

Wired+Wireless Designer Doorbell Model PC-5870

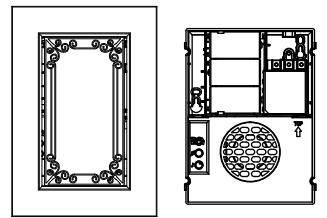

Instructions - Please retain these instructions for future reference.

You have purchased a Universal Door Chime that serves all residential applications. It can be installed as a Wired chime, where the power is supplied by a transformer with wires, or it can be a Wireless chime powered by 3 C cell batteries. Use the following guidelines to assist you in deciding the mode that best serves your application:

If you are building a new house:

- The Wired mode would be best if you are having an electrician install the door chime.
- The electrician will install a transformer and run the wires for the door chime as well as pushbuttons.
- You can also elect to use the Wireless mode. However, the batteries in the chime and pushbuttons will need to be replaced periodically.

If you are replacing a working Wired Doorbell:

- The Wired mode would be the best option.

If you have a wired doorbell, but it doesn't work:

- First install this chime in the Wired mode. Connect the wires as explained in the section "Replacing a Wired Doorbell". If the chime works, this is the best option.
- If the chime does not work, purchase either 1 or 2 IQ America Wireless Pushbuttons and follow the instructions for the Wireless mode.

If your home does not have a wired doorbell, you should use the Wireless Mode.

This package contains:

- Universal Chime and Decorative Cover
- 2 screws and 2 wall plugs for installing door chime
- 1 Diode 

WIRED MODE: New Installations

New installations will require a 16V 10W transformer. It is suggested that this be installed by a licensed electrician.

You will require: (for Wired option)

- A small Phillips head screwdriver.
- (For new installations) Transformer 16V 10W (IQ America DT1610)
- (For new installations) 2 Doorbell Pushbuttons
- 4 screws for installing doorbell pushbutton
- 1 Diode 

Installing the Transformer

Warning: Turn power off at fuse or circuit breaker before installing transformer. Transformer should be mounted on or near a junction box. They can also be mounted to the electrical service panels. Junction boxes in utility rooms, crawl spaces, or basement are preferred. Avoid attic locations. Failure to use a transformer with adequate power will result in loss of sound or may result in the chime being faulty. Contact a qualified electrician if you have any questions as to the suitability of the system or any doubts about your ability to wire this correctly.

Remove Decorative Chime Cover

Remove the decorative cover by simply pulling it away from the rear casing. When replacing the cover, simply press it back on the base.

Install the Door Chime (Refer to Figure 1)

Position the chime as shown in Figure 1. (The chime base can also be installed in the horizontal position.) Route the wires as shown and install the chime using the screws provided.

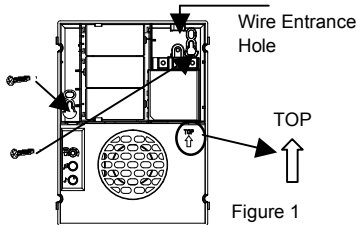

Figure 1

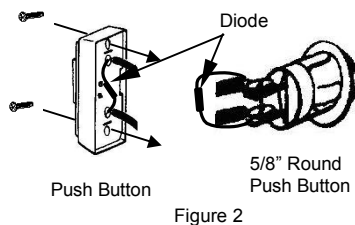

Figure 2

Wiring Instructions For New Installation (Refer to Figure 3)

- Turn off the power supply.
- Connect one wire from the Front Doorbell Pushbutton to the FRONT terminal of the Chime Base.
- Connect the other wire from the Front Doorbell Pushbutton to one Terminal of the Transformer.

- Connect the TRANS terminal of the Chime to the other Terminal of the Transformer.
- If the Back Doorbell Pushbutton is used, connect one end of the wire from the Back Doorbell Pushbutton to the REAR terminal of the Chime.

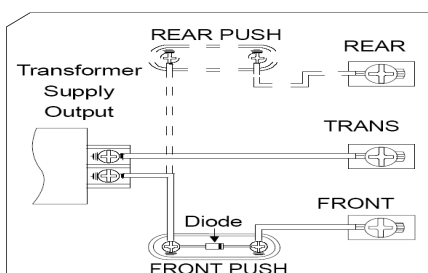

Figure 3

- Connect the other end of the Back Doorbell Pushbutton to the 1st Terminal of the Transformer.
- Turn on the power to the doorbell.
- Press the doorbell pushbutton. The chime should respond with a tune. If not, go to the Troubleshooting section.

Install the Front Doorbell Pushbutton (Refer to Figure 2)

A small electrical component called a 'diode' is supplied with the chime. Install the diode across the terminal screws of the Front Doorbell pushbutton as shown in Figure 2 & 3. Without this diode the chime will not work. Connect the wires to the Front Doorbell Pushbutton. Install the Front Doorbell Pushbutton in the desired location using the screws provided.

Install the Back Doorbell Pushbutton (Refer to Figure 2)

Connect the wires to the Back Doorbell Pushbutton. Install the Back Doorbell Pushbutton in the desired location using the screws provided (No diode required).

Replacing a Wired Doorbell

- Turn off the power supply.
- Remove the decorative cover by simply pulling it away from the rear casing. When replacing the cover, simply press it back on the base.
- Use tape to mark the wires and then disconnect the wires from doorbell.
- Position the chime as shown in Figure 1. (The chime base can also be installed in the horizontal position.) Route the wires as shown and install the chime using the screws provided.
- Connect the wires to the Door Chime.

- A small electrical component called a 'diode' is supplied with the chime. Install the diode across the terminal screws of the Front Doorbell pushbutton as shown in Figure 2 & 3. Without this diode the chime will not work. Connect the wires to the Front Doorbell Pushbutton. Install the Front Doorbell Pushbutton in the desired location using the screws provided.
- Turn the power on.

WIRELESS MODE

You will require: (for Wireless option)

- A small Phillips head screwdriver.
- Doorbell Pushbuttons
- 3 C cell batteries
- 2 screws for installing doorbell pushbutton

- Install the door chime using the hardware supplied.
- Mount the IQ America Wireless Pushbutton following the instructions provided and install the battery in the pushbutton.
- Insert the C cell batteries in the order shown in Figure 4. The Chime will play all of the tunes that are available when it is first powered up.
- Program the wireless IQ America pushbuttons to the door chime
 - Press the front door pushbutton. The door chime will respond with a chime.
 - Program a second pushbutton at this time. Programming must be completed within 2 minutes of programming the first pushbutton. If more than 2 minutes has elapsed, go to the **To Reset the Chime Programming**.

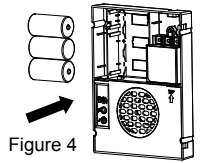

Figure 4

To Reset the Chime Programming, press and hold button A and B (Fig. 5) until the chime sounds. The chime will play all of the tunes available indicating that previous programs have been erased. Return to the *Program the Doorbell Pushbutton Transmitter and repeat section*.

Sound Selection: Refer to Figure 5 to select the sound

- Press button A until the desired tone for the front doorbell is heard (See Tune Options Table). Press the Front Doorbell Pushbutton to test the chime. (The chime tone can be changed at any time by simply pressing this button to select another tone.)
- If a Back Doorbell Pushbutton is used. Press button B until the desired tone is heard. Press the Back Doorbell Pushbutton to test the chime.
- Adjust the volume with the volume adjustment knob C.

Chime Options Table

- | | |
|-----------------------|--------------------------|
| 1. Big Ben 2notes | 6. Birthday Song |
| 2. Big Ben 8notes | 7. Merry Christmas |
| 3. Traditional 1note | 8. Auld Lang Synn |
| 4. Traditional 2notes | 9. Beethoven |
| 5. Traditional 8notes | 10. U.S. National Anthem |

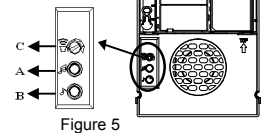

Figure 5

Replace the Decorative Chime Cover

as shown in Figure 6. Position the decorative cover and press down until it snaps in place. The cover can be installed in either direction.

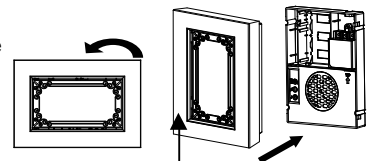

Figure 6

Specification

Range.....Up to 300 ft
Power supply.....16V Transformer

Troubleshooting For Wired Chime

Chime Not Sounding:
Check that power to the chime is turned on.
Verify Diode is attached securely to the Front Door bell Pushbutton. Diode may be positioned at the wrong polarity. Reverse the diode.
Verify all wires are securely fastened to terminals and that the wiring is correct.
Chime Sounds Only While Keeping Pushbutton Pressed
Reverse the direction of the diode on the front door pushbutton.

Troubleshooting For Wireless Chime

Chime Not Sounding:
Check that all batteries have been inserted correctly. The doorbell pushbutton LED light should come on when the pushbutton is pressed.
Chime may be positioned out of range of the doorbell pushbutton. Move your chime closer to the doorbell pushbutton. Note: During the programming cycle, the transmission range may be reduced and will resume optimum range after 2 minutes.
A metallic object may be blocking the signal from the doorbell pushbutton. Experiment with the location of the chime to see if you can move it in to a more suitable place.
The battery in the doorbell pushbutton or chime may need replacing. If the pushbutton LED light (B) flashes 5 times after being pushed, replace the battery. Note: When replacing batteries the chime will retain its programming. Note: In cold conditions, poor location or environment, operating at maximum range it is advisable to replace the battery more frequently before the indicator light flashes (i.e. every 12-18 months) to maintain optimum performance.
The doorbell pushbutton and chime haven't been programmed. Reset the automatic programming of your chime and doorbell pushbutton by Pressing and holding down chime selection buttons A and B (Figure 5) for 5 seconds. The chime will sound all of the tunes a available indicating the programming has been erased. Program the doorbell pushbutton following the installation instructions.
For any other problem, call 1-800-296-1869 Mon-Fri between 9 am and 5pm EST

IQ America Five Year Warranty

This is a "Limited Warranty" which gives you specific legal rights. You may also have other rights which vary from state to state and province to province. For a period of five years from the date of purchase, any malfunction caused by factory defective parts or workmanship will be corrected at no charge to you. To obtain a refund or a replacement, return the product to the place of purchase.

NOT COVERED: Repair service, adjustment and calibration due to misuse abuse or negligence. Unauthorized service or modification of the product or of any furnished component will void this warranty. This warranty does not include reimbursement for inconvenience, installation, setup time, loss of use or unauthorized service.

This warranty covers only IQ America products and is not extended to other equipment and components that a customer uses in conjunction with our products.

This warranty is expressly in lieu of all other warranties, express or implied, including any warranty, representation or condition of merchant ability of that the products are fit for any particular purpose or use, and specifically in lieu of all special, indirect or incidental or consequential damages.

Repair or replacement shall be the sole remedy of the customer and there shall be no liability on the part of IQ America for any special, indirect, incidental or consequential damages, including but not limited to any loss of business or profit, whether or not foreseeable. Some states or provinces do not allow the exclusion or limitation of incidental or consequential damages, so the above limitation or exclusion may not apply to you. Retain receipt for warranty claims.

Free Manuals Download Website

<http://myh66.com>

<http://usermanuals.us>

<http://www.somanuals.com>

<http://www.4manuals.cc>

<http://www.manual-lib.com>

<http://www.404manual.com>

<http://www.luxmanual.com>

<http://aubethermostatmanual.com>

Golf course search by state

<http://golfingnear.com>

Email search by domain

<http://emailbydomain.com>

Auto manuals search

<http://auto.somanuals.com>

TV manuals search

<http://tv.somanuals.com>