



BOSCH

Washing machine
WAY32540AU

en Instruction Manual and Installation Instructions

Your new washing machine

You have chosen a premium washing machine made by Bosch. Thanks to its innovative technologies, the washing machine is distinguished by its perfect washing performance and its economic consumption of water and energy.

Please take a couple of minutes to read and become familiar with the advantages of your washing machine.

To meet the high quality demands of the Bosch brand, each washing machine, which leaves our factory, is inspected thoroughly to ensure that it functions properly and is in perfect condition.

Further information on our products, accessories, spare parts and services can be found at: www.bosch-home.com or contact our customer service centres.

If the instructions for use and assembly describe various models, reference is made to the differences at the appropriate places.

Explanation of the symbols

Warning!

This combination of symbol and signal word indicates a potentially dangerous situation which may result in death or serious injuries unless it is avoided.

Caution!

This combination of symbol and signal word indicates a potentially dangerous situation which may result in slight or minor injuries or damage to property and the environment.



Instructions on how best to use the appliance as well as other useful information.



Contents

Before washing

■ Intended use	4
■ Safety instructions	5
■ Protection of the environment	8
■ Getting to know your appliance	9
■ Detergent drawer	10
■ Operating elements/Display elements	11
■ The main points in brief	12

Operating the appliance

■ Before each washing	13
■ Washing	19
■ After washing	22
■ Programme overview	23
■ Programme settings	27
■ Consumption values	29
■ Appliance settings	30
■ Sensors – Your washing machine is so intelligent	32

Cleaning and maintenance

■ Care and maintenance	33
■ Emergency lock release, e.g. if power failure occurs	37
■ Information on the display panel	38
■ Faults, what to do?	39
■ Customer service	41

Installing the appliance

■ Standard accessories	42
■ Installation	44
■ Remove transportation protection devices	48
■ Connecting the water	50
■ Alignment	54
■ Electrical connection	55
■ Before the 1st washing	57
■ Transportation, e.g. if moving house	58

Index

59



Intended use

- For use in the household only.
- The washing machine is suitable for washing machine-washable textiles and hand-washable wool in wash liquor.
- The washing machine is suitable to be operated with cold drinking water and commercially available detergents and care products which are suitable for use in washing machines.
- When dosing all detergents, cleaning aids, cleaning products and cleaning agents, always follow the manufacturer's instructions.
- The washing machine may be operated by children from 8 years of age, by persons who have limited physical, sensory or mental abilities and by persons who have inadequate experience or knowledge, provided they **are supervised** or **have been instructed** by a responsible person.
- Keep pets away from the washing machine!

Read and follow the operating and installation instructions and all other information enclosed with the washing machine.

Retain documents for subsequent use.



Safety instructions

⚠ Warning!

Danger of death from electric shock!

Danger of death if live parts are touched.

- Never pull out the mains plug by tugging the power cord.
- Insert/pull out the mains plug with dry hands only.

⚠ Warning!

Risk to children!

- Do not leave children unsupervised near the washing machine.
- Children must not play with the washing machine.
- This will prevent children from locking themselves in and suffocating.

On redundant appliances:

- Pull out the mains plug!
- Sever the power cord and discard together with the plug.
- Destroy the lock on the washing-machine door.
- Children must not perform any cleaning or maintenance work without supervision.
- When playing, children may become entangled in the packaging/film and packaging parts or pull them over their heads and suffocate.

Keep packaging, plastic film and packaging parts out of the reach of children.

- When washing at high temperatures, the glass of the washing machine door becomes hot.

Prevent children from touching the hot washing machine door.

- Detergents and care products may cause intoxication if consumed or eye and skin irritation if touched.

Keep detergents and care products out of the reach of children.

⚠ Warning!

Risk of explosion!

Items of washing pretreated with solvent detergents, e.g. stain remover/petroleum ether, may cause an explosion when the washing machine has been loaded.

Before hand thoroughly rinse items of washing by hand.

⚠ Caution!

Danger of scalding!

When washing at high temperatures, you may be scalded if you touch the hot wash liquor (e.g. if draining hot wash liquor into a washbasin or if draining the washing machine in an emergency). Allow detergent solution to cool down.

⚠ Caution!

Risk of damaging appliance!

- **Cover plate may break!**

Do not climb on the washing machine.

- **Opened washing machine door may break off or washing machine may overturn!**

Do not lean on the open washing machine door.

⚠ Caution!

Danger when reaching into/gripping the rotating drum!

If you reach into the rotating drum, you may injure your hands.

Do not grip the rotating drum. Wait until the drum stops rotating.

⚠ Caution!

Risk of coming into contact with liquid detergents/care products!

If the detergent drawer is opened while the washing machine is running, detergent/care product may spray out.

Caution when opening the detergent drawer.

In case of eye/skin contact, rinse thoroughly.

If accidentally swallowed, seek medical advice.



Protection of the environment

Packaging/Old appliance



Dispose of packaging in an environmentally friendly manner.

This appliance has been identified in accordance with the European Directive 2002/96/EG on Waste Electrical and Electronic Equipment (WEEE).

The Directive specifies the framework for an EU-wide valid return and recycling of waste appliances.

Hints and tips

- Utilise the maximum amount of washing for the particular programme.
- Wash normally soiled washing without Pre-wash.
- Instead of **Cottons 90 °C** programme select **Cottons 60 °C** and **EcoPerfect** button. Comparable cleaning result with significantly lower energy consumption.
- **Energy saving mode:** The display panel light goes out after several minutes, **Start/Reload** ▷||| flashes. To activate the light, select any button.
The energy-saving mode is not activated if a programme is running.
- **Automatic switch off:** If the appliance is not operated for a prolonged period, it automatically switches off before the programme starts and when the programme has ended to save energy. Switch on by pressing main switch ① button.
- If the washing is then dried in the tumble dryer, select spin speed according to the instructions of the dryer manufacturer.



Getting to know your appliance

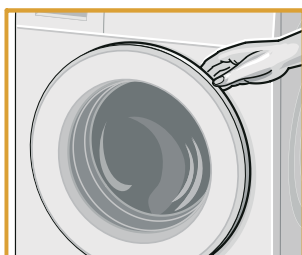
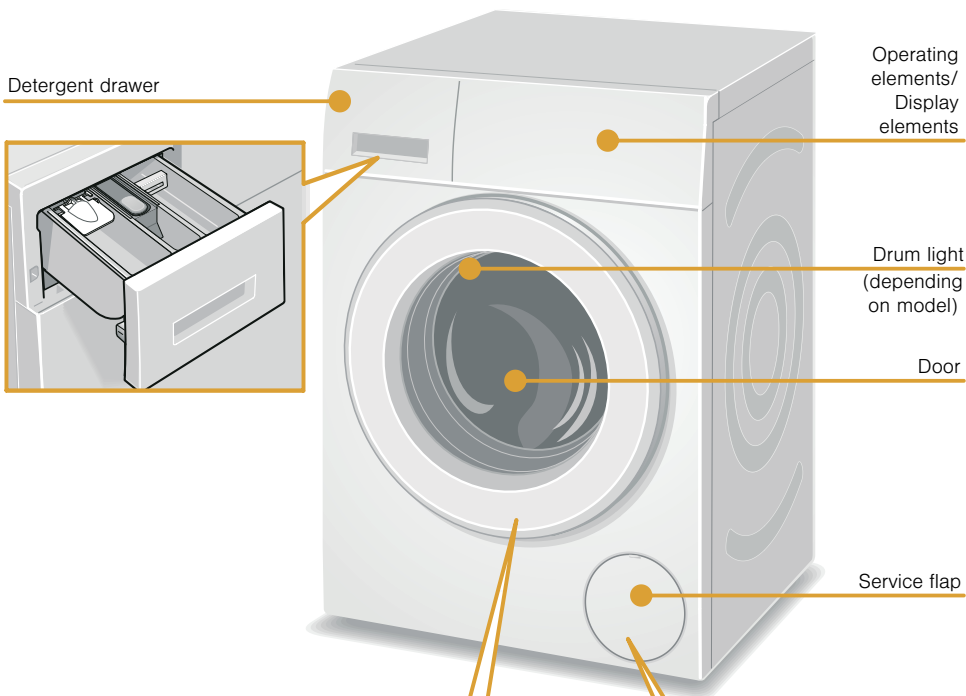

Opening ...

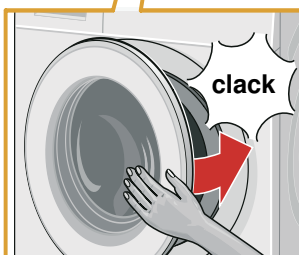

and closing the door

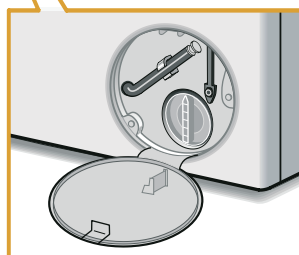

Service flap



Detergent drawer

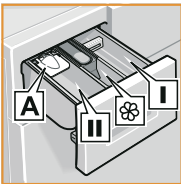

Dispenser I	Detergent for prewash
Dispenser 	Softener, starch. Do not exceed the maximum load.
Dispenser II	Detergent for main wash, water softener, bleach, stain remover
Dispenser A	for dosing liquid detergent (not for all models)

For models with insert for liquid detergent:

The detergent drawer features an insert which is used as a dosing aid for liquid detergent.



Do not use insert:

- For gel-like detergents and washing powders.
- For programmes with Prewash or Ready in option.

Position insert for dosing liquid detergent:

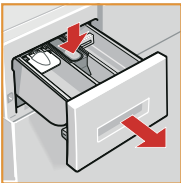

Completely remove detergent drawer.

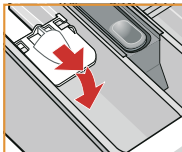

Push insert forwards.

For models without insert for liquid detergent:

Dose liquid detergent according to the manufacturer's instructions.



Operating elements/Display elements

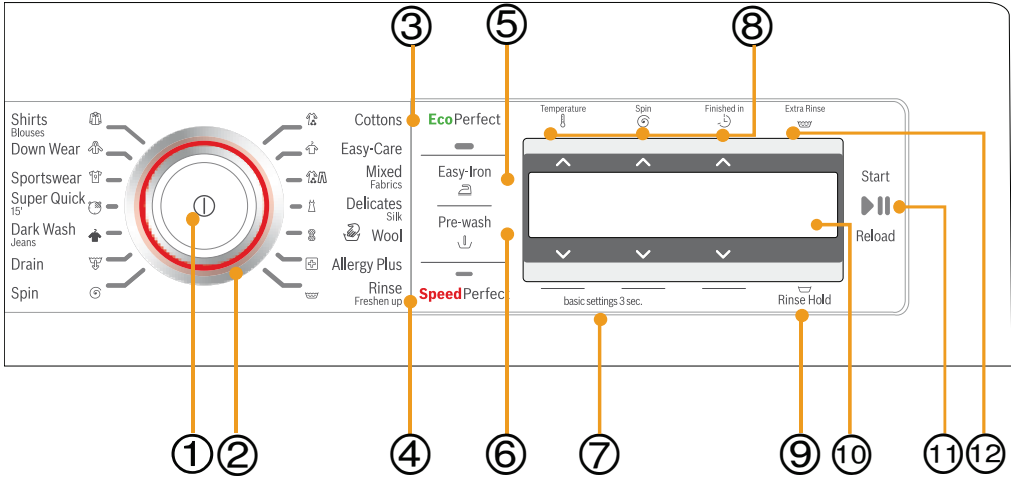

i All buttons are sensitive, they only need to be touched gently.

- ① Press the main switch ① button. Switch on and off the appliance.
- ② Programme selector – can be rotated in either direction. *Programme Overview, refer to → Page 23*
- ③ **EcoPerfect**
- ④ **SpeedPerfect**
- ⑤ Easy-Iron
- ⑥ Pre-wash
- ⑦ Change appliance settings. Hold down **Temperature** ∨ and **Spin** ∨ buttons for appliance settings (end signal, button signal, language, Autom. switch off) for approx. 3 seconds. *Overview of all settings → Page 30*
- ⑧ Temperature selection, Select spin speed, End time preselection button
- ⑨ Rinse Hold
- ⑩ Display panel for settings and information
- ⑪ **Start/Reload** ▶|| button to start, interrupt and cancel the programme (e.g. Topping up the washing).
- ⑫ Extra Rinse

Programme settings:

→ Page 16, → Page 23

- ③ **EcoPerfect**
- ④ **SpeedPerfect**
- ⑤ Easy-Iron
- ⑥ Pre-wash
- ⑦ Change appliance settings. Hold down **Temperature** ∨ and **Spin** ∨ buttons for appliance settings (end signal, button signal, language, Autom. switch off) for approx. 3 seconds. *Overview of all settings → Page 30*
- ⑧ Temperature selection, Select spin speed, End time preselection button



The main points in brief

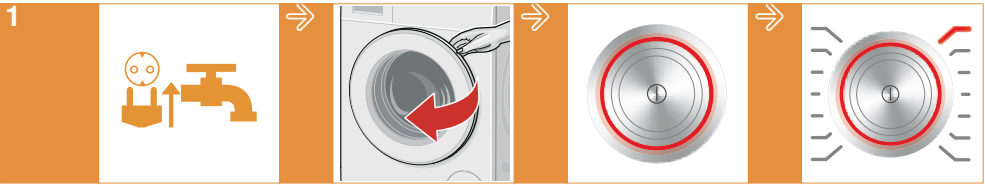

1 Insert mains plug.
Turn the tap on.

Open the washing machine door.

To switch on, press the button.

Select the programme, e.g. **Cottons**.

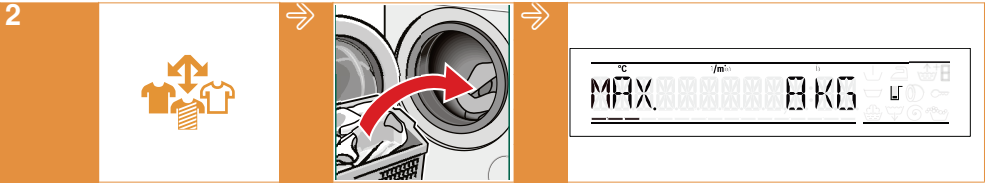

2 Sort the washing.

Insert the washing.

Do not exceed maximum load.

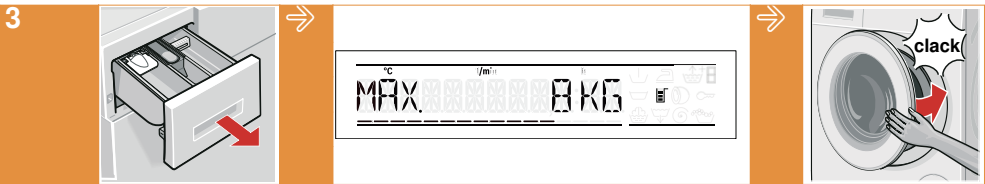

3 Open the detergent drawer.

Dose detergent according to dosing recommendation.

Close the washing machine door.

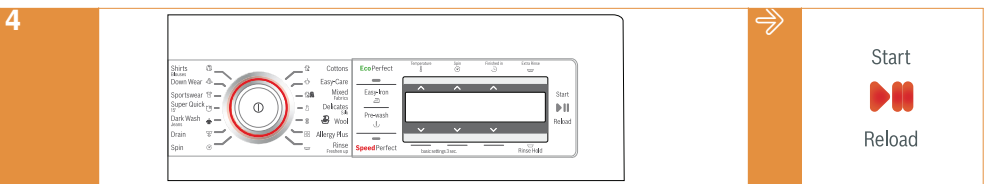

4 If required, change presettings of the selected programme and/or select programme settings.

Select **Start/Reload** .

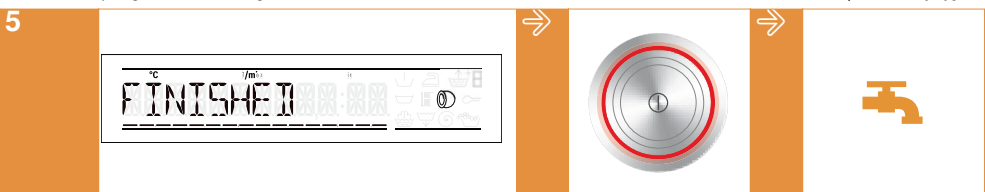

5 End of the programme

For switching the machine on, press the button.

Turn off the mains supply (for models without Aqua-Stop).



Before each washing

- i** – **Install and connect** washing machine **properly**.
Refer to → Page 44
- Before the 1st wash, wash once **without** any washing.
→ Page 57

1. Preparing the washing



Sorting the washing according to:

- Type of fabric/fibre.
- Colour.
- Soiling.
- Follow manufacturer's care information.
- Care label specifications:



Cottons 95 °C, 90 °C



Coloureds 60 °C, 40 °C, 30 °C



Easy-Care 60 °C, 40 °C, 30 °C



Delicates 40 °C, 30 °C



Hand and machine-washable silk and woollens cold, 40 °C, 30 °C



Do not wash laundry in the washing machine.

Protecting the washing and the machine:

- i** – When dosing all detergents, cleaning aids, cleaning products and cleaning agents, always follow the manufacturer's instructions.
- Keep detergents and agents for the pretreatment of washing (e.g. stain remover, prewash sprays, ...) away from the surfaces of the washing machine. Using a damp cloth, immediately remove any fine spray residue and other residue/droplets.



- Empty pockets.
- Remove metal parts (paper clips, etc.).
- Wash delicates in the net/bag (tights, underwired bras).
- Close zips, button up covers.
- Brush sand out of pockets and collars.
- Remove curtain fittings or include in the net/bag.
- Wash new items separately.

2. Preparing the appliance



Insert mains plug.

Turn on water tap.

3. Selecting programme and loading laundry in the drum

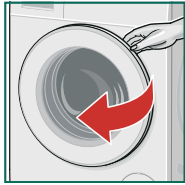

1. Open the washing machine door.



2. Check whether the drum has been completely emptied. If required, empty. Otherwise, the load display may malfunction.
→ Page 32



3. Press the  button. The appliance is switched on.

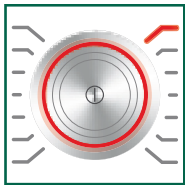

Then always the **Cottons** programme preset at the factory is displayed.

Displays for the **Cottons** programme:



- The indicator lamp is lit on the programme selector and the main menu for the selected programme is indicated on the display panel.

- For appliances with **drum light**:

After switching on the appliance, after opening and closing the washing machine door as well as after starting the programme, the drum is lit. The light goes out automatically.

4. Select a programme.
You can use the displayed programme
or select another programme, *Programme overview*, refer to → *Page 23*,

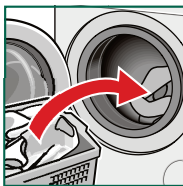

5. Insert the washing.

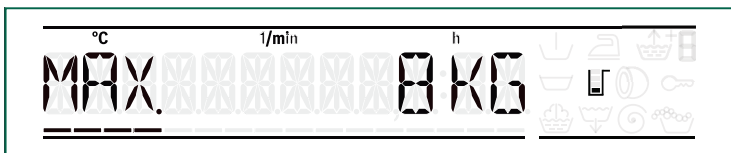

The load screen for the selected programme (e.g. for Cottons) is indicated on the display panel. The load screen is indicated when the door is opened or when the amount of washing is changed.

- i – Unfold and load presorted items of washing. Mix large and small items. Washing items of different size distribute themselves better during the spin cycle. Individual items of washing may cause an unbalanced load. → *Page 32*
- Do not load the laundry until the main menu for the programme is displayed.
- The load bar progresses as the washing machine is loaded. If the max. load is exceeded, the bar flashes. Do not exceed indicated max. load. Overfilling reduces the washing result and encourages creasing.

4. Add detergent and fabric care product

1. Pull out the detergent drawer.
2. Dosing in dispenser → *Page 10* according to:
 - Dosing recommendation on the display panel, e.g. for **Cottons**:

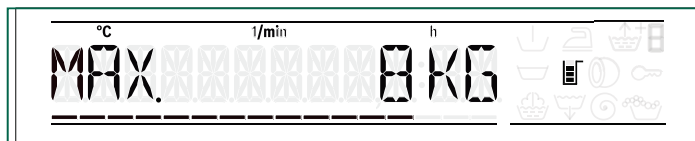

Depending on the amount of washing in the washing machine, a dosing recommendation is indicated on the display panel. The indicated % refers to the dosage recommendation of the detergent manufacturer.

 = 40 % of the recommendation of the detergent manufacturer

 = 60 %

 = 75 %

 = 100 %

- Soiling.
- Water hardness (*depending on model* can be determined using enclosed water hardness strip or is available from your water utility company).
- Manufacturer's instructions.

- i** - When dosing all detergents, cleaning aids, cleaning products and cleaning agents, always follow the manufacturer's instructions.
- Dilute viscous fabric softener and fabric conditioner with water.
- Prevents blockage of the overflow!

5. Changing programme settings

- i** Take care not to trap any items of clothing between the loading door and rubber seal.



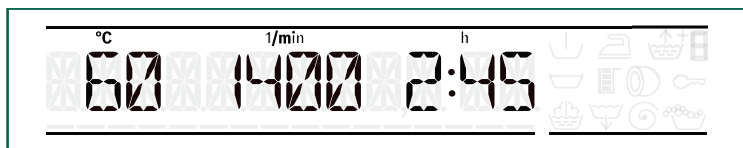

Close the door.



The main menu for the selected programme is indicated again on the display panel.

You can use the displayed presets or adjust the selected programme optimally to the items of washing by changing the presets or selecting additional settings.

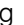
- Change Temperature, spin speed, Finished in time. *Refer to* → Page 23, → Page 27:

Selecting and changing e.g. the **Temperature**  or :

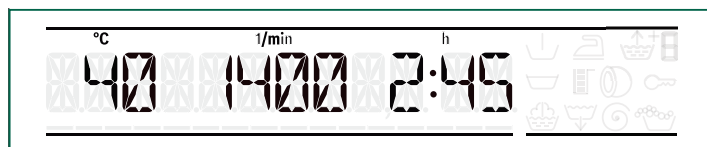
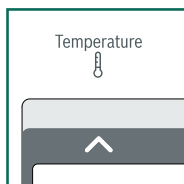

The settings are active without acknowledgement and are displayed in the main menu.

- i** – If the buttons are held down, the set values automatically run through (∧ downwards, ∨ upwards).
- The respective programme duration is displayed by selecting the programme. The programme duration is adjusted while the programme is running if the programme duration requires changing, e.g. due to changes in the programme settings, foam detection, unbalanced load detection, the load or soiling.
- Select additional programme settings:
→ Page 23, → Page 27



- **EcoPerfect**
For saving energy with a comparable washing effect to the standard programme. When selected, the display lamp is lit.



- **SpeedPerfect**
For a shorter wash time with a comparable washing effect to the standard programme. Observe maximum load.
→ Page 23
When selected, the display lamp is lit.

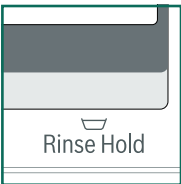

Other settings can be selected depending on the model, e.g. **Rinse Hold** button:



- When selected, the button indicator lamp is lit and a corresponding symbol is indicated on the display panel:
- Easy-Iron button –
 - Pre-wash button –
 - Extra Rinse button – 1, 2, 3 (Rinse cycles)
 - Rinse Hold button –

6. Starting the programme

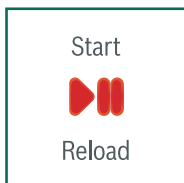

- Select **Start/Reload** . The indicator light is on.







Washing

Programme sequence





While the programme is running, the programme progress is indicated on the display panel via corresponding symbols and a progress bar. The bar progresses in the course of the wash cycles.



The combined symbol  indicates the following programme states:

-  Pre-wash
-  Washing
-  Rinse

Other symbols:

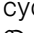
-  Drain
-  Spin
-  Childlock has been activated
-  Overdosage of the detergent detected, additional rinse cycles activated.
-  is lit when the door is locked or unlocked.

During the washing

■ Childlock

To prevent the set functions of the washing machine from being accidentally changed, the childproof lock can be activated when the programme has started.

Activate/deactivate: press **Finished in**  for approx. 5 seconds.

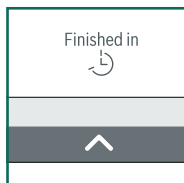

The activated childproof lock is indicated on the display panel by the symbol .

If the programme selector is adjusted or a button is selected while the childproof lock is active, the  symbol flashes briefly.

■ Topping up laundry

When the programme has started, washing can be reloaded or taken out as required.

Select **Start/Reload** .

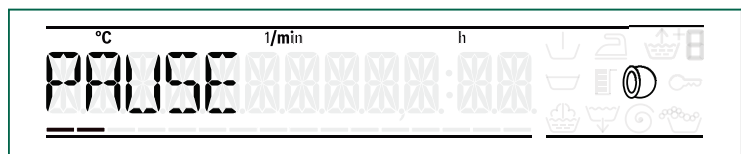
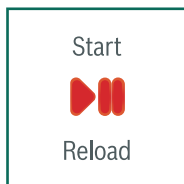

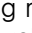
- i – If there is a high water level, high temperature or if the drum is rotating, the washing machine door remains locked for reasons of safety and reload is not possible. Follow the information on the display panel. To continue the programme, select the **Start/Reload**  button. The washing machine door is locked and the programme continues automatically.
- Load display is not active during reloading.
- Do not leave washing machine door open for a prolonged period – water could run out of the washing.

■ Changing the programme

if you have mistakenly started a wrong programme.

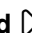
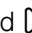
1. Select **Start/Reload** .
2. Select another programme.
3. Select **Start/Reload** . The new programme starts from the beginning.



After washing



1. Open washing machine door and remove washing.



- Do not leave any items of washing in the drum. In the next wash they may shrink or discolour something else.



- Remove any foreign objects from the drum and the rubber seal – risk of rust.
- Leave detergent drawer and door open so that residual water can evaporate.

Before switching the machine off:



- Always remove the washing. Otherwise, the load display may malfunction.
- Always wait until the programme ends, as the appliance could still be locked. Then switch the appliance on and wait for the unlocking device.



2. Press the ⓐ button. Appliance is switched off.















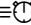



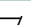

3. Turn off the water tap.

Not required for Aqua-Stop models. → Page 64





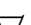

The presettings of the programmes are highlighted in **bold**.

Programme/Type of washing	Settings/Information
 <p>Wool Hand or machine-washable wool or rich-wool textiles. Especially gentle wash programme to prevent shrinkage, longer programme pauses (textiles rest in wash liquor).</p> <p>i.Wool is of animal origin, e.g.: angora, alpaca, lama, sheep.</p> <p>i.For machine wash use detergent suitable for wool.</p>	<p>max. 2 kg</p> <hr/> <p>cold – 30 – 40 °C</p> <hr/> <p>0 ... 800 rpm</p> <hr/> <p></p> <hr/>
 <p>Allergy Plus Hard-wearing textiles.</p> <p>i.For especially sensitive skin, extended wash cycle at higher water level, additional rinse cycle.</p> <p>i.* reduced load at SpeedPerfect setting</p>	<p>max. 8 kg/5 kg *</p> <hr/> <p>cold – 40 – 60 °C</p> <hr/> <p>0 ... 1200 ... 1600 rpm</p> <hr/> <p>, , , , </p> <hr/> <p>at : 0 ... 800 rpm</p> <hr/>
 <p>Rinse/Freshen up Extra rinse with spin.</p>	<p>-</p> <hr/> <p>-</p> <hr/> <p>0 ... 1200 ... 1600 rpm</p> <hr/> <p>, , </p> <hr/> <p>at : 0 ... 800 rpm</p> <hr/>
 <p>Spin Extra spin with selectable spin speed.</p>	<p>-</p> <hr/> <p>-</p> <hr/> <p>0 ... 1200 ... 1600 rpm</p> <hr/> <p></p> <hr/> <p>at : 0 ... 800 rpm</p> <hr/>
 <p>Drain the rinsing water, e.g. after Rinse Hold  (without final spin cycle).</p>	<p>-</p> <hr/> <p>-</p> <hr/> <p>-</p> <hr/> <p>-</p> <hr/>



The presettings of the programmes are highlighted in **bold**.

Programme/Type of washing	Settings/Information
 <p>Dark Wash/J Jeans Dark textiles made of cotton and dark easy-care textiles. Wash textiles inside out.</p>	<p>max. 3.5 kg cold – 30 – 40 °C 0 ... 800 ... 1200 rpm Ⓜ, =Ⓜ, ↓, ⊞, ↑, ☐ at ⊞: 0 ... 600 ... 800 rpm</p>
 <p>Super Quick 15' Extra short programme approx. 15 minutes, suitable for lightly soiled washing as a small amounts of laundry.</p>	<p>max. 2 kg cold – 30 – 40 °C 0 ... 800 ... 1200 rpm ☐</p>
 <p>Sportswear Textiles made of microfibres for sport and leisure time.</p> <p>i.The laundry must not be treated with fabric softener.</p> <p>i.Before washing, remove all fabric softener residue from detergent drawer (all dispensers).</p>	<p>max. 2 kg cold – 30 – 40 °C 0 ... 800 rpm Ⓜ, =Ⓜ, ↓, ⊞, ↑, ☐ at ⊞: 0 ... 600 ... 800 rpm</p>
 <p>Down Wear Machine-washable textiles filled with down, pillows, blankets or duvets.</p> <p>i.Wash large items individually. Use mild detergent. Measure detergent sparingly.</p>	<p>max. 2 kg cold – 40 – 60 °C 0 ... 1200 rpm Ⓜ, =Ⓜ, ↑, ☐</p>
 <p>Shirts/Blouses Non-iron shirts/blouses made of cotton, linen, synthetics fibres or blended fabrics. At the ⊞ Easy-Iron setting, shirts/blouses are given a short spin only, hang up dripping wet. → Self-smoothing effect.</p> <p>i Wash shirts/blouses made of silk/delicate materials in the Delicates/Silk programme.</p>	<p>max. 2 kg cold – 40 – 60 °C 0 ... 800 rpm Ⓜ, =Ⓜ, ↓, ⊞, ↑, ☐ at ⊞: 0 ... 400 rpm</p>

Starching

- i** The washing should not be treated with fabric softener. Liquid starch can be used in all wash programmes. Pour starch into the dispenser  according to manufacturer's specifications (if required clean beforehand).

Dyeing/Discolouring

Dye in household quantities only. Salt may attack stainless steel! Observe specifications of the dye manufacturer! Do **not** discolour washing in the washing machine!

Soaking

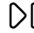
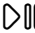
Pour soaking agent/detergent into dispenser **II** according to the manufacturer's instructions. Set programme selector to **Cottons 30 °C** and select **Start/Reload** . After approx. 10 minutes select **Start/Reload** . After the required soaking time, reselect **Start/Reload** , if the programme is to be continued or changed.

- i** Insert washing of the same colour. No additional detergent is required, the soaking solution is used for washing.









Programme settings

Depending on the programme, you can use the programme settings to adjust the washing process even more efficiently to your items of washing.

Programme settings:

- i – are active without acknowledgement.
- not retained after appliance is switched off.
- can be selected or deselected or changed depending on the programme progress.

Buttons	Notes
 Temperature	Temperature ^ , v Before and during the programme the presetsings can be changed depending on the programme progress.
 Spin	Spin ^ , v The maximum temperature depends on the programme and the maximum spin speed depends on the programme and model.
 Finished in	Finished in ^ , v Delays the Finished in time (end of programme). Before the programme starts, the end of the programme can be preselected in h steps up to maximum 24h (h = Hour). When the programme has started, the preselected time is displayed e.g. for 8h and counts down until the wash programme starts. Then the programme duration is displayed, e.g. 2:30h. When the programme has started, the preselected time can be changed as follows: <ol style="list-style-type: none"> 1. Select Start/Reload ▷ . 2. Select Finished in button and change Finished in time. 3. Select Start/Reload ▷ .
 Finished in	Finished in ^ To activate/deactivate the Childlock . → <i>Page 20</i>
 EcoPerfect	EcoPerfect @ For saving energy.
 SpeedPerfect	SpeedPerfect ≡⌚ For a shorter wash time.
 Easy-Iron	Easy-Iron ☞ Reduces creasing by special spin sequence followed by fluffing and reduced spin speed. i Residual moisture of the washing is slightly increased.

Buttons	Notes
Pre-wash 	Pre-wash  For heavily soiled washing. Pour detergent into dispensers I and II .
Extra Rinse 	Extra Rinse  1 Rinse cycle  2 Rinse cycles  3 Rinse cycles  Recommended application: for particularly sensitive skin and/or in areas with very soft water.
 Rinse Hold	Rinse Hold  The washing remains in the water after the last rinse cycle. End the programme. → <i>Page 21</i>



Consumption values

Programme	Additional function	Load	Energy consumption ***	Water ***	Programme duration ***
Cottons 30 °C *		8 kg	0.35 kWh	77 l	2:31 h
Cottons 40 °C *		8 kg	0.89 kWh	76 l	2:41 h
Cottons 60 °C *		8 kg	1.49 kWh	76 l	2:41 h
Cottons 60 °C	EcoPerfect **	8 kg	0.85 kWh	57 l	3:56 h
Cottons 90 °C		8 kg	2.42 kWh	89 l	2:31 h
Easy-Care 40 °C *		3.5 kg	0.58 kWh	55 l	1:43 h
Mixed Fabrics 40 °C		3.5 kg	0.61 kWh	51 l	1:01 h
Delicates/Silk 30 °C		2 kg	0.15 kWh	34 l	0:43 h
Wool 30 °C		2 kg	0.20 kWh	39 l	0:40 h

* Programme setting for tests according to currently valid European standard EN60456. Information about comparability tests: To test the test programmes, wash indicated load size at maximum spin speed.

** To be used for normally soiled laundry. Programme setting for energy labelling according to AS/NZS 2040.

*** The values may deviate from the stated values depending on water pressure and hardness, room temperature, type and amount of laundry, detergents used, fluctuations in the mains voltage and selected additional functions.



Appliance settings

The **basic settings 3 sec.** buttons (Temperature \checkmark and Spin \checkmark), can be used to change the set values, e.g. the volume of the button signals.

Simultaneously hold down **basic settings 3 sec.** buttons for approx. 3 seconds:

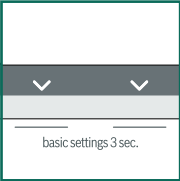

- The access menu for changing the appliance settings appears on the display panel.
- The Finished in \wedge , \vee buttons can be used to change the set values.
If the buttons are held down, the set values automatically run through.
- The Temperature \wedge , \vee and Spin \wedge , \vee buttons can be used to select other settings.
If the buttons are held down, the set values automatically run through.
- To end the settings, wait or hold down the **basic settings 3 sec.** buttons again.

i Settings are retained after appliance is switched off.

Settings	Set values	Notes
END SIGNAL	0 = off 1 = quiet 2 = medium 3 = loud 4 = very loud	Adjust volume of the end signal.
BUTTON SIG.	0 = off 1 = quiet 2 = medium 3 = loud 4 = very loud	Adjust volume of the button signals.

Settings	Set values	Notes
LANGUAGE	DE = German GB = English ...	Change displayed language.
AUTO OFF	15 (min.) 30 (min.) 1:00 (h=hour) OFF	The appliance automatically switches off after the selected time (=0 kWh energy consumption). to switch on, press main switch button ① .



Sensors – Your washing machine is so intelligent

Load adjust

Depending on the type of textile and load, the load adjust optimally adjusts the water consumption in each programme.

Load sensor/Load display

The load sensor detects the load level in the washing machine when the door is open. This is indicated by a progressing bar on the display panel.

- i** To ensure that the load sensor measures all the laundry, the drum must be empty before the washing machine is switched on.

Dosing recommendation

A detergent dosage recommendation is displayed depending on the selected programme and the detected load. → *Page 15*

- i** By observing the recommended dosage, you will protect the environment and reduce your household costs.

Unbalanced load detection system

The automatic unbalanced load detection system spins the laundry several times to ensure even distribution.

For reasons of safety the speed is reduced or does not perform a spin cycle if the washing is very unevenly distributed.

- i** Distribute small and large items of washing in the drum. *Faults, what to do?* → *Page 39*



Care and maintenance

⚠ Warning!

Danger of death from electric shock!

Danger of death if live parts are touched.
Switch off the appliance. Pull out the mains plug!

⚠ Caution!

Fire and explosion hazard!

If solvent cleaning agents, e.g. petroleum ether, are used in the washing machine, components may be damaged and toxic fumes generated.

Do not use solvent-based cleaning agents.

⚠ Caution!

Washing machine may be damaged!

If solvent cleaning agents, e.g. petroleum ether, are used on the washing machine, the surfaces may be damaged.

Do not use solvent-based cleaning agents.

Machine housing/Control panel

- Remove detergent residue immediately.
- Wipe with a soft, damp cloth.
- Do not clean the appliance with a water jet.

Drum

Use chlorine-free cleaning agent, not steel wool.

Descaling

Not required if detergent dosed correctly. However, if this does occur, follow the instructions of the descaling agent manufacturer. Suitable descalers can be purchased on our website or from customer service. → *Page 41*

Cleaning the detergent drawer

If it contains detergent or fabric softener residue:

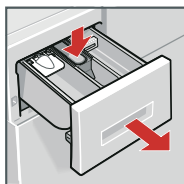

1. Pull out, depress insert, take out drawer all the way.

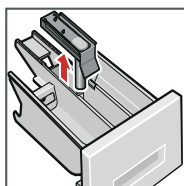

2. Take out insert: using your finger, press insert upwards.
3. Clean detergent dispenser and insert with water and a brush and dry.
4. Attach insert and lock into position (push cylinder onto guide pin).
5. Insert detergent drawer.

i Leave detergent drawer open so that residual water can evaporate.

Drain pump blocked

⚠ Warning! **Danger of scalding!**

Wash liquor is hot when washing at high temperatures. You may be scalded if you touch the hot wash liquor.

Allow detergent solution to cool down.

i Turn the tap off to prevent more water from flowing in and to ensure that it is drained via the pump.

1. Switch off the appliance. Pull out the mains plug!
2. Open service flap.

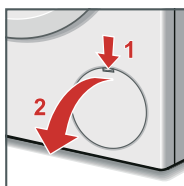



3. Take the drainage hose out of the holder.



4. Remove sealing cap, allow detergent solution to flow out. Have a suitable container ready.
Push up the closing cap and place the drain hose back in its holder.

Note: Residual water may run out.

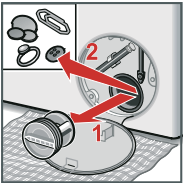

5. Carefully unscrew the pump cover. Clean the interior, pump cover thread and pump housing (fan impeller in the detergent-solution pump must rotate).

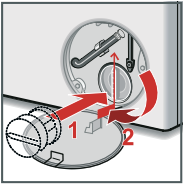

6. Reinsert and screw on pump cover. Handle should be vertical.
7. Close the service flap. If required, lock disengaged service flap beforehand.

i To prevent unused detergent from flowing into the outlet during the next wash: Pour 1 litre of water into dispenser **II** and start the **Drain** programme.

Drainage hose on the siphon blocked

1. Switch off the appliance. Pull out the mains plug!

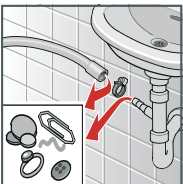

Note: Residual water may run out!



2. Loosen hose clip, carefully remove drainage hose.
3. Clean drainage hose and siphon spigot.
4. Re-attach drainage hose and secure connection point with hose clip.

Filter blocked in water inlet hose

First, release water pressure in the supply hose:

1. Turn off the tap!
2. Select any programme (except Spin/Drain).
3. Select **Start/Reload** . Leave programme for approx. 40 seconds.
4. Press the  button. Appliance is switched off. Pull out the mains plug!
5. Clean the filter:
Disconnect the hose from the water tap.
Clean filter with small brush.

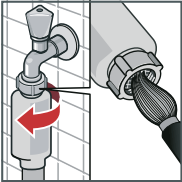

and/or for standard and Aqua-Secure models:

Remove hose from the rear of the appliance.

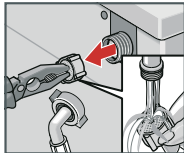

Take out filter with pliers and clean.

6. Connect the hose and check for leaks.

Emergency lock release, e.g. if power failure occurs

The programme continues running when the power supply is restored. If the washing is still to be removed, the door can be opened as described below:

⚠ **Warning!**

Danger of scalding!

Wash liquor and washing may be hot. If touched, there is a risk of scalding. If required, leave to cool down.

⚠ **Caution!**

Danger when reaching into/gripping the rotating drum!

If you reach into the rotating drum, you may injure your hands.

Do not grip the rotating drum. Wait until the drum stops rotating.

⚠ **Caution!**

Water damage possible!

Leaking water may cause damage.

Do not open the door if you can still see water through the glass.

1. Switch off the appliance. Pull out the mains plug!
2. Drain the water. → *Page 34*
3. Pull down emergency release with a tool and release. Door can then be opened.

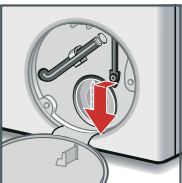







Information on the display panel

Display	Cause/Remedy
CLOSE DOOR	<ul style="list-style-type: none">– Washing may be caught. Please open and close washing machine door again and select Start/Reload ▷00.– If required, shut washing machine door or remove washing and shut again.– If required, switch appliance off and on again; set programme and make individual settings; start programme.
LOW WATER PRESSURE OPEN TAP	<ul style="list-style-type: none">– Turn on tap fully.– Supply hose kinked/jammed.– Water pressure too low. Clean the filter.
PUMP IS BLOCKED CLEAN PUMP	<ul style="list-style-type: none">– Drain pump blocked. Clean the drain pump. → <i>Page 34</i>– The water drainage pipe/drain hose is blocked. Clean the drainage hose on the siphon. → <i>Page 35</i>
DOOR IS LOCKED	Water level or temperature is too high. Select Start/Reload ▷00 to continue the programme.
LOCKING... UNLOCKING...	If the Start/Reload ▷00 button is pressed too frequently (e.g. repeatedly reloading items of washing), the door lock may overheat. Wait for the door lock to lock or unlock.
E: 23	not applicable without AquaStop Water in the base pan, appliance leaking. Call customer service! → <i>Page 41</i>
Error E: XXX	Switch off appliance, wait 5 seconds and switch on again. If the display is indicated again, call customer service. → <i>Page 41</i>

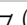
? Faults, what to do?

Faults	Cause/Remedy
Water is running out.	<ul style="list-style-type: none"> - Correctly attach/replace drainage hose. - Tighten screw-fitting on the supply hose.
Water not flowing in. Detergent not dispensed.	<ul style="list-style-type: none"> - Start/Reload  not selected? - Tap not open? - Filter blocked? Clean the filter. - Supply hose kinked or jammed?
Washing machine door cannot be opened.	<ul style="list-style-type: none"> - Safety function active. Stop programme? - Rinse Hold  (without final spin) selected? - Can be opened via emergency release only? → <i>Page 37</i>
Programme does not start.	<ul style="list-style-type: none"> - Start/Reload  or Finished in time selected? - Door closed? - Childlock active? Deactivate.
Detergent solution is not drained.	<ul style="list-style-type: none"> - Rinse Hold  (without final spin) selected? - Clean the drain pump. → <i>Page 34</i> - Clean outlet pipe and/or drainage hose.
Water not visible in the drum.	Not a fault – water below the visible area.
Spin result not satisfactory. Washing wet/too damp.	<ul style="list-style-type: none"> - Not a fault – unbalanced load detection system has stopped the spin cycle, washing unevenly distributed. - Distribute small and large items of washing in the drum. - Easy-Iron  selected? - Too low speed selected? → <i>Page 23</i>
Spin cycle activated several times.	Not a fault – unbalanced load detection system adjusts imbalance.
Residual water in the dispenser for care product.	<ul style="list-style-type: none"> - Not a fault – effect of the care product not impaired. - If required, clean insert. → <i>Page 34</i>
Odour formation in the washing machine.	Run Cottons 90 °C programme without washing. Use standard detergent.
Loud noise formation, vibrations and “wandering” during spin cycle.	<ul style="list-style-type: none"> - Appliance aligned? Align the appliance. → <i>Page 54</i> - Appliance feet fixed? Secure appliance feet. → <i>Page 54</i> - Transportation safety devices removed? Remove transportation protection devices. → <i>Page 48</i>

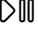
Faults	Cause/Remedy
Display panel/indicator lights do not function while the appliance is running.	<ul style="list-style-type: none"> - Power failure? - Fuse tripped? Switch on/replace fuse. - If the fault occurs repeatedly, call customer service. → <i>Page 41</i>
The programme takes longer than usual.	<ul style="list-style-type: none"> - Not a fault – unbalanced load detection system adjusts imbalance by repeatedly distributing the washing. - Not a fault – foam detection system active – several rinse cycles are switched on.
Detergent residue on the washing.	<ul style="list-style-type: none"> - Occasionally phosphate-free detergents contain water-insoluble residue. - Select Rinse/Freshen up or brush the laundry after washing.
In the pause status Start/Reload  flashes very quickly and a signal sounds.	<ul style="list-style-type: none"> - Water level too high. Washing cannot be reloaded. Immediately close washing machine door. - Select Start/Reload  to continue the programme.
<p>If a fault cannot be rectified (switching the machine on and off) or a repair is required:</p> <ul style="list-style-type: none"> - Switch off the appliance and pull out the mains plug. - Turn off the tap and call customer service. → <i>Page 41</i> 	



Customer service

If you cannot rectify the fault yourself, *Faults, what to do?* → Page 39, please contact our customer service. We will always find a suitable solution to avoid unnecessary visits by technicians.

Please give customer service the product number (E-Nr.) and the production number (FD) of the appliance.

E-Nr. _____ FD _____		These instructions can be found on: inside of washing machine door */ open service flap * and rear of the appliance. * depending on model
Product number	Production number	

Rely on the competence of the manufacturer.

Contact us. You can therefore be sure that the repair is carried out by trained service technicians who carry original spare parts.



Standard accessories

depending on model:

Aqua-Stop

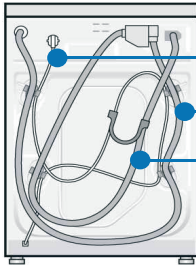

Standard/Aqua-Secure

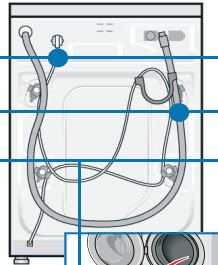

Mains cable

Water outlet

Water inlet



Instruction manual and
Installation instructions



Covers with hose clip

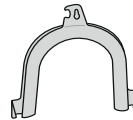

Elbow
for securing the
water outlet hose

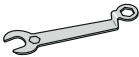

Spanner

Also required for connection of the water drainage hose to a siphon:

1 hose clip \varnothing 24–40 mm (DIY store) is also required for connection to a siphon. *Connecting the water* → Page 52

Useful tools:

- Spirit level for alignment.
- Socket wrench
 - size 13: for loosening the transportation protection devices → Page 48 and
 - size 17: for aligning the appliance feet. → Page 54

Hose and cable lengths

depending on model:

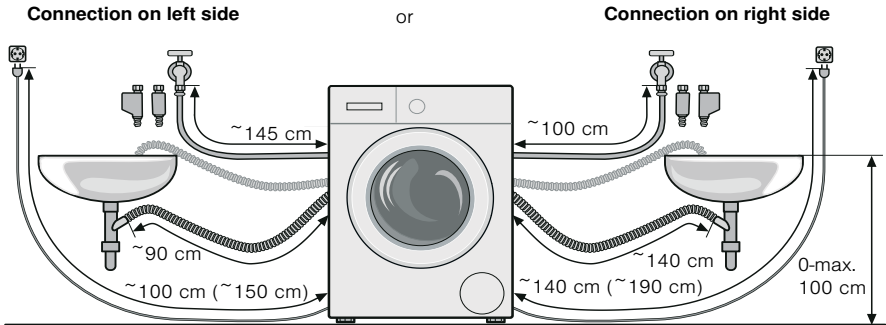

i If the hose holders are used, the possible hose lengths are reduced!

Available from dealer/customer service:

- Extension for Aqua-Stop or cold water inlet hose (approx. 2.50 m).
Order no. WMZ2380, WZ10130, CZ11350, Z7070X0
- Longer supply hose (approx. 2.20 m), for standard model.

Technical specifications

Dimensions (width x depth x height)	60 x 59 x 85 cm
Weight	depending on model: 63–83 kg
Mains connection	Nominal voltage 220–240 V, 50 Hz Nominal current 10 A Nominal power 2300 W
Water pressure	100–1000 kPa (1–10 bar)



Installation

i Humidity in the drum is caused by the final inspection.

Secure installation

⚠ Warning!

Risk of injury!

- The washing machine is heavy – caution: take care when lifting it.
- If the washing machine is raised by protruding components (e.g. washing machine door), the components may break off and cause injuries.
Do not lift the washing machine by its projecting parts.

⚠ Caution!

Risk of stumbling!

If the hoses and power cord are installed improperly, there is a risk of tripping and injury.

Lay hoses and cables in such a way that there is no risk of stumbling.

⚠ Caution!

Washing machine may be damaged!

- Frozen hoses may tear/burst.
Do not install the washing machine in an area where there is a risk of frost or outdoors.

- If the washing machine is raised by protruding components (e.g. washing machine door), the components may break off and the washing machine may be damaged.

Do not lift the washing machine by its projecting parts.

- i** - In addition to the safety information listed here, the local water and electricity supplier may have special requirements.
- If in doubt, have the appliance connected by a technician.

⚠ Warning!

Risk of injury!

- The washing machine is heavy – caution: take care when lifting it.
 - If the washing machine is raised by protruding components (e.g. washing machine door), the components may break off and cause injuries.
- Do not lift the washing machine by its projecting parts.

⚠ Caution!

Risk of stumbling!

If the hoses and power cord are installed incorrectly, there is a risk of tripping and injury.

Lay hoses and cables in such a way that there is no risk of stumbling.

⚠ Caution!

Washing machine may be damaged!

- Frozen hoses may tear/burst.

Do not install the washing machine in an area where there is a risk of frost or outdoors.

- If the washing machine is raised by protruding components (e.g. washing machine door), the components may break off and the washing machine may be damaged.

Do not lift the washing machine by its projecting parts.

- i** - In addition to the safety information listed here, the local water and electricity supplier may have special requirements.
- If in doubt, have the appliance connected by a technician.

Installation area

- i** Stability is important to prevent the washing machine from wandering!
 - The installation area must be firm and level.
 - Soft floors/floor coverings are not suitable.

Installing the appliance on a base or on a wooden joist ceiling

⚠ Warning!

Washing machine may be damaged!!

The washing machine may wander during the spin cycle and topple/fall off the base. Always secure the washing machine feet with fixing brackets.

Holding brackets: order no. WMZ 2200, WX 9756, CZ 110600, Z 7080X0

- i** If installing on a wooden joist ceiling:
 - If possible, install the washing machine in a corner.
 - Screw a water-resistant wooden panel (min. 30 mm thick) to the floor.

Appliance installed under/between kitchen units

⚠ Warning!

Danger of death from electric shock!

Danger of death if live parts are touched. The appliance cover plate must not be removed.

- i** - 60 cm cavity width required.
- Install washing machine only under a continuous worktop connected firmly to the adjacent cupboards.



Remove transportation protection devices

⚠ Caution!

Washing machine may be damaged!

Transit bolts which have not been removed may damage e.g. the drum while the washing machine is running.

Before using the appliance for the first time, remove the 4 transportation protection devices completely and keep in a safe place.

⚠ Caution!

Washing machine may be damaged!

To prevent damage in transit when transporting the washing machine subsequently, always re-install the transit bolts prior to transportation. → *Page 58*

Keep screw and sleeve screwed together.

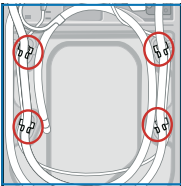
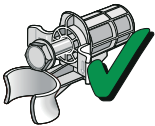

1. Take the hoses out of the holders.

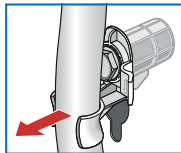

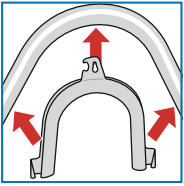

2. Take hoses out of the elbow and remove elbow.

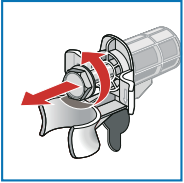

3. Loosen and remove all 4 transportation lock screws.

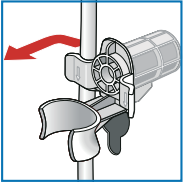

4. Take the power cord out of the holders. Remove sleeves.

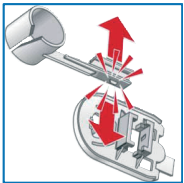
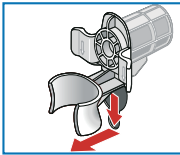

5. Prepare/separate cover.

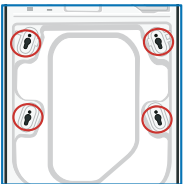

6. Insert covers.

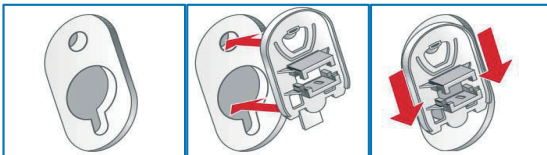

i Lock covers firmly by pressing on the locking hook.

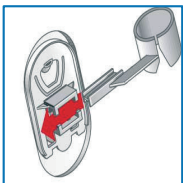

7. Insert hose holder.



8. Secure hoses in the hose holders.



Connecting the water

⚠ Warning!

Danger of death from electric shock!

Danger of death if live parts are touched.
Do not immerse Aqua-Stop safety device in water (contains an electric valve).

- i** – To prevent leakage or water damage, follow the instructions in this chapter!
- Operate the washing machine with cold drinking water only.
- Do not connect to the mixer tap of an unpressurised hot-water apparatus.
- Use only the supplied inlet hose or one purchased from an authorised specialist outlet, not a used one!
- If in doubt, have the appliance connected by a technician.

Water inlet hose

- i** Water inlet hose: do not kink, crush, modify or sever (strength is no longer guaranteed).

Optimum water pressure in the mains: 100–1000 kPa (1–10 bar)

- When the tap is turned on, the water flow is at least 8 l/min.
- If the water pressure is higher, install a pressure reducing valve.

1. Connect the water supply hose.

⚠ Warning!

Threads for screw connections may be damaged!

If the screw connections are tightened too tightly using a tool (pliers), the threads may be damaged.

Tighten plastic screw-fittings by hand only.

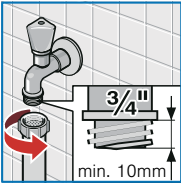

to the tap ($\frac{3}{4}'' = 26.4 \text{ mm}$):

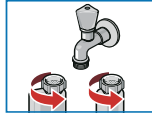
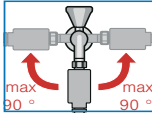

Aqua-Stop and Aqua-Secure Standard

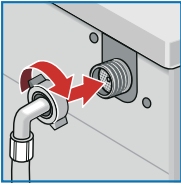

on the appliance:

for Standard and Aqua-Secure models



2. Carefully turn on the tap and check that the connection points are not leaking.

i Screw connection is under water pipe pressure.

Water drainage hose

- i**
- Do not kink or protract the the water drainage hose.
 - Height difference between the placement area and drainage point: 0–maximum 100 cm

Drainage into a wash basin

⚠ Warning!

Water damage possible!

If the attached drainage hose slips out of the washbasin due to high water pressure when draining the washing machine, leaking water may cause damage. Secure the drainage hose to prevent it from slipping out of the sink.

⚠ Caution!

The appliance may be damaged.

If the end of the drainage hose is immersed in the drained water, water may be drawn back into the appliance!

- The plug must not be in the plug hole.
- When the water is being pumped out of the washing machine, check that the water drains away quickly enough.
- The end of the drainage hose must not be immersed in the drained water!

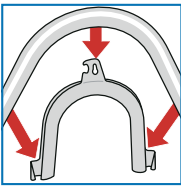

Installing the drainage hose:

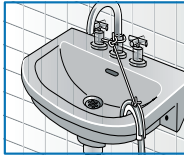

Drainage into a siphon

⚠ Warning!

Water damage possible!

If the drainage hose slips off the siphon connection due to high water pressure when draining the washing machine, leaking water may cause damage.

Connection point must be secured with hose clip, Ø 24–40 mm (specialist outlet).

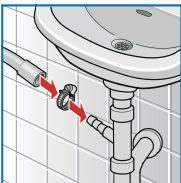

Connecting

Drainage into a plastic pipe with rubber sleeve or into a gully:

⚠ Warning!

Water damage possible!

If the drainage hose slips off the plastic pipe due to high water pressure when draining the washing machine, leaking water may cause damage.

Secure the drainage hose to prevent it from slipping out of the sink.



Connecting



Alignment

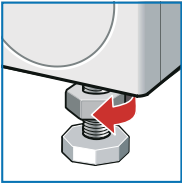

1. Loosen lock nut in a clockwise direction with a wrench.



2. Check alignment of the washing machine with a spirit level and, if required, correct. Adjust the height by rotating the foot.

i All four feet must be firmly on the floor.
The washing machine must not wobble!

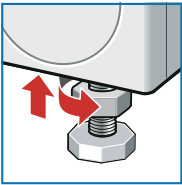

3. Tighten the lock nut against the housing.
Grip the foot and do not adjust the height.

i – The lock nuts on all four appliance feet must be screwed tightly against the housing!
– Loud noise formation, intense vibrations and “wandering” may be due to incorrect alignment!



Electrical connection

Electrical safety

⚠ Warning!

Danger of death from electric shock!

Danger of death if live parts are touched.

- Never pull out the mains plug by tugging the power cord.
- Insert/pull out the mains plug with dry hands only.
- Never pull out the mains plug during operation.
- Connect the washing machine to an alternating current via a correctly installed earthed socket only.
- The mains voltage and voltage specifications on the washing machine (appliance rating plate) must match.
- Connected load as well as required fuse are indicated on the appliance rating plate.

Ensure that:

- Mains plug and socket match fit.
- Cable cross-section is adequate.
- Earthing system has been installed correctly.
- A damaged power cord may be replaced by an electrician only. A replacement mains cable can be obtained from customer service.
- Do not use multiple plugs/couplings or extension cables.

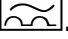
- If a residual-current-operated circuit breaker is used, use only a type which features this symbol: . Only this symbol guarantees compliance with currently valid regulations.
- The mains plug must be accessible at all times.



Before the 1st washing

The washing machine was inspected thoroughly before leaving the factory. To remove any water left over from testing procedures, the first washing cycle should be carried out **without** laundry in the machine.

i The washing machine must have been installed and connected properly. See chapter *Installing* → *Page 54*

1. Check the machine.

i Never switch on a damaged machine. Inform your customer service. → *Page 41*

2. Remove protective film from the fascia.

3. Insert mains plug.

4. Turn the tap on.

5. Switch on the appliance.

6. Close the washing machine door. Do not load any washing.

7. Select the **Cottons** programme.

8. Select the temperature **90 °C**.

9. Open the detergent drawer.

10. Pour approx. 1 litre of water (1¾ pt) into dispenser **II**.

11. Add standard detergent to dispenser **II** according to manufacturer's instructions for light soiling.

i To prevent frothing, use only half the recommended amount of detergent. Do not use any standard or mild detergents.

12. Close the detergent drawer.

13. Select **Start/Reload ▶II**.

14. When the programme ends, switch off the appliance.

Your washing machine is now ready for use.



Transportation, e.g. if moving house

Preparatory work

1. Turn off the tap.
2. Release the water pressure in the supply hose.
Maintenance – Filter in the water inlet hose
3. Drain any residual detergent solution.
Maintenance – Drain pump blocked → Page 34
4. Isolate the washing machine from the power supply.
5. Remove the hoses.

Installing transportation protection devices

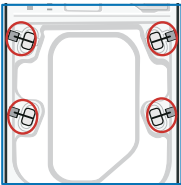

1. Remove covers and keep in a safe place.

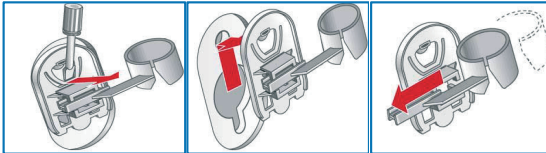

If required, use a screwdriver.

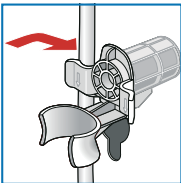

2. Insert all 4 sleeves.

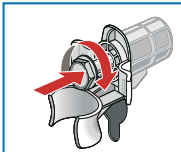

Clamp mains cable on the holders. Insert and tighten the bolts.

Before switching on the appliance:

- i** – **Remove** the transportation protection devices! → *Page 48*
- To prevent unused detergent from flowing into the outlet during the next wash: Pour 1 litre of water into dispenser **II** and start the **Drain** programme.

Index

- A** Alignment, 54
- B** basic settings 3 sec., 11, 30
Button
 Easy-Iron, 11, 17, 27
 EcoPerfect, 11, 17, 27
 Extra Rinse, 11, 17, 28
 Finished in, 11, 16, 27
 Pre-wash, 11, 17, 28
Rinse Hold, 11, 17, 17, 28
SpeedPerfect, 11, 17, 27
Spin, 11, 16, 27
Start/Reload, 11
Temperature, 11, 16, 27
Buttons
 basic settings 3 sec., 11
- C** Cancelling
 the programme, 21
Care, 33
 Drum, 33
 Machine housing/Control panel, 33
Changing
 the programme, 20
Childlock, 20, 27
Cleaning
 the detergent drawer, 34
 the filter, 36
 the siphon, 35
Connecting the water, 50
 Water drainage, 51
 Water supply, 50
Consumption values, 29
Customer service, 41
- D** Descaling, 34
Detergent drawer, 10
Discolouring, 26
Display panel, 11
Dosing recommendation, 32
Drain pump blocked, 34
Drum light, 14
Dyeing, 26
- E** Easy-Iron, 11, 17, 27
EcoPerfect, 11, 17, 27
Electrical connection, 55
Emergency lock release, 37
End of the programme, 21
Extra Rinse, 11, 17, 28
- F** Fascia, 11
Faults, what to do?, 39
Finished in, 11, 16, 27
- G** Getting to know your
 appliance, 9
- H** Hints and tips, 8
Hose and cable lengths, 43

I	Information on the display panel, 38 Inserting the laundry, 14, 15, 16	Installation, 44 Installing transportation protection devices, 58 Intended use, 4
L	Load adjust, 32	Load sensor/Load display, 32
M	Maintenance, 33	
O	Old appliance, 8	
P	Packaging, 8 Pre-wash, 11, 17, 28 Programme overview, 23 Programme selector, 11	Programme sequence, 19 Programme settings, 16, 23, 27 Protection of the environment, 8
Q	Quick-reference	instructions, 12
R	Rinse Hold, 11, 17, 21, 28	
S	Safety instructions, 5 Selecting the programme, 15 Settings 3 sec., 30 Soaking, 26 Sorting the washing, 13	SpeedPerfect, 11, 17 SpeedPerfect , 27 Spin, 11, 16, 27 Standard accessories, 42 Starching, 26 Starting the programme, 18
T	Technical specifications, 43 Temperature, 11, 16, 27 Topping up	the laundry, 20 Transport bolts, 48
U	Unbalanced load detection system, 32	Unloading the laundry, 22

Aqua-Stop warranty

For appliances with Aqua-Stop only

In addition to warranty claims against the seller based on the contract of sale and in addition to our appliance warranty we shall pay damages under the following conditions:

1. If water damage is caused by a fault in our water safety system, we shall make reparation for the damage with respect to private users.
2. The liability warranty applies to the service life of the appliance.
3. A claim can only be made under the warranty if the appliance and Aqua-Stop have been correctly installed and connected according to our instructions; this also includes a correctly installed Aqua-Stop extension (original accessory).
4. Our guarantee does not apply to defective cables/hoses or to fittings up to the connection on the tap.
5. Appliances which feature Aqua-Stop can be left unattended during operation and it is not necessary to turn off the tap afterwards.
6. The tap should only be turned off if you are away for a prolonged period, e.g. several weeks holiday.

To book an engineer visit and product advice

GB 0844 8928979 Calls from a BT landline will be charged at up to 3 pence per minute.

IE 01450 2655

Please find the contact data of all countries in the enclosed customer service list.



Robert Bosch, Hausgeräte GmbH
Carl-Wery-Straße 34
81739 München
DEUTSCHLAND

9000758520 (9202)

Free Manuals Download Website

<http://myh66.com>

<http://usermanuals.us>

<http://www.somanuals.com>

<http://www.4manuals.cc>

<http://www.manual-lib.com>

<http://www.404manual.com>

<http://www.luxmanual.com>

<http://aubethermostatmanual.com>

Golf course search by state

<http://golfingnear.com>

Email search by domain

<http://emailbydomain.com>

Auto manuals search

<http://auto.somanuals.com>

TV manuals search

<http://tv.somanuals.com>