

# Kodak ADVANTIX



## 4100ix zoom Camera



Download from [Www.Somanuals.com](http://www.Somanuals.com). All Manuals Search And Download.



Look for this logo to be certain that the film you buy is made for this camera.



Look for this logo to select a certified photofinisher for developing your film and to assure that you get all the features of the Advanced Photo System.

### Film Status Indicator (FSI)

A highlighted indicator advances from one symbol to another to identify the status of the film inside the cassette.

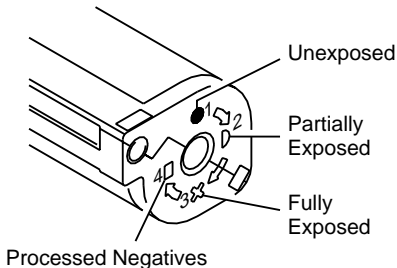

- 2 See inside cover flaps of manual for camera diagrams.  
Download from [Www.Somanuals.com](http://www.Somanuals.com). All Manuals Search And Download.

**Need help with your camera or more information about the new Advanced Photo System? Call Kodak (United States only) toll free from 9:00 a.m. to 7:00 p.m. (Eastern time ) Monday through Friday at 1 (800) 242-2424. The toll free number (in Canada only) from 8:30 a.m. to 5:00 p.m. (Eastern time) Monday through Friday is 1 (800) 465-6325; please ask for ext. 36100.**

---

**For warranty purposes, please keep your sales receipt as proof of the date of purchase.**

**This device complies with part 15 of the FCC Rules. Operation is subject to the following two conditions: (1) This device may not cause harmful interference, and (2) this device must accept any interference received, including interference that may cause undesired operation.**

**NOTE:** Your model camera has been tested and found to comply with the limits for a Class B digital device, pursuant to Part 15 of the FCC Rules. These limits provide reasonable protection against interference in residential use. The camera generates, uses and can radiate radio frequency energy and, if not used in accordance with the instructions, may cause interference to radio communications. There is no guarantee that interference will not occur. If this camera does cause interference to radio or television reception, which can be determined by turning the camera off and on, you may reduce the interference by the following:

- Reorient or relocate the receiving antenna.
- Increase the separation between the camera and the receiver.
- Consult the dealer or an experienced radio/television technician for help.

Changes or modifications not approved by the party responsible for compliance could void the user's authority to operate the equipment.

This Class B digital apparatus meets all requirements of the Canadian Interference-Causing Equipment Regulations.

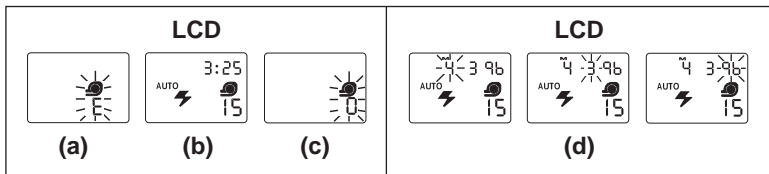
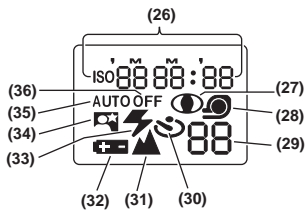
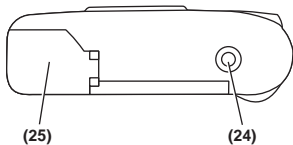
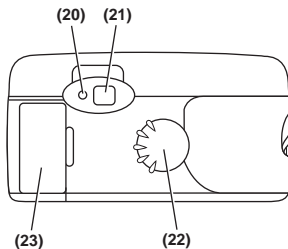
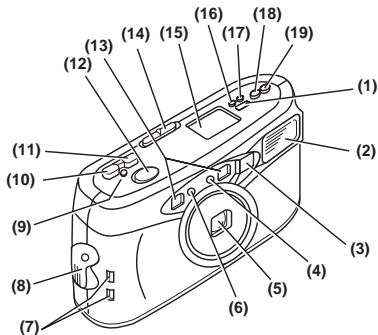

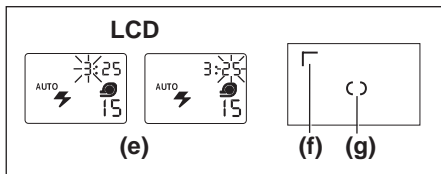
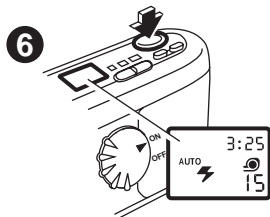
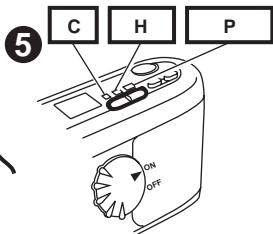
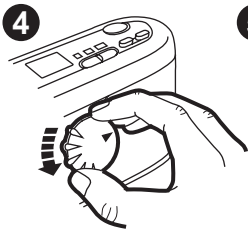
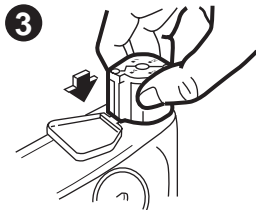
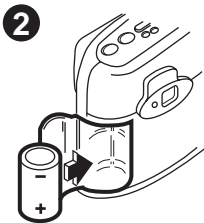
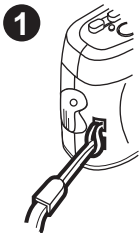

## **CAMERA IDENTIFICATION**

See inside cover flaps of manual for camera diagrams.

- |   |   |
|---|---|
| <b>(1)</b> Date-Menu Button                     | <b>(19)</b> Flash-Mode Button                         |
| <b>(2)</b> Flash                                | <b>(20)</b> Flash-Indicator Lamp                      |
| <b>(3)</b> Viewfinder                           | <b>(21)</b> Viewfinder Eyepiece                       |
| <b>(4)</b> Self-Timer/Red-Eye-Reduction Lamp    | <b>(22)</b> On/Off Dial                               |
| <b>(5)</b> Lens                                 | <b>(23)</b> Battery Door                              |
| <b>(6)</b> Meter-Cell Window                    | <b>(24)</b> Tripod Socket                             |
| <b>(7)</b> Strap Post                           | <b>(25)</b> Film Door                                 |
| <b>(8)</b> Film Door Latch                      | <b>(26)</b> Date & Time/ISO Film-Speed Display        |
| <b>(9)</b> Rewind Button                        | <b>(27)</b> Red-Eye-Reduction Indicator               |
| <b>(10)</b> Tele-Mode Button                    | <b>(28)</b> Film-Presence Indicator                   |
| <b>(11)</b> Wide-Mode Button                    | <b>(29)</b> Frame Counter/No Film in Camera Indicator |
| <b>(12)</b> Shutter Button                      | <b>(30)</b> Self-Timer Indicator                      |
| <b>(13)</b> Focus-Ranging Sensors               | <b>(31)</b> Infinity-Focus Indicator                  |
| <b>(14)</b> Print-Size Selector                 | <b>(32)</b> Battery Symbol                            |
| <b>(15)</b> LCD Panel                           | <b>(33)</b> Fill-Flash Indicator                      |
| <b>(16)</b> Date-Enter Button                   | <b>(34)</b> Nighttime-View Indicator                  |
| <b>(17)</b> Date-Select Button                  | <b>(35)</b> Auto-Flash Indicator                      |
| <b>(18)</b> Self-Timer/Red-Eye-Reduction Button | <b>(36)</b> Flash-Off indicator                       |

## BATTERY

This camera uses a 3-volt lithium KODAK K123LA (or equivalent) Battery that supplies power for all camera operations.

### ***Low-Battery Indicator***

It's time to replace the battery when—

- the battery symbol **(32)** “blinks” on the LCD panel **(15)**.
- all indicators on the LCD panel disappear and the shutter button **(12)** cannot be released.

### **Battery Tips:**

- **Keep spare batteries with you at all times. Lithium batteries perform consistently until they suddenly die.**
- Read and follow all warnings and instructions supplied by the battery manufacturer.
- Keep batteries away from children.
- Do not attempt to disassemble, recharge or short circuit the battery, or subject it to high temperature or fire.
- Store batteries in their original packaging prior to use.

## SETTING THE DATE OR TIME

With this camera, you can record the date (month/day/year, day/month/year or year/month/day) or time (hour/minute) of each exposure directly onto the film. The information appears on the back of your prints when processed. It features a clock (24-hour time display) and automatic calendar that includes leap years.

1. Press the date-menu button **(1)** to select the desired data type for date or time settings or select dashes for no databack information.
2. Press the date-select button **(17)** in succession to select the “blinking” month, day, or year **(d)** or hour or minute **(e)**.
3. Press the date-enter button **(16)** to change the data.
4. Press the date-select button to complete the setting.

## LOADING THE FILM

1. Turn the film-door latch **(8)** to the “open” position.
2. Insert the film cassette **completely** into the film chamber **③**. **Do not force the film cassette into the film chamber.**
3. Close the film door **(25)** to start the auto-film advance. The LCD panel **(15)** shows the number of exposures **(b)**.

**NOTE: After you close the safety-interlock film door, you cannot open the film door until the film is completely rewound into the film cassette.**

## TAKING PICTURES

You can take Classic (C), HDTV (H), and Panoramic (P) pictures on the **same film cassette**. **Your photo-processing cost will be based on the format sizes(s) that you use to expose the film** (see table on page 5).

1. Turn the on/off dial **(22)**, **④** counterclockwise to the ON position.
2. Move the print-size selector **(14)**, **⑤** to the desired format (C, H, or P).
3. Look through the viewfinder eyepiece **(21)** and place the auto-focus circle **(g)** on the subject. For a sharp picture, **stand at least 2 ft (0.60 m) from your subject**. When your subject is closer than 2.6 ft (0.8 m) with the lens in the 30 mm position, or closer than 5 ft (1.5 m) with the lens in the 60 mm position, compose your picture using the close framing guide **(f)** in the viewfinder
4. Press the shutter button **(12)**, **⑥** to take the picture.



## Typical Print Sizes

C	H	P
Classic	Group (HDTV)	Panoramic
3 1/2 x 5" or 4 x 6" (88.9 x 127 mm or 102 x 152 mm)	3 1/2 x 6" or 4 x 7" (88.9 x 152 mm or 102 x 178 mm)	3 1/2 x 8 1/2" to 4 x 11 1/2" (88.9 x 216 mm to 102 x 292.7 mm)

## Using the Zoom Lens

This camera has a power-zoom lens that lets you select the ideal lens-focal length for taking pictures. When you turn the camera on, it is initially set to the wide-angle position.

1. Turn the on/off dial **(22)**, **(4)** counterclockwise to the ON position.
2. Press the tele-mode button **(10)** to zoom *closer* to the subject or the wide-mode button **(11)** to zoom *away* from the subject.
3. Press the shutter button **(12)**, **(6)** to take the picture.

**NOTE:** If the lens barrel remains in the tele-mode position, it will automatically return to the wide-mode position after approximately 3 minutes.

## Using the Focus Lock

This camera automatically focuses on whatever is within the auto-focus circle of the viewfinder eyepiece. To get a sharp photograph, make sure the auto-focus circle is on your main subject. If you want to take a picture with the subject positioned outside of the auto-focus circle, use the focus lock as follows:

1. Place the auto-focus circle **(g)** on the subject that you want focused in the picture.
2. Partially depress and **hold** the shutter button **(12)** to lock the focus position.
3. **While still partially depressing the shutter button**, move the camera until your subject is where you want it within the viewfinder eyepiece **(21)**.
4. Press the shutter button **completely** down to take the picture.

### ***Using the Self-Timer***

You can include yourself in pictures by using the self-timer feature.

1. Use a tripod (tripod socket **[24]**) or place the camera on another firm support.
2. Turn the on/off dial (**22**), **4** counterclockwise to the ON position.
3. Press the self-timer/red-eye-reduction button (**18**) twice to move to the self-timer position. Make sure the self-timer indicator (**30**) appears on the LCD panel (**15**).
4. Press the shutter button (**12**). The self-timer lamp (**4**) “blinks” approximately 10 seconds before the picture is taken.

**NOTE:** If you want to stop the self-timer operation before the picture is taken, turn the camera off.

### **Tips for Better Pictures**

- Hold the camera **steady** when taking pictures
- Move close enough to your subject so it fills the viewfinder **but not closer than 2 ft (0.60 m)**.
- Take pictures at the subject’s level. Kneel down to take pictures of children and pets.
- Hold your camera vertically to capture tall, narrow subjects, such as a waterfall, skyscraper, or single person.
- Add interest to your picture by framing it with a tree branch, window, or even the rails of a fence.
- Keep the sun behind you for best subject illumination.

## TAKING FLASH PICTURES

In dim light, such as indoors or outdoors in heavy shade or on dark overcast days, you need flash. Your camera features automatic flash that fires when you need it. It also provides automatic daylight fill flash under certain bright-light conditions where shadows may exist. When you partially depress the shutter button **(12)** and the flash-indicator lamp **(20)** glows red, the flash is fully charged and ready for picture-taking (see table below for other **Flash-Lamp Signals** and page 8 for the recommended **Flash-to-Subject Distance**).

### *Flash-Lamp Signals*

<b>Lamp Indicator*</b>	<b>Situation</b>
Glows red	Flash fully charged. Okay to take the picture.
"Blinks" red continuously	Flash not fully charged. Wait for the lamp to glow red before you take the picture.
"Blinks" red momentarily	Flash not required. Okay to take the picture.

\* The flash-indicator lamp can be viewed when you partially depress the shutter button.

### ***Flash-to-Subject Distance***

<b>ISO Film Speed</b>	<b>Wide (30 mm)</b>	<b>Tele (60 mm)</b>
50	2 to 14 ft (0.60 to 4.3 m)	2 to 7 ft (0.60 to 2.1 m)
100	2 to 19 ft (0.60 to 5.8 m)	2 to 10 ft (0.60 to 3.1 m)
200	2 to 27 ft (0.60 to 8.2 m)	2 to 14 ft (0.60 to 4.3 m)
400	2 to 38 ft (0.60 to 11.6 m)	2 to 19 ft (0.60 to 5.8 m)
800	2 to 53 ft (0.60 to 16.2 m)	2 to 27 ft (0.60 to 8.2 m)
1600	2 to 74 ft (0.60 to 22.6 m)	2 to 38 ft (0.60 to 11.6 m)

### ***Using the Red-Eye Reduction***

Some people's eyes (and some pets') can reflect flash with a red glow. To minimize red eyes in flash or fill-flash pictures, use the red-eye reduction.

1. Turn the on/off dial **(22)**, **(4)** counterclockwise to the ON position.
2. Press the self-timer/red-eye-reduction button **(18)** once to move to the red-eye-reduction position. Make sure the red-eye-reduction indicator **(27)** appears on the LCD panel **(15)**.
3. Have your subject look directly at the red-eye-reduction lamp **(4)**.
4. Press the shutter button **(12)** to take the picture.
5. To exit from the red-eye-reduction mode, press the self-timer/red-eye-reduction button twice or turn the camera off.

### ***Using Infinity Focus, Flash Off, Fill Flash, and Nighttime View***

*Infinity Focus*—To capture sharp, distant scenery, use the infinity-focus mode.

*Flash Off*—When you do not want to use the flash, especially indoors where flash is prohibited, such as in theaters and museums, or in dim lighting situations, use flash off. Use a tripod (tripod socket **[24]**) or place the camera on another firm support.

*Fill Flash*—Bright light indoors or outdoors from backlit subjects can create dark shadows (especially on faces) in high-contrast scenes. Use fill flash to lighten these shadows.

*Nighttime View*—To lighten your subject in front of a night scene, use the nighttime-view mode.

1. Turn the on/off dial **(22)**, **④** counterclockwise to the ON position.
2. Press the flash-mode button **(19)** to select infinity focus **(31)**, flash off **(36)**, fill flash **(33)**, or nighttime view **(34)**.
3. Press the shutter button **(12)** to take the picture.
4. Press the flash-mode button to return to the auto-flash/start position **(35)**.

### ***Flash Tips***

- Turn on room lights and have the subject face the lights to minimize red eyes in pictures.
- Stand at an angle to shiny surfaces like windows or mirrors to avoid flash reflection and bright spots in your pictures.
- Keep your fingers and other objects away from the picture-taking lens, flash, and meter-cell window to avoid dark or light pictures.

### **UNLOADING THE FILM**

When the film is fully rewound, the film cassette symbol and 0 **(c)** blink on the LCD panel **(15)**. **Do not remove the film from the camera until the film is FULLY rewound.** When you remove the film cassette from the camera, the cassette symbol and E **(a)** blink.

### ***Using the Rewind Button***

If you don't want to take pictures on the entire film cassette, you can automatically rewind the film by pressing the rewind button **(9)**. **Once you've used this feature, you cannot reload the same film cassette into the camera.**

## TROUBLESHOOTING

<b>What happened</b>	<b>Probable cause</b>	<b>Solution</b>
Camera will not operate	There are no more pictures remaining Battery weak, dead, missing, or improperly loaded	Remove the film Replace or reload the battery
Film does not advance or rewind	Battery weak, dead, missing, or improperly inserted	Replace or reload the battery
LCD panel is blank	(see above cause)	(see above solution)
Film rewinds at beginning of film load or middle of cassette (empty cassette symbol [28] "blinks" on LCD panel)	Camera transport or film cassette problem	Load another film cassette into camera Call Kodak for assistance



<b>What happened</b>	<b>Probable cause</b>	<b>Solution</b>
Film does not load properly in camera	Loaded exposed, partially exposed, or processed film into the camera	Load only unexposed film into the camera
All LCD indicators "blink"	Camera mechanism problem	Press shutter button or turn the camera off and on
Film-door latch does not open	Film is not rewound into the cassette completely	Complete taking pictures or press the rewind button <b>(9)</b>

## SPECIFICATIONS

**Film Type:** KODAK ADVANTIX Film for color prints

**Lens:** 30–60 mm zoom lens, *f*/4.5 to *f*/8.5 glass hybrid aspheric

**Focus System:** 80 zone, active AF with focus lock

**Viewfinder:** Real image with C, H, & P format display; AF indicator

**Film-Speed Range:** DXIX (ISO) 50–1600 for color print films

**Flash Unit:** Auto flash, flash off, fill flash, & nighttime view

**Focus Range:** Daylight: 2 ft (0.60 m) to infinity

**Apertures:** *f*/4.5–*f*/8.5

**Shutter:** Programmed electronic; speeds from 1/6 to 1/270 sec.

**Power Source:** one 3-volt lithium KODAK K123LA (or equivalent) Battery

**Dimensions:** Approx. 4.86 x 2.56 x 1.53 in. (123.5 x 64.1 x 39 mm)

**Weight:** Approx. 8.11 oz (230 g) without battery and film

Kodak, Advantix, and the Advanced Photo System  
symbol and logotype are trademarks.



Consumer Imaging  
**EASTMAN KODAK COMPANY**  
**Rochester, NY 14650**

© Eastman Kodak Company, 1995

Pt. No. **914 7695**  
CAT **8008633**

Minor Revisions 7/97  
Printed in U.S.A.

## Free Manuals Download Website

<http://myh66.com>

<http://usermanuals.us>

<http://www.somanuals.com>

<http://www.4manuals.cc>

<http://www.manual-lib.com>

<http://www.404manual.com>

<http://www.luxmanual.com>

<http://aubethermostatmanual.com>

Golf course search by state

<http://golfingnear.com>

Email search by domain

<http://emailbydomain.com>

Auto manuals search

<http://auto.somanuals.com>

TV manuals search

<http://tv.somanuals.com>