

SYSTEM 8: Audiophile Single-Subwoofer System

This is a perfect setup for the customer who wants the highest levels of sound quality but is not interested in huge bass.

The single 12W3 in the CS112-W3 provides strong output and excellent bass quality without taking up a ton of trunk space. It's driven by a 250/1 monoblock.

The four XR systems (XR650-CS in the front, XR650-CX in the rear) are cleanly driven by the 300/2.

This system is shown connected to a single pair of line level outputs at the head unit. In this configuration, front-to-rear fading is not possible and subwoofer level must be carefully preset.

Recommended initial amplifier settings for this system...

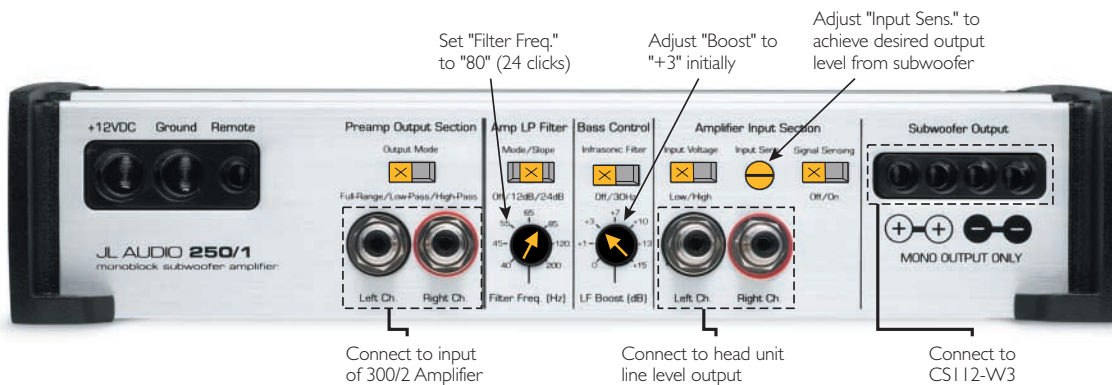

☞ ☒ ☞ = POSITION

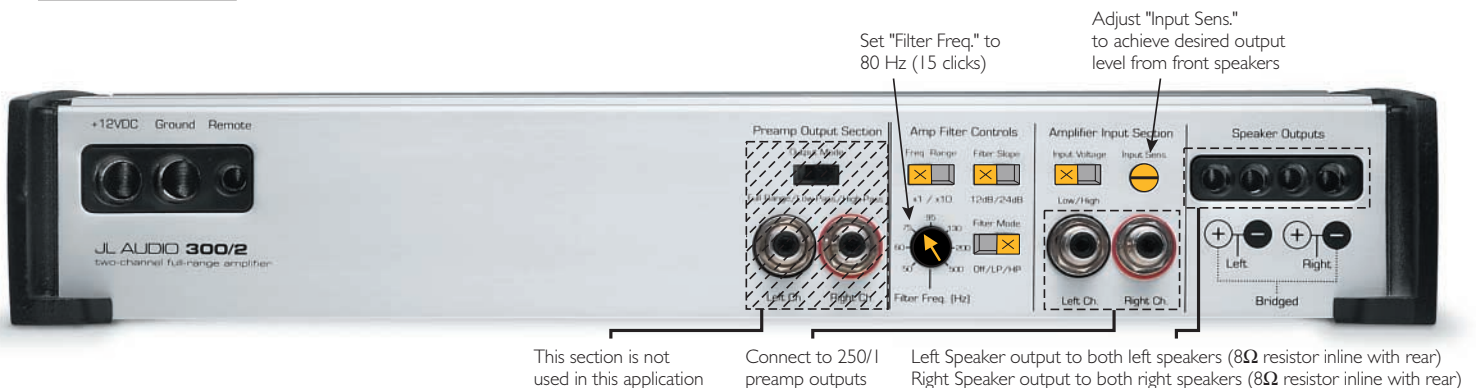

Note: These settings are intended as a "baseline" for tuning this system. Depending on the vehicle and the customer's tastes, some variation in the crossover and bass control settings may be necessary for optimum performance.

JL AUDIO
Ahead of the Curve™

Free Manuals Download Website

<http://myh66.com>

<http://usermanuals.us>

<http://www.somanuals.com>

<http://www.4manuals.cc>

<http://www.manual-lib.com>

<http://www.404manual.com>

<http://www.luxmanual.com>

<http://aubethermostatmanual.com>

Golf course search by state

<http://golfingnear.com>

Email search by domain

<http://emailbydomain.com>

Auto manuals search

<http://auto.somanuals.com>

TV manuals search

<http://tv.somanuals.com>