



Operator's Manual & Illustrated Parts List

AERATOR

MTD #	DESCRIPTION
DA528	Aerator 30 w/Briggs & Stratton 5 HP Engine w/ Closed Spoons
00029316	Set of 30 Open Spoons
00029393	Set of 30 Closed Spoons

FORWARD

The MTD Aerator-30 should only be operated and maintained by thoroughly trained individuals. The machine can cause serious injury to anyone who misuses the machine or does not understand its operation. All operators and maintenance personnel must read this entire manual for their personal safety. **Note: Safety goggles should be worn when operating or maintaining this machine.**

This manual presents the safety and operating instructions and parts breakdown necessary to keep your MTD Aerator-30 at peak efficiency. If properly operated and maintained, your MTD Aerator-30 will give dependable service.

MTD PRODUCTS INC. P.O. BOX 368022 CLEVELAND, OHIO 44136-9722

PRINTED IN U.S.A.

1. FOREWORD

Your Aerator should only be operated and maintained by thoroughly trained individuals. The machine can cause serious injury to anyone who misuses the machine or does not understand its operation. All operators and maintenance personnel must read this entire manual for their personal safety.

Note: Safety goggles should be worn when operating or maintaining this machine.

2. SAFETY INSTRUCTIONS

1. The operator should have access to this manual at all times.
2. Do not operate this machine until you have read this entire manual thoroughly.
3. Make sure all guards are in place before starting this machine.
4. **Never** put hands or feet under the machine housing, except for maintenance. Always use handles when lifting.
5. Make certain the belt tensioner is not engaged when starting the engine.
6. Never stand in front of the machine while the engine is running.
7. **CAUTION: The machine may start suddenly when the belt tensioner is engaged. Start machine at low throttle and gradually increase to desired operating speed.**
8. If a breakdown occurs, shut off the machine immediately and do not restart until repairs are made.
9. Do not adjust the machine or perform any maintenance functions while the engine is running.
10. Never run the engine in an area without proper ventilation.
11. Gasoline is extremely dangerous and flammable. Do not permit open flames or sparks near the engine at any time.
12. Remove all foreign objects in the path of the aerator.
13. Do not run the aerator under low hanging limbs which will interfere with the operator.
14. When transporting the unit, always push the unit from behind.
15. When parking the aerator a slope, shut off engine, lower tines, and engage the belt tensioner. Never leave the aerator on a slope in the transport mode.
16. **CAUTION: Do not exceed manufacturer's recommended tire pressure. Failure to comply may cause tire to explode.**
17. Altering this machine in any way may cause injury to the operator or bystanders.

3. PREPARATION AND ASSEMBLY

1. Install the spoons using two 3/8"-16 x 1-3/4" capscrews, 3/8" lockwashers, and 3/8" hex nuts per spoon. This hardware is provided.
2. Mount the handle using the 3/8"-16 x 1" capscrews, 3/8" lockwashers, and 3/8" hex nuts provided.
3. Mount the front support assembly using the spring pins provided.
4. Mount the tensioner rod as follows. Attach the tensioner rod yoke (Ref. No. 16) to the center hold of the belt tensioner (Ref. No. 20) using the clevis pin (Ref. No. 17) and cotter pin (Ref. No. 13). Standing behind the aerator in the operating position, fit the end of the tensioner rod (Ref. No. 14) through the hole in the belt tensioner handle (Ref. No. 11) from left to right. Pull handle toward you and you should feel firm pressure as the tensioner pulley contacts the V-belt and the handle pulls the tensioner rod over center to lock. If you don't feel firm

pressure or if there is too much pressure, remove the rod from the handle and loosen the nut (Ref. No. 15). Turn the rod clockwise to increase the pressure or counterclockwise to decrease the pressure. Retighten the nut (Ref. No. 15) and again fit the rod through the hole in the handle. Further adjustments can be made by moving the tensioner rod yoke (Ref. No. 16) to the upper or lower hole in the belt tensioner (Ref. No. 20). When the adjustments are complete, place a cotter pin (Ref. No. 13) through the hole in the end of the tensioner rod that fits through the hole in the belt tensioner handle (Ref. No. 11).

5. Mount the throttle cables as follows. The throttle lever is bolted to a bracket on the right side of the aerator handle. The lever should be mounted on the inside of the handle so that when the lever is pushed down, it pulls on the throttle wire. Two 10-24 x 1/2" round head machine screws with locknuts are used to mount the throttle lever. The other end of the throttle wire is bent in an "S" shape. It should be hooked into the speed control lever on the engine under the gas tank. The speed control lever pivots in a quarter moon-shaped slot and when moved all the way to the left, is on idle and when moved to the right, increases engine speed. To mount, the throttle lever should be all the way up and the speed control lever moved all the way to the left. Then the throttle wire casing should be clamped to the right side of the speed control frame using the screw and clamp provided on the engine.
6. Check the engine oil and gear reduction oil levels. Always adjust the aerator so that the engine is sitting level when checking oil levels. Add oil if necessary. Refer to the engine manual for proper engine maintenance.
7. Fill the gas tank with regular, lead-free gasoline.

4. OPERATING INSTRUCTIONS PRIOR TO EACH DAY'S USE

1. Check engine oil and gear reduction oil levels.
2. Lubricate all grease fittings (4 wheels, 2 caster wheel yokes, spoon disc and shaft assembly and jackshaft bracket).
3. Check belt and chain tension.
4. Check and tighten all nuts and bolts as necessary.
5. Consult engine owners manual for proper oil change and air filter maintenance schedule.

5. TO START THE AERATOR

1. Disengage the belt tensioner.
2. Turn the engine switch to "on" and start the engine.
3. Adjust the throttle to a low RPM, firmly grip the handle and engage the belt tensioner.
4. To shut off the machine, disengage the belt tensioner and turn the engine switch to "off".

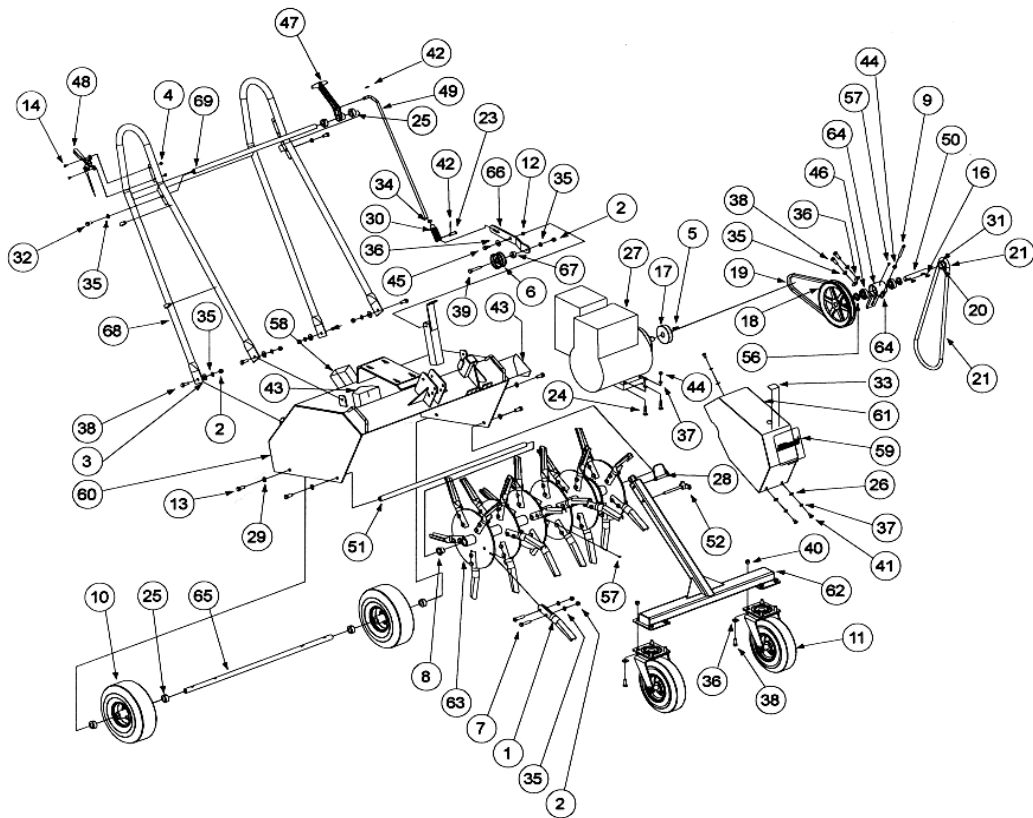

1	00002674	Open Spoon 1/2"	30	36	00012158	Flat Washer, 3/8, SAE, Yellow Zinc	11
2	00006131	Hex Nut, 3/8-16	65	37	00012168	Lock Washer, 5/16, Zinc	7
3	00006168	Flat Washer, USS 3/8 Zinc	4	38	00012171	HHCS, Standard, 3/8-16 x 1, Zinc	14
4	00006194	Lock Nut, Nylon Insert, #10-24	2	39	00012172	HHCS, Standard, 3/8-16 x 2, Zinc	1
5	00006246	Key, 3/16" x 1"	1	40	00012173	Lock Nut, Nylon Insert, 3/8-16	8
6	00006519	Idler, Flat 3616	1	41	00012178	HHCS, Standard, 5/16-18 x 1/2, Zinc	3
7	00008495	Capscrew, 3/8-16 x 1-3/4"	60	42	00012204	Cotter Pin, 3/32 x 3/4, Zinc	2
8	00008646	Bushing, Flange, Sintered, Bronze	2	43	00013311	Decal, Rotary "Danger-Keep Hands"	2
9	00008666	Cap Screw, Square Head, 5/16-18 x 2-1/2	1	44	00013433	Hex Nut, 5/16-18, Yellow	5
10	00008679	Rear, Wheel, 410/350 x 4-2Ply, White	2	45	00013733	Shoulder Bolt, Socket, 3/8 x 3/8 Zinc	1
11	00008700	Caster Wheel	2	46	00017633	Bearing, Single, Seal, 1630-RS	2
12	00008720	Bushing, 1/2 x 3/8 x 1/4, Bronze	1	47	00020282	Handle, Throw-Out	1
13	00008724	HHCS, 7/16-14, 1, Yellow Zinc	4	48	00020326	Throttle Cable	1
14	00008745	Screw, Round Head, Machine, 10-24 x 1/2	2	49	00020330	Belt Tensioner Rod, Zinc Plated	1
15	00008755	Clamp, To Hold Tubing on Handle	2	50	00020334	Jackshaft Complete	1
16	00008792	Woodruff Key, 3/16 x 3/4, #606	2	51	00020340	Reel Shaft	1
17	00009552	Small Pulley	1	52	01000377	Pin, Release Quick 3/8 Dia X3.	1
18	00009553	Large Pulley	1	53			
19	00009557	V Belt	1	54	00051484	Plate Base	1
20	00009599	Sprocket, 40BS-10 x 3/4" BOR	1	55	00051485	Carton Top Cap & Top Frame	1
21	00009625	Chain #40 W/Master Link	1	56	00060017	Flat Washer, .06, .776, 1.25, SS	2
22	00009650	Master Link, #40	1	57	00060078	Grease Fitting, 1/4-28 x 3/16 STR	2
23	00009678	Clevis Pin, 3/8 x 1 1/8, Zinc	1	58	00090006	Decal, "Made In America"	1
24	00009708	Carrige Bolt, 5/16-18 x 1-1/2	4	59	01002139	Decal, "MTD PRO"	1
25	00009748	Shaft Color, .760" x Bore w/SS Plate	6	60	01002393	Housing Assembly	1
26	00009812	Flat Washer, 5/16, SAE, Yellow Zinc	3	61	01002395	Belt & Chain Guard Assembly	1
27	00009816	Engine, Briggs & Stratton, 5 HP	1	62	01002397	Front Support Assembly	1
28	00009838	Lynch Pin, 3/8 x 2-1/4, Zinc	1	63	01002399	Reel Assembly	1
29	00009920	Lock Washer, 7/16, Zinc	4	64	01002401	Jackshaft Bearing Mount Assembly	1
30	00009968	Yoke, 3/8-24 Forged	1	65	01002403	Right Rear Wheel Axle	1
31	00010985	Cap, Screw, Socket Set, 5/16-18 x 1/4	1	66	01002405	Belt Tensioner	1
32	00011437	HHCS, Standard, 3/8-16 x 3/4, Zinc	2	67	00020342	Spacer, Belt Tensioner	1
33	00011971	Decal, "Grease Daily"	1	68	01002411	Handle Assembly w/Brace	1
34	00012156	Hex Nut, 3/8-24, Yellow	1	69	01002413	Handle Strut	1
35	00012157	Lock Washer, 3/8 Zinc	69				



EQUIPMENT TWO-YEAR LIMITED WARRANTY

*This warranty is specific for the product manual to which it is attached.
For a complete list of products and warranties contact your dealer.*

Proper maintenance of your equipment is the owner's responsibility. Follow the instructions in your owner's manual for correct lubricants and maintenance schedule. Your dealer carries a complete line of quality lubricants and filters for your equipment's engine, transmission, chassis and attachments.

1. **What Is Covered By This Warranty.** This limited warranty covers any defect in materials or workmanship in your MTD Pro equipment for two years from the date of purchase for the first user purchaser. MTD Pro will replace or repair any part or parts without charge through your authorized MTD Pro dealer. Batteries, belts and tires will be covered for a period of ninety (90) days from date of purchase. Engine warranties beyond listed coverage, if available, is handled directly with the engine manufacturer.
2. **What Is Not Covered By This Warranty.** MTD Pro does not warrant (a) routine maintenance items such as lubricants, filters (oil, fuel, air and hydraulic), cleaning, tune-ups, brake or clutch inspection, adjustments made as part of normal maintenance, blade sharpening, setup and normal wear. (b) incidental costs such as transporting equipment to and from the dealer, telephone charges or renting a product temporarily to replace a warranted product. (c) damage caused by use of the equipment for purposes other than those for which it was designed; (d) damage caused by accident or disasters such as fire, flood, wind and lightning; (e) damage caused by unauthorized attachments or modification; or (f) any other abuse or misuse of the equipment. There is no other express warranty.
3. **Exclusive Warranty.** The foregoing warranty is exclusive and in lieu of all other warranties or remedies, whether written, oral or implied. Any and all implied warranties of merchantability, fitness for a particular purpose, course of dealing or usage of trade are hereby expressly disclaimed and excluded.
4. **Limitation of Remedies.** Under no circumstances, except to the extent prohibited by applicable law, shall MTD Pro be liable for any loss or damage, direct or indirect, special, incidental or consequential arising out of the use or inability to use this equipment including but not limited to any claim for loss of profits, loss of savings or revenue, loss of use of the equipment or any associated equipment, facilities or service, downtime, the claims or costs of third parties including customers, and injury to property. *Some states do not allow limitations on how long an implied warranty lasts or the exclusion or limitation of incidental or consequential damages, so the above limitations or exclusion may not apply to you. This warranty gives you specific legal rights, and you may also have other rights which vary from state to state.*
5. **Future Changes:** MTD Pro reserves the right to reserve, change or modify the construction and design of its Equipment or any component part or parts thereof without incurring the obligations to make such changes or modifications in present equipment.
6. **How to Obtain Service:** Contact the authorized MTD Pro dealer who sold you your equipment to obtain service or replacement parts. If you need further assistance in finding an authorized servicing dealer, contact:

MTD Pro
P.O. Box 361131
Cleveland, Ohio 44136

Free Manuals Download Website

<http://myh66.com>

<http://usermanuals.us>

<http://www.somanuals.com>

<http://www.4manuals.cc>

<http://www.manual-lib.com>

<http://www.404manual.com>

<http://www.luxmanual.com>

<http://aubethermostatmanual.com>

Golf course search by state

<http://golfingnear.com>

Email search by domain

<http://emailbydomain.com>

Auto manuals search

<http://auto.somanuals.com>

TV manuals search

<http://tv.somanuals.com>