

OWNER'S GUIDE

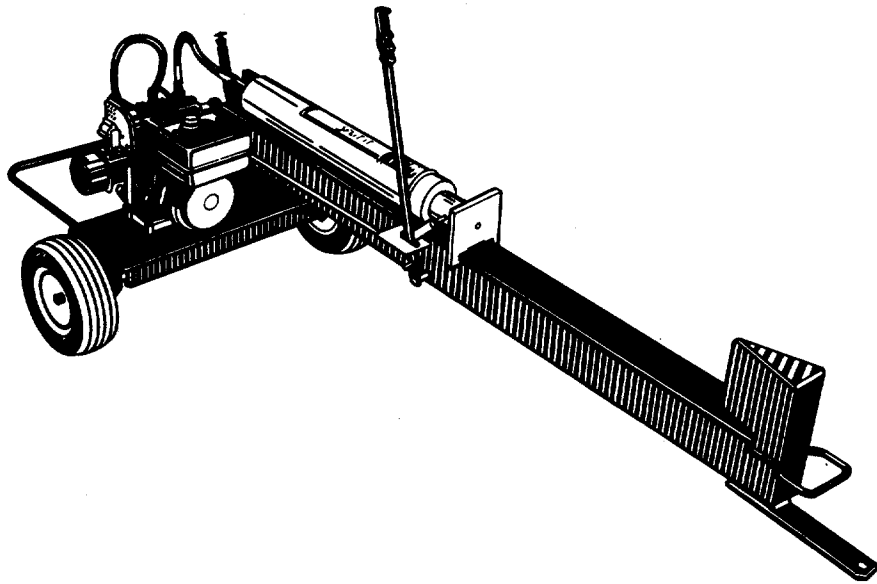

ASSEMBLY • OPERATION • MAINTENANCE • PARTS

3-1/2 H.P. LOG SPLITTER

Important:

**Read Safety Rules and
Instructions Carefully**

Model Number

241-640A

Thank you for purchasing an
American built product.

INDEX

Safe Operation Practices	3	Engine Maintenance	9
List of Contents in Hardware Pack	4	Storage Instructions	
Assembly Instructions	4	Exploded View	12, 15
Operation Instructions	5	Repair Parts List	13, 14
Maintenance	8	Parts Information	Back Cover

LIMITED WARRANTY

For one year from the date of original retail purchase, MTD PRODUCTS INC will either repair or replace, at its option, free of charge, F.O.B. factory or authorized service firm, any part or parts found to be defective in material or workmanship. Transportation charges under this warranty must be paid by the purchaser unless return is requested by MTD PRODUCTS INC.

This warranty will not apply to any part which has become inoperative due to misuse, excessive use, accident, neglect, improper maintenance, alterations, or unless the unit has been operated and maintained in accordance with the instructions furnished. This warranty does not apply to the engine, motor, battery, battery charger or component parts thereof. Please refer to the applicable manufacturer's warranty on these items.

This warranty will not apply where the unit has been used commercially.

Warranty service is available through your local authorized service dealer or distributor. If you do not know the dealer or distributor in your area, please write to the Customer Service Department of MTD.

This warranty gives you specific legal rights. You may also have other rights which vary from state to state.



TO PURCHASERS OF INTERNAL COMBUSTION ENGINE EQUIPPED MACHINERY OR DEVICES IN THE STATE OF CALIFORNIA

The equipment which you have just purchased does not have a spark arrester. If this equipment is used on any forest covered land, brush covered land, or grass covered unimproved land in the State of California, before using on such land, the California law requires that a spark arrester be provided. In addition, spark arrester is required by law to be in effective working order. The spark arrester must be attached to the exhaust system and comply with Section 442 of the California Public Resources Code.

➔ IMPORTANT

It is suggested that this manual be read in its entirety before attempting to assemble or operate. Keep this manual in a safe place for future reference and for ordering replacement parts.

This unit is shipped WITHOUT GASOLINE or OIL. After assembly, see operating section of this manual for proper fuel and amount.

Your log splitter is a precision piece of power equipment, not a plaything. Therefore exercise extreme caution at all times.

SAFE OPERATION PRACTICES FOR LOG SPLITTERS

TRAINING

1. Know the controls and how to stop quickly--
READ THE OWNER'S MANUAL.
2. Do not allow children to operate. Do not allow adults to operate it without proper instruction. Only persons well acquainted with these rules of safe operation should be allowed to use your log splitter.
3. Open doors if engine is run in garage--
exhaust fumes are dangerous. Do not run engine indoors.
4. Always operate the log splitter from the engine side of the beam.

PREPARATION

1. Do not wear loose fitting clothing that could get caught on the moving parts.
Do not operate equipment when barefoot or wearing open sandals. Always wear substantial footwear.
2. Check the fuel before starting the engine. Do not fill the gasoline tank indoors, when the engine is running, or while the engine is still hot. Wipe off any spilled gasoline before starting the engine.
3. Use only in daylight or in good artificial light.
4. Never operate the equipment in the rain. Always be sure of your footing.

Stand behind the ram when operating. See drawings.

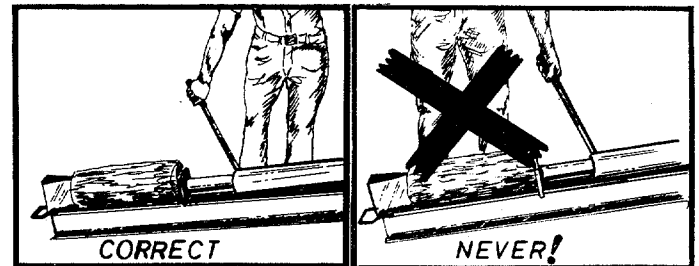

OPERATION

1. Do not change the engine governor settings or overspeed the engine. Excessive engine speeds are dangerous.
2. Do not put hands or feet near rotating or moving parts.
3. If the equipment should start to vibrate abnormally, stop the engine and check immediately for the cause. Vibration is generally a warning of trouble.
4. When cleaning, repairing or inspecting, make certain all moving parts have stopped. Disconnect the spark plug wire, and keep the wire away from the plug to prevent accidental starting.
5. Handle gasoline with care--it is highly flammable.
 - A. Use approved gasoline container.
 - B. Never remove cap or add gasoline to a running or hot engine or fill fuel tank indoors. Wipe up spilled gasoline.

7. Be careful not to touch the muffler after the engine has been running, it is **HOT**.

MAINTENANCE and STORAGE

1. Keep all nuts, bolts, screws, hose clamps and hydraulic fittings tight to be sure equipment is in safe working condition.
2. Never store the equipment with gasoline in the tank inside of a building where fumes may reach an open flame or spark. Allow the engine to cool before storing in any enclosure.
3. To reduce fire hazard keep engine free of grass, leaves, wood chips, excessive grease and oil.
4. Do not change the engine governor settings or overspeed the engine. Excessive engine speeds are dangerous.
5. Never store outside without a waterproof cover. Rain will cause rust on the inside of the cylinder.

TOOLS REQUIRED:

- (1) Adjustable Wrench
- (1) 3/4" Wrench

OTHER MATERIALS NEEDED:

- (A) One gallon of regular grade gasoline (for engine)
- (B) 1-1/4 pints of SAE 30 or 10W oil (for engine)
- (C) 3-1/2 gallons of Dexron II Automatic Transmission fluid. (May be obtained at your local Service Station or Auto Parts store).
- (D) Cleaning rag
- (E) Funnel

LIST OF CONTENTS IN HARDWARE PACK:

See figure 1.

- A (2) Spacers
- B (2) Collars
- C (2) Square Head Set Screws
- D (1) Flat Washer
- D (1) Shoulder Bolt

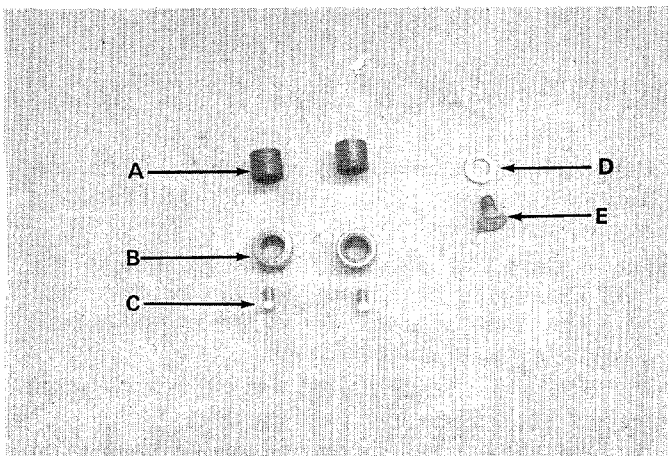

FIGURE 1

ASSEMBLY INSTRUCTIONS

1. Block up rear end of log splitter so that the rear wheels may be assembled.
2. Place spacers (A) on axle, then wheels and secure with collars (B) and set screws (C). See figure 2.

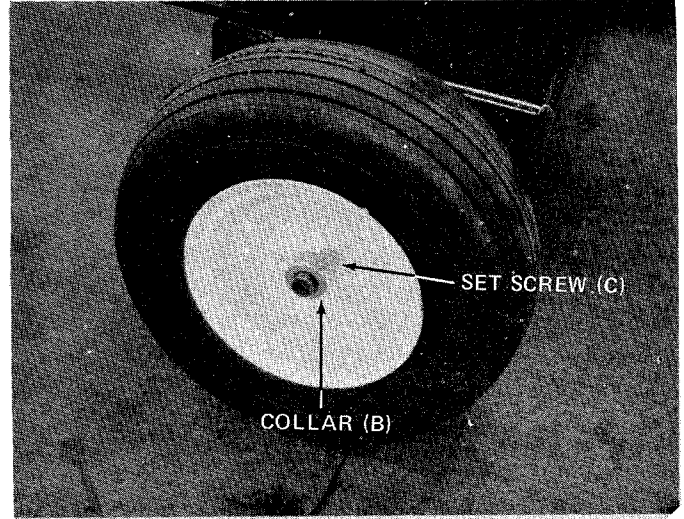

FIGURE 2

3. Secure engagement handle to beam with shoulder bolt (E) and flat washer (D). See figure 3.

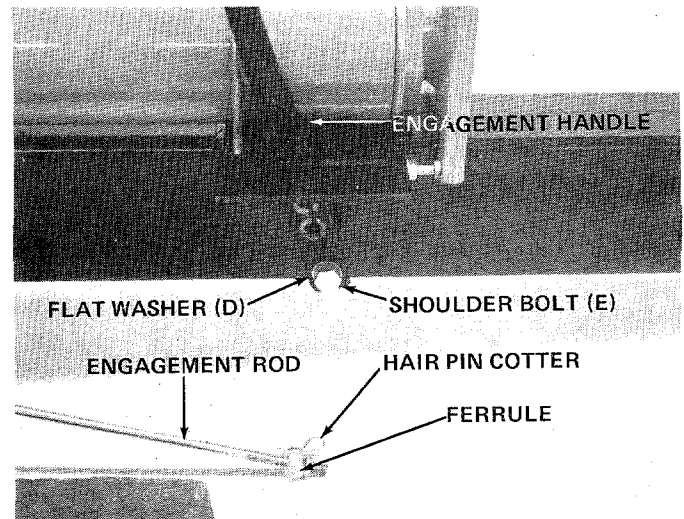

FIGURE 3

4. Remove the hairpin cotter from ferrule.
5. Secure engagement rod to engagement handle with hairpin cotter. See figure 3.

OPERATION

1. Service engine with gas and oil. See engine manual packed with log splitter for complete instructions for the care and maintenance of engine. **READ DIRECTIONS CAREFULLY.**



CAUTION

You must not operate log splitter without proper amount of oil in reservoir tank.

2. Remove the breather plug from breather tube. See figure 4. Pour 3-1/2 gallons of Dexron automatic transmission fluid **ONLY** into breather tube.

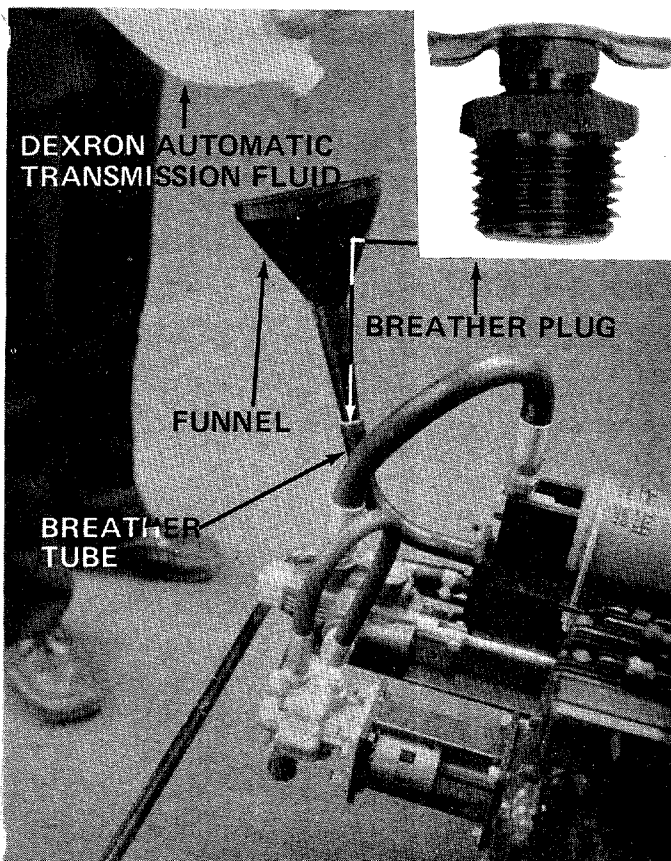

FIGURE 4

3. Open the breather valve. Valve must be open when running log splitter. Valve must be closed when transporting log splitter. See figure 5.

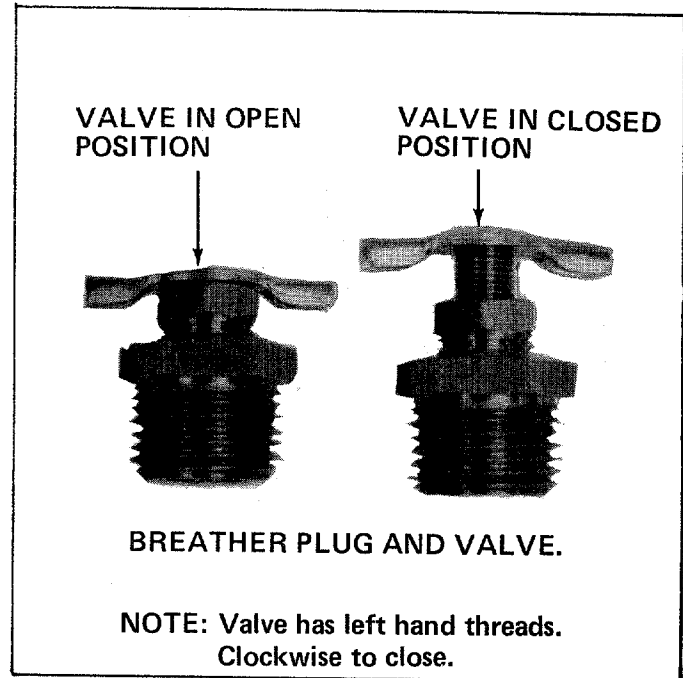

FIGURE 5

LOG SPLITTER:

The oil in the reservoir should be changed every (100) hours of operation.

Check oil in log splitter reservoir before every use. See figure 6.

1. Let the log splitter rest on the tongue. (**DO NOT** block up level).
2. Remove check pipe plug in rear of beam. See figure 6. If oil starts to come out of check pipe plug hole, oil level is correct. **IF NOT** add oil to breather tube (figure 4) until oil starts out.

NOTE: Use hydraulic sealant tape or pipe sealant on pipe plug threads.

3. Replace check pipe plug.

CHANGING OIL IN RESERVOIR:

1. Remove the hose clamp at inlet hose (bottom hose in rear of beam). See figure 15.

NOTE: Be prepared to catch oil in a container.

2. Pull off inlet hose from strainer tube assembly and catch oil in a suitable container. See figure 15.
3. With an adjustable wrench remove the strainer tube assembly. See figure 15.

NOTE: The strainer tube assembly is 53" long.

4. Drain oil, clean strainer tube and reassemble using a hydraulic pipe sealant on the threads.
5. Remove the breather plug from breather tube. See figure 4. Pour 3-1/2 gallons of Dexron automatic transmission fluid **ONLY** into breather tube.

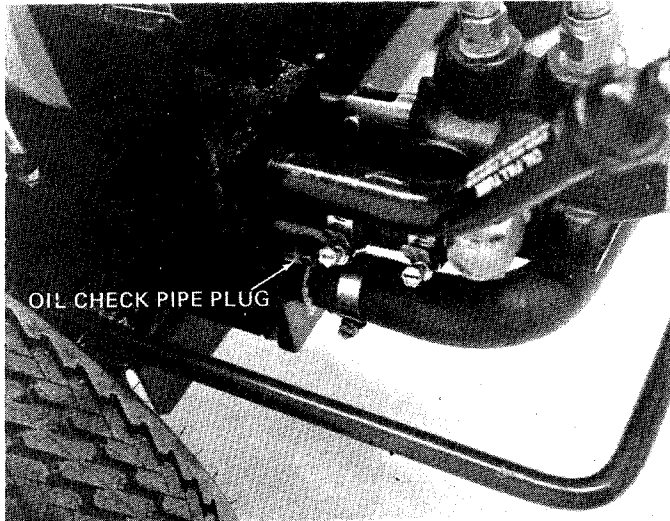

FIGURE 6

BEFORE STARTING

During initial break-in period, oil level should be watched closely. See ENGINE MAINTENANCE.

Use MS classification oil. Do not use oils marked only MM or ML or unmarked.

Above 32° use SAE 30; below 32° use SAE 10W. These recommendations must be followed for best performance and long life.

Change oil first two (2) hours of operation and check oil level every five (5) operating hours or each time equipment is used.

Change oil every twenty-five (25) operating hours or sooner if equipment is operated in extremely dusty or dirty conditions. See figure 7.



Carburetors are preset at the factory. DO NOT attempt to make adjustments at this time. See carburetor instructions outlined under CARBURETOR ADJUSTMENT.

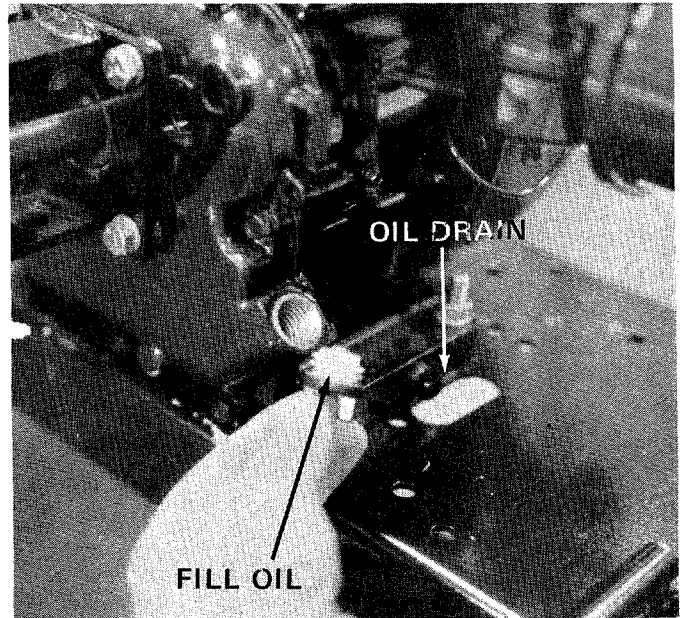

FIGURE 7

TO START ENGINE

1. Place control lever (on engine) in run position. See figure 8.
2. Move choke lever to CHOKE position. See figure 9.
3. Rewind starter—use quick full arm stroke. Keep firm grip on handle and return rope slowly.

TO STOP ENGINE

1. Move control lever to STOP position. See figure 8.
2. Remove high tension wire from spark plug to prevent accidental starting by children while equipment is unattended.

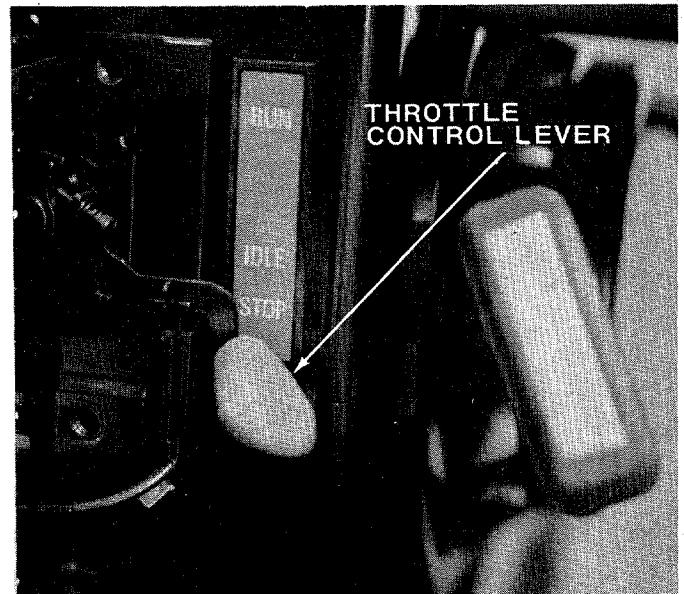

FIGURE 8

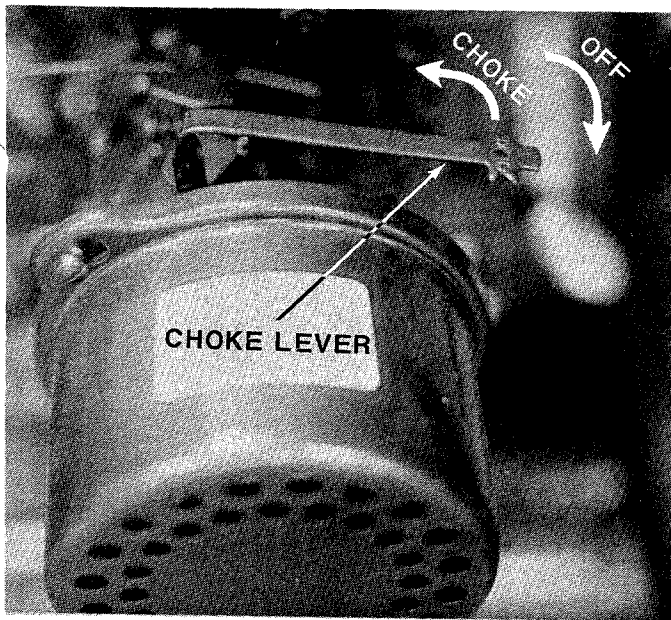

FIGURE 9

USING YOUR LOG SPLITTER

Your log splitter is designed for safe, efficient, operation. CARE, OF COURSE, MUST BE EXERCISED THAT HANDS ARE KEPT AWAY FROM MOVING PARTS.

- A. Set throttle at maximum speed.
- B. Engagement handle has three positions: Forward—moves ram toward wedge. Neutral—ram stops in place. Reverse—ram returns. See figure 10.

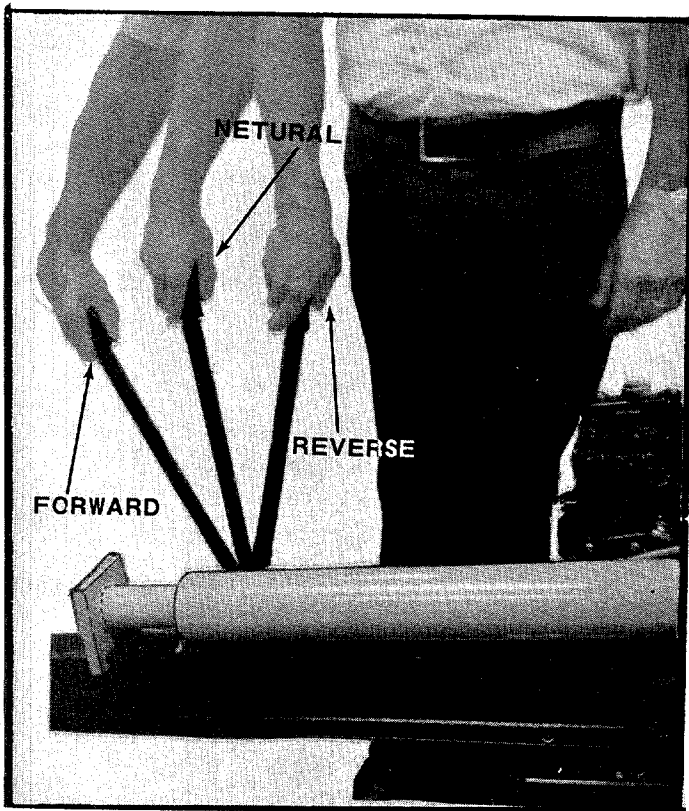

FIGURE 10

- C. Maximum length that can be split is 24".
- D. Place log on beam and hold in place with right hand. See figure 11.

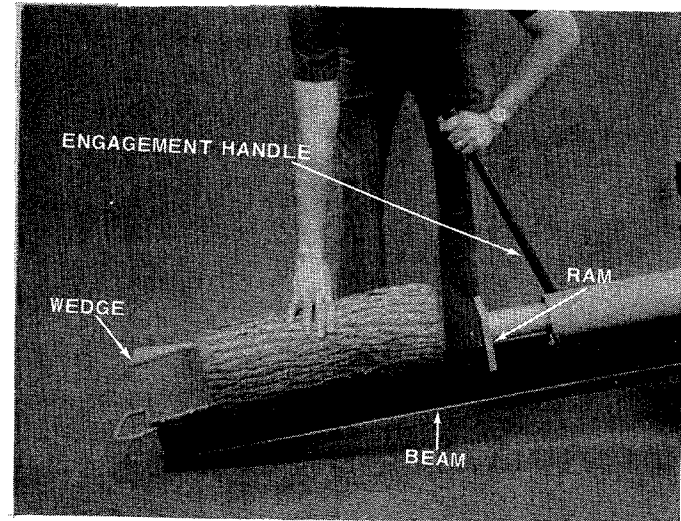

FIGURE 11

- E. Slowly move engagement handle forward until ram rests against log. Release engagement handle (Neutral).
- F. Remove your hand from the log and step behind the ram. See figure 12.

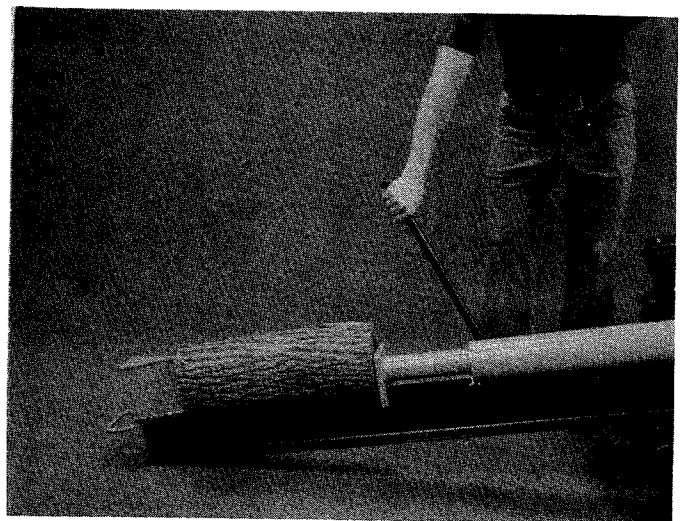

FIGURE 12

- G. Move engagement handle forward until log is split.



If you attempt to run the ram beyond its normal stroke it will automatically return the engagement handle to neutral.

- H. Move the engagement handle to the rear to return ram.



Never attempt to cut a log in half with the log splitter. See figure 13.

Never stand next to the ram when operating. See figure 14. Always stand behind the ram.

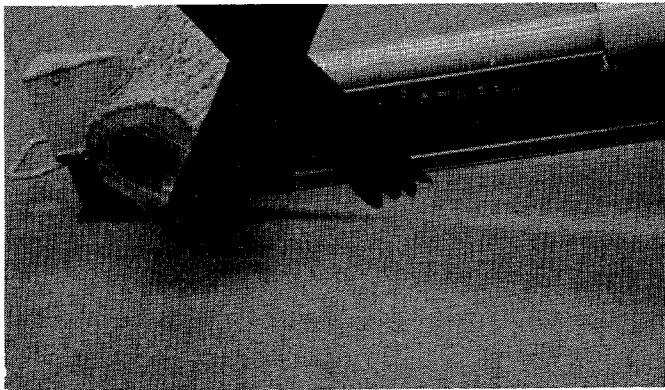

FIGURE 13

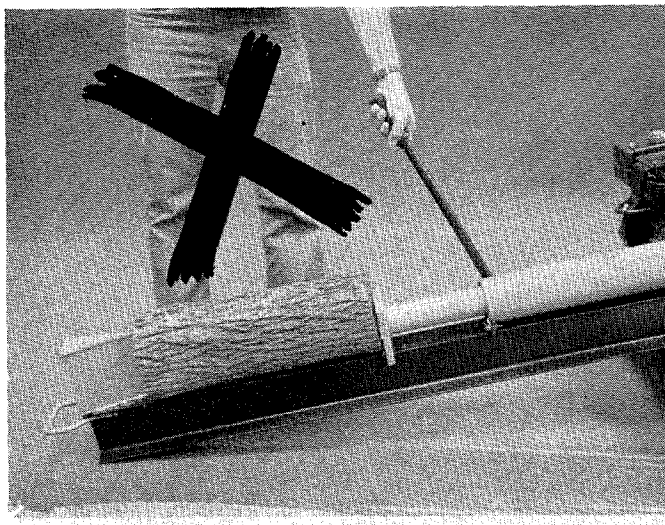

FIGURE 14



The ram should take approximately 30 seconds to make a complete cycle. This speed may vary depending on throttle setting and temperature of oil.

MAINTENANCE



Always stop engine and disconnect spark plug wire before doing any maintenance.

RAM OPERATION

If the ram does not move smoothly, run the ram its full stroke several times to clear out air in the system. Be sure the breather valve is open.

If this does not correct the problem see strainer tube assembly paragraph.



When the pressure relief valve opens a loud high pitched sound is heard and engine labors.

HOSE CLAMPS

Check the hose clamps on the bottom of the pump for proper tightness before each use.

Hose clamps on the return hose should be checked once a season.

STRAINER TUBE ASSEMBLY

If the ram does not move back and forth smoothly the strainer tube assembly may be clogged.

To clean follow these steps.

1. Remove the hose clamp at inlet hose (bottom hose on rear of beam).



Be prepared to catch oil in a container.

2. Pull off inlet hose from strainer tube assembly and catch oil in a suitable container. See figure 15.
3. With an adjustable wrench remove the strainer tube assembly. See figure 15.

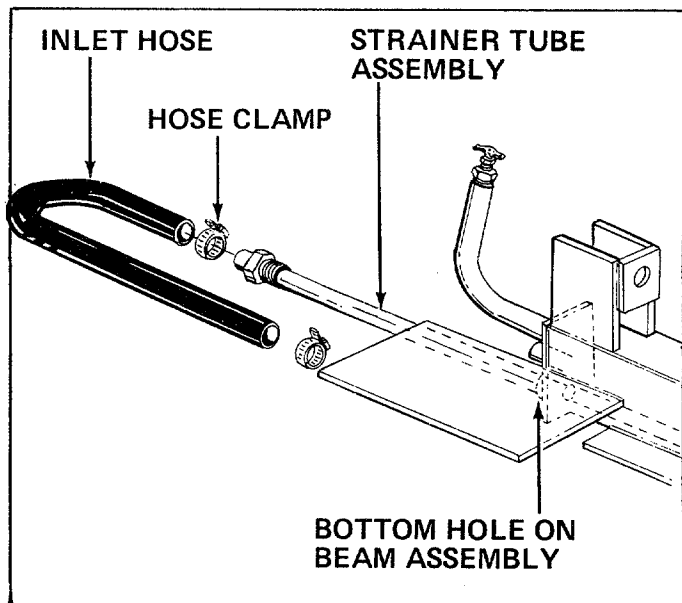

FIGURE 15



The strainer tube assembly is 53" long.

4. Clean and reassemble using a hydraulic pipe sealant on the threads.

PRESSURE RELIEF VALVE SETTING

If the pressure relief valve is set too low it will open up before enough pressure is built up to properly operate the ram. See figure 16.

TO SET THE PRESSURE RELIEF VALVE

1. Have someone place a log crossways in the Splitter and allow the Ram to push against it with the engine running wide open.
2. If the engine begins to lug down, the Relief Valve setting is correct.
3. If adjustment is necessary, tighten the screw until the engine begins to lug down.

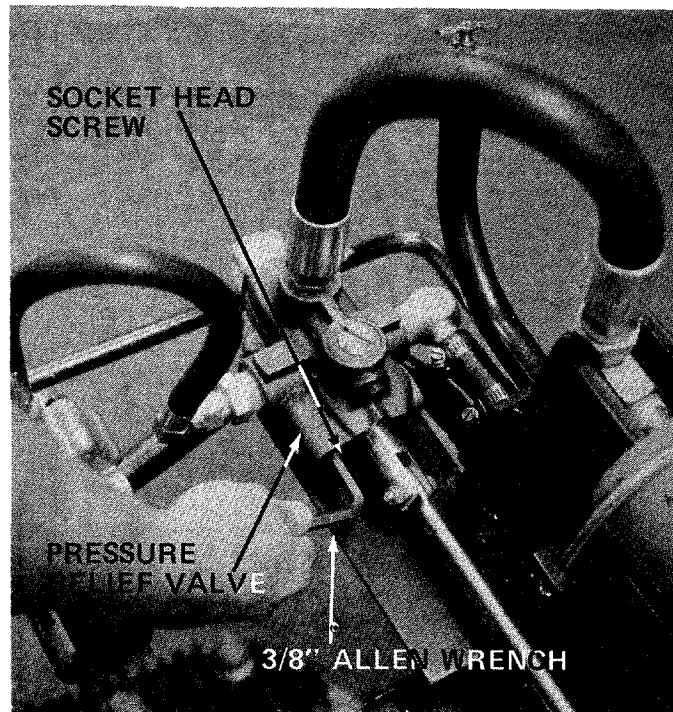

FIGURE 16

ENGINE MAINTENANCE

To obtain long life and trouble-free service from your engine, certain normal maintenance must be performed as outlined below:

1. Change oil in crankcase after first two (2) hours of operation. Then, follow instructions outlined on page 6.

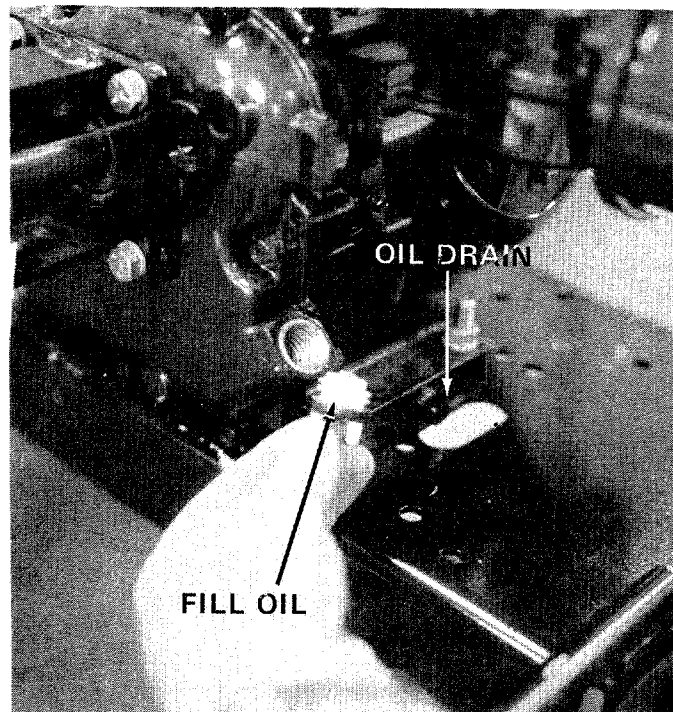

FIGURE 17



CAUTION

Disconnect high tension wire at spark plug to prevent accidental starting of engine. Unscrew oil drain plug located on side at bottom of engine See figure 17.



NOTE

Always tip engine towards oil drain hole. Be sure oil drains completely.

Replace oil drain plug and refill with oil as directed on page 6 or engine nameplate.

2. Check oil every five (5) operating hours or each time equipment is used.
3. Cleaning engine—This is an aircooled engine which operates most efficiently when the cooling fins are clean.

Clean cylinder fins and underside of tank or housing thoroughly of all accumulated grass and debris.

4. Air Cleaner. (See figure 18).

Paper Type Element. Remove every 10 hours or oftener if under dusty conditions. Tap to remove loose dirt and/or blow from inside out with low pressure air. Replace if torn or perforated or when plugged to maintain proper carburetor setting (50 hours). DO NOT WASH IN ANY LIQUID AND DO NOT OIL.

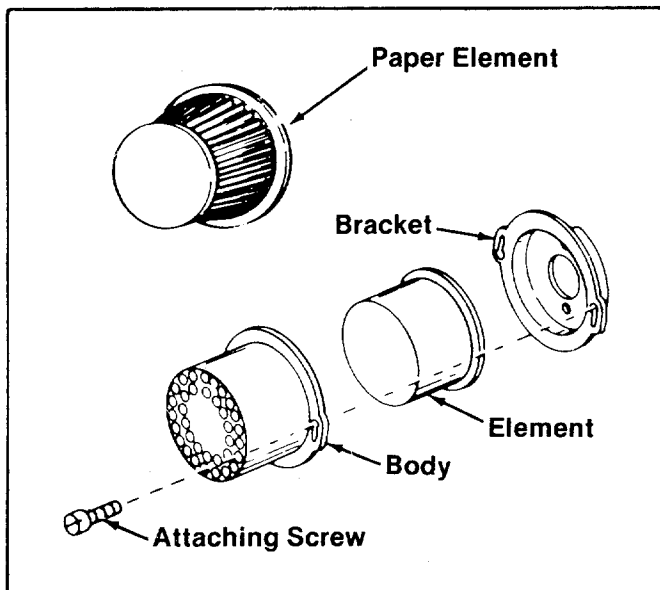

FIGURE 18

CARBURETOR ADJUSTMENTS (See figure 19)

Do not make unnecessary adjustment. Factory settings are correct for most application. If adjustments are needed, proceed as follows:

1. Close power adjusting needle (figure 19) by turning to right (clockwise). Close finger tight only. Forcing will cause damage.
2. Open one turn (counterclockwise).
3. Close idle adjusting needle (figure 19) by turning to right (clockwise). Close finger tight only. Forcing will cause damage.
4. Open one and one-half (1-1/2) turns (counterclockwise).
5. Start engine. Follow starting instructions page 6.
6. With throttle open (carburetor control at RUN or FAST position) adjust power adjusting needle one-eighth (1/8) turn at a time forward to backward until engine runs smoothly. If engine tends to stall under load enrich mixture slightly (counterclockwise).
7. Hold throttle lever closed or move carburetor control to IDLE or SLOW position and adjust idle adjusting needle until engine runs smoothly proceeding in step six (6) above.
8. Allow several seconds between each adjustment when performing either step six (6) or seven (7) to allow engine to react to new setting.

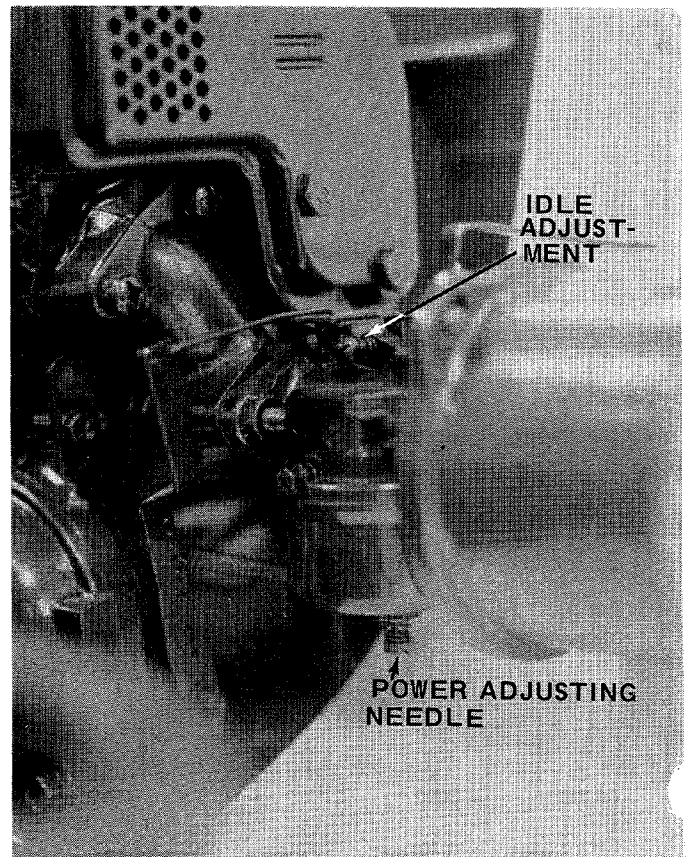

FIGURE 19

STORAGE INSTRUCTIONS

In event engine is to be stored for any length of time (30 days or more), prepare as follows:

1. Drain gasoline by tipping or by syphon hose, then run engine until remainder is used and tank and carburetor are empty.



CAUTION

Drain into container outdoors away from fire or flame.

2. Drain carburetor by running engine until it stops
3. Inside protecting of engine for storage is performed by removing spark plug and pouring one ounce of SAE 30 oil through spark plug hole into cylinder. Crank engine, without starting, several times to spread oil over cylinder walls.
4. Never store outside without a waterproof cover.

241-640A

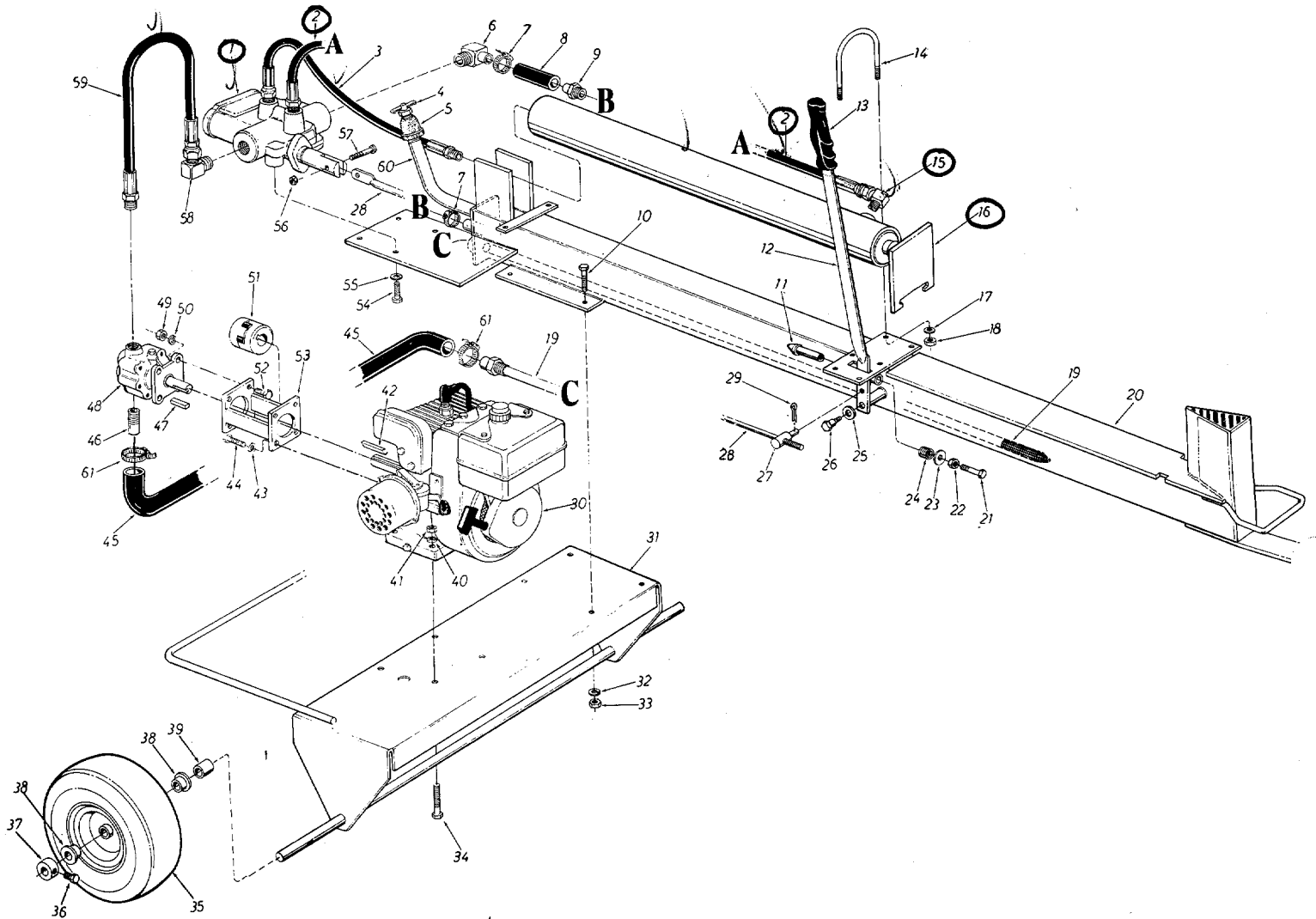

241-640A

PARTS LIST FOR LOG SPLITTER MODEL No. 241-640A

Ref. No.	Part No.	Color Code	DESCRIPTION	New Part	Ref. No.	Part No.	Color Code	DESCRIPTION	New Part
1	717-0407		Control Valve		30	-----		3-1/2 H.P. Engine - Tecumseh	
2	727-0231		Return Stroke High Pressure		31	13748		Frame Ass'y.	
			Hose	N	32	736-0119		L.-Wash. 5/16" I.D.*	
3	727-0211		Forward Stroke High		33	712-0123		Hex Nut 5/16-24 Thd.*	
			Pressure Hose		34	710-0409		Hex Bolt 5/16-24 x 1.75"	
4	737-0161		Breather Valve					Lg.*	
5	737-0173		Female Adapter 3/4-14 x		35	734-0488		Wheel Ass'y. Comp. 11.0 x 4.0	
			1/4-18 N.P.T.F.	N	36	710-0494		Sq. Hd. Set Scr. 5/16-18 x	
6	737-0153		Return Elbow					.38" Lg. Cup Point	
7	726-0173		Hose Clamp 3/4" I.D.		37	711-0169		Collar 5/16" I.D.	
8	727-0210		Return Hose 3/4" I.D. x		38	748-0184		Flange Bearing .630" I.D.	
			2.62" Lg.		39	748-0192		Spacer .63" I.D. x .88" O.D.	
9	737-0172		Nipple 1/2-14 N.P.T.F. x					x .800" Lg.	
			1.5" Lg.	N	40	736-0119		L.-Wash. 5/16" I.D.*	
10	710-0117		Hex Bolt 5/16-24 x 1.00"		41	712-0123		Hex Nut 5/16-24 Thd.*	
			Lg. (Grade 5)		42	714-0105		Sq. Key 3/16 x 3/16 x 1.5" Lg.*	
11	738-0406		Return Stroke Stop Plunger		43	736-0119		L.-Wash. 5/16" I.D.*	
12	750-0428		Engagement Handle		44	710-0157		Hex Bolt 5/16-24 x .75"	
13	08118		Grip					Lg.*	
14	747-0355		Cylinder Support Rod		45	727-0228		Suction Hose	N
			(for 3-1/2" Dia.)	N	46	737-0174		Straight Barb Hose Fitting	N
15	737-0152		High Pressure 90° Elbow		47	-----		Sq. Key comes with Ref. No. 48	
			3/8 N. P. T. x 9/16-18	N	48	717-0363		Pump with Sq. Key 1/8 x 1/8 x	
16	-----		Cylinder Ass'y. (See Page					1.00" Lg.	
			14 for Breakdown)		49	712-0123		Hex Nut 5/16-24 Thd.*	
17	736-0169		L.-Wash. 3/8" I.D.*		50	736-0119		L.-Wash. 5/16" I.D.*	
18	712-0798		Hex Nut 3/8-16 Thd.*		51	717-0463		Flexible Coupling w/set	
19	15234		Strainer Tube Ass'y.	N				Screw	N
20	15235		Complete Oil Tank & Beam		52	710-0117		Hex Bolt 5/16-24 x 1.00" Lg.*	
			Ass'y.	N				(Grade 5)	
21	710-0624		Hex Bolt 5/16-24 x 1.50" Lg.*		53	13295		Coupling Support Brkt. Ass'y.	
22	712-0123		Hex Nut 5/16-24 Thd.*		54	710-0216		Hex Bolt 3/8-16 x .75" Lg.*	
23	736-0159		Fl.-Wash. .34 I.D. x .88" O.D.		55	736-0105		Belleville Wash. 3/8" I.D.	
24	732-0252		Compression Spring .64		56	712-0107		Hex Cent. L.-Nut 1/4-20 Thd.	
			O.D. x .81 Lg.		57	710-0106		Hex Bolt 1/4-20 x 1.25"	
25	736-0160		Fl.-Wash. .53" I.D. x .94" O.D.					Lg.*	
26	738-0234		Shld. Bolt .500" Dia. x .295		58	737-0171		90° Solid Male Adapter	N
27	711-0198		Pivot Bushing		59	727-0230		High Pressure Hose Ass'y.	N
28	747-0297		Engagement Rod .38 Dia. x		60	750-0501		Filler Tube	N
			31" Lg.		61	726-0132		Hose Clamp 1" I.D.	
29	714-0507		Cotter Pin 3/32" Dia. x .75" Lg.*						

*For faster service obtain standard nuts, bolts and washers locally. If these items cannot be obtained locally, order by part number and size as shown on parts list.

The engine is not under warranty by the log splitter manufacturer. If repairs or service is needed on the engine, please contact your nearest authorized engine service outlet. Check the "Yellow Pages" of your telephone book under "Engines - Gasoline."



241-640A

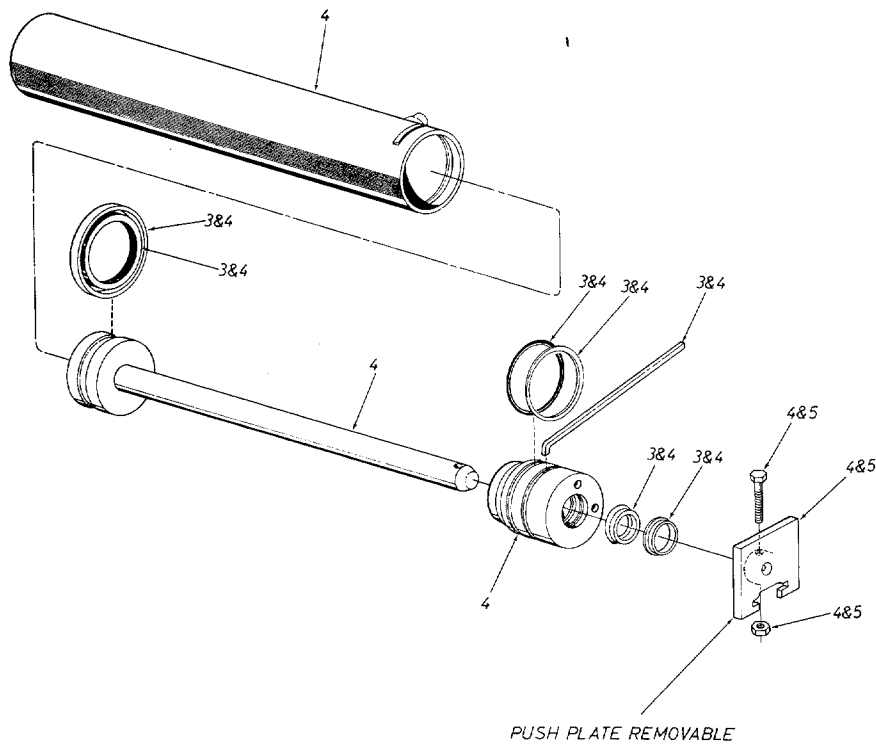
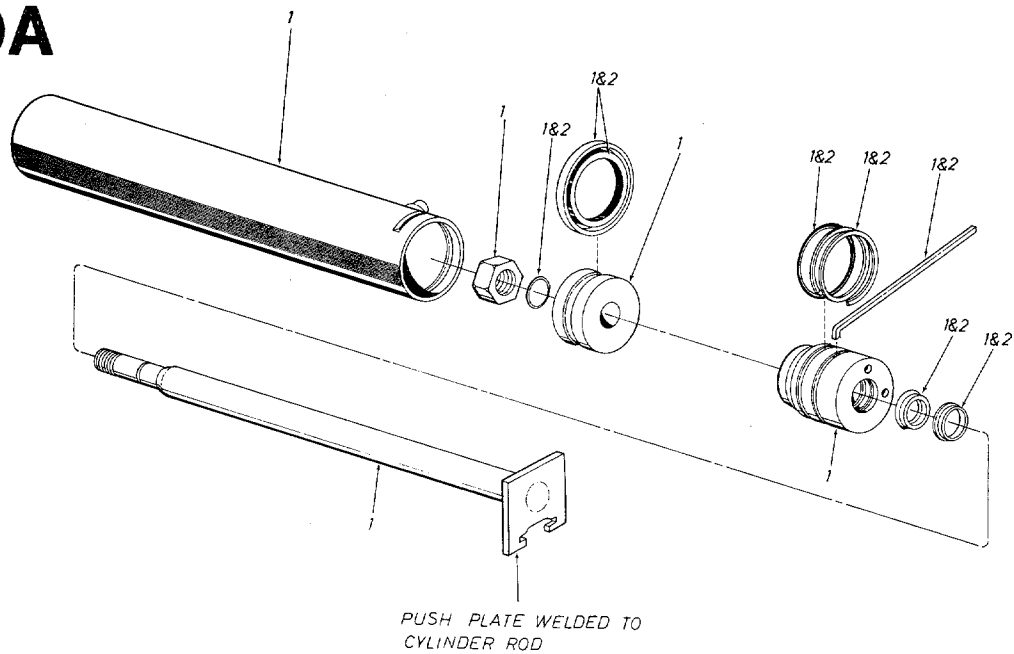

3-1/2" DIA. CYLINDER PARTS LIST FOR MODEL 241-640A

Ref. No.	PART No.	DESCRIPTION	New Part
1	717-0459	Cylinder Ass'y. Comp. (Welded Push Plate)	N
2	753-0271	3-1/2" Cyl. Kit "O"-Ring Set (Welded Push Plate)	N
3	753-0272	3-1/2" Cyl. Kit "O"-Ring Set (Removable Push Plate)	N
4	717-0459	Cylinder Ass'y. Comp. (Removable Push Plate)	N
5	753-0274	3-1/2" Cyl. Kit - Push Plate	N

PARTS INFORMATION

POWER EQUIPMENT PARTS AND SERVICE

Parts and service for all MTD manufactured power equipment are available through the authorized service firms listed below. All orders should specify the model number of your unit, part numbers, description of parts and the quantity of each part required.

NOTE: If any parts are found to be missing or defective upon assembly of this unit, write to advise the factory so that immediate replacement can be made.

ALABAMA	BIRMINGHAM	
Auto Electric & Carburetor Co.	2625 4th Ave. S.	35233
ARKANSAS	FORT SMITH	
Mity Mite Motors, Inc.	4515 S. 16th St.	72901
	NORTH LITTLE ROCK	
Sutton's Lawn Mower Shop	Rt. 4, Box 368	72117
CALIFORNIA	PORTERVILLE	
Billious	75 North D Street	93257
	SAN FRANCISCO	
J.W. Jewett Co.	981 Folsom St.	94107
COLORADO	DENVER	
Colorado Outdoor Power Equip.	527 West Evans	80223
FLORIDA	JACKSONVILLE	
Radco Distributors	4909 Victor St.	
	Box 5459	32207
	OPA LOCKA	
Small Eng. Dist.	2351 N.W. 147th St.	33054
GEORGIA	EAST POINT	
East Point Cycle & Key	2834 Church St.	30344
ILLINOIS	LYONS	
Keen Edge Co.	8615 Ogden Ave.	60534
INDIANA	ELKHART	
Parts & Sales Inc.	2101 Industrial Pkwy.	46514
IOWA	DUBUQUE	
Power Lawn & Garden Equip.	2551 J.F. Kennedy	52001
LOUISIANA	NEW ORLEANS	
Suhren Engine Co.	8330 Earhart Blvd.	70118
MARYLAND	TAKOMA PARK	
Center Supply Co.	6867 New Hampshire Ave.	20012
MASSACHUSETTS	SPRINGFIELD	
Morton B. Collins Co.	300 Birnie Ave.	01107
MICHIGAN	LANSING	
Lorenz Service Co.	2500 S. Pennsylvania	48910
	MOUNT CLEMENS	
Power Equipment Dist.	36463 South Gratiot	48043
MINNESOTA	HOPKINS	
Hance Distributing Inc.	420 Excelsior Ave. W.	55343
MISSISSIPPI	BILOXI	
Biloxi Sales & Service, Inc.	506 Caillavet St.	39533
MISSOURI	KANSAS CITY	
Automotive Equip. Service	3117 Holmes St.	64109
	ST. JOSEPH	
Ross-Frazier Supply Co.	8th and Monterey	64503
	ST. LOUIS	
Henzler, Inc.	2015 Lemay Ferry Road	63125
NEW JERSEY	BELLMAWR	
Lawnmower Parts Inc.	717 Creek Rd.	08030
	RUTHERFORD	
Feld Distributor	28 Glen Rd.	07070
NEW YORK	CARTHAGE	
Gamble Dist., Inc.	West End Ave.	13619

BRIGGS AND STRATTON, TECUMSEH AND PEERLESS PARTS AND SERVICE

Briggs & Stratton, Tecumseh and Peerless parts and service should be handled by your nearest authorized engine service firm. Check the yellow pages of your telephone directory under the listing **Engines—Gasoline**, Briggs & Stratton or Tecumseh Lauson.

NORTH CAROLINA	GOLDSBORO	
Smith Hardware Co.	515 N. George St.	27530
	GREENSBORO	
Dixie Sales Company	335 N. Green	27402
OHIO	CARROLL	
Stebe's Mid-State Mower Supply	Box 366, 71 High St.	43112
	CLEVELAND	
Bleckrie, Inc.	7900 Lorain Ave.	44102
	WADSWORTH	
National Central	687 Seville Rd.	44281
	YOUNGSTOWN	
Burton Supply Co.	1301 Logan Ave.	
	Box 929	44501
OKLAHOMA	MUSKOGEE	
Victory Motors, Inc.	605 S. Cherokee	74401
	OKLAHOMA CITY	
Forest Sales Inc.	6415 N. Olie	73116
OREGON	PORTLAND	
Kenton Supply Co.	8216 N. Denver Ave.	97217
PENNSYLVANIA	CHESTER	
Stull Equipment Corp.	742 W. Front St.	19013
	HARRISBURG	
EECO Inc.	4021 N. 6th St.	17110
	PHILADELPHIA	
Thompson Rubber Co.	5222-24 N. Fifth St.	19120
	PITTSBURGH	
Bluemont Co.	11125 Frankstown Rd.	15235
	PUNXSUTAWNEY	
Frank Roberts & Sons	R.D. 2	15767
TENNESSEE	KNOXVILLE	
Master Repair Service	2000 Western Ave.	37921
	MEMPHIS	
American Sales & Service, Inc.	1922 Lynnbrook	38116
TEXAS	DALLAS	
Marr Brothers, Inc.	423 E. Jefferson	75203
	FORT WORTH	
Woodson Sales Corp.	1702 N. Sylvania	76111
	HOUSTON	
Bullard Supply Co.	2409 Commerce St.	77003
	SAN ANTONIO	
Catto & Putty, Inc.	414 Live Oak	78298
UTAH	SALT LAKE CITY	
A-1 Engine & Mower Co.	437 E. 9th St.	84111
VERMONT	BURLINGTON	
Vermont Hdwe. Co. Inc.	180 Flynn Ave.	05401
VIRGINIA	RICHMOND	
RBI Corp.	963 Myers St.	23260
WASHINGTON	SEATTLE	
Bailey's Inc.	1414 14th Ave.	98102
WEST VIRGINIA	CHARLESTON	
Young's, Inc.	233 Virginia St., E.	25301
WISCONSIN	MARSHFIELD	
Power Pac	301 E. 29th St.	54449

WARRANTY PARTS AND SERVICE POLICY

The purpose of warranty is to protect the customer from defects in workmanship and materials, defects which are NOT detected at the time of manufacture. It does not provide for the unlimited and unrestricted replacement of parts. Use and maintenance are the responsibility of the customer. The manufacturer cannot assume responsibility for conditions over which it has no control. Simply put, if it's the manufacturer's fault, it's the manufacturer's responsibility; if it's the customer's fault, it's the customer's responsibility.

CLAIMS AGAINST THE MANUFACTURER'S WARRANTY INCLUDES:

1. **Replacement of Missing Parts** on new equipment.
2. **Replacement of Defective Parts** within the warranty period.
3. **Repair of Defects** within the warranty period.

All claims **MUST** be substantiated with the following information:

1. **Model Number** of unit involved.
2. **Date** unit was purchased or first put into service.
3. **Date of failure.**
4. **Nature of failure.**

MTD PRODUCTS • 5965 GRAFTON ROAD • P.O. BOX 36900 • CLEVELAND, OHIO 44136

Free Manuals Download Website

<http://myh66.com>

<http://usermanuals.us>

<http://www.somanuals.com>

<http://www.4manuals.cc>

<http://www.manual-lib.com>

<http://www.404manual.com>

<http://www.luxmanual.com>

<http://aubethermostatmanual.com>

Golf course search by state

<http://golfingnear.com>

Email search by domain

<http://emailbydomain.com>

Auto manuals search

<http://auto.somanuals.com>

TV manuals search

<http://tv.somanuals.com>