

**O W N E R ' S
M A N U A L**

RM7200 SYSTEM

RM3300 SATELLITES

RM3600 CENTER CHANNEL

RM7600 SYSTEM

RM4300 SATELLITES

RM4600 CENTER CHANNEL

polkaudio
the speaker specialists®

GETTING STARTED

Make certain your system contains all its parts:

The complete RM7200 comes in ONE carton, containing the following items:

- Four (4) magnetically shielded micro-satellite speakers with integrated wall mount brackets
- One (1) magnetically shielded micro-center channel speaker with integrated wall mount bracket
- One (1) RM7200 8" Powered Subwoofer

The complete RM7600 comes in TWO cartons.

Carton 1 contains the following items:

- Four (4) magnetically shielded satellite speakers with integrated wall mount brackets
- One (1) magnetically shielded center channel speaker with integrated wall mount brackets

Carton 2 contains the following item:

- One (1) PSW series powered subwoofer with instruction manual

Please inspect each loudspeaker carefully. Notify your Polk Audio dealer if you notice any damage or any missing items. Keep the carton and packing material. They will do the best job of protecting your speakers if they need to be transported.

SPEAKER PLACEMENT

CENTER CHANNEL SPEAKER (Figure 1)



Place the center channel speaker as close to your TV as possible (Figure 1). The most popular placement for the center channel speaker is right on top of your TV set. The small size and slender design of the RM7000 Series center channel speakers makes them easy to mount on the wall directly above your TV. They look especially nifty if you have a slim line or flat screen TV. RM7000 Satellites are magnetically shielded for safe placement on or near your TV. If you notice video distortion or discoloration, immediately move the speaker away from the TV and call Polk Audio Customer Service 800-377-7655 (US & Can), 410-764-5266, 9am-6pm EST, Monday through Friday, or email: polkcs@polkaudio.com.

FRONT SATELLITES (Figure 2)

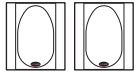

The front satellite and center channel speakers of the RM7000 systems are specifically designed to complement flat screen and inset display televisions by mounting unobtrusively on the wall flanking the TV. RM7000 Satellites are magnetically shielded for safe placement on or near your TV. If you notice video distortion or discoloration, immediately move the speaker away from the TV and call Polk Audio Customer Service 800-377-7655 (US & Can), 410-764-5266, 9am-6pm EST, Monday through Friday, or email: polkcs@polkaudio.com. The integrated brackets on the RM7000 Series satellites make them easy to mount. They also sound great on stands (available at your Polk Audio dealer, or online at <http://polkaudio.tranguard.com/>), bookshelves, or in entertainment centers. Place the small front satellites about as far apart as the distance you are sitting from them (Figure 2). Avoid placing them less than 2 feet (60cm) from the side walls of the room. When mounting the speakers on stands or on a shelf, place them at or near ear level.

SURROUND SPEAKERS (Figures 3a & 3b)

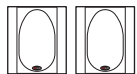

The best placement for surround channel speakers is on the side walls, facing each other, a foot or two (30-60cm) behind your listening position (Figure 3a). If this placement is not possible, the speakers may be placed on a rear wall (Figure 3b). In either case, mount the speakers two to four feet (60-120cm) above your head (when seated).

SUBWOOFER (Figures 4 & 5)



The RM7200 Systems uses a specially built compact Polk Audio Powered Subwoofer to round out its surround sound capabilities. This subwoofer module may be placed behind furniture or next to a sofa or chair. It can be placed anywhere in the room, but you will get the best performance from it when it is on the same side of the room as the front satellites. Placing it near a wall or in a corner will increase bass loudness. Allow at least 6 inches (15cm) of space between any subwoofer driver and a wall or obstruction (Figure 4). It may lie on its side, but NEVER LAY THE SUBWOOFER ON THE AMPLIFIER END—THIS WILL DAMAGE THE AMPLIFIER (Figure 5). The RM7200 subwoofer is magnetically shielded for safe placement near your television set. If you notice video distortion or discoloration, immediately move the subwoofer away from the TV and call Polk Audio Customer Service 800-377-7655 (US & Can), 410-764-5266, 9am-6pm EST, Monday through Friday, or email: polkcs@polkaudio.com.

You'll find an informative article on "Subwoofer Positioning and Adjustment" in the set up section at <http://www.polkaudio.com/home/faqad/>.

CONNECTING THE SPEAKERS TO YOUR SYSTEM (General Directions)

We recommend using two-conductor 16 gauge or thicker speaker wire. Strip 1/2 inch (12.7mm) of insulation from each of the two conductors to expose the bare metal and twist each of the individual conductors into single unfrayed strands. Note that one of the terminals on the rear of each speaker is red (+) and the other is black (-). Make certain that you connect the wire from the red (+) terminal of your amplifier or receiver to the red (+) terminal on your speaker and the wire from the black (-) terminal of your amplifier or receiver to the black (-) terminal on your speaker. Most wire has some indicator (such as color-coding, ribbing or writing) on one of the two conductors to help you maintain consistency. If your speakers sound “thin,” with little bass and little or no center image, chances are that one of the speaker wires is connected backwards. Double-check all connections.

USING PUSH-TAB AND 5-WAY BINDING POSTS

To connect wire to the push-tab connectors, push the plastic tab of one connector to open the hole. Insert the bare wire into the hole and release the plastic tab (**Figure 6**). Repeat this step with the other connectors.

To connect wire using the binding posts (**Figure 7**), unscrew the hex nut and insert the bare wire into the hole near the base of the binding post. Do not insert the insulated part of the wire into the hole as this will not give you a good connection. Twist the hex nut back down the binding post until it firmly meets the wire. Do not overtighten.

To Use Banana Plugs (US only): Carefully pry out the Binding Post Plugs (plastic plugs on the end of the binding posts) to expose Banana Plug holes. Insert Banana Plugs. (**This is for US owners only.**)

HOOK-UP OPTIONS

The versatile RM7000 Series loudspeaker systems give you many hook-up options. The option that is best for you depends on your electronics and your personal taste. Here are the hookups we recommend for each system. (You may want to experiment to see what works best for you.)

AN IMPORTANT NOTE ABOUT SUBWOOFER HOOKUP

For best sound, DO NOT USE THE “SUBWOOFER OUTPUT” OR LFE JACK ON YOUR RECEIVER TO CONNECT THE SUBWOOFER. The RM7200 and RM7600 Systems both feature a powered subwoofer that has a built-in, adjustable low pass filter to separate the low frequency signals (the bass) from the full range signal. The dedicated “subwoofer output” jacks (sometimes labeled “LFE” or “Low Frequency Effects”) on most receivers also contain a fixed low pass filter. If you connect the subwoofer to the receiver’s LFE Out jack, the two filters will interact and reduce the fidelity of your system. Follow the hook up and receiver set-up/bass management instructions below and all of the bass will go to the subwoofer, you will not lose any bass, and you will get the highest possible performance from your system. We promise.

You’ll find an informative article on “Bass Management and Subwoofer Connections” in the set up section at <http://www.polkaudio.com/home/faqad/>.

RM7200 HOOKUP OPTIONS

OPTION 1—SPEAKER WIRE HOOKUP, OUR FAVORITE HOOKUP METHOD (**Figure 8**):

- Using speaker wire, connect the left and right front speaker outputs of your receiver or amplifier to the “speaker level” (wire) inputs of the powered subwoofer.
- Then, connect the left and right front satellite speakers with speaker wire from the “speaker level” outputs of the powered subwoofer.
- Connect the Center Channel Speaker directly to the center channel output from your receiver.
- Connect the Rear Surround Satellites directly to the rear or surround channel outputs from your receiver.

OPTION 2—LINE LEVEL HOOKUP, USED WITH ELECTRONICS THAT HAVE PRE-OUT JACKS FOR THE LEFT AND RIGHT FRONT CHANNELS (**Figure 9**)

- Connect your front speakers to your receiver or amplifier in the normal way (**Figure 8**). If your pre-amp, processor, amplifier or receiver has a spare set of front left and right pre-outs, connect them to the Line Level “In” jacks of the subwoofer. Use well-shielded RCA cables. If your pre-amp, processor, amplifier or receiver has a single set of pre-outs and they are being used to deliver signal to an amplifier, use “Y” cables as shown in (**Figure 9**).

RM7600 HOOKUP OPTIONS

OPTION 1—SPEAKER WIRE HOOKUP, OUR FAVORITE HOOKUP METHOD (**Figure 8**):

- Using Speaker Wire, connect the left and right front speaker outputs of your receiver or amplifier to the “speaker level” (wire) inputs of the powered subwoofer.
- Then, connect the left and right front satellite speakers with speaker wire from the “speaker level” outputs of the powered subwoofer.
- Connect the Center Channel Speaker directly to the center channel output from your receiver.
- Connect the Rear Surround Satellites directly to the rear or surround channel outputs from your receiver.

OPTION 2—LINE LEVEL HOOKUP, USED WITH ELECTRONICS THAT HAVE PRE-OUT JACKS FOR THE LEFT AND RIGHT FRONT CHANNELS (**Figure 9**):

- Connect your front speakers to your receiver or amplifier in the normal way (**Figure 8**). If your pre-amp, processor, amplifier or receiver has a spare set of front left and right pre-outs, connect them to the Line Level “In” jacks of the subwoofer. Use well-shielded RCA cables. If your pre-amp, processor, amplifier or receiver has a single set of pre-outs and they are being used to deliver signal to an amplifier, use “Y” cables as shown in (**Figure 9**).

RECEIVER SET-UP/BASS MANAGEMENT FOR RM7200 & RM7600 SYSTEMS

All surround receivers allow you to “customize” their performance depending on the size of your speakers. Refer to the owner’s manual of your receiver or surround processor to learn how this is done. To get the best performance from your RM7000 Series Home Theater Systems, use the following settings **with the above hook-up methods**:

- Front speakers—set to “large”
- Center speaker—set to “normal” or “small”
- Surround speakers—set to “small”
- Subwoofer—set to “OFF” or “none.” (We know; doesn’t make sense, right? Both your RM7200 and RM7600 have subwoofers. But really truly, this is the correct setting for the recommended Speaker Wire and Line Level hookup methods. In the Speaker Wire Hookup, setting the front left and right speakers to “Large” and routing them through the subwoofer’s low pass filter delivers a full range signal to the subwoofer’s low pass filter. The low pass filter takes the low frequencies and passes the rest on to the front speakers, for perfect sub/sat blending. In the Line Level Hookup, setting the front left and right speakers to “Large” and choosing subwoofer “OFF” directs all the bass and LFE channel information to the subwoofer via the left and right pre-amp outputs.)

WALL-MOUNTING YOUR RM7200 & RM7600 SATELLITES & CENTER CHANNEL SPEAKER (**Figures 10–12**)

All five satellites of both the RM7200 and RM7600 Systems have integrated wall-mounting brackets built onto the rear of each speaker. On-wall installation of these RM speakers requires basic skills and basic tools (drill and screwdriver). If you are in doubt that you possess the necessary skills or tools, consult your Polk dealer or a professional installer. Otherwise, follow the steps below to safely secure the speakers to the location of your choice.

- Make sure the material on which you plan to mount the speakers (plaster, drywall, paneling, stone, etc.) can support the weight of the speakers (**See product weight specifications on page 14**).
- Make sure the locations you select do not conceal electrical wiring or plumbing.
- Prior to installation, hold the speaker in the chosen location to make sure it safely clears obstacles such as ceiling, adjacent walls, corners, beams, lighting fixtures and door/window frames.
- Using the keyhole slots in the bracket template (included), mark the installation location of the keyhole slots with a pencil (**Figure 10**). Orient the template so that the small ends of the keyhole slots are facing “up” according to the direction of installation.
- If you are certain that there is a stud behind the wall surface, drive #10 screws (not included) through the wall and into the stud (**Figure 11a**).
- If there is no stud behind the wall at the chosen location, install #10 wall anchors (not supplied) into the wall by following the wall-anchor-manufacturer’s instructions (**Figure 11b**).
- For masonry walls, use a masonry drill bit and #10 masonry anchor and screw (not included).
- Tighten screws into stud or wall anchors, leaving screw heads protruding 1/16" (1.6mm).
- Line up the keyhole slots on the bracket so that the screw heads pass through the large center hole of the slots.
- Let the speaker slide straight down, allowing the screw head to slip behind the smaller end of the keyhole slot (**Figure 12**).
- Tug gently on the speaker to make certain that the screws and bracket are properly aligned and that the wall anchors are secure.
- If the bracket is not held snug against the wall by the screw heads, remove the speaker from the wall, drive the screws in a little further and then remount the speaker.

RM7200 POWERED SUBWOOFER ADJUSTMENTS (Figure 13)

The RM7200 Powered Subwoofer offers a range of setting options. We recommend the following settings as starting points, but the settings that are best for you depend upon your speaker placement, electronics and personal taste. After you've become familiar with what the settings do, experiment with alternate options to find the method that works best for your system setup.

You'll find an informative article on "Subwoofer Positioning and Adjustment" in the set up section at <http://www.polkaudio.com/home/faqad/>.

RM7200 AC POWER (Figure 13)

The RM7200 Powered Subwoofer has a built-in power amplifier and must be plugged into a standard household AC power source in order to operate. The power switch has three positions: "On," "Off" and "Auto" (**Figure 13**). When the Powered Subwoofer is plugged in (even with the power switch in the "off" position) the power light will glow RED. In the "Auto" position, the amplifier will automatically turn on as soon as the speaker senses a signal coming from your electronics. The power light will change from RED to GREEN upon sensing a signal. The subwoofer will turn off approximately 15 minutes after input signal ceases, and the power light will return to RED. In the "On" position, the power amplifier will operate and the power light will glow GREEN until the switch is set to the "Off" position or the AC cord is disconnected from a power source. We recommend using the "Auto" position. Turn it to "Off" if the system will not be used for extended periods of time, such as during vacations.

RM7200 SUBWOOFER LEVEL CONTROL (Volume)

Subwoofer level (volume) is adjusted via the knob on the rear amplifier plate. To set Subwoofer Level, play a piece of music that has an average amount of bass content. Start with the knob set to "5" and the Phase Switch set to 0. Adjust by ear using a wide variety of CDs and video sources. Adjust for deep, powerful bass without "boominess."

RM7200 LOW PASS FILTER

This control adjusts the frequency range over which the subwoofer operates. With the RM7200, the upper range of this control will yield the best results. Experiment and let your ears be the final judge. If male vocals sound "thin," turn this control up until the voice sounds rich but not boomy. If male vocals sound too "thick" or "chesty," turn this control down until the voice sounds natural.

RM7200 RECOMMENDED SETTINGS — ON WALL & OFF WALL (Figures 13, 15a & 15b)

Mounting your right and left front satellites on the wall tends to increase their low-midrange response (the low range of a male voice). Mounting them on stands away from the sides of the room tends to decrease their low-midrange response. If you mount the satellites on the wall, we recommend setting your variable crossover control (see **Figure 13**) at a lower setting (**Figure 15a**). If you mount the satellites on stands, we recommend setting your variable crossover control at a higher setting (**Figure 15b**).

Turning the knob up from the recommended setting (**Figure 15a or 15b**) will add more "warmth" to the bass and lower midrange, possibly at the sacrifice of bass "tightness" and midrange clarity. Turning the knob down from the recommended setting will make the bass and lower midrange sound "thinner."

RM7200 PHASE SWITCH

Changing the phase of your subwoofer can strengthen its bass "attack." If the bass sounds muddy or unclear, try toggling the phase control. Have someone else switch between the two settings while you sit in your favorite listening position. Use music with good bass (preferably "plucked" string bass) and a deep male vocal. When you hear the best balance of deep bass and natural lower octaves of the male voice, you have achieved optimum phase tuning.

RM7600 POWERED SUBWOOFER ADJUSTMENTS (Figure 14)

The RM7600 Powered Subwoofer offers a wide range of setting options. We recommend the following settings as starting points, but the settings that are best for you depend upon your speaker placement, electronics and personal taste. After you've become familiar with what the settings do, experiment with alternate options to find the method that works best for your system setup.

Outside the US:

These adjustments are specific to the Polk Audio PSW650 Model Subwoofer. If you are using a subwoofer other than the PSW650, please refer to that subwoofer's owner's manual for correct, model-specific adjustment instructions

You'll find an informative article on "Subwoofer Positioning and Adjustment" in the set up section at <http://www.polkaudio.com/home/faqad/>.

RM7600 AC POWER (Figure 14)

The RM7600 Powered Subwoofer has a built-in power amplifier and must be plugged into a standard household AC power source in order to operate. The power switch has three positions: "On," "Off" and "Auto" (Figure 14). The Powered Subwoofer also has a small GREEN light under the Level Control Pod on the subwoofer's front face. This light is not illuminated when the Subwoofer power switch is in the "Off" position. In the "Auto" position, the amplifier will automatically turn on as soon as the speaker senses a signal coming from your electronics. The power light will glow GREEN upon sensing a signal. The subwoofer will turn off approximately 15 minutes after input signal ceases, and the power light will go off. In the "On" position, the power amplifier will operate and the power light will glow GREEN until the switch is set to the "Off" position or the AC cord is disconnected from a power source. We recommend using the "Auto" position. Turn it to "Off" if the system will not be used for extended periods of time, such as during vacations.

RM7600 SUBWOOFER LEVEL CONTROL (Volume)

Subwoofer level (volume) is adjusted via the knob on the front of the subwoofer under the logo pod. This lets you adjust the level of bass easily after you have made the more complex adjustments on the rear of the Subwoofer. To set level, play a piece of music that has an average amount of bass content. Start with the knob set to "5" and the Phase Switch set to 0. Adjust by ear using a wide variety of CDs and video sources. Adjust for deep, powerful bass without "boominess."

RM7600 SETTINGS

On the back of the subwoofer (Figure 14), you will see the following controls:

- Variable crossover control
- Phase toggle switch
- +3dB bass boost switch
- High Pass Filter toggle switch (You will never need to change this out of the "0" position. Trust us.)

The Subwoofer Level Control is found under the logo pod on the front of the subwoofer.

RM7600 VARIABLE CROSSOVER FREQUENCY CONTROL

This control adjusts the frequency range over which the subwoofer operates. It only effects signals that are sent through the low level, subwoofer and Speaker Wire inputs. It has no effect on signals fed into the LFE input (and you shouldn't be using that input anyway).

RM7600 RECOMMENDED SETTINGS — ON WALL & OFF WALL (Figures 14, 15 & 15b)

Mounting your right and left front satellites on the wall tends to increase their low-midrange response (the low range of a male voice). Mounting them on stands away from the sides of the room tends to decrease their low-midrange response. If you mount the satellites on the wall, we recommend setting your variable crossover control (see Figure 14) at a lower setting (Figure 15a). If you mount the satellites on stands, we recommend setting your variable crossover control at a higher setting (Figure 15b).

Turning the knob up from the recommended setting (Figure 15a or 15b) will add more "warmth" to the bass and lower midrange, possibly at the sacrifice of bass "tightness" and midrange clarity. Turning the knob down from the recommended setting will make the bass and lower midrange sound "thinner."

RM7600 PHASE SWITCH

Changing the phase of your subwoofer can strengthen its bass "attack." If the bass sounds muddy or unclear, try toggling the phase control. Have someone else switch between the two settings while you sit in your favorite listening position. Use music with good bass (preferably "plucked" string bass) and a deep male vocal. When you hear the best balance of deep bass and natural lower octaves of the male voice, you have achieved optimum phase tuning.

RM7600 +3dB BASS BOOST

In most cases, this switch should be set to "0." If you have hooked up the subwoofers from a subwoofer output or pre-out jacks and cannot get enough bass output even with the subwoofer level control turned all the way up, switch to the +3dB position. In typical systems where the 3dB boost is not needed, this switch can be useful for providing a quick boost for bass-shy program material. Most people prefer more bass output for movies than music so you can use this switch as a handy way to adjust bass levels as you switch between movie and music sources.

Q. "WHY DOES MY SYSTEM HUM?"

BECAUSE IT DOESN'T KNOW THE WORDS.

This is what passes for humor in the audio business. Here's the real answer: If you have any electrical (50/60Hz) hum in your system you're going to hear it clearly as soon as you hook up your subwoofer. Most hum problems are caused by "ground loops." That is, the electrical grounds of the components in your system are not at the same electrical potential. A very common ground loop source is cable TV. Disconnect the coaxial cable from your TV and/or VCR. If the hum goes away, the cable is the ground loop villain. In that case you need a 75 ohm ground loop isolator. This device attaches to your coaxial cable where it plugs into your VCR (or television). They're simple to install and usually solve the hum problem. Find 75 ohm ground loop isolators at your audio dealer, Radio Shack stores, or online at <http://polkaudio.tranguard.com/>.

Ground loops and hum can also be the result of faulty electrical wiring in your home. Consult a licensed electrician to evaluate and, if necessary, repair the AC wiring in your home. Light dimmers also tend to introduce noise into audio systems. Remove them.

If none of our suggestions work for you, contact Polk Audio Customer Service 800-377-7655 (US & Canada), 410-764-5266, 9am-6pm EST, Monday through Friday, or email: polkcs@polkaudio.com.

SAFE LIMITS OF OPERATION FOR RM7000 SERIES LOUDSPEAKERS

Your Polk Audio loudspeakers are made with the highest-quality materials to ensure years of great sounding, trouble-free performance. However, damage to loudspeakers can occur when an amplifier, regardless of its wattage, is made to play at higher listening levels that its power can clearly produce. (This is usually beyond the "1 to 2 o'clock" position on the volume control.) This results in very high levels of audible distortion originating in the amplifier, which adds a harsh, gritty sound to the music you're listening to. Contrary to popular belief, a speaker is more likely to be damaged by trying to get too much volume from a low-powered amp or receiver (than from a high-powered one).

TAKING CARE OF YOUR RM7000 LOUDSPEAKERS (Figure 16)

Your new RM7000 Series Loudspeakers are finished in rugged vinyl. Avoid harsh detergents and cleaning fluids, as they can permanently damage your speakers' finish (**Figure 16**). Instead, clean the speaker cabinets with non-abrasive products like Windex or Brilliantize Brand products and a clean soft cloth. Gently vacuum the grilles to remove dust.

TECHNICAL ASSISTANCE OR SERVICE

If, after following these hook up directions, you experience difficulty, please double-check all wire connections. Should you isolate the problem to the speaker, contact the authorized Polk Audio dealer where you made your purchase, or call Polk Audio's friendly Customer Service Department at 1-800-377-7655 (calls from US or CAN only), 410-764-5266 9am to 6pm EST, Monday through Friday. You may also contact us via email: polkcs@polkaudio.com.

For more detailed hook up information and manual updates, visit

<http://www.polkaudio.com/home/products/systems/RM7200>

or

<http://www.polkaudio.com/home/products/systems/RM7600>

or

<http://www.polkaudio.com/home/faqad/>

For recommended accessories (including speaker stands, brackets, accessories and exclusive Polk Audio logowear), visit our Webstore: <http://polkaudio.tranguard.com/>

Figure 1

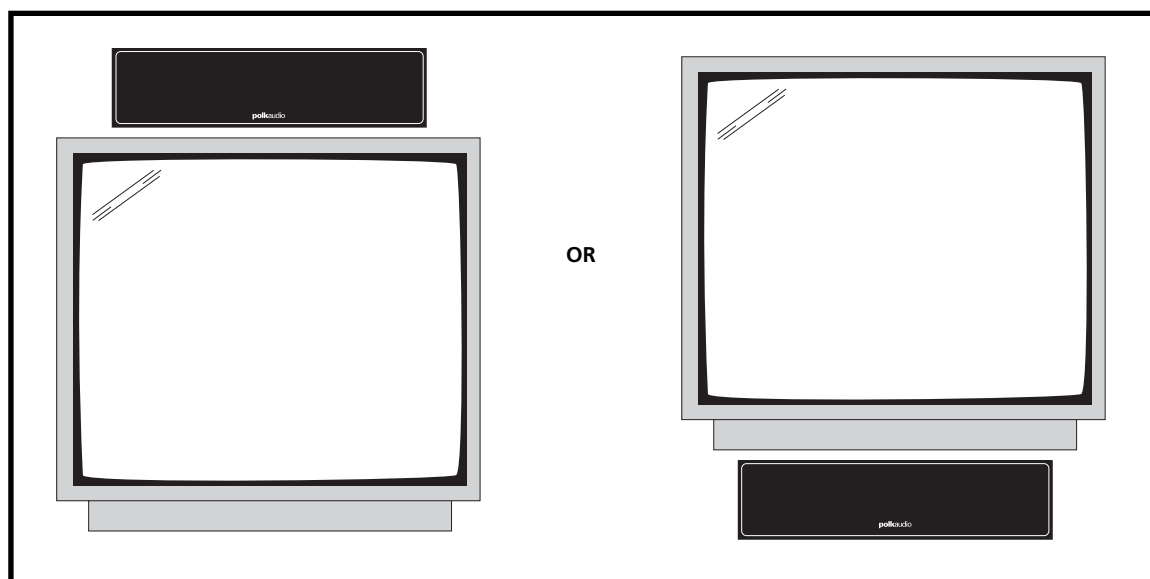

Most popular placement, above the TV screen. RM7000 Series Center Channel Speakers can also be wall mounted. RM7000 Series Loudspeakers are magnetically shielded for safe placement near TV or video monitors. If you notice video distortion or discoloration, immediately move the speakers away from the video source and call Polk Audio Customer Service 800.377.7655 (US & Can) or polkcs@polkaudio.com.

Esta es la ubicación más popular, sobre el televisor. Los altavoces de canal central de la serie RM7000 también se pueden montar en la pared. Los altavoces de la serie RM7000 tienen blindaje magnético para poder ubicarlos con seguridad cerca de televisores o monitores de video. Si nota que hay distorsión o descoloración del video, aleje inmediatamente los altavoces de la fuente de video y llame al Servicio al Cliente de Polk Audio al 800.377.7655 (EE.UU. y Canadá) o escriba a polkcs@polkaudio.com.

Disposition la plus courante, au-dessus de l'écran. Les enceintes centrales de la Série RM7000 peuvent également être installées au mur. Elles sont blindées magnétiquement et peuvent être disposées à proximité d'une télé ou d'un moniteur vidéo. Si vous percevez de la distorsion ou de la décoloration vidéo, éloignez immédiatement les enceintes de l'écran et communiquez avec le service à la clientèle de Polk. 800-377-7655 (É-U et Can) ou polkcs@polkaudio.com.

Häufigste Platzierung—über dem Fernsehbildschirm. Lautsprecher der Serie RM7000 können auch an der Wand montiert werden. Diese Lautsprecher (RM7000) sind für eine Platzierung in der Nähe von Fernsehgeräten oder Videomonitoren magnetisch abgeschirmt. Wenn Sie eine Verzerrung oder Verfärbung des Videobildes bemerken, sind die Lautsprecher umgehend von der Videoquelle zu entfernen. Setzen Sie sich in diesem Fall mit dem Kundendienst von Polk Audio in Verbindung (telefonisch unter: 1 (800) 377.7655—gebührenfrei, nur in den USA/Kanada—oder per E-Mail an: polkcs@polkaudio.com).

Figure 2

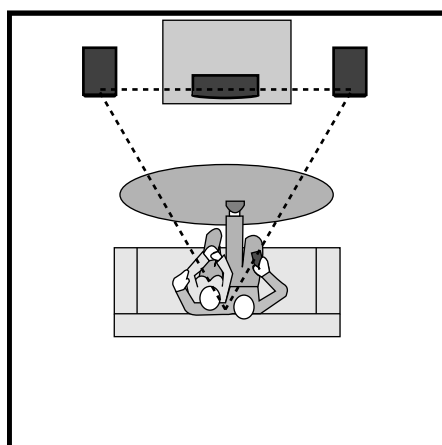

Front speaker array. Create an equilateral triangle between the speakers and the listening position. RM7000 Series Loudspeakers are magnetically shielded for safe placement near TV or video monitors. If you notice video distortion or discoloration, immediately move the speakers away from the video source and call Polk Audio Customer Service 800.377.7655 (US & Can) or polkcs@polkaudio.com.

Disposición de los altavoces frontales. Forme un triángulo equilátero entre los altavoces y la posición de audición. Los altavoces de la serie RM7000 tienen blindaje magnético para poder ubicarlos con seguridad cerca de televisores o monitores de video. Si nota que hay distorsión o descoloración del video, aleje inmediatamente los altavoces de la fuente de video y llame al Servicio al Cliente de Polk Audio al 800.377.7655 (EE.UU. y Canadá) o escriba a polkcs@polkaudio.com.

Disposition des enceintes avant. Créez un triangle équilatéral entre les enceintes et la position d'écoute. Les enceintes de la série RM7000 sont blindées magnétiquement et peuvent être disposées à proximité d'une télé ou d'un moniteur vidéo. Si vous percevez de la distorsion ou de la décoloration vidéo, éloignez immédiatement les enceintes de l'écran et communiquez avec le service à la clientèle de Polk. 800-377-7655 (É-U et Can) ou polkcs@polkaudio.com.

Anordnung der vorderen Lautsprecher. Bilden Sie ein Dreieck zwischen den Lautsprechern und Ihrer Hörposition. Diese Lautsprecher (RM7000) sind für eine Platzierung in der Nähe von Fernsehgeräten oder Videomonitoren magnetisch abgeschirmt. Wenn Sie eine Verzerrung oder Verfärbung des Videobildes bemerken, sind die Lautsprecher umgehend von der Videoquelle zu entfernen. Setzen Sie sich in diesem Fall mit dem Kundendienst von Polk Audio in Verbindung (telefonisch unter: 1 (800) 377.7655 - gebührenfrei, nur in den USA/Kanada - oder per E-Mail an: polkcs@polkaudio.com).

Figure 3a

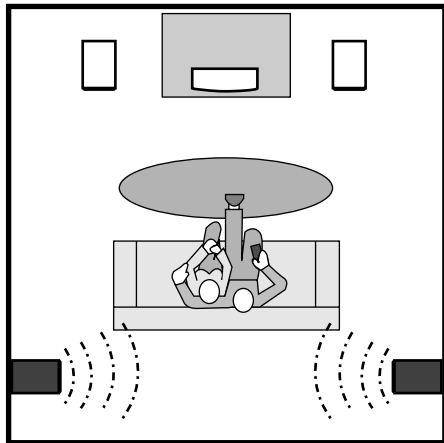
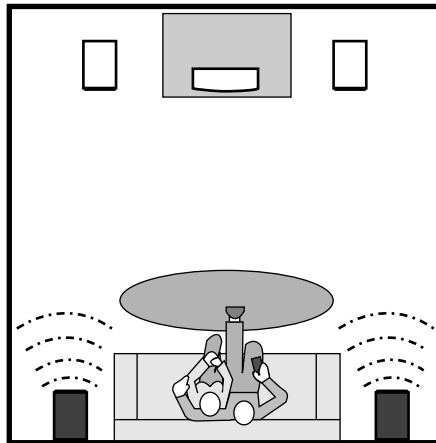

Figure 3b



Placement options for rear/surround speakers.

Opciones de ubicación de los altavoces surround o de atrás.

Options de disposition des enceintes arrière- ambiophoniques.

Platzierungsoptionen für hintere Lautsprecher bzw. Surround-Lautsprecher.

Figure 4

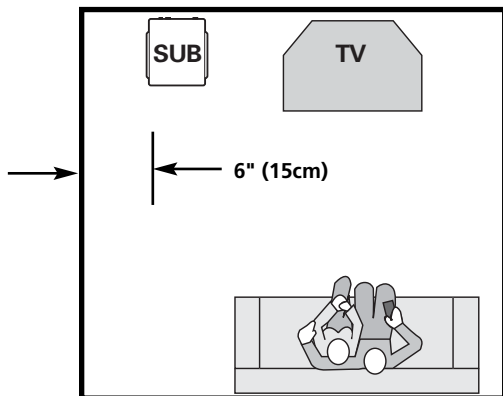

Allow at least 6" (15cm) between sub driver and wall or obstruction.

Deje por lo menos 15 cm (6 plg.) entre el excitador del subwoofer y la pared o la obstrucción.

Assurez un dégagement d'au moins 15cm (6po) entre le transducteur du subwoofer et le mur (ou toute autre obstruction).

Lassen Sie mindestens 15 cm Abstand zwischen dem Subwoofer (Treiber) und der Wand oder anderen Gegenständen.

Figure 5

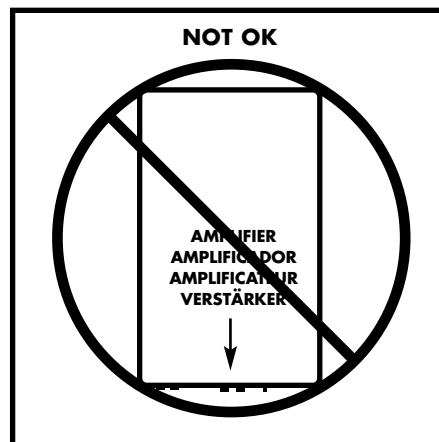

NEVER LAY THE SUBWOOFER ON ITS AMPLIFIER END. THIS WILL DAMAGE THE SUBWOOFER.

NUNCA COLOQUE EL SUBWOOFER SOBRE EL EXTREMO DE SU AMPLIFICADOR. ESTO DAÑARÍA EL AMPLIFICADOR.

NE COUCHEZ JAMAIS LE SUBWOOFER SUR SON AMPLIFICATEUR. L'AMPLIFICATEUR SERA ENDOMMAGÉ.

LEGEN SIE DEN SUBWOOFER NIE AUF DAS VERSTÄRKERENDE. DADURCH WIRD DER SUBWOOFER BESCHÄDIGT.

Figure 6

Using push tab connectors.

Uso de conectores de plástico.

Utilisation des bornes à languettes de plastique.

Verwendung der Kunststoffanschlüsse.

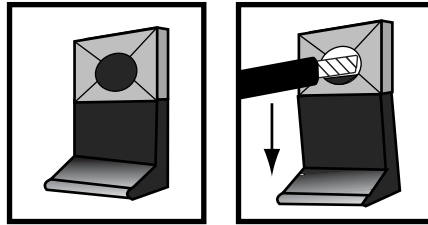
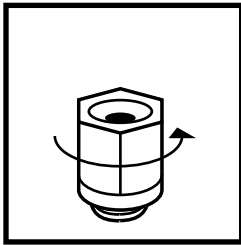

Figure 7

Using binding post connectors.



Loosen hex nut.

Desentornille la tuerca hexagonal.

Desserrer l'écrou.

Sechskantmutter lösen.

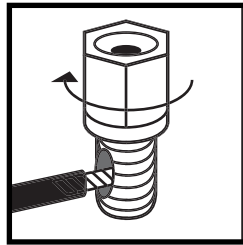

Insert speaker wire through hole.

Inserte el cable conector del altoparlante a través del orificio.

Insérer le fil du haut-parleur dans le trou.

Lautsprecher-draht durch das loch schieben.

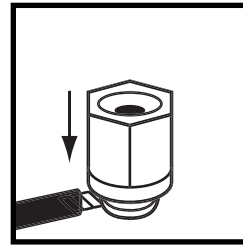

Tighten hex nut.

Asegure la tuerca hexagonal.

Serrer l'écrou.

Sechskantmutterfestschrauben.

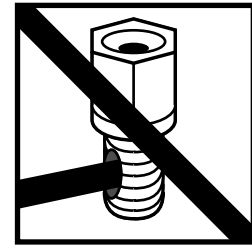

Do not insert insulated section of speaker wire.

No inserte la sección aislada del cable conector del altoparlante.

Ne pas insérer la partie isolée du fil du haut-parleur.

Isolation des lautsprecher-drahtes nicht in das loch schieben.

To use Banana Plugs (US only): Carefully pry out the Binding Post Plugs (plastic plugs on the end of the binding posts) to expose Banana Plug holes. Insert Banana Plugs. **(This is for US owners only.)**

Figure 8

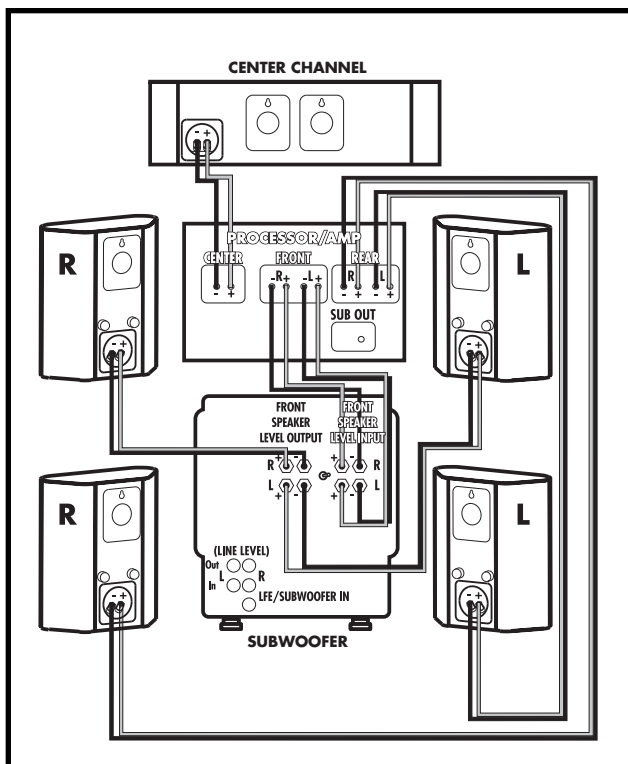

Basic Speaker Wire Hookup method. We recommend this method for best blending.

Método básico de conexión de los cables del altavoz. Recomendamos este método para obtener la mejor mezcla.

Branchement élémentaire des fils de haut-parleurs. Méthode recommandée pour la meilleure sonorité.

Grundlegende Methode zum Anschluss der Lautsprecherkabel. Zur Gewährleistung des optimalen Hörerlebnis empfehlen wir diese Methode.

Figure 9

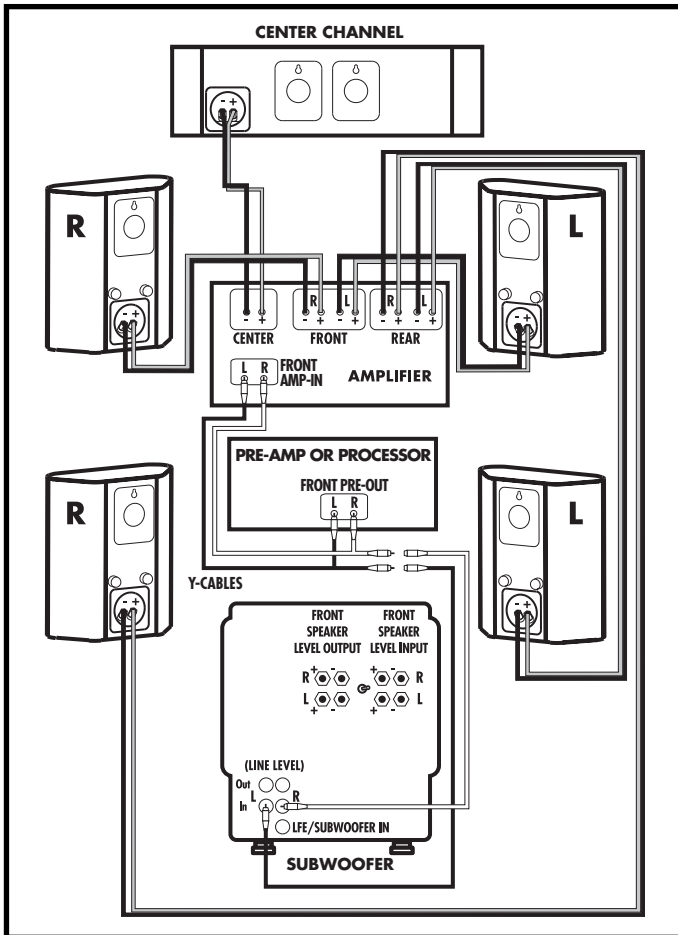

Line Level Hookup method using pre-amp outs.
 Método de conexión usando cables con conectores RCA para salidas de preamplificador.
 Branchement aux sorties niveau de ligne du préamplificateur.
 Line-Level-Anschlussmethode mit Vorverstärker-Ausgängen.

Figure 11

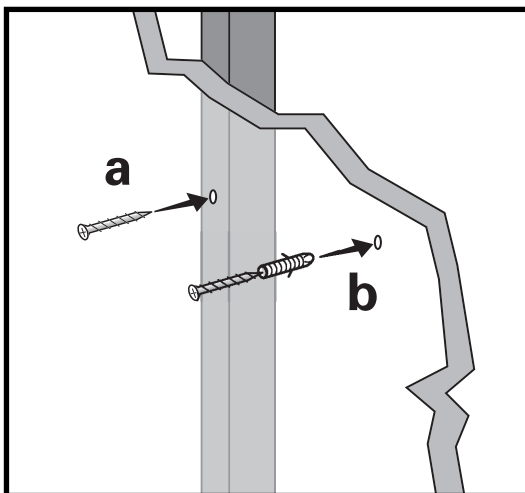

Use #10 screw for wall stud, use #10 wall anchors + screw for no wall stud.

Use tornillos n° 10 cuando haya paralelos en la pared, use to rnillos y anclas n° 10 cuando no haya paralelos internos.

Utilisez des vis #10 pour fixation sur un montant ou des chevilles #10 avec vis s'il n'y a pas de montant.

Verwenden Sie eine Schraube Nr. 10 für Wände mit Holzstielverstärkung bzw. Dübel und Schrauben (Nr. 10) für Wände ohne Holzstielverstärkung.

Figure 10

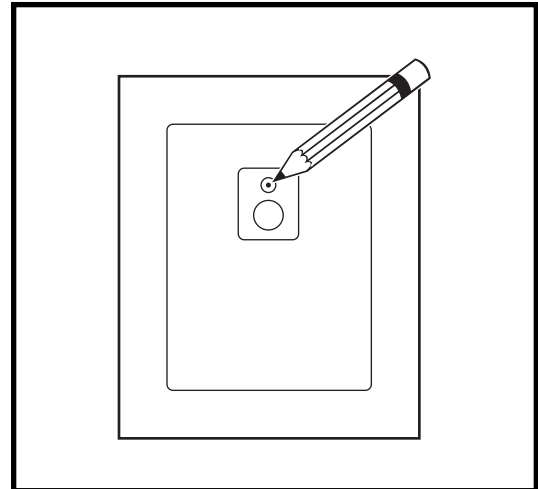

Use template to mark mounting location.
 Use la plantilla para marcar la ubicación de montaje.
 Utilisez le gabarit pour marquer l'endroit de l'installation.
 Verwenden Sie die Schablone zur Markierung der Befestigungsstelle.

Figure 12

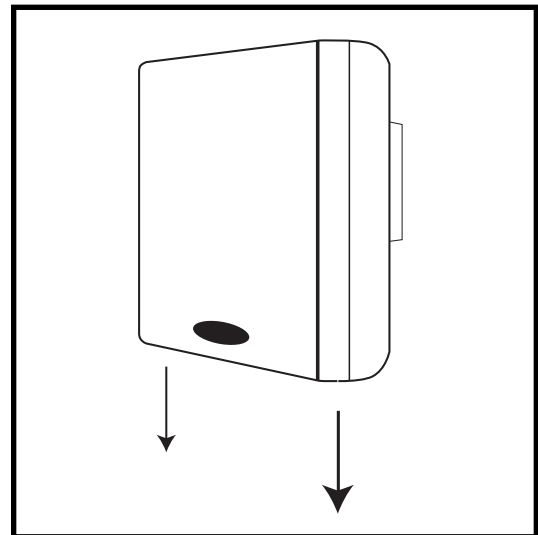

Slide the speaker down on the screw heads to catch the keyhole slots.
 Deslice el altavoz sobre las cabezas de los tornillos para que encajen en las ranuras en forma de cerradura.

Glissez l'enceinte sur les têtes de vis jusqu'à ce que les encoches en trou de serrure s'enclenchent.

Schieben Sie den Lautsprecher auf die Schraubköpfe herunter, so dass er in den Ritzen einrastet.

Figure 13

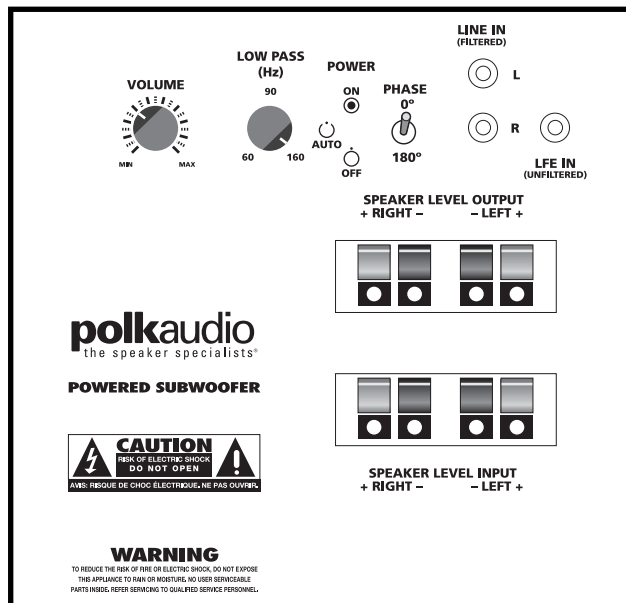

Rear of RM7200 Powered Subwoofer showing controls.

Parte de atrás del subwoofer de potencia RM7200. Se ven los controles.

Arrière et contrôles du subwoofer amplifié RM7200.

Rückseite des Subwoofers (mit RM7200) mit Steuerungen.

Figure 14

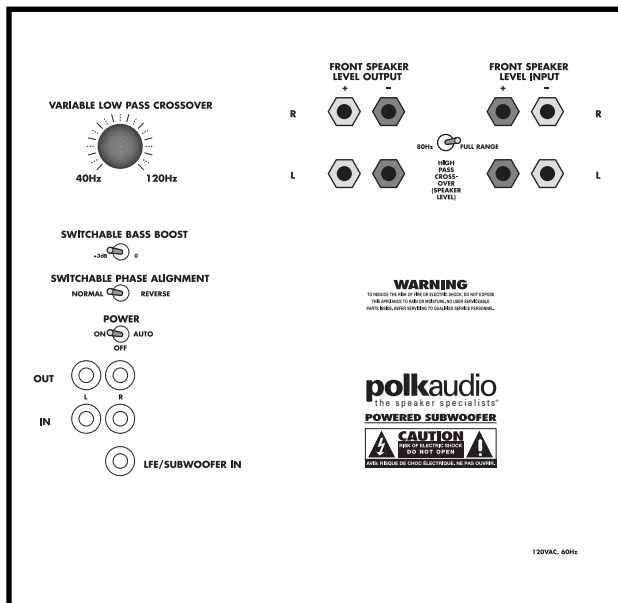

Rear of PSW650 Subwoofer used with RM7600, showing controls.

Parte de atrás del subwoofer PSW650 usado con el RM7600.

Se ven los controles.

Arrière et contrôles du subwoofer PSW650 utilisé avec le RM7600.

Rückseite des PSW650-Subwoofers (mit RM7600) mit Steuerungen.

Figure 15a

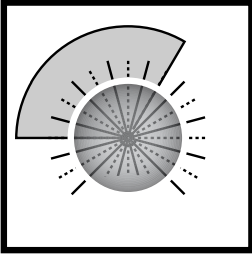

Recommended Variable Crossover Setting for wall mounted satellites.

Ajuste recomendado del crossover variable para satélites montados en la pared.

Réglage recommandé du séparateur de fréquences lorsque les satellites sont installés au mur.

Empfohlene variierbare Crossover-Einstellung für wandmontierte Satellitenlautsprecher.

Figure 15b

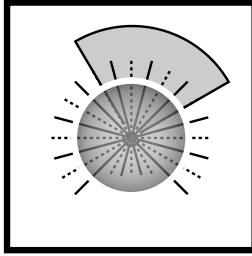

Recommended Variable Crossover Setting for satellites on stands.

Ajuste recomendado del crossover variable para satélites montados sobre pedestales.

Réglage recommandé du séparateur de fréquences lorsque les satellites sont posés sur des socles.

Empfohlene variierbare Crossover-Einstellung für Satellitenlautsprecher auf Ständern.

Figure 16

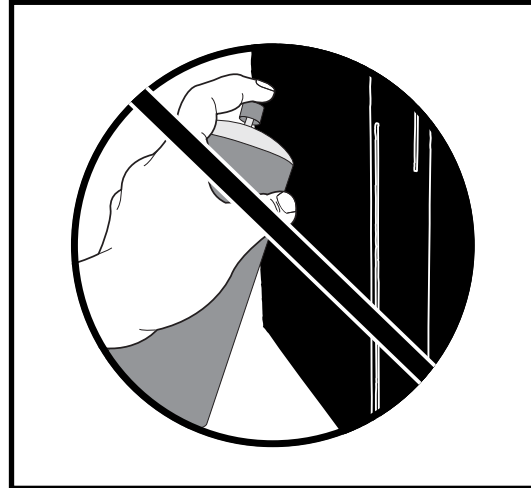

Do not use furniture polish on the Gloss veneer. Dust with a damp cloth only.

No use lustramuebles sobre el enchapado lustroso. Quite el polvo solamente con un paño húmedo.

N'utilisez jamais de poli à meubles sur le placage lustré. Époussetez seulement avec un chiffon humide.

Furnierte Hochglanzelemente sollten nicht mit Möbelpolitur gereinigt werden. Die Reinigung mit einem feuchten Tuch wird empfohlen.

SPECIFICATIONS

	RM3300 Satellite	RM3600 Center	RM7200 Subwoofer	RM7200 System	RM4300 Satellite	RM4600 Center	PSW650 Subwoofer	RM7600 System (with PSW650 subwoofer. Specifications will vary depending on subwoofer model supplied.)
Overall Freq Response	90Hz-23kHz	80Hz-23kHz	26Hz-200Hz	26Hz-23kHz	65Hz-26kHz	55Hz-26kHz	25 - 180Hz	25Hz-26kHz
-3dB Limits	125Hz-20kHz	115Hz-20kHz	32Hz-180Hz	32Hz-20kHz	90Hz-25kHz	80Hz-25kHz	28 - 125 Hz	28Hz-25kHz
Recommended Amplification	80W	80W	NA	20-125W	20-125W	20-125W	NA	20 -150 Watts/channel
Sensitivity @1m, 2.83Vrms drive level	89dB SPL	89dB SPL	NA	NA	89dB SPL	89dB SPL	NA	89dB SPL
Nominal Impedance	4 ohms	8 ohms	NA	NA	Compatible with 8 Ohm outputs	Compatible with 8 Ohm outputs	NA	Compatible with 8 Ohm outputs
Power Output	NA	NA	100W Continuous Average Power into 4 Ohms with < 1% THD, 30-200Hz	NA	NA	NA	165 W Continuous Average Power into 4 Ohms with < 1% THD, 30-200Hz	(see specification in subwoofer manual for power rating)
Mid-bass Driver Diameter (nominal)	3.25"	2 x 3.25"	NA	NA	5.25" (13.34 cm), shielded	2 x 5.25" (13.34 cm), shielded	NA	NA
Tweeter Diameter (nominal)	3/4" (19mm) Metalized Dome	3/4" (19mm) Metalized Dome	NA	NA	1" (25mm) Tri-laminate Dome	1" (25mm) Tri-laminate Dome	NA	NA
Subwoofer Driver Diameter (nominal)	NA	NA	8", Shielded	NA	NA	NA	2 - 10" (25 cm) Polymer composite drivers	(see specification in subwoofer manual)
Crossover Frequency	2.6kHz	3.1kHz	variable 60-160Hz, 90Hz optimal (Low-pass filter)	NA	2.5kHz	2.0kHz	60Hz - 160Hz, adjustable Low Pass Filter. Selectable 80Hz High Pass Filter on the line level outputs	(see specification in subwoofer manual)
Enclosure Type	vented	vented	vented with floor-coupled Power Port	NA	vented	vented	Power Port, vented	(see individual component's specs)
Dimensions	8" H x 6 3/4" W x 4" D (20.5cm H x 17.2cm W x 10cm D)	5 3/8" H x 14" W x 4 11/16" D (3.7cm H x 35.7cm W x 11.9cm D)	16 1/2" H x 13 1/2" W x 16 1/4" D (41.9cm H x 34.3cm W x 41.3cm D)	NA	11 1/4" H x 9 13/16" W x 5 1/2" D (28.6cm H x 24.9cm W x 28.6cm D)	6 5/16" H x 21 11/16" W x 5 3/4" D (16.1cm H x 55cm W x 14.6cm D)	18 3/4" H x 17-1/2" W x 19" D (47.62cm H x 44.45cm W x 48.26cm D)	(see individual component's specs)
Shipping Weight	10.5 lbs. (4.8kg) pair	9 lbs. (4.1kg) ea.	NA	70 lbs. (31.8kg) sys.	20 lbs. (9.1kg) pair	15 lbs. (6.8kg) ea.	75 lbs. (34kg) ea.	(see individual component's specs)
Product Net Weight	4.6 lbs. (2.1kg) ea.	7.7 lbs. (3.5kg) ea.	39 lbs. (17.7kg) ea.	NA	9.3 lbs. (4.2kg) ea.	13.5 lbs. (6.1kg) ea.	61 lbs. (27.7kg) ea.	(see individual component's specs)

POLK AUDIO LIMITED WARRANTY

Warranty for Satellites and Center Channel Loudspeakers

Polk Audio, Inc. warrants to the original purchaser only that this Polk Audio Loudspeaker Product (the "Product") will be free from defects in materials and workmanship for a period of five (5) years from the date of original retail purchase from a Polk Audio Authorized Dealer. However, this Warranty will automatically terminate prior to the expiration of the five (5) years if the original retail purchaser sells or otherwise transfers the Product to any other party. The original retail purchaser shall hereinafter be referred to as "you."

Warranty for Subwoofer

Polk Audio, Inc., warrants to the original purchaser only that the amplifier in this Polk Audio Loud-speaker Product (the "Product") will be free from defects in material and workmanship for a period of three (3) years from the date of original retail purchase from a Polk Audio Authorized Dealer. Polk Audio, Inc., further warrants to the original purchaser only that the Loudspeaker(s) in this Polk Audio Product (the "Product") will be free from defects in material and workmanship for a period of five (5) years from the date of original retail purchase from a Polk Audio Authorized Dealer. The original retail purchaser shall hereinafter be referred to as "you." However, this Warranty will automatically terminate prior to the expiration if you sell or otherwise transfer the Product to any other party.

To allow Polk Audio to offer the best possible warranty service, please fill out the Product Registration Card(s) and send it to the Factory, at the address provided on the Product Cards(s) within ten (10) days of the date of purchase.

Defective Products must be shipped, together with proof of purchase, prepaid insured to the Polk Audio Authorized Dealer from whom you purchased the Product, or to the Factory at 2550 Britannia Boulevard, Suite D, San Diego, California 92154. Products must be shipped in the original shipping container or its equivalent; in any case the risk of loss or damage in transit is to be borne by you. If upon examination at the Factory or Polk Audio Authorized Dealer it is determined that the unit was defective in materials or workmanship at any time during this Warranty period, Polk Audio or the Polk Audio Authorized Dealer will, at its option, repair or replace this Product at no additional

charge, except as set forth below. All replaced parts and Products become the property of Polk Audio. Products replaced or repaired under this warranty will be returned to you, within a reasonable time, freight prepaid.

This warranty does not include service or parts to repair damage caused by accident, disaster, misuse, abuse, negligence, inadequate packing or shipping procedures, commercial use, voltage inputs in excess of the rated maximum of the unit, cosmetic appearance of cabinetry not directly attributable to defect in materials or workmanship, or service, repair, or modification of the Product which has not been authorized or approved by Polk Audio. This warranty shall terminate if the Serial number on the Product has been removed, tampered with or defaced.

This warranty is in lieu of all other expressed Warranties. If this Product is defective in materials or workmanship as warranted above, your sole remedy shall be repair or replacement as provided above. In no event will Polk Audio, Inc. be liable to you for any incidental or consequential damages arising out of the use or inability to use the Product, even if Polk Audio, Inc. or a Polk Audio Authorized Dealer has been advised of the possibility of such damages, or for any claim by any other party. Some states do not allow the exclusion or limitation of consequential damages, so the above limitation and exclusion may not apply to you.

All implied warranties on this Product are limited to the duration of this expressed Warranty. Some states do not allow limitation on how long an implied Warranty lasts, so the above limitations may not apply to you. This Warranty gives you specific legal rights, and you also may have other rights which vary from state to state.

This Warranty applies only to Products purchased in the United States of America, its possessions, and U.S. and NATO armed forces exchanges and audio clubs. The Warranty terms and conditions applicable to Products purchased in other countries are available from the Polk Audio Authorized Distributors in such countries.

polkaudio
the speaker specialists®

Polk Audio
5601 Metro Drive
Baltimore, Maryland 21215
800-377-7655

RM7208-1

RETURN THIS CARD TODAY AND RECEIVE THESE 3 IMPORTANT BENEFITS:



WARRANTY CONFIRMATION:

Your prompt product registration confirms your right to the protection available under the terms and conditions of your Polk Audio warranty.



PRODUCT PROTECTION:

We will keep the model number and date of purchase of your speakers on file in the event of an insurance claim such as theft or loss.



PRODUCT REGISTRATION:

Returning this card is your only way to guarantee that you will be notified by Polk Audio of any issues that arise concerning this product.

PLEASE DETACH HERE BEFORE MAILING.

polkaudio
the speaker specialists®

Thank you for your purchase. We at Polk Audio feel you are the most important person in our company. Your feedback will help us in our ongoing efforts to produce the finest and most satisfying loudspeaker available.

129 E

1 **First Name:** _____ **Initial:** _____ **Last Name:** _____

Address: (Number and Street) _____ **Apt #:** _____

City: _____ **State:** _____ **Zip Code:** _____

2 **Phone #:** _____

3 **E-mail Address:**
If you voluntarily provide us with your email address, you give us permission to share and use your email address to send you email offers that may interest you.

(EXAMPLE: yourname@yourhost.com)

4 **Date of Purchase:** _____
Month Day Year

6 **Store Name:** _____

7 **Who installed this product?**
1. Self 3. Friend / Relative
2. Professional

8 **Did the following reasons influence your purchase of this Polk Audio product?**

	Yes	No
1. Polk Audio Reputation	<input type="checkbox"/>	<input type="checkbox"/>
2. Ease of Use	<input type="checkbox"/>	<input type="checkbox"/>
3. Appearance	<input type="checkbox"/>	<input type="checkbox"/>
4. Recommendation of Dealer	<input type="checkbox"/>	<input type="checkbox"/>
5. Recommendation of Family/Friend	<input type="checkbox"/>	<input type="checkbox"/>
6. Magazine Review	<input type="checkbox"/>	<input type="checkbox"/>
7. Quality of Sound	<input type="checkbox"/>	<input type="checkbox"/>
8. Technical Specifications	<input type="checkbox"/>	<input type="checkbox"/>
9. Value for Price	<input type="checkbox"/>	<input type="checkbox"/>
10. Prior Experience with Polk Audio	<input type="checkbox"/>	<input type="checkbox"/>

9 **Where have you seen Polk products featured? (Check all that apply)**

1. <input type="checkbox"/> Magazine advertisement	4. <input type="checkbox"/> In-store advertising
2. <input type="checkbox"/> Polk literature	5. <input type="checkbox"/> Someone else's home or car
3. <input type="checkbox"/> Magazine review	6. <input type="checkbox"/> On-line computer bulletins

10 **What other brands did you consider? (Check all that apply)**

1. <input type="checkbox"/> No other brands	13. <input type="checkbox"/> KEF
2. <input type="checkbox"/> Acoustic Research	14. <input type="checkbox"/> Klipsch
3. <input type="checkbox"/> Advent	15. <input type="checkbox"/> M&K
4. <input type="checkbox"/> B&W	16. <input type="checkbox"/> Mirage
5. <input type="checkbox"/> Bose	17. <input type="checkbox"/> NHT
6. <input type="checkbox"/> Boston Acoustics	18. <input type="checkbox"/> Paradigm
7. <input type="checkbox"/> Cambridge Soundworks	19. <input type="checkbox"/> Phase Technology
8. <input type="checkbox"/> Cerwin-Vega	20. <input type="checkbox"/> Radio Shack
9. <input type="checkbox"/> Definitive Technology	21. <input type="checkbox"/> Sonance
10. <input type="checkbox"/> Eosone	22. <input type="checkbox"/> Velodyne
11. <input type="checkbox"/> Infinity	23. <input type="checkbox"/> Yamaha
12. <input type="checkbox"/> JBL	24. <input type="checkbox"/> Other

11 **Your gender:** 1. Male 2. Female

12 **Your marital status:** 1. Married 2. Single

13 **Date of your birth:** _____
Month Day Year

14 **Including yourself, what is the total number of people living in your household?**
(Examples: 01, 02, 03, 04...) _____

15 **Date of birth (month/year) of the other adults and children in your household:**

Male	Female	Male	Female
1. <input type="checkbox"/>	2. <input type="checkbox"/>	1. <input type="checkbox"/>	2. <input type="checkbox"/>
Month Year	Month Year	Month Year	Month Year
1. <input type="checkbox"/>	2. <input type="checkbox"/>	1. <input type="checkbox"/>	2. <input type="checkbox"/>
Month Year	Month Year	Month Year	Month Year

5



16 **For your primary residence, do you:**

1. Own 2. Rent

17 **Which best describes your family income?**

- | | |
|---|--|
| 1. <input type="checkbox"/> Under \$15,000 | 7. <input type="checkbox"/> \$100,000-\$124,999 |
| 2. <input type="checkbox"/> \$15,000-\$24,999 | 8. <input type="checkbox"/> \$125,000-\$149,999 |
| 3. <input type="checkbox"/> \$25,000-\$34,999 | 9. <input type="checkbox"/> \$150,000-\$174,999 |
| 4. <input type="checkbox"/> \$35,000-\$49,999 | 10. <input type="checkbox"/> \$175,000-\$199,999 |
| 5. <input type="checkbox"/> \$50,000-\$74,999 | 11. <input type="checkbox"/> \$200,000-\$249,999 |
| 6. <input type="checkbox"/> \$75,000-\$99,999 | 12. <input type="checkbox"/> \$250,000 or over |

18 **Education:**

(Please check which category applies to you):

1. Some high school 3. College degree
2. Completed high school 4. Graduate degree

19 **In the last six (6) months has anyone in your household purchased any of the following items through the mail and/or over the internet?**

- | | A. Mail | B. Internet |
|---------------------------------|--------------------------|--------------------------|
| 1. Books/magazines | <input type="checkbox"/> | <input type="checkbox"/> |
| 2. Children's products | <input type="checkbox"/> | <input type="checkbox"/> |
| 3. Clothes | <input type="checkbox"/> | <input type="checkbox"/> |
| 4. Insurance/financial products | <input type="checkbox"/> | <input type="checkbox"/> |
| 5. Music/video/DVD | <input type="checkbox"/> | <input type="checkbox"/> |
| 6. Travel | <input type="checkbox"/> | <input type="checkbox"/> |
| 7. Other | <input type="checkbox"/> | <input type="checkbox"/> |

20 **I use these credit cards:**

1. American Express 4. Visa
2. Gas/Retail 5. Other _____
3. Master Card 6. Do not have credit cards

21 **Someone in my home participates in the following activities:**
(Check all that apply)

- | | |
|---|---|
| 1. <input type="checkbox"/> Automotive work | 19. <input type="checkbox"/> Hunting/Shooting |
| 2. <input type="checkbox"/> Bible/devotional | 20. <input type="checkbox"/> Investments (mutual funds, IRAs) |
| 3. <input type="checkbox"/> Boating/sailing | 21. <input type="checkbox"/> Investments (stocks & bonds) |
| 4. <input type="checkbox"/> Camping/hiking | 22. <input type="checkbox"/> Movie watching |
| 5. <input type="checkbox"/> Casino gambling | 23. <input type="checkbox"/> Own a cat |
| 6. <input type="checkbox"/> Contribute to charitable causes | 24. <input type="checkbox"/> Own a dog |
| 7. <input type="checkbox"/> Crafts | 25. <input type="checkbox"/> Personal computing / internet |
| 8. <input type="checkbox"/> Cultural art/events | 26. <input type="checkbox"/> Photography |
| 9. <input type="checkbox"/> Cycling | 27. <input type="checkbox"/> Read books |
| 10. <input type="checkbox"/> Do-it-yourself | 28. <input type="checkbox"/> Snow skiing |
| 11. <input type="checkbox"/> Enter sweepstakes/contests | 29. <input type="checkbox"/> Self improvement |
| 12. <input type="checkbox"/> Fishing | 30. <input type="checkbox"/> Soccer |
| 13. <input type="checkbox"/> Fitness/exercise/jogging | 31. <input type="checkbox"/> Tennis |
| 14. <input type="checkbox"/> Gardening | 32. <input type="checkbox"/> Travel-Foreign |
| 15. <input type="checkbox"/> Golf | 33. <input type="checkbox"/> Travel-U.S |
| 16. <input type="checkbox"/> Gourmet cooking/food/wines | 34. <input type="checkbox"/> TV shopping |
| 17. <input type="checkbox"/> Grandchildren | 35. <input type="checkbox"/> Vitamins/natural foods |
| 18. <input type="checkbox"/> Home decorating | 36. <input type="checkbox"/> Watch sports on TV |

COMMENTS:

Thank you for purchasing

polkaudio

the speaker specialists®

Please send other correspondence to:

Polk Audio, Inc.
5601 Metro Drive
Baltimore, MD 21215
129 E



NO POSTAGE
NECESSARY
IF MAILED
IN THE
UNITED STATES

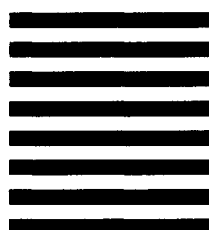

BUSINESS REPLY MAIL
FIRST-CLASS MAIL PERMIT NO. 18230 BALTIMORE, MD

POSTAGE WILL BE PAID BY ADDRESSEE

polkaudio
the speaker specialists®

**PRODUCT REGISTRATION DEPARTMENT
5601 METRO DRIVE
BALTIMORE MD 21215-9956**



RM 0296-1

PRODUCT REGISTRATION CARD

polkaudio

the speaker specialists®

By completing and returning the attached
Product Registration Card you will:

- **CONFIRM YOUR WARRANTY**
- **REGISTER YOUR PRODUCT**
- **PROTECT YOUR NEW PRODUCT**

REGISTER Online

It's faster...easier...and you get **COOL** stuff!

Register on-line to get:

- An entry into a **monthly drawing** for a **free** Polk subwoofer (home or car, your choice)
- The **peace of mind** that we have a record of your purchase to verify purchase date and warranty status.
- **Privacy.** The data we gather on our on-line registration is never sold or otherwise shared with anyone.
- **Free membership in Club Polk.** Club Polk members enjoy valuable services and benefits not available to the general public.
- A **free subscription** to Polk's newspaper *The Speaker Specialist*, to help you get better performance and more enjoyment from your audio system.

www.polkaudio.com/home/registration



Free Manuals Download Website

<http://myh66.com>

<http://usermanuals.us>

<http://www.somanuals.com>

<http://www.4manuals.cc>

<http://www.manual-lib.com>

<http://www.404manual.com>

<http://www.luxmanual.com>

<http://aubethermostatmanual.com>

Golf course search by state

<http://golfingnear.com>

Email search by domain

<http://emailbydomain.com>

Auto manuals search

<http://auto.somanuals.com>

TV manuals search

<http://tv.somanuals.com>