

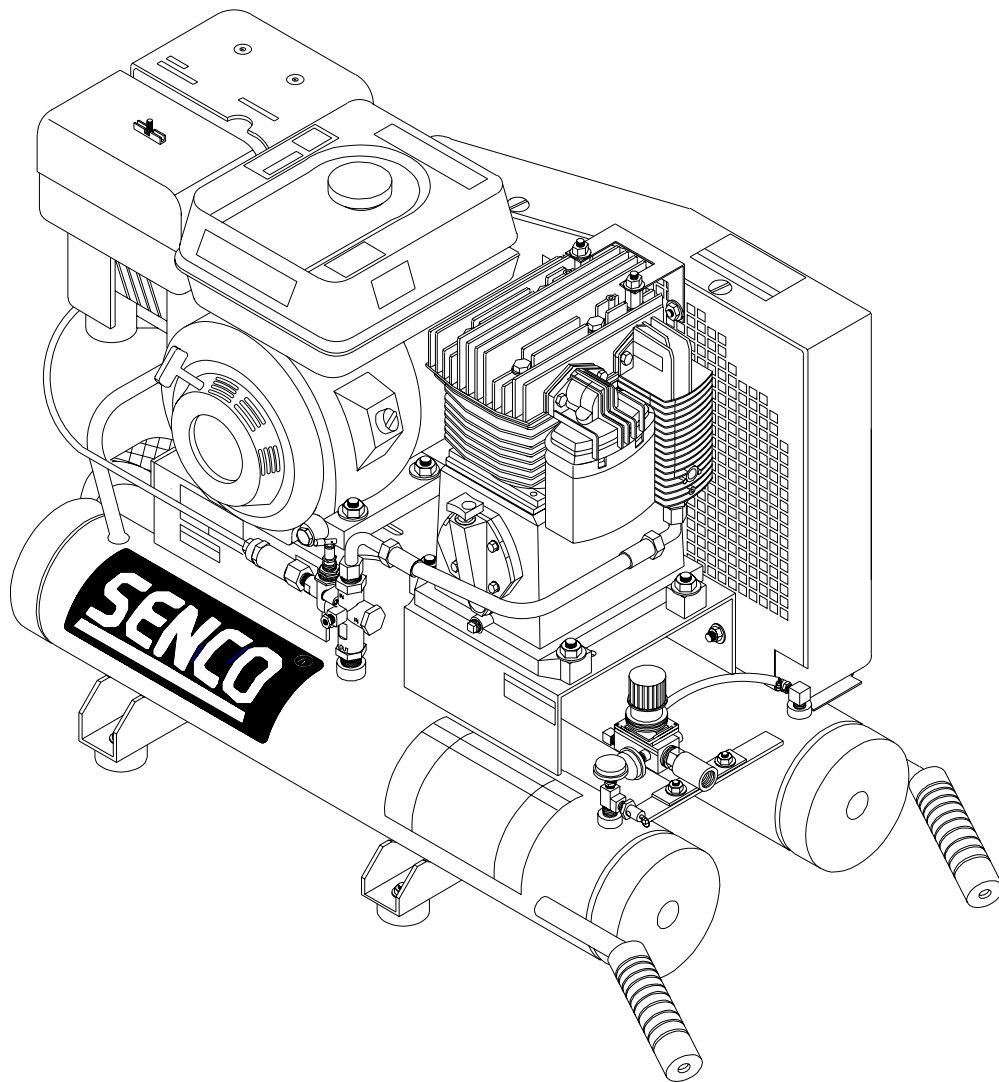

Questions? Comments? call SENCO's toll-free Action-line: 1-800-543-4596 or e-mail: toolprof@senco.com

PC2015 Gasoline Air Compressor



Operating Instructions

Document #MTM008 Issue Date: 04/06/00

© 2000 by SENCO Products, Inc.



Warnings for the safe use of this air compressor are included in this manual

TABLE OF CONTENTS

INTRODUCTION	3
SAFETY ALERT	3
INSPECTION	3
SAFETY WARNINGS	4-7
EXPLOSION OR FIRE	4
BURSTING	5
BREATHING	5
BURNS	6
FLYING OBJECTS	6
MOVING PARTS	6
NEGLIGENCE	7
AIR COMPRESSOR DAMAGE	7
FEATURES DRAWING	8
FEATURES REVIEW	9
PREPARATION	10
INITIAL SET-UP	10
LOCATION	10
GASOLINE ENGINE	10
OPERATION	11
PRE-START CHECKLIST	11
START-UP	11
SHUTDOWN	11
MAINTENANCE	11
TROUBLESHOOTING	12-13
SPECIFICATIONS	15
WARRANTY	16

INTRODUCTION

Congratulations on the purchase of your new Senco® Air Compressor! You can be assured your Senco® Air Compressor was constructed with the highest level of precision and accuracy. Each component has been rigorously tested by technicians to ensure the quality, endurance and performance of this air compressor.

This operator's manual was compiled for your benefit. By reading and following the simple safety, installation and operation, maintenance and troubleshooting steps described in this manual, you will receive years of troublefree operation from your new Senco® Air Compressor. The contents of this manual are based on the latest product information available at the time of publication. The manufacturer reserves the right to make changes in price, color, materials equipment, specifications or models at any time without notice.

SAFETY ALERT!

A "**DANGER, WARNING or CAUTION**" safety warning will be surrounded by a "**SAFETY ALERT BOX**". This box is used to designate and emphasize Safety Warnings that must be followed when operating this air compressor. Accompanying the safety warnings are "Signal Words" which designate the degree or level of hazard seriousness. The "Signal Words" used in this manual are as follows:

DANGER: Indicates an imminently hazardous situation which, if not avoided, WILL result in death or serious injury.

WARNING: Indicates a potentially hazardous situation which, if not avoided, COULD result in death or serious injury.

CAUTION: Indicates a potentially hazardous situation which, if not avoided MAY result in minor or moderate injury or damage to the air compressor.



The symbols set to the left of this paragraph are "Safety Alert Symbols". These symbols are used to call attention to items or procedures that could be dangerous to you or other persons using this equipment.

ALWAYS PROVIDE A COPY OF THIS MANUAL TO ANYONE USING THIS EQUIPMENT. READ ALL INSTRUCTIONS IN THIS MANUAL AND ANY INSTRUCTIONS SUPPLIED BY MANUFACTURERS OF SUPPORTING EQUIPMENT BEFORE OPERATING THIS AIR COMPRESSOR AND ESPECIALLY POINT OUT THE "SAFETY WARNINGS" TO PREVENT THE POSSIBILITY OF PERSONAL INJURY TO THE OPERATOR.

INSPECTION

Unbox the air compressor and write in the serial number in the space provided below. Inspect for signs of obvious or concealed freight damage. Be sure that all damaged parts are replaced and any mechanical problems are corrected prior to the operation of the air compressor.

SERIAL NUMBER _____

If you have Questions or Comments call SENCO's toll-free Action-line: **1-800-543-4596** or,
e-mail: toolprof@senco.com.

Please have the following information available for all service calls:

1. Model Number
2. Serial Number
3. Date and Place of Purchase

Senco® Corporation 8485 Broadwell Road, Cincinnati, OH 45244



SAFETY WARNINGS

READ ALL SAFETY WARNINGS BEFORE USING AIR COMPRESSOR

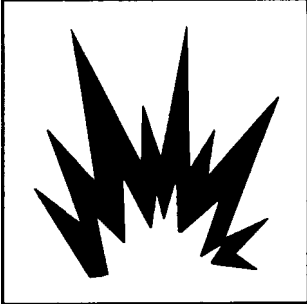
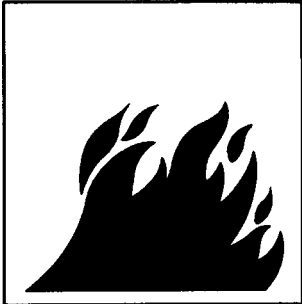
HAZARD	POTENTIAL CONSEQUENCE	PREVENTION
<p data-bbox="212 302 483 359">RISK OF EXPLOSION OR FIRE</p>  	<p data-bbox="566 302 967 420">Serious injury or death may occur from normal sparks in the engine ignition system or engine exhaust/muffler.</p> <p data-bbox="566 667 924 724">Injury or death may occur as a result of improper fueling.</p> <p data-bbox="566 1766 967 1908">Serious injury may occur if any air compressor ventilation openings are restricted, causing the air compressor to overheat and start on fire.</p>	<p data-bbox="1019 302 1414 449">Always operate air compressor in a well ventilated area free of flammable vapors, combustible dust, gases or other combustible materials.</p> <p data-bbox="1019 485 1414 632">If spraying flammable material, locate the air compressor at least 20 feet away from the spray area. (An additional hose may be required.)</p> <p data-bbox="1019 667 1406 724">Do not smoke while filling engine fuel tank.</p> <p data-bbox="1019 760 1430 877">Never fill the engine fuel tank while the engine is running or hot. Allow the engine to cool two minutes before refueling.</p> <p data-bbox="1019 913 1427 970">Do not refuel indoors or in a poorly ventilated area.</p> <p data-bbox="1019 1005 1430 1089">Always refuel slowly to avoid the possibility of spilled fuel which may cause a risk of fire.</p> <p data-bbox="1019 1125 1430 1272">Do not operate the unit if gasoline is spilled. Wipe the air compressor clean and move it away from the spill. Avoid creating any ignition until the gasoline has evaporated.</p> <p data-bbox="1019 1308 1398 1486">Do not store the air compressor near an open flame or any equipment such as a stove, furnace water heater, etc. which utilizes a pilot light or sparking device.</p> <p data-bbox="1019 1522 1422 1730">A spark arrester must be added to the muffler of this engine if it is to be used on any forest covered, brush covered or grass covered unimproved land. The arrester must be maintained in effective working order by the operator.</p> <p data-bbox="1019 1766 1427 1940">Never place objects against or on top of air compressor. Operate air compressor at least 12 inches away from any wall or obstruction that would restrict proper ventilation.</p>



SAFETY WARNINGS

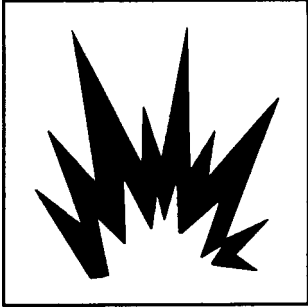
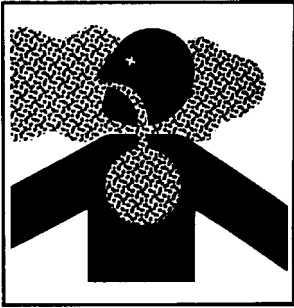

READ ALL SAFETY WARNINGS BEFORE USING AIR COMPRESSOR

HAZARD	POTENTIAL CONSEQUENCE	PREVENTION
<p style="text-align: center;">RISK OF BURSTING</p> 	<p>Serious injury or death may occur from an air tank explosion if air tanks are not properly maintained.</p> <p>Serious injury may occur from an air compressor malfunction or exploding accessories if incorrect system components, attachments or accessories are used.</p>	<p>Drain air tank daily or after each use to prevent moisture buildup in the air tank.</p> <p>If air tank develops a leak, replace the air tank immediately. Never repair, weld or make modifications to the air tank or its attachments. Use only genuine Senco® repair parts for your air compressor.</p> <p>Never make adjustments to the factory set pressures.</p> <p>Never exceed manufacturers maximum allowable pressure rating of attachments.</p> <p>Because of extreme heat, do not use plastic pipe or lead tin soldered joints for a discharge line.</p> <p>Never use air compressor to inflate small, low pressure objects such as toys.</p>
<p style="text-align: center;">RISK TO BREATHING</p> 	<p>Serious injury or death could occur from inhaling compressed air. The air stream may contain carbon monoxide, toxic vapors or solid particles.</p> <p>Serious injury or death may occur from inhaling engine exhaust.</p> <p>Sprayed materials such as paint, paint solvents, paint remover, insecticides, weed killers, etc. contain harmful vapors and poisons.</p>	<p>Never inhale air from the air compressor either directly or from a breathing device connected to the air compressor.</p> <p>This air compressor was designed for outdoor use. Never operate this air compressor in an enclosed area. Always make certain there is adequate ventilation (fresh outside air) for breathing and combustion. This will prevent the buildup of dangerous carbon monoxide gases. Beware of poorly ventilated areas, or areas with exhaust fans which can cause poor air exchange.</p> <p>Operate air compressor only in a well ventilated area. Follow all safety instructions provided with the materials you are spraying. Use of a respirator may be required when working with some materials.</p>



SAFETY WARNINGS

READ ALL SAFETY WARNINGS BEFORE USING AIR COMPRESSOR

HAZARD	POTENTIAL CONSEQUENCE	PREVENTION
<p>RISK OF BURNS</p> 	<p>Serious injury could occur from touching exposed metal parts. These areas can remain hot for some time after the air compressor is shutdown.</p>	<p>Never allow any part of your body or other materials to make contact with any exposed metal parts on the air compressor.</p> <p>Never allow any part of your body to contact the engine muffler or adjacent areas.</p>
<p>RISK OF FLYING OBJECTS</p> 	<p>Soft tissue damage can occur from the compressed air stream.</p> <p>Serious injury can occur from loose debris being propelled at a high speed from the compressed air stream.</p>	<p>Always wear OSHA required "Z87" safety glasses to shield the eyes from flying debris.</p> <p>Never point the air stream at any part of your body, anyone else or animals.</p> <p>Never leave pressurized air compressor unattended. Shut off air compressor and relieve pressure before attempting maintenance, attaching tools or accessories.</p> <p>Always maintain a safe distance from people and animals while operating the air compressor.</p> <p>Do not move the air compressor while air tank is under pressure. Do not attempt to move the air compressor by pulling on the hose.</p>
<p>RISK FROM MOVING PARTS</p> 	<p>Risk of bodily injury from moving parts. This air compressor cycles automatically when the pressure switch is in the "On/Auto" position.</p>	<p>Before performing <u>maintenance</u>, always turn off air compressor. Bleed pressure from the air hose and disconnect spark plug wire to prevent engine from starting unexpectedly. All <u>repairs</u> to the air compressor should be made by an Authorized Service person.</p> <p>Do not operate without protective covers/guards. Replace damaged covers/guards before using the air compressor.</p>



SAFETY WARNINGS

READ ALL SAFETY WARNINGS BEFORE USING AIR COMPRESSOR

HAZARD	POTENTIAL CONSEQUENCE	PREVENTION
RISK FROM NEGLIGENCE	Risk of injury from negligent use.	<p>Never allow children or adolescents to operate this air compressor!</p> <p>Stay alert-watch what you are doing. Do not operate the air compressor when fatigued or under the influence of alcohol or drugs.</p> <p>Know how to stop the air compressor. Be thoroughly familiar with controls.</p>
RISK OF AIR COMPRESSOR DAMAGE	Risk of major repair.	<p>Do not operate air compressor without an air filter.</p> <p>Do not operate air compressor in a corrosive environment.</p> <p>Do not incline the air compressor transversely or longitudinally more than 10°.</p> <p>Ensure the oil level is above the minimum notch and below the maximum notch on the dipstick. If low, add Senco® part number PC0344 compressor pump oil.</p> <p>Always operate the air compressor in a stable, secure position to prevent air compressor from falling.</p> <p>Follow all maintenance instructions listed in this manual.</p>

! SAVE THESE INSTRUCTIONS !

PC2015 GASOLINE AIR COMPRESSOR FEATURES

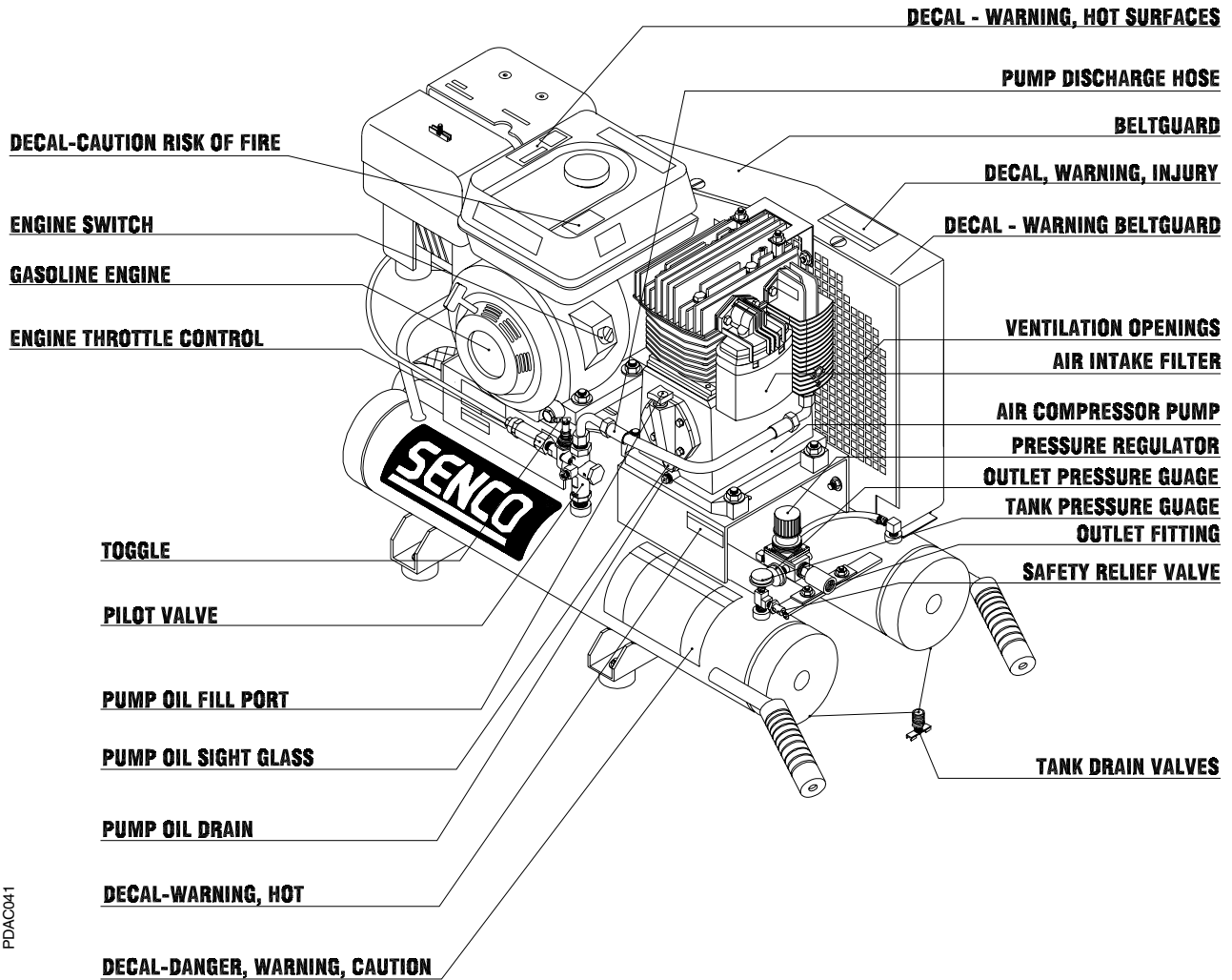

PDAC041

PC2015 FEATURES REVIEW

OIL SIGHT GLASS: The sight glass will register the amount of oil in the pump. Oil level should be checked on a daily basis to ensure it does not exceed the maximum or fall below the minimum level on the sight glass.

OMAC0055-DUB

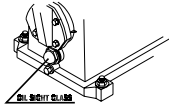

OIL FILL PLUG: To add oil to the pump, simply remove the oil fill plug. Replace when correct oil level is achieved.

OMAC0056-DUB

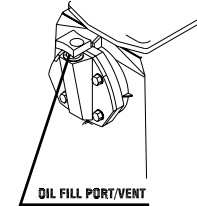

AIR INTAKE FILTER: This filter is designed to clean air coming into the pump. To ensure the pump continually receives a clean, cool, dry air supply this filter must always be clean and ventilation opening free from obstructions. The filter can be removed for cleaning by using warm, soapy water. Rinse the filter and air dry. Replace filter when necessary.

OMAC0065

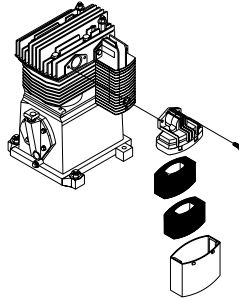

AIR COMPRESSOR PUMP: To compress air, the pistons move up and down in the cylinders. On the downstroke, air is drawn in through the air intake valves while the exhaust valves remain closed. On the upstroke, air is compressed, the intake valves close and compressed air is forced out through the exhaust valves, into the discharge line, through the pilot valve and into the air tank.

PILOT VALVE: When the toggle is in the upright position, all air from the air compressor is vented through the discharge muffler. This gives an easy start feature. For normal operation, the toggle is in the 90° position.

OMAC020-DUB

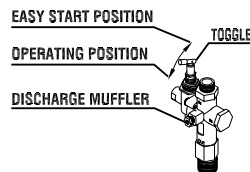

SAFETY RELIEF VALVE: This valve is designed to prevent system failures by relieving pressure from the system when the compressed air reaches a predetermined level. The valve is preset by the manufacturer and must not be modified in any way. To verify the valve is working properly, pull on the ring. Air pressure should escape. When the ring is released, it will reset.

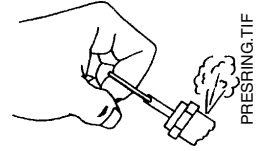

PRESRING.TIF

AIR TANK DRAIN VALVE: The drain valve is used to remove moisture from the air tank(s) after the air compressor is shut off. **NEVER attempt to open the drain valve when more than 10 PSI of air pressure is in the air tank!** To open the drain valve, turn the knob counter-clockwise.

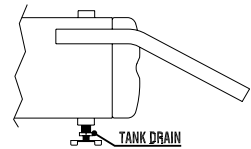

OMAC019-DUB

AIR TANK PRESSURE GAUGE: The air tank pressure gauge indicates the reserve air pressure in the air tank (s).

OUTLET PRESSURE GAUGE: The outlet pressure gauge indicates the air pressure available at the outlet side of the regulator. This pressure is controlled by the regulator and is always less or equal to the air tank pressure.

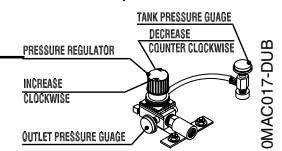

OMAC017-DUB

PRESSURE REGULATOR: The air pressure coming from the air tank is controlled by the regulator knob. Turn the pressure regulation knob clockwise to increase discharge pressure, and counterclockwise to decrease discharge pressure.

PREPARATION

INITIAL SET-UP:

1. Read safety warnings before setting-up air compressor.
2. Ensure the oil level is above the minimum notch and below the maximum notch on the dipstick. If low, add Senco® part number PC0344 compressor pump oil.

LOCATION:

CAUTION

In order to avoid damaging the air compressor, do not incline the air compressor transversely or longitudinally more than 10°.

1. Place air compressor at least 12 inches away from obstacles that may prevent proper ventilation. Do not place air compressor in an area:
 - where there is evidence of oil or gas leaks.
 - where flammable gas vapors or materials may be present.



WARNING

Serious injury or death may occur if electrical sparks from motor and pressure switch come in contact with flammable vapors, combustible dust, gases or other combustible materials. When using the air compressor for spray painting, place the air compressor as far away from the work area as possible, using extra air hoses instead of extension cords.

- where air temperatures fall below 32°F or exceed 104°F.
- where extremely dirty air or water could be drawn into the air compressor.

GASOLINE ENGINE:



DANGER

Do not place unit in an area where flammable gas vapors may be present. A spark could cause an explosion or fire.



DANGER

**Do not smoke while fueling!
Do not fill fuel tank while compressor is running or hot. Allow air compressor and engine to cool down for two minutes before refueling.
Do not fill fuel tank to point of overflowing. Allow approximately 1/4" of head space for fuel expansion.**



WARNING

Always store fuel away from the air compressor while it is running or hot.



WARNING

Do not operate in an enclosed area. Use this product only in well ventilated areas! The exhaust from the engine contains carbon monoxide, a poisonous, odorless and invisible gas. Breathing the gas can cause serious injury, illness and possible death.

1. Review "Risk of Fire or Explosion" pg. 4 before fueling.
2. Read the engine manual accompanying this air compressor for correct engine start-up maintenance procedures.
3. Read and understand the safety labels located on the air compressor.
4. A minimum of 86 octane fuel is recommended for use with this air compressor. Do not mix oil with gasoline.
5. Use of clean, fresh, lead free gasoline is recommended. Leaded gasoline may be used if lead free is not available. Do not use gasoline containing methanol or alcohol.
6. Check the engine oil level before starting. (See engine manual.)
7. Fill the fuel tank according to the engine manual instruction.
8. Refer to the engine manual for all necessary maintenance and adjustments.

OPERATION

PRE-START CHECKLIST:

1. Check oil level. Add if necessary.
2. Remove any moisture in the air compressor air tank. Remove excessive pressure with an air tool, then open the air tank drain valve in the bottom of the air tank. Close tightly when drained.

 **WARNING**
Risk of bodily injury. NEVER attempt to open the drain valve when more than 10 PSI of air pressure is in the air tank!

3. Make sure the engine switch is in the "OFF" position.
4. Make sure all safety valves are working correctly.
5. Make sure all guards and covers are in place and securely mounted.

START-UP: Read safety warnings before performing operation.

1. Flip the toggle on top of the pilot valve to the upright position. This provides a loadless start. The air compressor will unload and allow the engine to start easier.
2. Start the engine. (Refer to the Engine Manual accompanying this unit.)
3. When the engine has run for 1-2 minutes, flip toggle back to the original position.
4. Set pressure by adjusting the pressure regulator knob counterclockwise for less pressure and clockwise for more pressure.
5. If you notice any unusual noise or vibration, stop the air compressor and refer to "Troubleshooting".

SHUTDOWN:

1. To stop the air compressor, move the engine switch to the "Off" position. (Refer to the Engine Manual accompanying this unit.)
2. Drain air from the air tanks by releasing air with an attached air tool or by pulling on the safety relief valve rings.
3. Once pressure in the air tanks register under 10 pounds, open the drain valve under each air tank to drain any moisture.
4. Allow the air compressor to cool down.
5. Wipe air compressor clean and store in a safe, non-freezing area.

MAINTENANCE

Read the instruction manual before performing maintenance. The following procedures must be performed when stopping the air compressor for maintenance or service.

1. Turn off air compressor.
2. Open all drains.
3. Wait for the air compressor to cool before starting service.

MAINTENANCE CHART

PROCEDURE	DAILY	WEEKLY	MONTHLY	200 HOURS
Check pump oil level	X			
Check engine oil level	X			
Check engine air filter	X			
Oil leak inspection	X			
Drain condensation in air tank(s)	X			
Inspect guards/covers	X			
Check for unusual noise/vibration	X			
Check safety relief valve		X		
Inspect air filter		X		
Clean exterior of compressor		X		
Inspect belt			X	
Check for air leaks			X	
Change pump oil *				X
Replace air filter				X
Check engine spark plug				X

*The pump oil must be changed after the first 50 hours of operation and every 200 hours or 3 months, whichever comes first.

TROUBLESHOOTING SYMPTOM

1. Engine will not start.

PROBABLE CAUSE

Various engine problems.

REMEDY

Refer to engine manual accompanying your air compressor.

SYMPTOM

2. Noisy operation.

PROBABLE CAUSE

Loose engine pulley or pump flywheel.

Lack of oil in the pump.

Carbon deposits on pistons or valves.

Bearing, piston or connecting rod failure.

REMEDY

Tighten pulley and or flywheel.

Add correct amount of oil. Check for bearing damage.

Remove cylinder head and inspect. Clean or replace.

STOP THE COMPRESSOR! Contact Senco Customer Service @ 800-543-4596.

SYMPTOM

3. Air leaks from safety relief valve.

PROBABLE CAUSE

Possible defective safety relief valve.

Excessive air tank pressure.

REMEDY

Operate safety relief valve manually by pulling on ring. If it still leaks, it should be replaced.

Defective motor/pressure switch. Replace.

SYMPTOM

4. Air leaks at pump.

PROBABLE CAUSE

Defective gaskets.

REMEDY

Replace and torque head bolts to 20 ft./lbs.

SYMPTOM

5. Air leaks at fittings.

PROBABLE CAUSE

Fittings are not tight enough.

REMEDY

Tighten fittings where air can be heard escaping. Check fittings with soapy water solution. **Do not overtighten.**

SYMPTOM

6. Air leak in air tank.

PROBABLE CAUSE

Defective or rusted air tank.

REMEDY

Air tank must be replaced. **Do not attempt to repair air tank!**

SYMPTOM

7. Air blowing from inlet filter.

PROBABLE CAUSE

Damaged inlet (reed) valve.

REMEDY

Contact Senco Customer Service @ 800-543-4596.

TROUBLESHOOTING SYMPTOM

8. Insufficient pressure at air tool or accessory.	
PROBABLE CAUSE	REMEDY
Pressure regulator knob not turned to high enough pressure or defective pressure regulator.	Adjust pressure regulator knob to proper setting or replace.
Restricted air intake filter.	Clean or replace.
Air leaks.	Check for leaks and repair.
Hose or hose connections are too small or long.	Replace with larger hose or connectors.
Slipping belt.	Tighten or replace.
Air compressor is not large enough for air requirement.	Check the accessory air requirement. If it is higher than the CFM or pressure supply of the air compressor, you need a larger air compressor.

SYMPTOM

9. Air compressor not making enough air.	
PROBABLE CAUSE	REMEDY
Restricted air intake filter.	Clean or replace.
Defective (reed) valve.	Drain air tank and measure pump up time. Compare to specifications. If lower, remove pump head and inspect valve plate, clean or replace.
Restriction in pilot valve.	Clean or replace.

SYMPTOM

10. Excessive oil consumption in pump.	
PROBABLE CAUSE	REMEDY
Restricted air intake filter.	Clean or replace.
Air compressor on unlevel surface.	Do not incline the air compressor more than 10° in any direction while running.
Crankcase overfilled with oil.	Drain oil. Refill to proper level with Senco PC0344 oil.
Plugged oil dipstick vent.	Clean.
Oil leaks.	Repair.
Worn piston rings or scored cylinder.	Contact Senco Customer Service 800-543-4596.

SYMPTOM

11. Oil has milky appearance.	
PROBABLE CAUSE	REMEDY
Water in oil due to condensation.	Change oil and move air compressor to a less humid environment.

SYMPTOM

12. Moisture in discharge air.	
PROBABLE CAUSE	REMEDY
Condensation in air tank caused by high level of atmospheric humidity or air compressor is not run long enough.	Drain air tank after every use. Drain air tank more often in humid weather and use an air line filter.

Specifications

Model #	PC2015
Engine	
Oil Type	SAE 10W 30
Oil Capacity	37.2 oz.
Low Oil Protection	Oil Alert
Fuel Type	Unleaded Gasoline 86 Octane Minimum
Fuel Capacity	1.6 Gallon
Maximum No Load RPM	3450
Compressor Pump	
Number of Cylinders	2
Compression Stages	2
Bore-1st Stage	3.74"
Bore-2nd Stage	2.05"
Stroke	2.36"
RPM	1392
Flywheel	15.7
Lubrication	Splash
Oil Quantity	31.1 oz.
Oil Type	Senco PC0344
Crankcase	Aluminum
Bearings	Ball
Cylinder	Cast Iron
Valves	Reed
Head	Aluminum
Filter	Foam
Pilot Valve Setting	
Cut-out	125 PSI
Cut-in	90 PSI
Air tank	
Capacity	8 gallon
Performance	
CFM Air Displacement	20.9
CFM @ 40 PSI	17.0
CFM @ 90 PSI	16.4
CFM @ 100 PSI	16.3
CFM @ 125 PSI	16.2
Maximum Pressure	
Pump-up Time: 0-125 PSI	32 seconds
Recovery Time: 90-125 PSI	7 seconds
Weight	
Net	214 lbs.
Shipping	265 lbs.
Dimensions	
Basic L x W x H	45 x 18.5 x 29
Shipping L x W x H	48.5 x 24.5 x 36.5

SENCO COMPRESSOR AND PARTS WARRANTY

This compressor has been designed and constructed using the highest standards of material and workmanship.

COMPRESSOR WARRANTY:

The length of this guarantee is **one year** from date of purchase by the **original retail purchaser**. During this period, Senco Products, Inc., will repair or replace at Senco's option, any original part or parts for the original retail purchaser. This will be done free of charge, provided the parts are determined defective in materials or workmanship upon examination by a Senco Authorized Warranty Service Center, with the exceptions and exclusions described below. Any replacement part provided will carry a warranty for the balance of the period of warranty applicable to the part it replaces. When repair or replacement of parts or compressor is necessary, the original retail purchaser returns the complete compressor or part, with transportation prepaid, to the nearest Senco Authorized Warranty Service Center, with purchase receipt or other positive proof that the part or compressor is within the warranty period.

Senco warrants all parts (except those listed below) of your Senco air compressor to be free from defects in materials and workmanship during the following periods:

1. For 1 year from date of original purchase:

Compressor Pump	Pilot Valve
Tank Assembly	Plumbing
Flywheel	Throttle Control
Power Cord	

2. For 90 days from date of original purchase:

Pressure Gauge	Pressure Relief Valve
Draincocks	

Defective parts not subject to normal wear and tear will be repaired or replaced, at our (Senco's) option, during warranty period. In any event, reimbursement is limited to the purchase price paid.

EXCLUSIONS:

1. Engine/Motor is covered under separate warranty by its respective manufacturer and is subject to the terms set forth therein.
2. Normal wear parts not covered under warranty:

Isolators	Drive Belt
Air Filter	
3. This warranty does not cover parts damaged due to normal wear, misapplication, misuse, accidents, operation at other than recommended speeds or voltage (electric units only), improper storage, or damages resulting during shipping.
4. Deviation from operating instructions, specifications, and maintenance schedules.
5. Labor charges, loss or damage resulting from improper operation, maintenance or repairs made by person(s) other than a Senco Authorized Warranty Service Center.
6. The use of other than genuine Senco Repair Parts will void warranty.

This warranty is contingent upon proper use of the compressor by purchaser and does not cover:

- (A) Abnormal conditions, accident, neglect, misuse or improper storage of the unit.
- (B) Deviation from operating or maintenance instructions.
- (C) Modifications not authorized by Senco.
- (D) Repairs or maintenance (other than routine air tank draining and oil filter changes required by your operating and maintenance manual) made by persons other than Senco or its authorized agents.
- (E) Freight damage.

THIS WARRANTY IS THE ONLY WARRANTY ON THIS COMPRESSOR, AND ALL OTHER WARRANTIES, WHETHER ORAL, WRITTEN, EXPRESS, OR IMPLIED, INCLUDING, BUT NOT LIMITED TO, THE IMPLIED WARRANTY OF MERCHANTABILITY OR FITNESS FOR A PARTICULAR PURPOSE, ARE EXCLUDED. BUYER'S OR USER'S REMEDIES ARE SOLELY AND EXCLUSIVELY AS STATED ABOVE. Senco PRODUCTS, INC. SHALL IN NO EVENT BE LIABLE FOR INCIDENTAL, CONSEQUENTIAL, INDIRECT, OR SPECIAL DAMAGES. IN NO EVENT, WHETHER AS A RESULT OF A BREACH OF CONTRACT, WARRANTY, TORT (INCLUDING NEGLIGENCE) OR OTHERWISE, SHALL Senco'S LIABILITY EXCEED THE PRICE OF THE COMPRESSOR WHICH HAS GIVEN RISE TO THE CLAIM OR LIABILITY. ANY LIABILITY CONNECTED WITH THE USE OF THIS COMPRESSOR SHALL TERMINATE UPON THE EXPIRATION OF THE WARRANTY PERIOD SPECIFIED ABOVE.

Replacement of Compressor Due to Natural Disaster

Senco will also replace any compressor destroyed by an Act of God such as flood, earthquake, hurricane or other disaster resulting only from the forces of nature. Such a claim will be honored provided that such original retail purchaser had previously submitted a completed warranty registration card, and then submits proof of ownership and an acceptable statement describing such Act of God documented by an insurance carrier, police department, or other official governmental source. To obtain instructions for filing a claim call 1-800-543-4596.

SENCO PRODUCTS, INC.
CINCINNATI, OHIO 45244-1611 USA

Free Manuals Download Website

<http://myh66.com>

<http://usermanuals.us>

<http://www.somanuals.com>

<http://www.4manuals.cc>

<http://www.manual-lib.com>

<http://www.404manual.com>

<http://www.luxmanual.com>

<http://aubethermostatmanual.com>

Golf course search by state

<http://golfingnear.com>

Email search by domain

<http://emailbydomain.com>

Auto manuals search

<http://auto.somanuals.com>

TV manuals search

<http://tv.somanuals.com>