

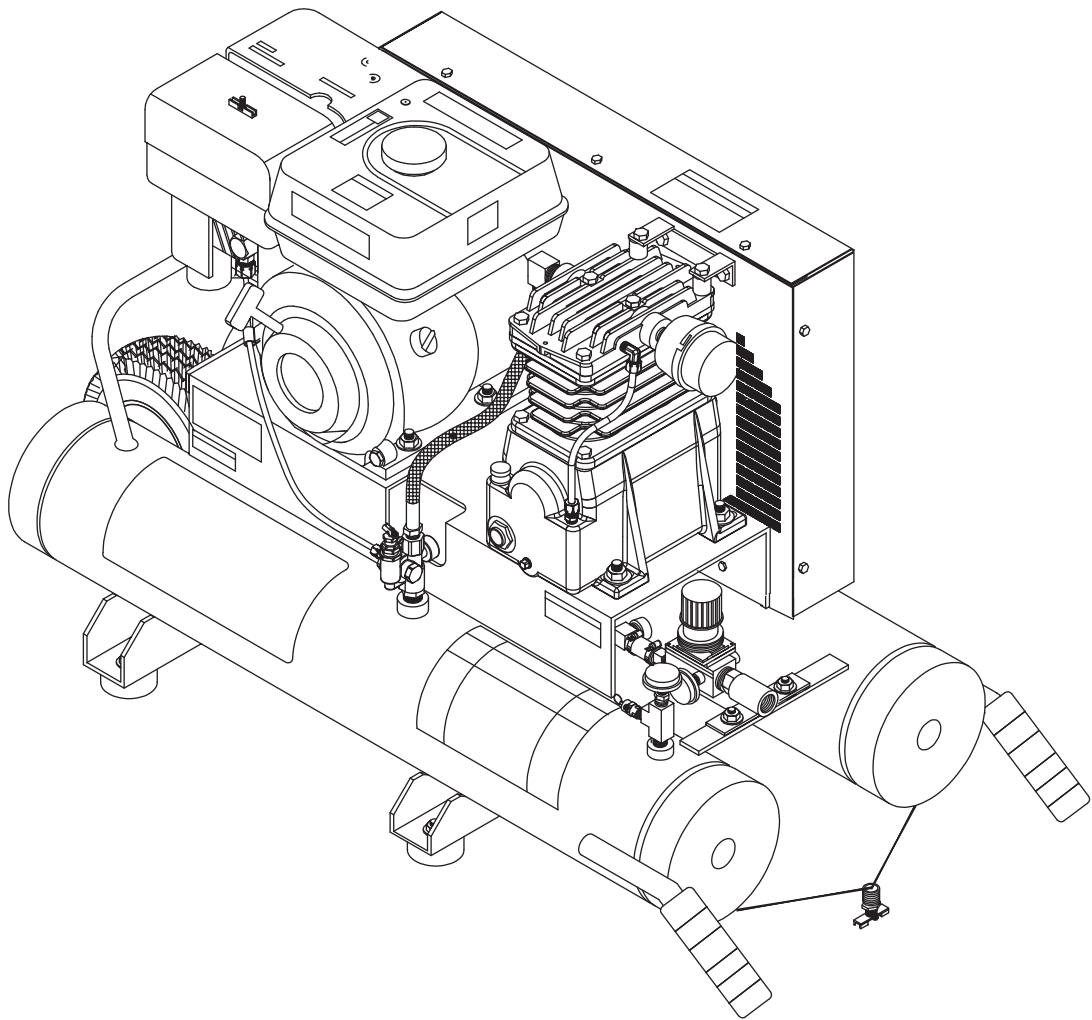

Questions? Comments? call SENC0's toll-free Action-line: 1-800-543-4596 or e-mail: [toolprof@senco.com](mailto:toolprof@senco.com)

## ***PC2017 Gasoline Air Compressor***



## **OPERATING INSTRUCTIONS**

*Document #MTM011 Revised Date: 062104 (Replaces 07/10/03)*

© 2004 by SENC0 Products, Inc.



**Warnings for the safe use of this air compressor are included in this manual.**

# TABLE OF CONTENTS

|                               |              |
|-------------------------------|--------------|
| <b>INTRODUCTION</b> .....     | <b>3</b>     |
| <b>SAFETY ALERT</b> .....     | <b>3</b>     |
| <b>INSPECTION</b> .....       | <b>3</b>     |
| <b>SAFETY WARNINGS</b> .....  | <b>4-7</b>   |
| EXPLOSION OR FIRE.....        | 4            |
| BURSTING.....                 | 5            |
| BREATHING .....               | 5            |
| BURNS.....                    | 6            |
| FLYING OBJECTS.....           | 6            |
| MOVING PARTS .....            | 6            |
| NEGLIGENCE.....               | 7            |
| AIR COMPRESSOR DAMAGE.....    | 7            |
| <b>FEATURES DRAWING</b> ..... | <b>8</b>     |
| <b>FEATURES REVIEW</b> .....  | <b>9</b>     |
| <b>PREPARATION</b> .....      | <b>10</b>    |
| INITIAL SET-UP.....           | 10           |
| LOCATION .....                | 10           |
| GASOLINE ENGINE .....         | 10           |
| <b>OPERATION</b> .....        | <b>11</b>    |
| PRE-START CHECKLIST .....     | 11           |
| START-UP.....                 | 11           |
| SHUTDOWN .....                | 11           |
| <b>MAINTENANCE</b> .....      | <b>11</b>    |
| <b>TROUBLESHOOTING</b> .....  | <b>12-13</b> |
| <b>SPECIFICATIONS</b> .....   | <b>15</b>    |
| <b>WARRANTY</b> .....         | <b>16</b>    |

## INTRODUCTION

Congratulations on the purchase of your new Senco® Air Compressor! You can be assured your Senco® Air Compressor was constructed with the highest level of precision and accuracy. Each component has been rigorously tested by technicians to ensure the quality, endurance and performance of this air compressor.

This operator's manual was compiled for your benefit. By reading and following the simple safety, installation and operation, maintenance and troubleshooting steps described in this manual, you will receive years of troublefree operation from your new Senco® Air Compressor. The contents of this manual are based on the latest product information available at the time of publication. The manufacturer reserves the right to make changes in price, color, materials equipment, specifications or models at any time without notice.



### SAFETY ALERT!

A "**DANGER, WARNING** or **CAUTION**" safety warning will be surrounded by a "SAFETY ALERT BOX". This box is used to designate and emphasize Safety Warnings that must be followed when operating this air compressor. Accompanying the safety warnings are "Signal Words" which designate the degree or level of hazard seriousness. The "Signal Words" used in this manual are as follows:

**DANGER:** Indicates an imminently hazardous situation which, if not avoided, WILL result in death or serious injury.

**WARNING:** Indicates a potentially hazardous situation which, if not avoided, COULD result in death or serious injury.

**CAUTION:** Indicates a potentially hazardous situation which, if not avoided MAY result in minor or moderate injury or damage to the air compressor.



The symbols set to the left of this paragraph are "Safety Alert Symbols". These symbols are used to call attention to items or procedures that could be dangerous you or other persons using this equipment.

**ALWAYS PROVIDE A COPY OF THIS MANUAL TO ANYONE USING THIS EQUIPMENT. READ ALL INSTRUCTIONS IN THIS MANUAL AND ANY INSTRUCTIONS SUPPLIED BY MANUFACTURERS OF SUPPORTING EQUIPMENT BEFORE OPERATING THIS AIR COMPRESSOR AND ESPECIALLY POINT OUT THE "SAFETY WARNINGS" TO PREVENT THE POSSIBILITY OF PERSONAL INJURY TO THE OPERATOR.**

## INSPECTION

Unbox the air compressor and write in the serial number in the space provided below. Inspect for signs of obvious or concealed freight damage. Be sure that all damaged parts are replaced and any mechanical problems are corrected prior to the operation of the air compressor.

**SERIAL NUMBER** \_\_\_\_\_

If you have Questions or Comments call SENCO's toll-free Action-line: **1-800-543-4596** or, e-mail: [toolprof@senco.com](mailto:toolprof@senco.com).

Please have the following information available for all service calls:



1. Model Number
2. Serial Number
3. Date and Place of Purchase

Senco® Corporation 8485 Broadwell Road, Cincinnati, OH 45244



## SAFETY WARNINGS

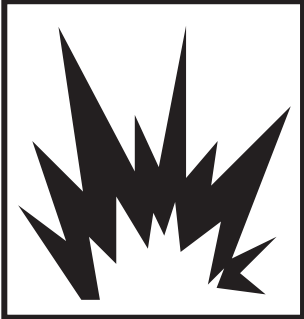

READ ALL SAFETY WARNINGS BEFORE USING AIR COMPRESSOR

| HAZARD   | POTENTIAL CONSEQUENCE   | PREVENTION  |
|--|---|---|
| <p data-bbox="212 275 483 331"><b>RISK OF EXPLOSION OR FIRE</b></p>   | <p data-bbox="565 275 971 394">Serious injury or death may occur from normal sparks in the engine ignition system or engine exhaust/muffler.</p> <p data-bbox="565 642 927 699">Injury or death may occur as a result of improper fueling.</p> <p data-bbox="565 1770 971 1917">Serious injury may occur if any air compressor ventilation openings are restricted, causing the air compressor to overheat and start on fire.</p> | <p data-bbox="1019 275 1406 422">Always operate air compressor in a well ventilated area free of flammable vapors, combustible dust, gases or other combustible materials.</p> <p data-bbox="1019 464 1419 611">If spraying flammable material, locate the air compressor at least 20 feet away from the spray area. (An additional hose may be required.)</p> <p data-bbox="1019 642 1409 699">Do not smoke while filling engine fuel tank.</p> <p data-bbox="1019 737 1409 856">Never fill the engine fuel tank while the engine is running or hot. Allow the engine to cool two minutes before refueling.</p> <p data-bbox="1019 888 1430 945">Do not refuel indoors or in a poorly ventilated area.</p> <p data-bbox="1019 976 1406 1075">Always refuel slowly to avoid the possibility of spilled fuel which may cause a risk of fire.</p> <p data-bbox="1019 1106 1430 1285">Do not operate the unit if gasoline is spilled. Wipe the air compressor clean and move it away from the spill. Avoid creating any ignition until the gasoline has evaporated.</p> <p data-bbox="1019 1316 1398 1495">Do not store the air compressor near an open flame or any equipment such as a stove, furnace water heater, etc. which utilizes a pilot light or sparking device.</p> <p data-bbox="1019 1526 1414 1747">A spark arrester must be added to the muffler of this engine if it is to be used on any forest covered, brush covered or grass covered unimproved land. The arrester must be maintained in effective working order by the operator.</p> <p data-bbox="1019 1778 1419 1957">Never place objects against or on top of air compressor. Operate air compressor at least 12 inches away from any wall or obstruction that would restrict proper ventilation.</p> |



## SAFETY WARNINGS

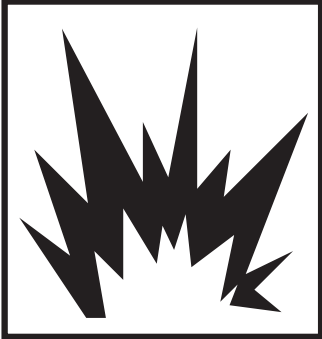

READ ALL SAFETY WARNINGS BEFORE USING AIR COMPRESSOR

| HAZARD  | POTENTIAL CONSEQUENCE  | PREVENTION  |
|---|--|---|
| <p data-bbox="293 268 431 327"><b>RISK OF BURSTING</b></p>       | <p data-bbox="597 268 1000 359">Serious injury or death may occur from an air tank explosion if air tanks are not properly maintained.</p> <p data-bbox="597 590 1000 741">Serious injury may occur from an air compressor malfunction or exploding accessories if incorrect system components, attachments or accessories are used.</p>   | <p data-bbox="1036 268 1438 352">Drain air tank daily or after each use to prevent moisture buildup in the air tank.</p> <p data-bbox="1036 384 1438 558">If air tank develops a leak, replace the air tank immediately. Never repair, weld or make modifications to the air tank or its attachments. Use only genuine Senco® repair parts for your air compressor.</p> <p data-bbox="1036 590 1406 646">Never make adjustments to the factory set pressures.</p> <p data-bbox="1036 678 1385 762">Never exceed manufacturers maximum allowable pressure rating of attachments.</p> <p data-bbox="1036 793 1393 905">Because of extreme heat, do not use plastic pipe or lead tin soldered joints for a discharge line.</p> <p data-bbox="1036 936 1438 1020">Never use air compressor to inflate small, low pressure objects such as toys.</p> |
| <p data-bbox="269 1054 423 1113"><b>RISK TO BREATHING</b></p>  | <p data-bbox="597 1054 1008 1207">Serious injury or death could occur from inhaling compressed air. The air stream may contain carbon monoxide, toxic vapors or solid particles.</p> <p data-bbox="597 1249 1000 1306">Serious injury or death may occur from inhaling engine exhaust.</p> <p data-bbox="597 1627 987 1780">Sprayed materials such as paint, paint solvents, paint remover, insecticides, weed killers, etc. contain harmful vapors and poisons.</p> | <p data-bbox="1036 1054 1463 1178">Never inhale air from the air compressor either directly or from a breathing device connected to the air compressor.</p> <p data-bbox="1036 1249 1463 1591">This air compressor was designed for outdoor use. Never operate this air compressor in an enclosed area. Always make certain there is adequate ventilation (fresh outside air) for breathing and combustion. This will prevent the buildup of dangerous carbon monoxide gases. Beware of poorly ventilated areas, or areas with exhaust fans which can cause poor air exchange.</p> <p data-bbox="1036 1627 1463 1812">Operate air compressor only in a well ventilated area. Follow all safety instructions provided with the materials you are spraying. Use of a respirator may be required when working with some materials.</p>             |



## SAFETY WARNINGS

READ ALL SAFETY WARNINGS BEFORE USING AIR COMPRESSOR

| HAZARD   | POTENTIAL CONSEQUENCE   | PREVENTION   |
|--|---|--|
| <p data-bbox="277 249 415 302"><b>RISK OF BURNS</b></p>               | <p data-bbox="570 254 938 407">Serious injury could occur from touching exposed metal parts. These areas can remain hot for some time after the air compressor is shutdown.</p>   | <p data-bbox="1019 254 1425 373">Never allow any part of your body or other materials to make contact with any exposed metal parts on the air compressor.</p> <p data-bbox="1019 415 1419 499">Never allow any part of your body to contact the engine muffler or adjacent areas.</p>  |
| <p data-bbox="212 659 483 711"><b>RISK OF FLYING OBJECTS</b></p>     | <p data-bbox="570 659 954 716">Soft tissue damage can occur from the compressed air stream.</p> <p data-bbox="570 1073 959 1192">Serious injury can occur from loose debris being propelled at a high speed from the compressed air stream.</p> | <p data-bbox="1013 659 1458 751">Always wear OSHA required "Z87" safety glasses to shield the eyes from flying debris.</p> <p data-bbox="1013 789 1458 846">Never point the air stream at any part of your body, anyone else or animals.</p> <p data-bbox="1013 884 1442 1037">Never leave pressurized air compressor unattended. Shut off air compressor and relieve pressure before attempting maintenance, attaching tools or accessories.</p> <p data-bbox="1013 1075 1474 1167">Always maintain a safe distance from people and animals while operating the air compressor.</p> <p data-bbox="1013 1205 1468 1325">Do not move the air compressor while air tank is under pressure. Do not attempt to move the air compressor by pulling on the hose.</p> |
| <p data-bbox="245 1379 451 1432"><b>RISK FROM MOVING PARTS</b></p>  | <p data-bbox="570 1383 976 1503">Risk of bodily injury from moving parts. This air compressor cycles automatically when the pressure switch is in the "On/Auto" position.</p>   | <p data-bbox="1013 1383 1425 1629">Before performing <u>maintenance</u>, always turn off air compressor. Bleed pressure from the air hose and disconnect spark plug wire to prevent engine from starting unexpectedly. All <u>repairs</u> to the air compressor should be made by an Authorized Service person.</p> <p data-bbox="1013 1667 1419 1787">Do not operate without protective covers/guards. Replace damaged covers/guards before using the air compressor.</p>   |



## SAFETY WARNINGS

READ ALL SAFETY WARNINGS BEFORE USING AIR COMPRESSOR

| HAZARD                                      | POTENTIAL CONSEQUENCE                     | PREVENTION   |
|---|---|--|
| <p><b>RISK FROM NEGLIGENCE</b></p>          | <p>Risk of injury from negligent use.</p> | <p>Never allow children or adolescents to operate this air compressor!</p> <p>Stay alert-watch what you are doing. Do not operate the air compressor when fatigued or under the influence of alcohol or drugs.</p> <p>Know how to stop the air compressor. Be thoroughly familiar with controls.</p>   |
| <p><b>RISK OF AIR COMPRESSOR DAMAGE</b></p> | <p>Risk of major repair.</p>              | <p>Do not operate air compressor without an air filter.</p> <p>Do not operate air compressor in a corrosive environment.</p> <p>Do not incline the air compressor transversely or longitudinally more than 10°.</p> <p>Ensure the oil level is above the minimum notch and below the maximum notch on the dipstick. If low, add Senco® part number PC0344 compressor pump oil.</p> <p>Always operate the air compressor in a stable, secure position to prevent air compressor from falling.</p> <p>Follow all maintenance instructions listed in this manual.</p> |

**! SAVE THESE INSTRUCTIONS !**



### WARNING

The engine exhaust from this product contains chemicals known to the State of California to cause cancer, birth defects or other reproductive harm.



### WARNING

This product contains one or more chemicals known to the State of California to cause cancer and birth defects or other reproductive harm.

# PC2017 GASOLINE AIR COMPRESSOR FEATURES

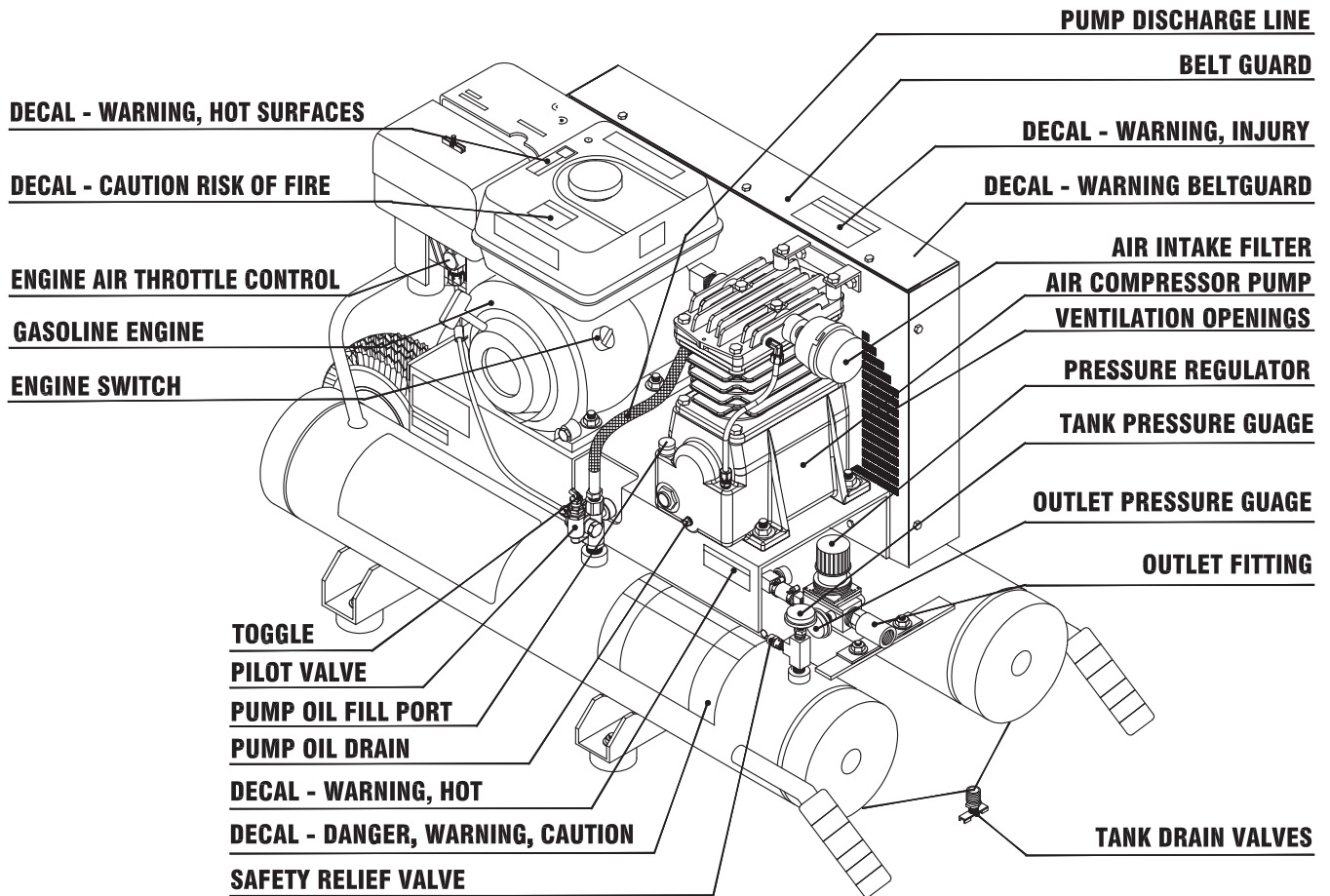

PDAC046-062304-DLG



**AIR INTAKE FILTER:** This filter is designed to clean air coming into the pump. To ensure the pump continually receives a clean, cool, dry air supply this filter must always be clean and ventilation opening free from obstructions. Replace filter when necessary.

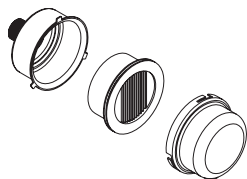

**AIR COMPRESSOR PUMP:** To compress air, the pistons move up and down in the cylinders. On the downstroke, air is drawn in through the air intake valves while the exhaust valves remain closed. On the upstroke, air is compressed, the intake valves close and compressed air is forced out through the exhaust valves, into the discharge line, through the pilot valve and into the air tank.

**PILOT VALVE:** When the toggle is in the upright position, all air from the air compressor is vented through the discharge muffler. This gives an easy start feature. For normal operation, the toggle is in the 90° position.

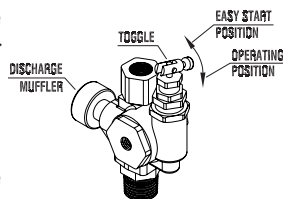

**SAFETY RELIEF VALVE:** This valve is designed to prevent system failures by relieving pressure from the system when the compressed air reaches a predetermined level. The valve is preset by the manufacturer and must not be modified in any way. To verify the valve is working properly, pull on the ring. Air pressure should escape. When the ring is released, it will reset.

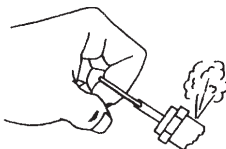

**AIR TANK DRAIN VALVE:** The drain valve is used to remove moisture from the air tank(s) after the air compressor is shut off. **NEVER attempt to open the drain valve when more than 10 PSI of air pressure is in the air tank!** To open the drain valve, turn the knob counterclockwise.

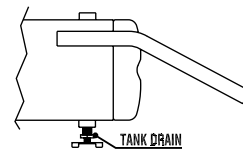

**AIR TANK PRESSURE GAUGE:** The air tank pressure gauge indicates the reserve air pressure in the air tank (s).

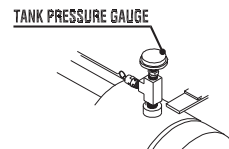

**PRESSURE REGULATOR:** The air pressure coming from the air tank is controlled by the regulator knob. Turn the pressure regulation knob clockwise to increase discharge pressure, and counterclockwise to decrease discharge pressure.

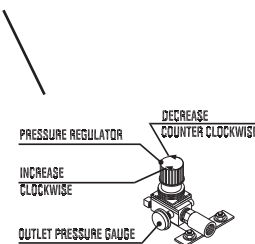

**OUTLET PRESSURE GAUGE:** The outlet pressure gauge indicates the air pressure available at the outlet side of the regulator. This pressure is controlled by the regulator and is always less or equal to the air tank pressure.

**OIL SIGHT GLASS:** The oil sight glass will register the amount of oil in the pump. Ensure the oil level in the air compressor pump is adequate. If low, add SAE-30W non-detergent oil.

# PREPARATION

## INITIAL SET-UP:

1. Read safety warnings before setting-up air compressor.
2. Ensure the oil level is above the minimum notch and below the maximum notch on the dipstick. If low, add Senco® part number PC0344 compressor pump oil.

## LOCATION:

**CAUTION**  
In order to avoid damaging the air compressor, do not incline the air compressor transversely or longitudinally more than 10°.

1. Place air compressor at least 12 inches away from obstacles that may prevent proper ventilation. Do not place air compressor in an area:
  - where there is evidence of oil or gas leaks.
  - where flammable gas vapors or materials may be present.

 **WARNING**  
Serious injury or death may occur if electrical sparks from motor and pressure switch come in contact with flammable vapors, combustible dust, gases or other combustible materials. When using the air compressor for spray painting, place the air compressor as far away from the work area as possible, using extra air hoses instead of extension cords.

- where air temperatures fall below 32°F or exceed 104°F.
- where extremely dirty air or water could be drawn into the air compressor.

## GASOLINE ENGINE:

 **DANGER**  
Do not place unit in an area where flammable gas vapors may be present. A spark could cause an explosion or fire.

 **DANGER**  
Do not smoke while fueling!  
Do not fill fuel tank while compressor is running or hot. Allow air compressor and engine to cool down for two minutes before refueling.  
Do not fill fuel tank to point of overflowing. Allow approximately 1/4" of head space for fuel expansion.

 **WARNING**  
Always store fuel away from the air compressor while it is running or hot.

 **WARNING**  
Do not operate in an enclosed area. Use this product only in well ventilated areas! The exhaust from the engine contains carbon monoxide, a poisonous, odorless and invisible gas. Breathing the gas can cause serious injury, illness and possible death.

1. Review "Risk of Fire or Explosion" pg. 4 before fueling.
2. Read the engine manual accompanying this air compressor for correct engine start-up maintenance procedures.
3. Read and understand the safety labels located on the air compressor.
4. A minimum of 86 octane fuel is recommended for use with this air compressor. Do not mix oil with gasoline.
5. Use of clean, fresh, lead free gasoline is recommended. Leaded gasoline may be used if lead free is not available. Do not use gasoline containing methanol or alcohol.
6. Check the engine oil level before starting. (See engine manual.)
7. Fill the fuel tank according to the engine manual instruction.
8. Refer to the engine manual for all necessary maintenance and adjustments.

## OPERATION

### PRE-START CHECKLIST:

1. Check oil level. Add if necessary.
2. Remove any moisture in the air compressor air tank. Remove excessive pressure with an air tool, then open the air tank drain valve in the bottom of the air tank. Close tightly when drained.



**WARNING**  
**Risk of bodily injury. NEVER attempt to open the drain valve when more than 10 PSI of air pressure is in the air tank!**

3. Make sure the engine switch is in the "OFF" position.
4. Make sure all safety valves are working correctly.
5. Make sure all guards and covers are in place and securely mounted.

### START-UP: Read safety warnings before performing operation.

1. Flip the toggle on top of the pilot valve to the upright position. This provides a loadless start. The air compressor will unload and allow the engine to start easier.
2. Start the engine. (Refer to the Engine Manual accompanying this unit.)
3. When the engine has run for 1-2 minutes, flip toggle back to the original position.
4. Set pressure by adjusting the pressure regulator knob counterclockwise for less pressure and clockwise for more pressure.
5. If you notice any unusual noise or vibration, stop the air compressor and refer to "Troubleshooting".

### SHUTDOWN:

1. To stop the air compressor, move the engine switch to the "Off" position. (Refer to the Engine Manual accompanying this unit.)
2. Drain air from the air tanks by releasing air with an attached air tool or by pulling on the safety relief valve rings.
3. Once pressure in the air tanks register under 10 pounds, open the drain valve under each air tank to drain any moisture.
4. Allow the air compressor to cool down.
5. Wipe air compressor clean and store in a safe, non-freezing area.

## MAINTENANCE

Read the instruction manual before performing maintenance. The following procedures must be performed when stopping the air compressor for maintenance or service.

1. Turn off air compressor.
2. Open all drains.
3. Wait for the air compressor to cool before starting service.

### MAINTENANCE CHART

| PROCEDURE                         | DAILY | WEEKLY | MONTHLY | 200 HOURS |
|-----------------------------------|-------|--------|---------|-----------|
| Check pump oil level              | X     |        |         |           |
| Check engine oil level            | X     |        |         |           |
| Check engine air filter           | X     |        |         |           |
| Oil leak inspection               | X     |        |         |           |
| Drain condensation in air tank(s) | X     |        |         |           |
| Inspect guards/covers             | X     |        |         |           |
| Check for unusual noise/vibration | X     |        |         |           |
| Check safety relief valve         |       | X      |         |           |
| Inspect air filter                |       | X      |         |           |
| Clean exterior of compressor      |       | X      |         |           |
| Inspect belt                      |       |        | X       |           |
| Check for air leaks               |       |        | X       |           |
| Change pump oil *                 |       |        |         | X         |
| Replace air filter                |       |        |         | X         |
| Check engine spark plug           |       |        |         | X         |

\*The pump oil must be changed after the first 50 hours of operation and every 200 hours or 3 months, whichever comes first.

# TROUBLESHOOTING

## SYMPTOM

### 1. Engine will not start.

**PROBABLE CAUSE**

Various engine problems.

**REMEDY**

Refer to engine manual accompanying your air compressor.

## SYMPTOM

### 2. Noisy operation.

**PROBABLE CAUSE**

Loose engine pulley or pump flywheel.

Lack of oil in the pump.

Carbon deposits on pistons or valves.

Bearing, piston or connecting rod failure.

**REMEDY**

Tighten pulley and or flywheel.

Add correct amount of oil. Check for bearing damage.

Remove cylinder head and inspect. Clean or replace.

## SYMPTOM

### 3. Air leaks from safety relief valve.

**PROBABLE CAUSE**

Possible defective safety relief valve.

Excessive air tank pressure.

**REMEDY**

Operate safety relief valve manually by pulling on ring. If it still leaks, it should be replaced.

Defective motor/pressure switch. Replace.

## SYMPTOM

### 4. Air leaks at pump.

**PROBABLE CAUSE**

Defective gaskets.

**REMEDY**

Replace and torque head bolts to 20 ft./lbs.

## SYMPTOM

### 5. Air leaks at fittings.

**PROBABLE CAUSE**

Fittings are not tight enough.

**REMEDY**

Tighten fittings where air can be heard escaping. Check fittings with soapy water solution. **Do not overtighten.**

## SYMPTOM

### 6. Air leak in air tank.

**PROBABLE CAUSE**

Defective or rusted air tank.

**REMEDY**

Air tank must be replaced. **Do not attempt to repair air tank!**

## SYMPTOM

### 7. Air blowing from inlet filter.

**PROBABLE CAUSE**

Damaged inlet (reed) valve.

**REMEDY**

Contact Senco Customer Service @ 800-543-4596.

# TROUBLESHOOTING

## SYMPTOM

### 8. Insufficient pressure at air tool or accessory.

**PROBABLE CAUSE**

Pressure regulator knob not turned to high enough pressure or defective pressure regulator.

Restricted air intake filter.

Air leaks.

Hose or hose connections are too small or long.

Slipping belt.

Air compressor is not large enough for air requirement.

**REMEDY**

Adjust pressure regulator knob to proper setting or replace.

Clean or replace.

Check for leaks and repair.

Replace with larger hose or connectors.

Tighten or replace.

Check the accessory air requirement. If it is higher than the CFM or pressure supply of the air compressor, you need a larger air compressor.

## SYMPTOM

### 9. Air compressor not making enough air.

**PROBABLE CAUSE**

Restricted air intake filter.

Defective (reed) valve.

Restriction in pilot valve.

**REMEDY**

Clean or replace.

Drain air tank and measure pump up time. Compare to specifications. If longer, remove pump head and inspect valve plate, clean or replace.

Clean or replace.

## SYMPTOM

### 10. Excessive oil consumption in pump.

**PROBABLE CAUSE**

Restricted air intake filter.

Air compressor on unlevel surface.

Crankcase overfilled with oil.

Plugged oil dipstick vent.

Oil leaks.

Worn piston rings or scored cylinder.

**REMEDY**

Clean or replace.

Do not incline the air compressor more than 10° in any direction while running.

Drain oil. Refill to proper level with Senco PC0344 oil.

Clean.

Repair.

Contact Senco Customer Service 800-543-4596.

## SYMPTOM

### 11. Oil has milky appearance.

**PROBABLE CAUSE**

Water in oil due to condensation.

**REMEDY**

Change oil and move air compressor to a less humid environment.

## SYMPTOM

### 12. Moisture in discharge air.

**PROBABLE CAUSE**

Condensation in air tank caused by high level of atmospheric humidity or air compressor is not run long enough.

**REMEDY**

Drain air tank after every use. Drain air tank more often in humid weather and use an air line filter.

## Notes

## Specifications

|                           |                                     |
|---------------------------|-------------------------------------|
| Model #                   | PC2017                              |
| Engine                    |                                     |
| Oil Type                  | SAE 10W 30                          |
| Oil Capacity              | 20 oz.                              |
| Low Oil Protection        | Oil Alert                           |
| Fuel Type                 | Unleaded Gasoline 86 Octane Minimum |
| Fuel Capacity             | .95 Gallon                          |
| Maximum No Load RPM       | 3200                                |
| Compressor Pump           |                                     |
| Number of Cylinders       | 2                                   |
| Compression Stages        | 1                                   |
| Bore/Stroke               | 2.5" x 1.88"                        |
| RPM                       | 1380                                |
| Flywheel                  | 10"                                 |
| Lubrication               | Splash                              |
| Oil Quantity              | 17.3 oz.                            |
| Oil Type                  | Senco PC0344                        |
| Crankcase                 | Cast Iron                           |
| Bearings                  | Ball                                |
| Cylinder                  | Cast Iron                           |
| Valves                    | Reed-Single                         |
| Head                      | Aluminum                            |
| Filter                    | Canister                            |
| Pilot Valve Setting       |                                     |
| Cut-out                   | 125 PSI                             |
| Cut-in                    | 95 PSI                              |
| Air Tank                  |                                     |
| Capacity                  | 8 Gallon                            |
| Performance               |                                     |
| CFM Air Displacement      | 14.7                                |
| CFM @ 40 PSI              | 10.6                                |
| CFM @ 100 PSI             | 9.0                                 |
| Maximum Pressure          | 125 PSI                             |
| Pump-up Time: 0-125 PSI   | 54 seconds                          |
| Recovery Time: 95-125 PSI | 14 seconds                          |
| Weight                    |                                     |
| Net                       | 170 lbs.                            |
| Shipping                  | 190 lbs.                            |
| Dimensions                |                                     |
| Basic L x W x H           | 44 1/2" x 18 1/2" x 26"             |
| Shipping L x W x H        | 45" x 19" x 32"                     |



## SENCO COMPRESSOR AND PARTS WARRANTY

This compressor has been designed and constructed using the highest standards of material and workmanship.

### **COMPRESSOR WARRANTY:**

The length of this guarantee is **one year (two years on the pump)** from date of purchase by the **original retail purchaser**. During this period, Senco Products, Inc., will repair or replace at Senco's option, any original part or parts for the original retail purchaser. This will be done free of charge, provided the parts are determined defective in materials or workmanship upon examination by a Senco Authorized Warranty Service Center, with the exceptions and exclusions described below. Any replacement part provided will carry a warranty for the balance of the period of warranty applicable to the part it replaces. When repair or replacement of parts or compressor is necessary, the original retail purchaser returns the complete compressor or part, with transportation prepaid, to the nearest Senco Authorized Warranty Service Center, with purchase receipt or other positive proof that the part or compressor is within the warranty period.

Senco warrants all parts (except those listed below) of your Senco air compressor to be free from defects in materials and workmanship during the following periods:

1. For 2 years from date of original purchase:  
Compressor Pump
  
2. For 1 year from date of original purchase:

|                |                       |
|----------------|-----------------------|
| Tank Assembly  | Pilot Valve           |
| Flywheel       | Plumbing              |
| Power Cord     | Throttle Control      |
| Pressure Gauge | Pressure Relief Valve |
| Drain Cocks    |                       |

Defective parts not subject to normal wear and tear will be repaired or replaced, at our (Senco's) option, during warranty period. In any event, reimbursement is limited to the purchase price period.

### **EXCLUSIONS:**

1. Engine/Motor is covered under separate warranty by it's respective manufacturer and is subject to the terms set forth therein.
2. Normal wear parts not covered under warranty:

|             |            |
|-------------|------------|
| Isolators   | Drive Belt |
| Air Filters |            |
3. This warranty does not cover parts damaged due to normal wear, misapplication, misuse, accidents, operation at other than recommended speeds or voltage (electric units only), improper storage, or damages resulting during shipping.
4. Deviation from operating instructions, specifications, and maintenance schedules.
5. Labor charges, loss or damage resulting from improper operation, maintenance or repairs made by person(s) other than a Senco Authorized Warranty Service Center.
6. The use of other than genuine Senco Repair Parts will void warranty.

This warranty is contingent upon proper use of the compressor by purchaser and does not cover;

- (A) Abnormal conditions, accident, neglect, misuse or improper storage of the unit.
- (B) Deviation from operating or maintenance instructions.
- (C) Modifications not authorized by Senco.
- (D) Repairs or maintenance (other than routine air tank draining and oil filter changes required by your operating and maintenance manual) made by persons other than Senco or its authorized agents.
- (E) Freight damage.

THIS WARRANTY IS THE ONLY WARRANTY ON THIS COMPRESSOR, AND ALL OTHER WARRANTIES, WHETHER ORAL, WRITTEN, EXPRESS, OR IMPLIED, INCLUDING, BUT NOT LIMITED TO, THE IMPLIED WARRANTY OF MERCHANTABILITY OR FITNESS FOR A PARTICULAR PURPOSE, ARE EXCLUDED. BUYER'S OR USER'S REMEDIES ARE SOLELY AND EXCLUSIVELY AS STATED ABOVE. SENCO PRODUCTS, INC. SHALL IN NO EVENT BE LIABLE FOR INCIDENTAL, CONSEQUENTIAL, INDIRECT, OR SPECIAL DAMAGES. IN NO EVENT, WHETHER AS A RESULT OF A BREACH OF CONTRACT, WARRANTY, TORT (INCLUDING NEGLIGENCE) OR OTHERWISE, SHALL SENCO'S LIABILITY EXCEED THE PRICE OF THE COMPRESSOR WHICH HAS GIVEN RISE TO THE CLAIM OR LIABILITY. ANY LIABILITY CONNECTED WITH THE USE OF THIS COMPRESSOR SHALL TERMINATE UPON THE EXPIRATION OF THE WARRANTY PERIOD SPECIFIED ABOVE.

### **Replacement of Compressor Due to Natural Disaster**

Senco will also replace any compressor destroyed by an Act of God such as flood, earthquake, hurricane or other disaster resulting only from the forces of nature. Such a claim will be honored provided that such original retail purchaser had previously submitted a completed warranty registration card, and then submits proof of ownership and an acceptable statement describing such Act of God documented by an insurance carrier, police department, or other official governmental source. To obtain instructions for filing a claim call 1-800-543-4596.

**SENCO PRODUCTS, INC.  
CINCINNATI, OHIO 45244-1611 USA**



## Free Manuals Download Website

<http://myh66.com>

<http://usermanuals.us>

<http://www.somanuals.com>

<http://www.4manuals.cc>

<http://www.manual-lib.com>

<http://www.404manual.com>

<http://www.luxmanual.com>

<http://aubethermostatmanual.com>

Golf course search by state

<http://golfingnear.com>

Email search by domain

<http://emailbydomain.com>

Auto manuals search

<http://auto.somanuals.com>

TV manuals search

<http://tv.somanuals.com>