

# CX 6 travel

Instructions for use

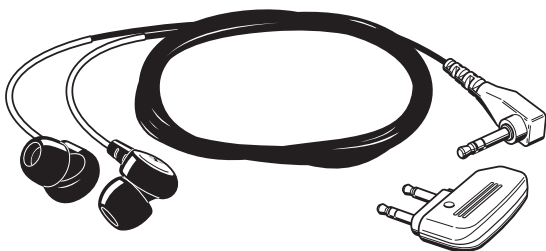

## Important safety instructions

In order to prevent hearing damage:

- ▶ Set the volume to a low level before inserting the ear canal phones into your ears.
- ▶ Listening at high volume levels for long periods can lead to permanent hearing defects. Please protect your hearing!

In order to prevent injury to your auditory canals and ear drums:

- ▶ Mount the suitable earpads (S, M or L) to the ear canal phones. Never insert the ear canal phones without earpads!
- ▶ Always insert and extract the ear canal phones very **carefully** and **slowly**! Do not insert the ear canal phones too deep into your ears!
- ▶ Always keep the ear canal phones dry.

In order to prevent accidents:

- ▶ Do not wear the ear canal phones in an environment that requires your special attention (e.g. in traffic or when performing skilled jobs).

### Note on the sound quality

The perceived sound quality and bass performance of the ear canal phones depends to a large extent on the correct fit of the ear canal phones in the ear. For best sound enjoyment, please use the supplied earpads.

## Delivery includes

- 1 CX 6 travel ear canal phones
- 1 storage box
- 1 in-flight adapter (double mono)
- 4 pairs of earpads (sizes S, M and L),  
size M is pre-mounted to the ear canal phones
- 3 pairs of lamellar earpads (sizes S, M and L)
- 1 cable clip
- 1 pair of ear hooks
- 1 cleaning tool
- 1 user manual



## Adjustment to the ear

US

### Bending the ear hook

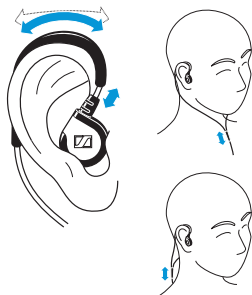

- ▶ Position the ear canal phones on the ear and guide the ear hook behind the ear (L - left or R - right) as shown.
- ▶ Bend the ear hook to ensure an optimum fit on the ear.
- ▶ Adjust the cable length using the cable slider.

### Replacing the earpads

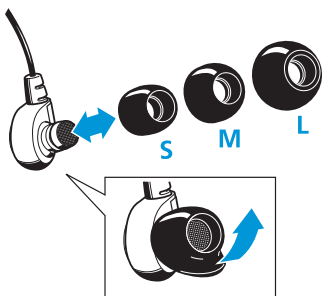

- ▶ Carefully remove the earpads from the ear canal phones.
- ▶ Mount the new earpads to the ear canal phones.

## Connecting the in-flight adapter

**CAUTION!** Danger of damage to the device!



On some aircraft there is a small 2.5 mm jack socket as part of the audio socket. This small socket is DC power for aircraft-issue ANR (Active Noise Reducing) headphones and is not used by the CX 6 travel.

- ▶ Use the supplied in-flight adapter to connect the CX 6 travel only to 3.5 mm jack sockets.

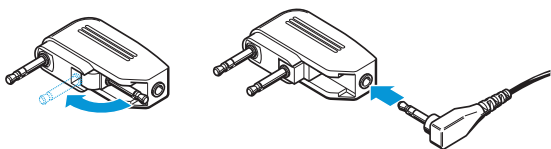

The supplied in-flight adapter is for connection to the in-flight entertainment system of the aircraft.

### Note

When operating the ear canal phones in the aircraft, **always** use the in-flight adapter!

- ▶ Fold out the second jack plug of the in-flight adapter if there are two jack sockets (double mono) in the aircraft.
- ▶ Plug the in-flight adapter onto the jack plug of the ear canal phones.
- ▶ Connect the in-flight adapter to the 3.5 mm stereo socket or the twin 3.5 mm mono sockets in the aircraft.

## Transporting the ear canal phones

US

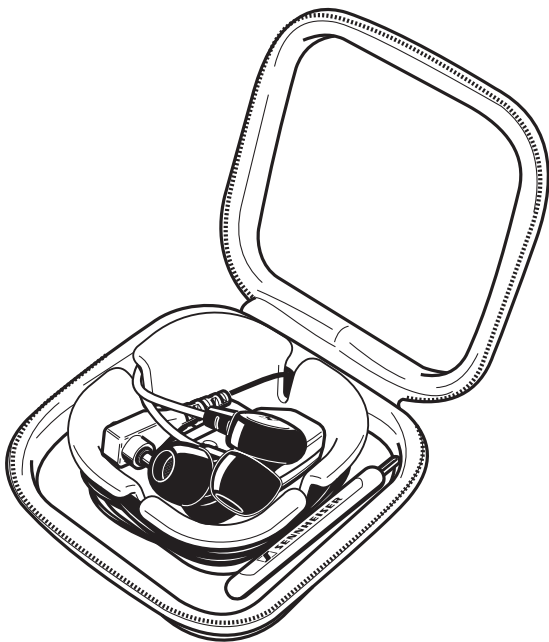

- ▶ Stow the ear canal phones, the in-flight adapter and the cleaning tool in the storage box as shown.

## Cleaning the ear canal phones

**CAUTION!** Liquids can damage the electronics of the ear canal phones!



Liquids entering the housing of the ear canal phones can cause a short-circuit and damage the electronics.

- ▶ Use only a slightly damp cloth to clean the ear canal phones. Do not use any solvents or cleansing agents.

**NOTICE!** Danger of damage to the device!

Ear wax and tallow buildup can clog the ear canal phones and lower the sound quality or even damage the diaphragm.

- ▶ Use only the supplied cleaning tool to clean the ear canal phones.

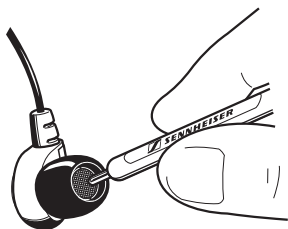

- ▶ Carefully remove buildup from the mesh using the cleaning tool.
- ▶ Clean the ear canal phones regularly.

### Note:

For reasons of hygiene, the earpads should be replaced from time to time (see page 2). Spare earpads are available from your Sennheiser dealer.

## Specifications

US

Weight of the ear-canal-phones	13 g 5 g without cable
Connector	3.5 mm stereo jack
Cable length	1.2 m
Temperature range	-10 to 55 °C
Impedance	16 Ω
Frequency response	10–18,000 Hz
Noise attenuation (passive)	up to 90% / 20 dB
Sound pressure level	115 dB SPL
THD	< 0.1% at 1 kHz, 100 dB SPL



## Accessories/spare parts

Accessories and spare parts are available from your Sennheiser partner.

- ▶ Only use original Sennheiser accessories and spare parts.

A list of the suitable accessories/spare parts can be found on the Sennheiser homepage:

[www.sennheiser.com](http://www.sennheiser.com)



Sennheiser electronic GmbH & Co. KG  
Am Labor 1  
30900 Wedemark, Germany  
Phone +49 (5130) 600 0  
Fax +49 (5130) 600 300  
[www.sennheiser.com](http://www.sennheiser.com)

Printed in China  
Publ. 06/08  
525750/A01



## Free Manuals Download Website

<http://myh66.com>

<http://usermanuals.us>

<http://www.somanuals.com>

<http://www.4manuals.cc>

<http://www.manual-lib.com>

<http://www.404manual.com>

<http://www.luxmanual.com>

<http://aubethermostatmanual.com>

Golf course search by state

<http://golfingnear.com>

Email search by domain

<http://emailbydomain.com>

Auto manuals search

<http://auto.somanuals.com>

TV manuals search

<http://tv.somanuals.com>