

SAMSUNG

DVD MINI COMPONENT SYSTEM WITH USB HOST

DVD/VCD/CD/MP3-CD/CD-R/RW
PLAYBACK

MAX-DX75

MAX-DX76

MAX-DX79

THIS APPLIANCE IS MANUFACTURED BY:

Instruction Manual

SAMSUNG

ELECTRONICS

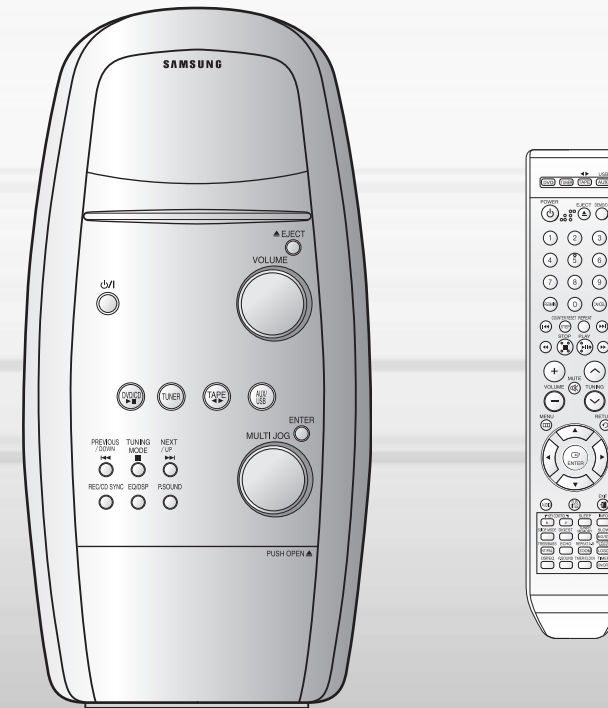



Safety Warnings

CLASS 1 LASER PRODUCT
KLASSE 1 LASER PRODUCT
LUOKAN 1 LASER LAITE
KLASS 1 LASER APPARAT
PRODUCTO LASER CLASE 1

	CAUTION RISK OF ELECTRIC SHOCK. DO NOT OPEN	
<p>CAUTION: TO REDUCE THE RISK OF ELECTRIC SHOCK, DO NOT REMOVE REAR COVER. NO USER SERVICEABLE PARTS INSIDE. REFER SERVICING TO QUALIFIED SERVICE PERSONNEL.</p>		

CLASS 1 LASER PRODUCT
 This Compact Disc player is classified as a CLASS 1 LASER product.

(Saudi Arabian Standards Organisation)

THIS APPLIANCE IS FITTED WITH 220V SASO APPROVED PLUG.THE CUSTOMER IS ENTITLED TO A FREE SASO APPROVED 127V PLUG FROM THE LOCAL DEALER.

Use of controls, adjustments or performance of procedures other than those specified herein may result in hazardous radiation exposure.

CAUTION-INVISIBLE LASER RADIATION WHEN OPEN AND INTERLOCKS DEFEATED, AVOID EXPOSURE TO BEAM.

This symbol indicates that dangerous voltage which can cause electric shock is present inside this unit.

This symbol alerts you to important operating and maintenance instructions accompanying the unit.

WARNING: To reduce the risk of fire or electric shock, do not expose this appliance to rain or moisture.

CAUTION: TO PREVENT ELECTRIC SHOCK, MATCH WIDE BLADE OF PLUG TO WIDE SLOT, FULLY INSERT.



Precautions

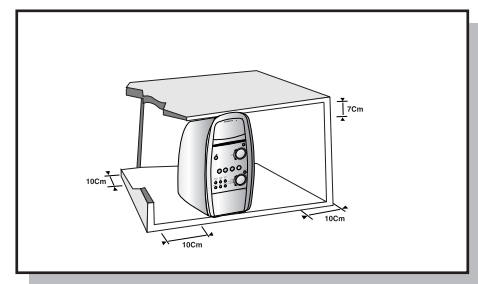

Ensure that the AC power supply in your house complies with the identification sticker located on the back of your player. Install your player horizontally, on a suitable base (furniture), with enough space around it for ventilation (3~4inches). Make sure the ventilation slots are not covered. Do not stack anything on top of the player. Do not place the player on amplifiers or other equipment which may become hot. Before moving the player, ensure the disc tray is empty. This player is designed for continuous use. Switching off the DVD player to the stand-by mode does not disconnect the electrical supply. In order to disconnect the player completely from the power supply, remove the main plug from the wall outlet, especially when left unused for a long period of time.

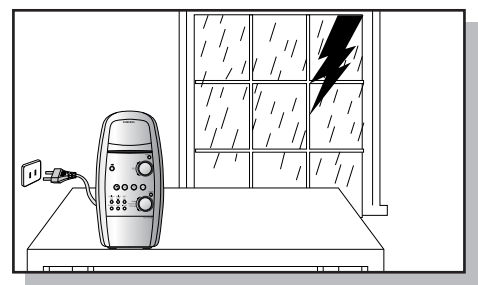
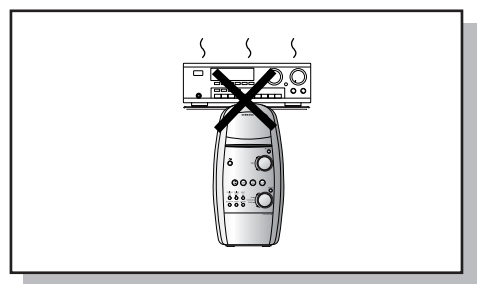

During thunderstorms, disconnect AC main plug from the wall outlet. Voltage peaks due to lightning could damage the unit.

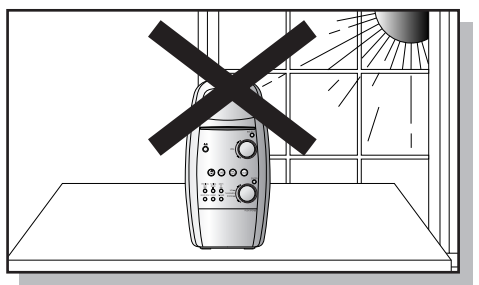

Do not expose the unit to direct sunlight or other heat sources. This could lead to overheating and malfunction of the unit.



Protect the player from moisture(i.e. vases), and excess heat(e.g.fireplace) or equipment creating strong magnetic or electric fields (i.e.speakers...). Disconnect the power cable from the AC supply if the player malfunctions. Your player is not intended for industrial use. Use of this product is for personal use only. Condensation may occur if your player or disc have been stored in cold temperatures. If transporting the player during the winter, wait approximately 2 hours until the unit has reached room temperature before using.

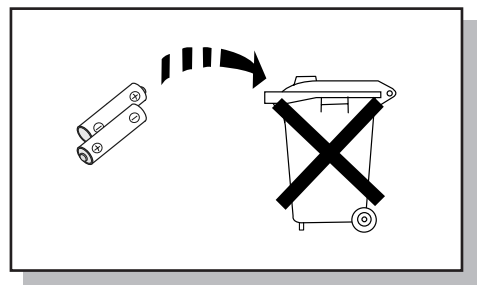

The battery used with this product contain chemicals that are harmful to the environment. Do not dispose of batteries in the general household trash.

Features

● Multi-Disc Playback & FM Tuner, TAPE,USB HOST.

The MAX-DX75/DX76/DX79 combines the convenience of multi-disc playback capability, including DVD-VIDEO, CD, MP3-CD, CD-R, CD-RW,VCD,DivX,JPEG and DVD-R/RW, with a sophisticated FM tuner, TAPE, USB HOST all in a single player.

● TV Screen Saver Function

The MAX-DX75/DX76/DX79 automatically brightens and darkens the brightness of the TV screen after 3 minutes in the stop mode.
The MAX-DX75/DX76/DX79 automatically switches itself into the power saving mode after 20 minutes in the screen saver mode.

● Power Saving Function

The MAX-DX75/DX76/DX79 automatically shuts itself off after 20 minutes in the stop mode.

● Customized TV Screen Display

The MAX-DX75/DX76/DX79 allows you to select your favorite image during JPEG, VCD/DVD playback and set it as your background wallpaper.

● USB Host support

You can enjoy media files such as pictures, movies and music saved on an MP3 player, digital camera or USB memory stick by connecting the storage device to the USB port of the Home Theater.

● HDMI

HDMI transmits DVD video and audio signals simultaneously, and provides a clearer picture.

Contents

● PREPARATION	
Safety Warnings	1
Precautions	2
Features	3
Notes on Discs	5
Description	7
● CONNECTIONS	
Connecting the Speakers	11
Connecting the video Out to your TV	13
HDMI Function	14
Connecting External Components	15
Connecting the FM Antennas	16
Setting the Clock	17
● OPERATION	
Disc Playback	19
MP3/WMA/CD Playback	20
DivX Playback	21
Playing Media Files using the USB feature	23
Displaying Disc Information	25
Fast/Slow Playback	26
Skipping Scenes/Songs	27
Step Function	27
Angle Function	28
Repeat Playback	29
A-B Repeat playback	31
Zoom Function	32
Selecting Audio/Subtitle Language	33
Moving Directly to a Scene/Song	34
JPEG File Playback	35
Using Disc Menu	37
Using the Title Menu	38
● SETUP	
Setting the Language	39
Language Code List	40
Setting TV Screen type	41
Setting Parental Controls (Rating Level)	43
Setting the Password	44
Setting the Wallpaper	45
Setting the DRC (Dynamic Range Compression)	47
AV SYNC Setup	48
● RADIO OPERATION	
Listening to Radio	49
Presetting Stations	50
● TAPE DECK	
Listening to a Cassette	51
● MISCELLANEOUS	
Recording a Compact Disc	54
Recording a Radio Program	56
Timer Function	57
Canceling the Timer	58
POWER SOUND and Sound Field (DSP/EQ) Function	59
Sleep Timer Function / Mute Function	60
DEMO Function / DIMMER Function/ECO Function	61
Bass/Treble Level Function	62
Connecting Headphones/Microphone(option)	63
Key Control	63
Cautions on Handling and Storing Discs	64
Before Calling for Service	65
Specifications	67
USB Feature Supported Player	68
Notes on Terminology	69



DVD (Digital Versatile Disc) offers fantastic audio and video, thanks to Dolby Digital surround sound and MPEG-2 video compression technology. Now you can enjoy these realistic effects in the home, as if you were in a movie theater or concert hall.



DVD players and the discs are coded by region. These regional codes must match in order for the disc to play. If the codes do not match, the disc will not play.

The Region Number for this player is given on the rear panel of the player.
(Your DVD player will only play DVDs that are labeled with identical region codes.)

Playable Discs



Disc Type	Mark (Logo)	Recorded Signals	Disc Size	Max. Playing Time
DVD-VIDEO		Video	12cm	Approx. 240 min. (single-sided) Approx. 480 min. (double-sided)
			8cm	Approx. 80 min. (single-sided) Approx. 160 min. (double-sided)
AUDIO-CD		Audio	12cm	74 min.
			8cm	20 min.
DivX		Audio + Video	12cm	74 min.
			8cm	20 min.

Do not use the following types of disc!



- LD, CD-G, CD-I, CD-ROM and DVD-ROM discs cannot be played on this player. If such discs are played, a <WRONG DISC FORMAT> message appears on the TV screen.
- DVD discs purchased abroad may not play on this player. If such discs are played, a <CAN'T PLAY THIS DISC PLEASE, CHECK REGION CODE> message appears on the TV screen.

Copy Protection

- Many DVD discs are encoded with copy protection. Because of this, you should only connect your DVD player directly to your TV, not to a VCR. Connecting to a VCR results in a distorted picture from copy-protected DVD discs.
- This product incorporates copyright protection technology that is protected by methods claims of certain U.S. patents and other intellectual property rights owned by Macrovision Corporation and other rights owners. Use of this copyright protection technology must be authorized by Macrovision Corporation, and is intended for home and other limited viewing uses only unless otherwise authorized by Macrovision Corporation. Reverse engineering or disassembly is prohibited.

Disc Recording Format

This product does not support Secure (DRM) Media files.

CD-R Discs

- Some CD-R discs may not be playable depending on the disc recording device (CD-Recorder or PC) and the condition of the disc.
- Use a 650MB/74 minute CD-R disc. Do not use CD-R discs over 700MB/80 minute as they may not be playable.
- Some CD-RW (Rewritable) media, may not be playable.
- Only CD-Rs that are properly "closed" can be fully played. If the session is closed but the disc is left open, you may not be able to fully play the disc.

CD-R MP3 Discs

- Only CD-R discs with MP3 files in ISO 9660 or Joliet format can be played.
- MP3 file names should be 8 characters or less in length and contain no blank spaces or special characters (. / = +).
- Use discs recorded with a compression/decompression data rate greater than 128Kbps.
- Only files with the "mp3" and extensions can be played.
- Only a consecutively written multisession disc can be played. If there is a blank segment in the Multisession disc, the disc can be played only up to the blank segment.
- If the disc is not closed, it will take longer to begin playback and not all of the recorded files may be played.
- For files encoded in Variable Bit Rate (VBR) format, i.e. files encoded in both low bit rate and high bit rate (e.g., 32Kbps ~ 320Kbps), the sound may skip during playback.
- A maximum of 500 tracks can be played per CD.
- A maximum of 300 folders can be played per CD.

CD-R JPEG Discs

- Only files with the "jpg" extensions can be played.
- If the disc is not closed, it will take longer to start playing and not all of the recorded files may be played.
- Only CD-R discs with JPEG files in ISO 9660 or Joliet format can be played.
- JPEG file names should be 8 characters or less in length and contain no blank spaces or special characters (. / = +).
- Only a consecutively written multisession disc can be played. If there is a blank segment in the multisession disc, the disc can be played only up to the blank segment.
- A maximum of 9,999 images can be stored on a single CD.
- When playing a Kodak/Fuji Picture CD, only the JPEG files in the picture folder can be played.
- Picture discs other than Kodak/Fuji Picture CDs may take longer to start playing or may not play at all.

DVD±R/RW, CD-R/RW DivX Discs

- Since this product only provides encoding formats authorized by DivX Networks, Inc., a DivX file created by the user might not play.
- Software updates for incompatible formats are not supported. (Example : QPEL, GMC, resolution higher than 800 x 600 pixels, etc.)
- Sections with a high frame rate might not be played while playing a DivX file.
- For more information about the formats authorized by DivX Networks, Inc., please visit "www.divxnetworks.net".



Description

—Front Panel—

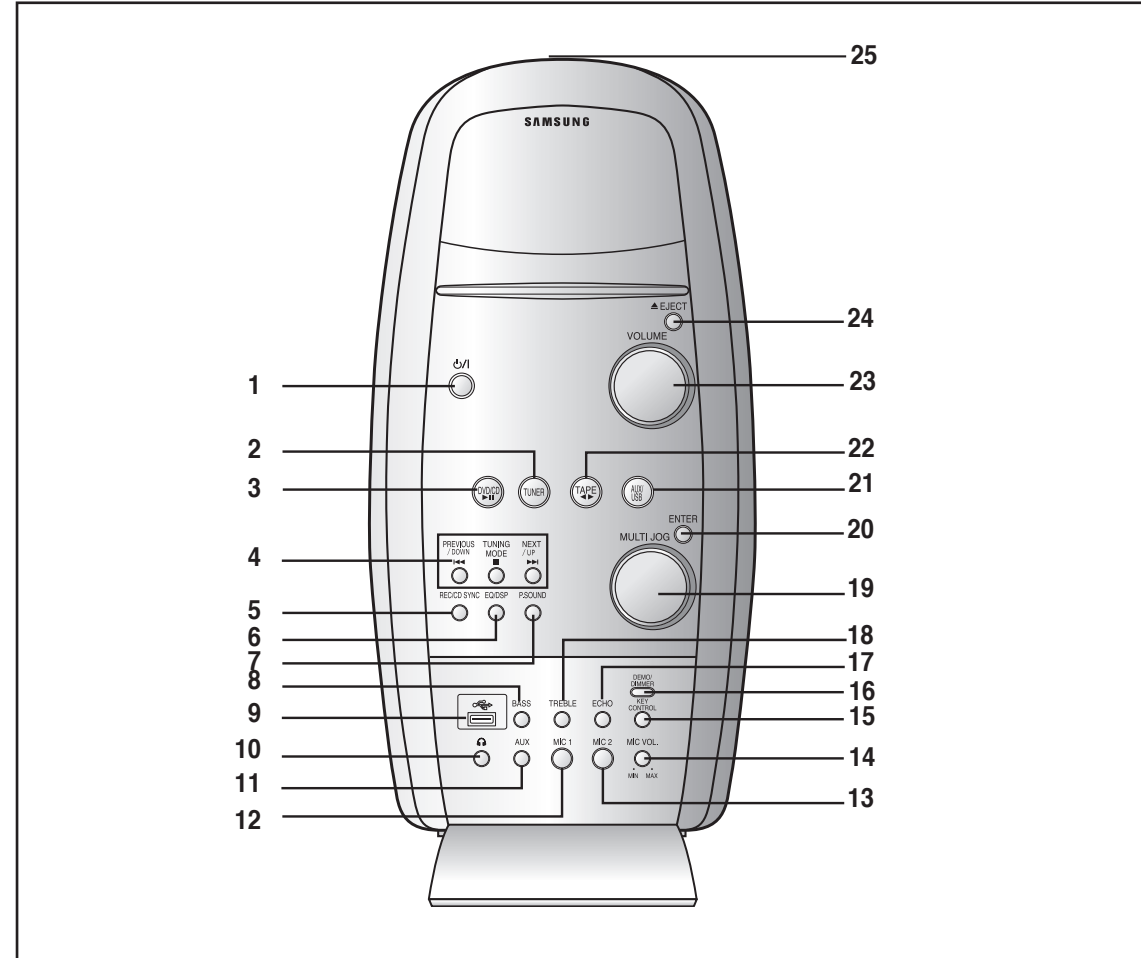

- | | |
|--|-------------------|
| 1. STANDBY/ON/ECO | 15. KEY CONTROL |
| 2. TUNER BUTTON | 16. DEMO/DIMMER |
| 3. DVD/CD BUTTON | 17. ECHO |
| 4. SEARCH FUNCTION BUTTONS
TUNING MODE OR STOP BUTTON | 18. TREBLE |
| 5. RECORD/CD SYNCHRO | 19. MULTI JOG |
| 6. EQ/DSP | 20. ENTER |
| 7. POWER SOUND | 21. AUX/USB |
| 8. BASS | 22. TAPE BUTTON |
| 9. USB HOST JACK | 23. VOLUME |
| 10. PHONES | 24. EJECT BUTTON |
| 11. AUX | 25. CASSETTE DECK |
| 12. MIC 1 | |
| 13. MIC 2 | |
| 14. MIC VOLUME | |

• You can use MULTI JOG KNOB to instead of SEARCH BUTTON on the main set and the remote control.

—Rear Panel—

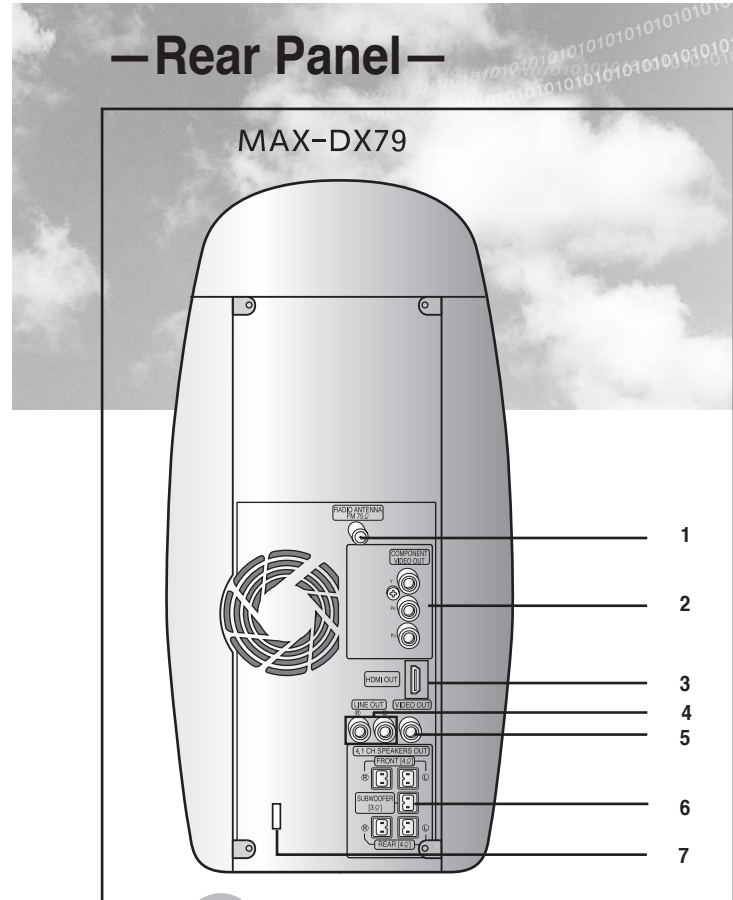

1. FM Antenna Connector
2. Component Video Output Connectors
Connect a TV with component video input jacks to these jacks.
3. HDMI OUT
4. LINE OUT
5. Video Output Connector
Connect the TV's video input jacks (VIDEO IN) to the VIDEO OUT connector.
6. 2.0 Channel Speaker Output Terminals(for MAX-DX75)
2.1 Channel Speaker Output Terminals(for MAX-DX76)
4.1 Channel Speaker Output Terminals(for MAX-DX79)
7. Voltage Selector (Option)

Note

The picture of Rear panel is based on MODEL:MAX-DX79

MAX-DX75: 2.0 Channel Speaker Output
MAX-DX76: 2.1 Channel Speaker Output
MAX-DX79: 4.1 Channel Speaker Output

Accessories

Remote Control	Video Cable	HDMI Cable
FM Antenna	User's Manual	

Description

—Remote Control—

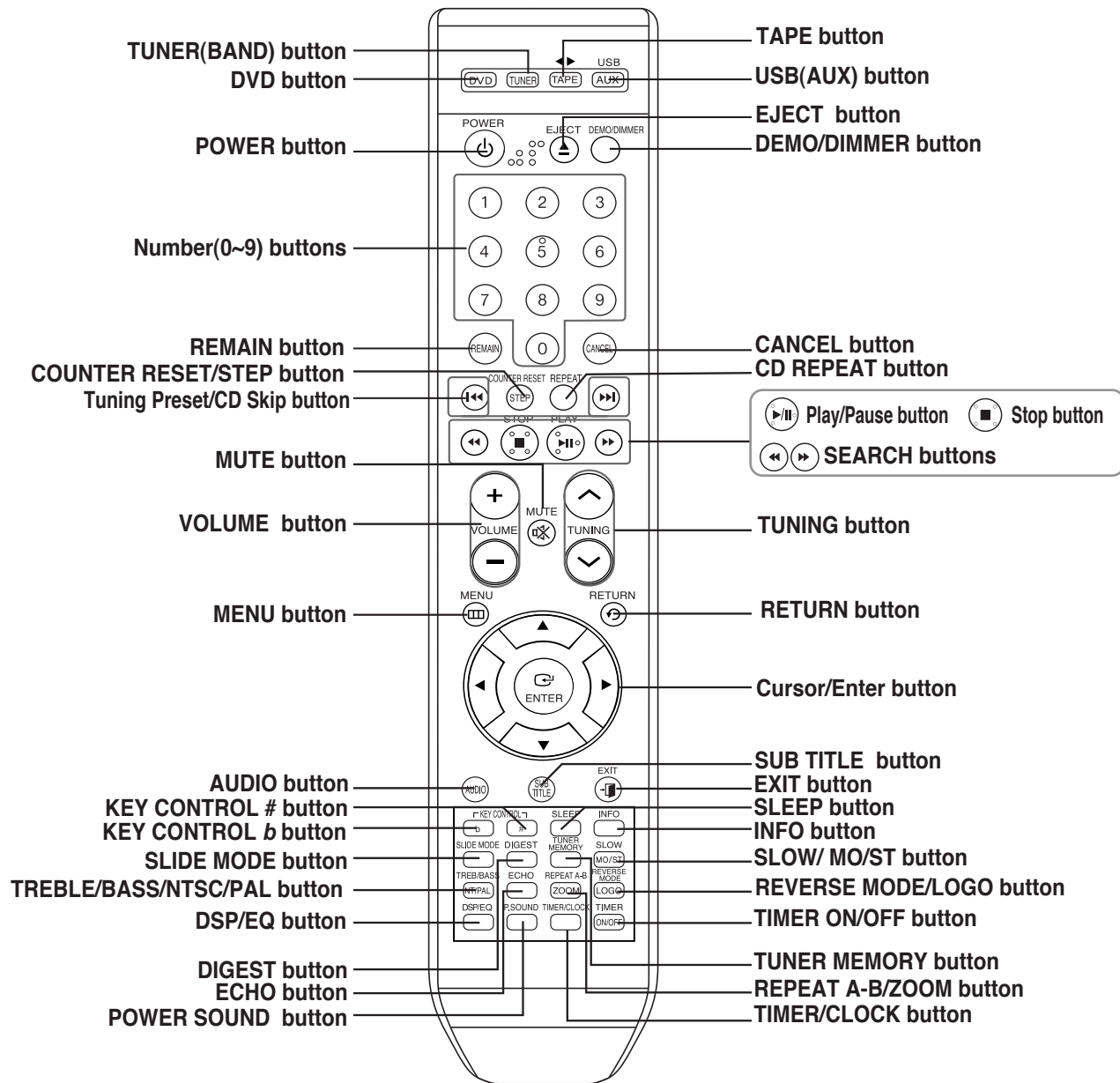

Insert Remote Batteries

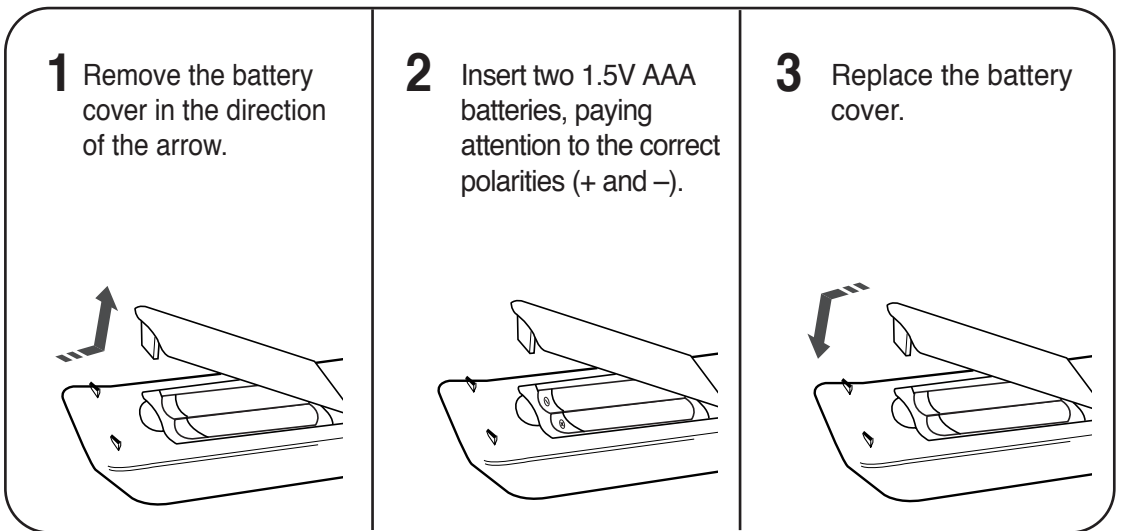

- Caution** Follow these precautions to avoid leaking or cracking cells:
- Place batteries in the remote control so they match the polarity:(+) to (+)and (-)to (-).
 - Use the correct type of batteries.Batteries that look similar may differ in voltage.
 - Always replace both batteries at the same time.
 - Do not expose batteries to heat or flame.

Range of Operation of the Remote Control

The remote control can be used up to approximately 23 feet/7 meters in a straight line. It can also be operated at a horizontal angle of up to 30° from the remote control sensor.

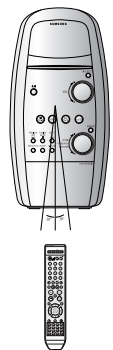



Connecting the Speakers

Before moving or installing the product, be sure to turn off the power and disconnect the power cord.

Connect the connecting jacks (2) to the back of mini-compact system.

◆ Make sure the polarities (+ and -) are correct.

MAX-DX75

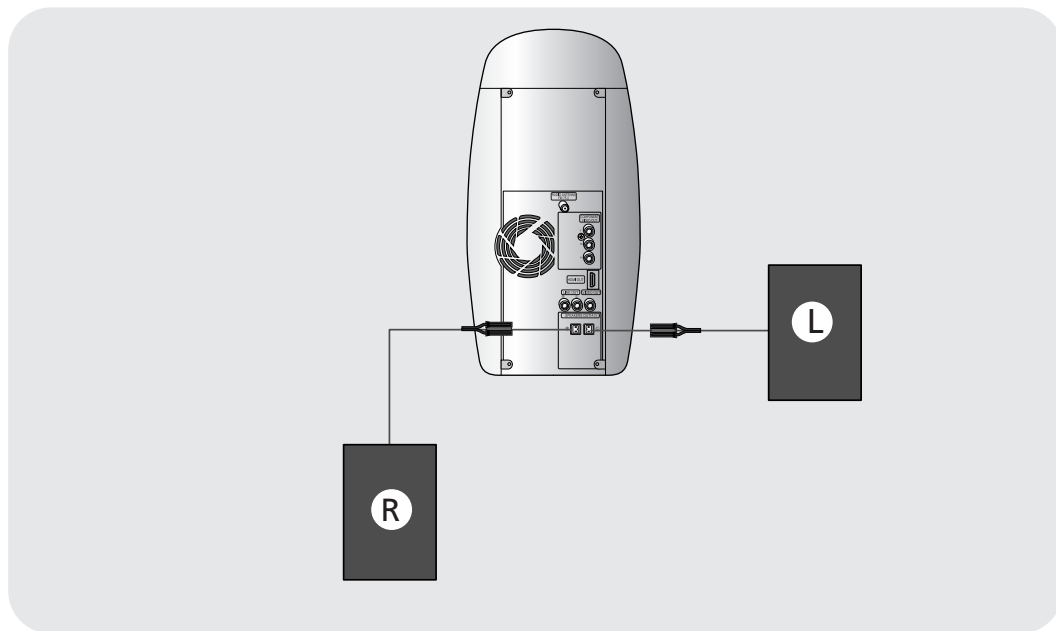

MAX-DX76

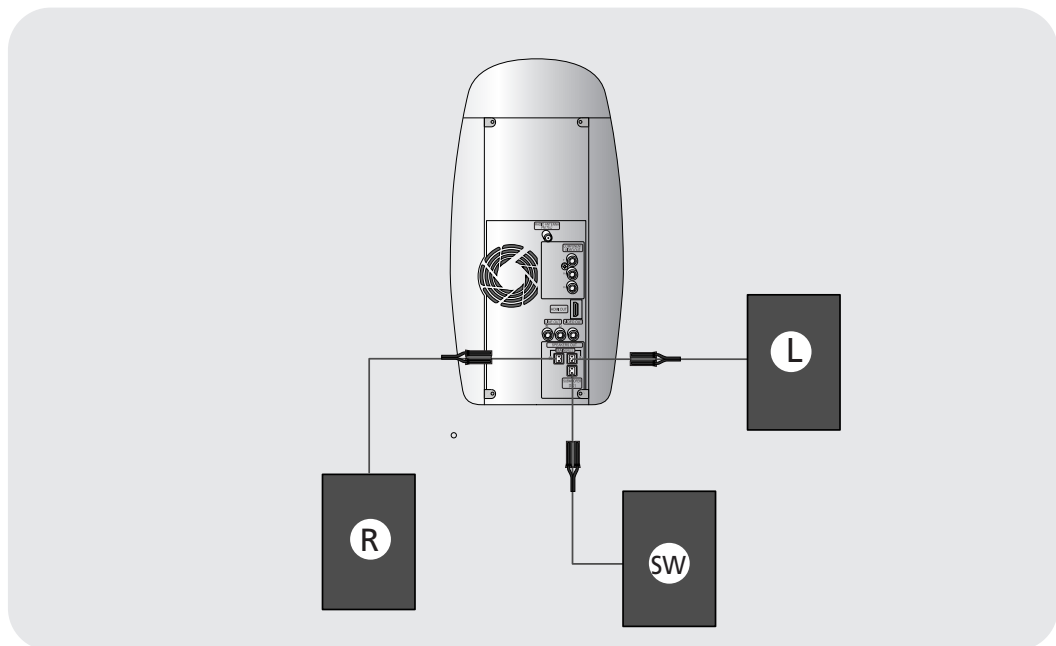

MAX-DX79

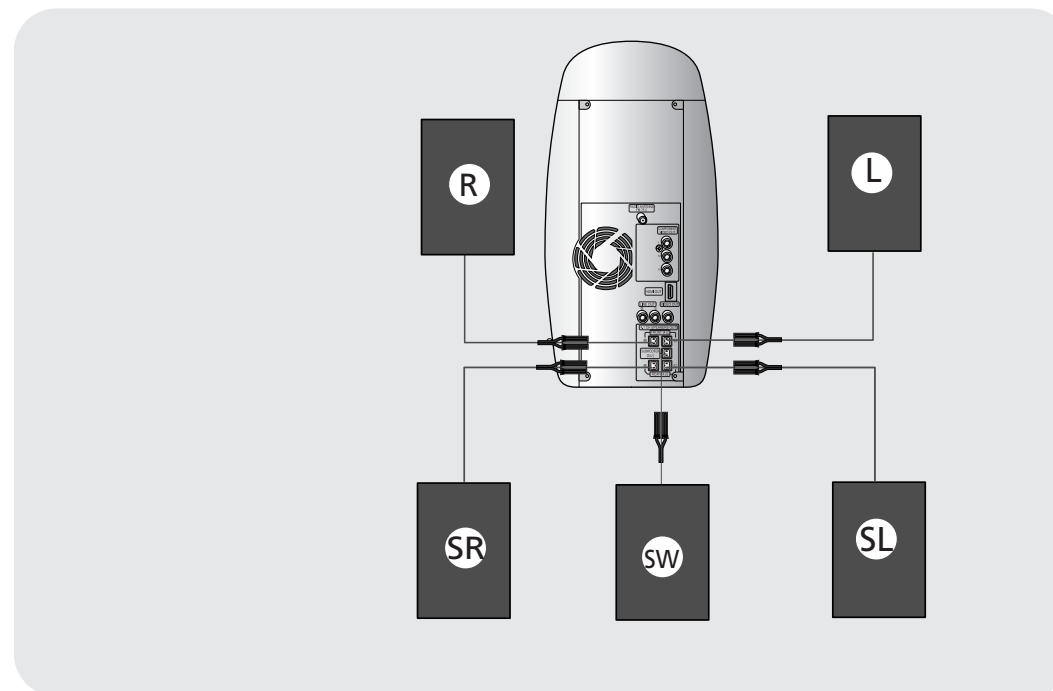

Position of the DVD Player

- Place it on a stand or cabinet shelf, or under the TV stand.

Speakers **L R**

- Place these speakers in front of your listening position, facing inwards (about 45°) toward you.
- Place the speakers so that their tweeters will be at the same height as your ear.

Subwoofer **SW**

- The position of the subwoofer is not so critical. Place it anywhere you like.
- Usually, it is placed by a corner near the front speakers.

Selecting the Listening Position

The listening position should be located about 2.5 to 3 times the distance of the TV's screen size away from the TV. Example: For 32" TVs 2~2.4m (6~8feet)
For 55" TVs 3.5~4m (11~13feet)

Rear Speakers **SL SR**

- Place these speakers behind your listening position.
 - If there isn't enough room, place these speakers so they face each other.
 - Place them about 60 to 90cm (2 to 3feet) above your ear, facing slightly downward.
- * Unlike the front and center speakers, the rear speakers are used to handle mainly sound effects and sound will not come from them all the time.

Directions in Installing Speaker

- Installation in a place near heating apparatus, under direct lay of light or with high humidity may cause performance degradation of the speaker.
- Do not install on the wall or on a high place of pole or other unstable place to prevent any safety accident caused by falling of the speaker.
- Do not take the speaker near from TV or computer monitor.
The speaker near the TV or computer monitor may influence the quality of the screen display.



Connecting the Video Out to your TV

Choose one of the three methods for connecting to a TV.

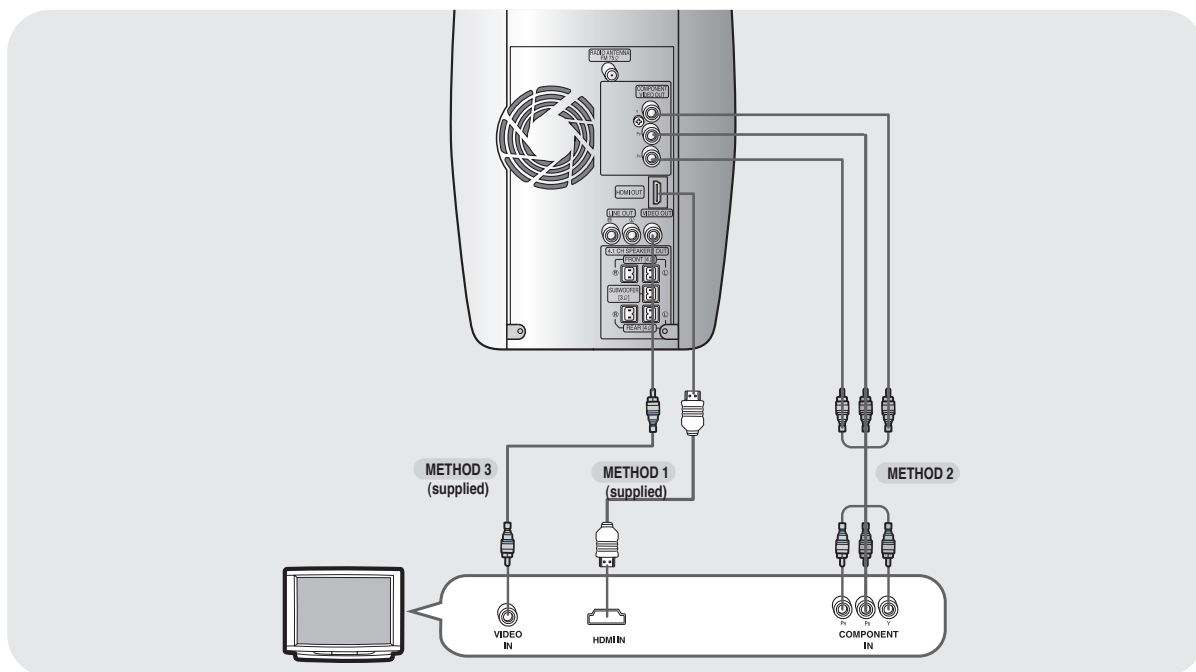

METHOD 1 : HDMI (Best Quality)

Connect the HDMI cable from the HDMI OUT jack on the back of the DVD Player to the HDMI IN jack on your TV.

METHOD 2 : Component Video (Better Quality)

If your television is equipped with Component Video inputs, connect a Component video cable(not supplied) from the Component Video Output (Pr, Pb and Y) jacks on the back of the panel of the main unit to the corresponding jacks on your television.

METHOD 3 : Composite Video..... (Good Quality)

Connect the supplied video cable from the VIDEO OUT jack on the back of the main unit to the VIDEO IN jack on your TV.

- This product operates in Interlace scan mode (480i Only) for Component Output.

Selecting the Video Format

Turn off the main unit and then press **NTSC/PAL** on the Remote Control or **REC/PAUSE** on the Main Unit.

- Each time the button is pressed, the video format switches between "NTSC" and "PAL".
- Each country has a different video format standard.
- For normal playback, the video format of the disc must be the same as the video format of your TV.



HDMI Function

What is HDMI (High Definition Multimedia Interface)?

This device transmits a DVD video signal digitally without the process of converting to analog. You will get sharper digital pictures when using an HDMI connection.

- Resolutions available for the HDMI output are 576p(480p).
- If the TV does not support the configured resolution, you will not be able to see the picture properly.
- When an HDMI cable is connected, composite and component video signals are not output.
- See your TV owner's manual for more information on how to select the TV's Video Input source.

Setting the HDMI Audio

The audio signals transmitted over the HDMI Cable can be toggled ON/OFF.



- 1 In Stop mode, press the **MENU** button.
- 2 Press the Cursor **▼** button to move to **<Audio>** and then press the **ENTER** button.
- 3 Press the Cursor **▼** button to move to **<HDMI AUDIO>** and then press the **ENTER** button.
- 4 Press the Cursor **▲, ▼** button to select **<ON>** or **<OFF>** and then press the **ENTER** button.

- **ON** : Both video and audio signals are transmitted over the HDMI connection cable, and audio is output through your TV speakers only.
- **OFF** : Video is transmitted over the HDMI connection cable only, and audio is output through the home theater speakers only.

- The default setting of this function is HDMI AUDIO OFF.
- HDMI AUDIO is automatically down-mixed to 2ch for TV speakers.
- BASS/TREBLE/ECHO/KEY CONTROL/P.SOUND/EQ/DSP function is not available when HDMI AUDIO is ON.
- MIC output is not available while HDMI AUDIO ON.

- Press the **RETURN** button to return to the previous level.
- Press the **EXIT** button to exit the setup screen.

Connecting External Components

Connecting an External Analog Component

Example: Analog signal components such as a VCR, Camcorder, and TV.

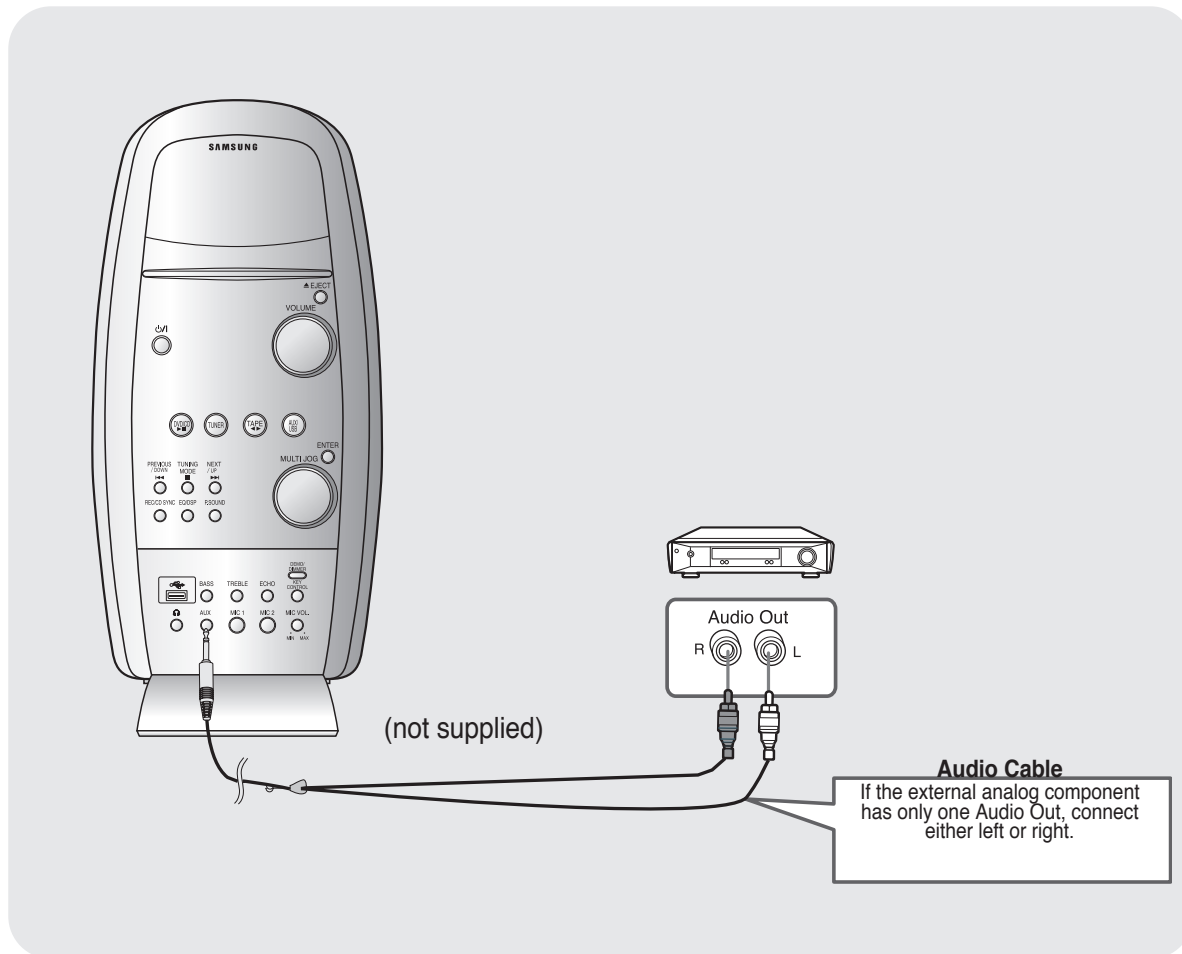

- 1 Connect Audio In on the DVD player to Audio Out on the external analog component.
 - Be sure to match connector colors.
- 2 Press **AUX** to select AUX.
 - 'AUX' appears in the display.

Connecting the FM Antennas

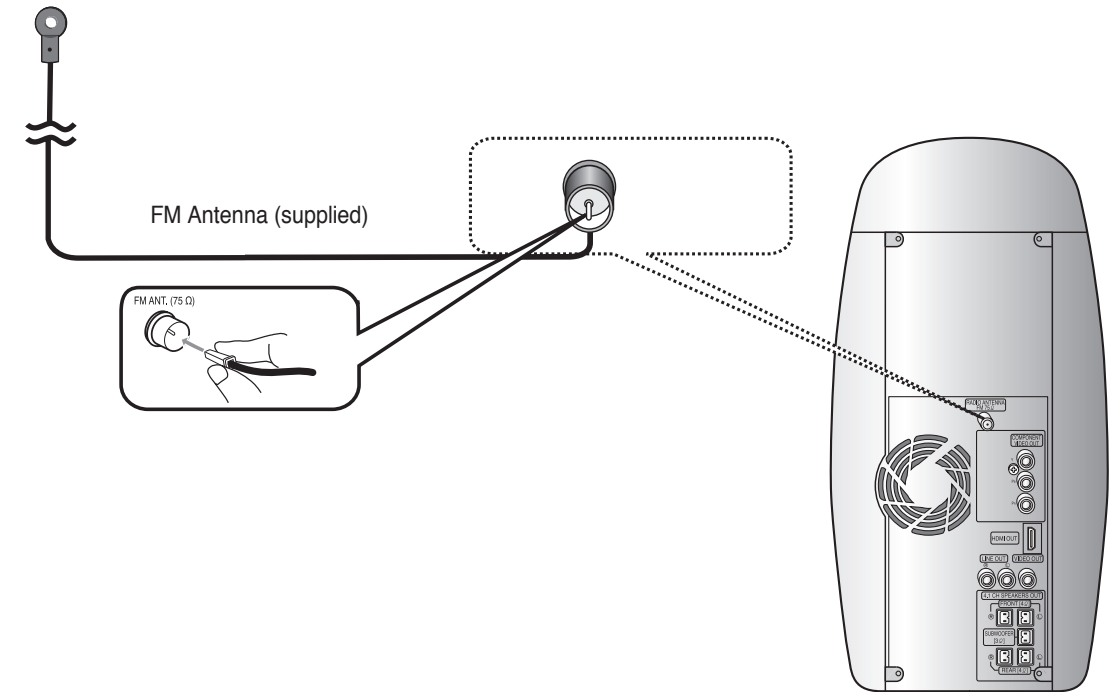

FM antenna connection

1. Connect the FM antenna supplied to the FM 75Ω COAXIAL terminal as a temporary measure.
2. Slowly move the antenna wire around until you find a location where reception is good, then fasten it to a wall or other rigid surface.

- If reception is poor, connect an outdoor antenna. Before attaching a 75Ω coaxial cable (with a standard type connector), disconnect the supplied FM antenna.

Cooling Fan

The cooling fan dissipates the heat generated inside the unit so that the unit can be operated normally. The cooling fan is activated automatically to supply cool air to the unit.

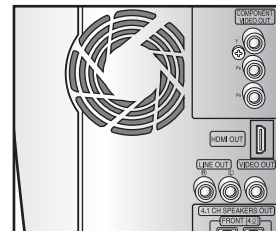

Please observe the following cautions for your safety.

- Make sure the unit is well-ventilated. If the unit has poor ventilation, the temperature inside the unit could rise and may damage it.
- Do not obstruct the cooling fan or ventilation holes. (If the cooling fan or ventilation holes are covered with a newspaper or cloth, heat may build up inside the unit and fire may result.)

Setting the Clock

For each step, you have a few seconds to set the required options.
If you exceed this time, you must start again.

1 Switch the system on by pressing **POWER** button.

2 Press **TIMER/CLOCK** twice.

- **CLOCK** is displayed.

3 Press **ENTER**.
The hour flashes.

- Increase the hours : ▶
- Decrease the hours : ◀

4 When the correct hour is displayed, press **ENTER**.
The minutes flash.

- Increase the minutes : ▶
- Decrease the minutes : ◀

5 When the correct time is displayed, press **ENTER**.

- **"TIMER"** appears in the display.
- The current time is now set.

Note

- You can display the time, even when you are using another function, by pressing **TIMER/CLOCK** once.

Note

You can also use Multi-Jog or ◀▶▶▶▶▶ button on the panel front instead of ◀, ▶ buttons in step 3,4.



Checking the Remaining Time

Press the **REMAIN** button.

- For checking the total and remaining time of a title or chapter being played.

Each time the **REMAIN** button is pressed

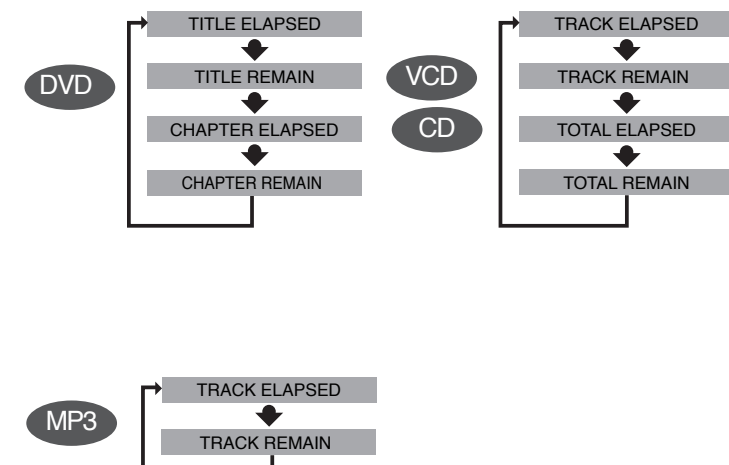



Disc Playback

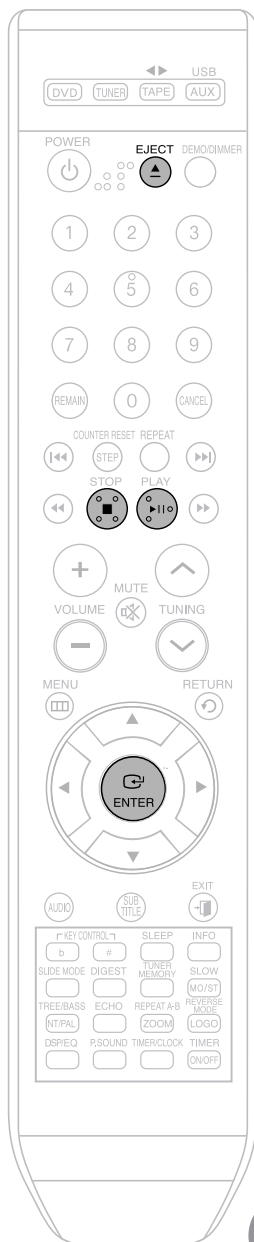

1 Load a disc.
 • Insert a disc that the disc's label facing up.

2 To eject the disc, press **EJECT** button

DVD VCD CD
 • Playback starts automatically.

MP3 DivX JPEG
 • Playback starts automatically.
 • If the TV is on, a list of MP3s on the CD will appear on the TV screen.



Note

- Depending on the content of the disc, the initial screen may appear different.
- Depending on the recording mode, some MP3-CDs cannot be played.
- Table of contents of a MP3-CD varies depending on the MP3 track format recorded on the disc.

To stop playback, press **STOP** during playback.

- If pressed once, "PRESS PLAY" is displayed and the stop position will be stored in memory. If **PLAY/PAUSE** (▶/II) button or **ENTER** button is pressed, playback resumes from the stop position. (This function works only with DVDs.)
- If pressed twice, "STOP" is displayed, and if **PLAY/PAUSE** (▶/II) button is pressed, playback starts from the beginning.

To temporarily pause playback, press **PLAY/PAUSE** during playback.

- To resume playback, press **PLAY/PAUSE** button again.



MP3/WMA-CD Playback

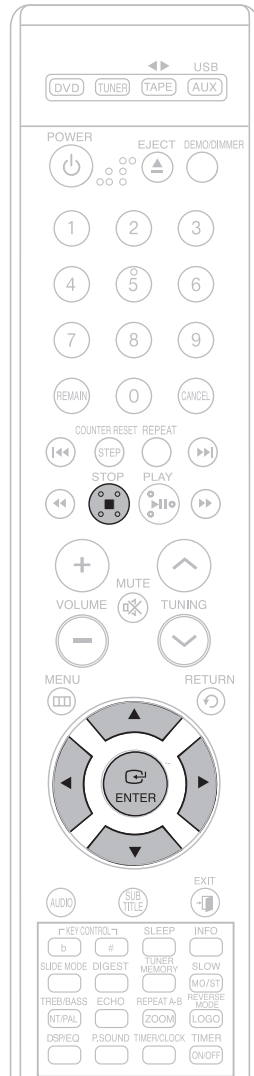

1 Load the MP3/WMA disc.
 • The MP3/WMA menu screen will appear and playback will start.
 • The appearance of the menu depends on the MP3/WMA disc.
 • WMA-DRM files cannot be played.

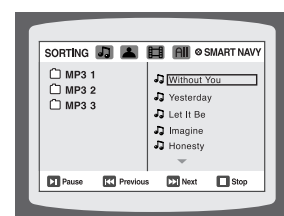

3 To change the album, use ◀ ▶ ▲ ▼ to select another album in Stop mode, and then press the **ENTER** button.
 • To select another album and track, repeat Steps 2 and 3 above.

Note

- Depending on the recording mode, some MP3/WMA-CDs may not play.
- Table of contents of a MP3-CD varies depending on the MP3/WMA track format recorded on the disc.

2 In Stop mode, use ◀ ▶ ▲ ▼ to select the album, and then press the **ENTER** button.
 • Use ▲ ▼ to select the track.

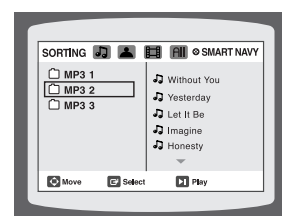

4 Press the **STOP** button to stop playback.

To play a file icon in the screen,

Press the ◀ ▶ ▲ ▼ button when it is in stop status and select a desired icon from the top part of the menu.

- To play music files only, select the icon.
- To view image files only, select the icon.
- To view movie files only, select the icon.
- To select all files select the icon.

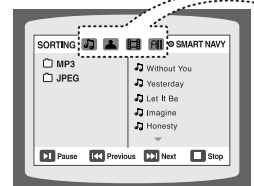

- Music File Icon
- Image File Icon
- Movie File Icon
- All File Icon

DivX Playback

Skip Forward/Back

During playback, press the **⏮️⏭️** button.

- Go to the next file whenever you press **⏭️** button, if there are over 2 files in the disk.
- Go to the previous file whenever you press **⏮️** button, if there are over 2 files in the disk.

Fast playback

Press and hold **⏮️⏭️** button.

- Each time the button is held down during playback, the playback speed changes as follows:

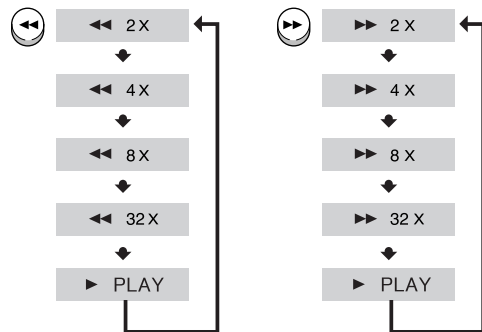

Zoom Function

1 Press **ZOOM** button.

- Each time you press the button, your selection will toggle between **"ZOOM X2"** and **"ZOOM OFF"**.

2 Press Cursor **▲, ▼, ◀, ▶** buttons to move to the area you want to enlarge.

Note

- DivX files can be played in Zoom X2 mode only.

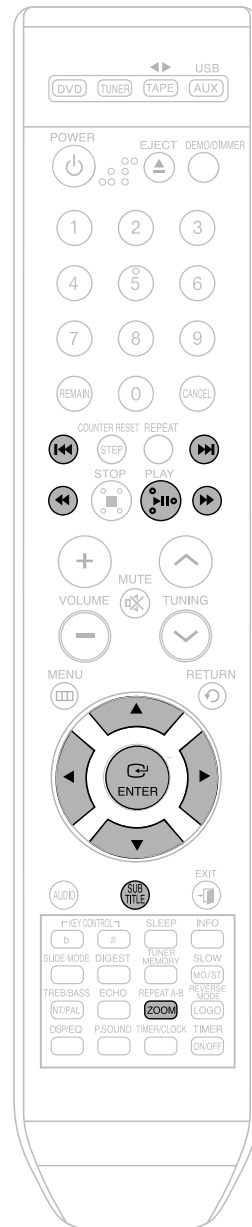

5 Minute Skip function

During playback, press the **◀, ▶** button.

- Go to the screen about 5 minutes after whenever you press **▶** button.
- Go to the screen about 5 minutes earlier whenever you press **◀** button.

Subtitle Display

Press the **SUBTITLE** button.

- Each time you press the button, your selection will toggle between **"SUBTITLE ON"** and **"SUBTITLE OFF"**.
- If the disc has only one subtitle file, it will be played automatically.
- Up to 8 subtitle languages are supported.

DivX Feature Table

DivX Supported

Avi files are used to contain the audio and video data; these must be stored on CD in the ISO 9660 format.

		SPEC
VIDEO Compatibility	DivX3.11	Up to the latest VERSION
	WMV	WMV V1/V2/V3/V7
AUDIO Compatibility	MP3	CBR : 80kbps~384kbps
	AC3	CBR : 128kbps~384kbps
	WMA	CBR : 56kbps~128kbps

MPEGs containing DivX can be divided into Video and Audio.

- **Video compatibility** : All versions of DivX later than 3.11 (including the latest 5.1) are supported. In addition, XviD is supported. For WMV, V1, V2, V3, and V7 formats are possible. The initial resolution is 720X480 and may support up to 720X576 .

- **Audio compatibility** : MP3s encoded at bitrates from 80kbps to 384kbps, AC3s from 128kbps to 384kbps, and WMAs from 56kbps to 128kbps are supported.

- In addition, for subtitles, this unit will support Text format (SMI).

Note

- When playing the DivX disk, you can play the file with extension of AVI only.
- Among the available DivX audio formats, DTS Audio is not supported.
- WMV V8 is not supported for WMV files.
- When burning a subtitle file to a CD-ROM with your PC, be sure to burn it as an SMI file.
- DivX Disc does not playing when its sampling frequency is lower than 32KHz.
- Some of the discs recorded in DivX or XviD depending on the way of recording could be played back not correctly or couldn't be played back at all.
- MP3 file support: MPEG1 LAYER3 (BITRATE : 128KBPS~320KBPS , SAMPLING FREQ.: 32K/44.1K/48KHz) .



Playing Media Files using the USB feature

You can connect and play files from external USB storage devices such as MP3 players, USB flash memory, etc. using the player's USB function.

1 connect the USB cable.

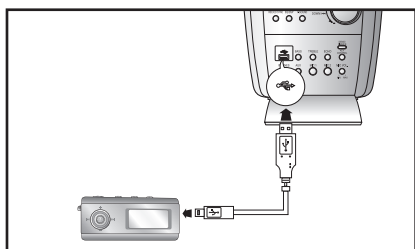

2 Press the AUX/USB button on the main unit or the USB/AUX button on the remote control to select the USB mode.

- "USB" appears on the display screen and then disappear.
- USB SORTING screen appears on the TV screen and the saved file is played.

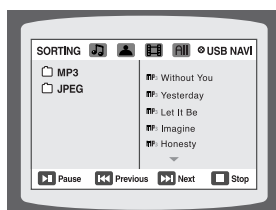

To stop playback, press the **STOP** (■) button.

- Note**
- Video files (DivX, WMV, MPEG, etc.) are supported.
 - To prevent the loss of data saved in the USB device, please turn the unit off or switch it to another mode before disconnecting the USB cable.

To play a file in the USB menu screen,

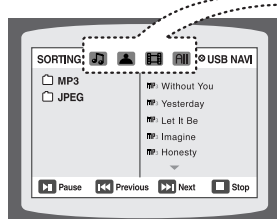

- Music File Icon
- Image File Icon
- All File Icon
- Movie File Icon

Press the ◀ ▶ ▲ ▼ button when it is in stop status and select a desired icon from the top part of the menu.

- To play music files only, select the 🎵 icon.
- To view image files only, select the 🖼️ icon.
- To select all files select the 📁 icon.
- To view movie files only, select the 🎬 icon.



Skip Forward/Back

During playback, press the ◀◀ ▶▶ button.

- When there is more than a file, when you press the ▶▶ button, the next file is selected.
- When there is more than a file, when you press the ◀◀ button, the previous file is selected.

Fast playback

To playback the disc at a faster speed, press and hold ◀◀ or ▶▶ during playback.

- Each time you press and hold either button, the playback speed will change as follows: 2x → 4x → 8x → 32x → Normal.

Compatible Devices

1. USB devices that support USB Mass Storage v1.0. (USB devices that operate as a removable disk in Windows (2000 or later) without additional driver installation.)
2. MP3 Player: HDD and flash type MP3 player.
3. Digital camera: PTP protocol is not supported.
 - Devices which require additional program installation when you have connected it to a computer, are not supported.
4. USB HDD and USB Flash Drive: Devices that support USB2.0 or USB1.1.
 - You may experience a difference in playback quality when you connect a USB1.1 device.
 - For a USB HDD, make sure to connect an auxiliary power cord to the USB HDD for proper operation.
5. USB card Reader: One slot USB card reader and Multi slot USB card reader
 - Depending on the manufacturer, the USB card reader may not be supported.
 - If you install multiple memory devices into a multi card reader, you may experience problems.

Supported Formats

	File name	File extension	Bit rate	Version	Pixel	Sampling Frequency
Still Picture	JPG	.JPG .JPEG	—	—	640*480	—
Music	MP3	.MP3	80~384kbps	—	—	44.1kHz
	WMA	.WMA	56~128kbps	V8	—	44.1kHz
Movie	VCD	MPG.MPEG .DAT	1.5Mbps	VCD1.1,VCD2.0	320*480	44.1KHz
	WMV	WMV	4Mbps	V1,V2,V3,V7 (V9 is not supported)	720*480	44.1KHz~48KHz
	DivX	.AVI,.ASF	4Mbps	DivX3.11~DivX5.1,Xvid	720*480	44.1KHz~48KHz

• A device using NTFS file system is not supported.(Only FAT file system is supported.)

The USB host function of this product does not support all USB devices. For the information on the supported devices,pls see the P68.



Displaying Disc Information

You can view playback information on the disc on the TV screen.

Press **INFO** button on the remote control .

- Each time the button is pressed, the display changes as follows:

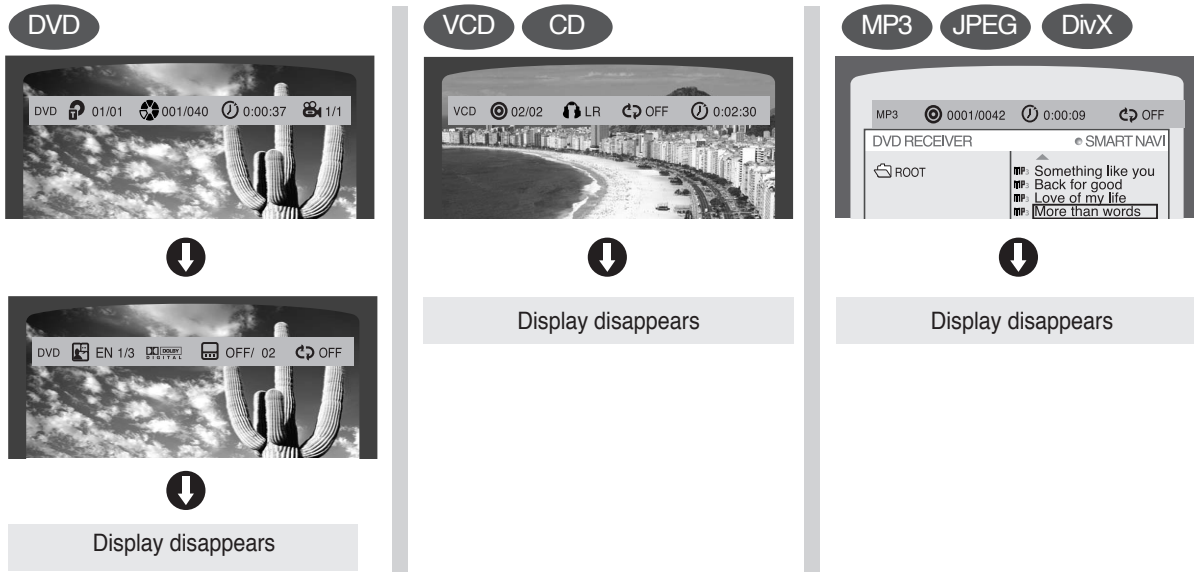

- **What is a Title?**
A movie contained in a DVD disc.
- **What is a Chapter?**
Each title on a DVD disc is divided into several smaller sections called "chapters".
- **Hand icon appears on the TV screen!**
If this symbol appears on the TV screen while buttons are being operated, that operation is not possible with the disc currently being played.
- **What is a Track (File)?**
A section of video or a music file recorded on a VCD, CD, or MP3-CD.

Note

- Depending on the disc, the disc information display may appear different.

Screen Display

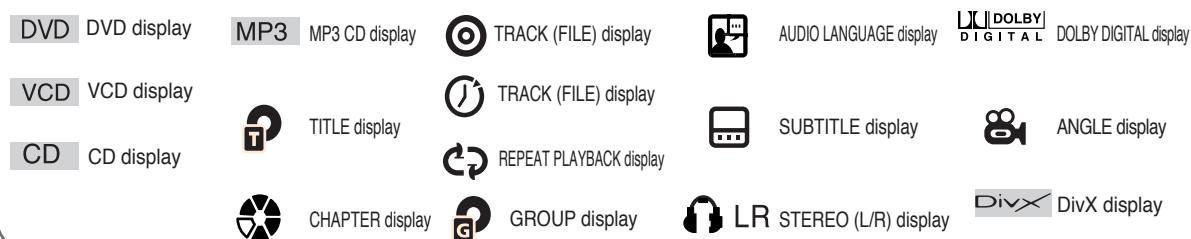

Fast/Slow Playback

Fast Playback DVD VCD CD MP3

Press and hold **FAST** button .

- Each time the button is held down during playback, the playback speed changes as follows:

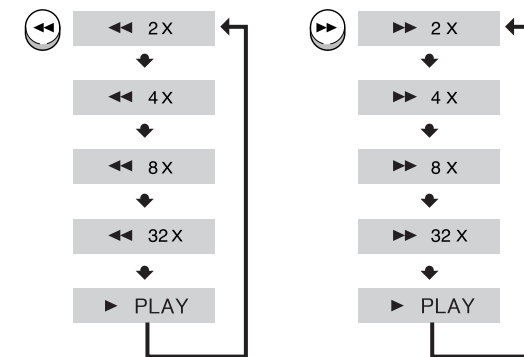

Slow Playback

Press **SLOW** button.

- Each time the button is pressed during playback, the playback speed changes as follows:

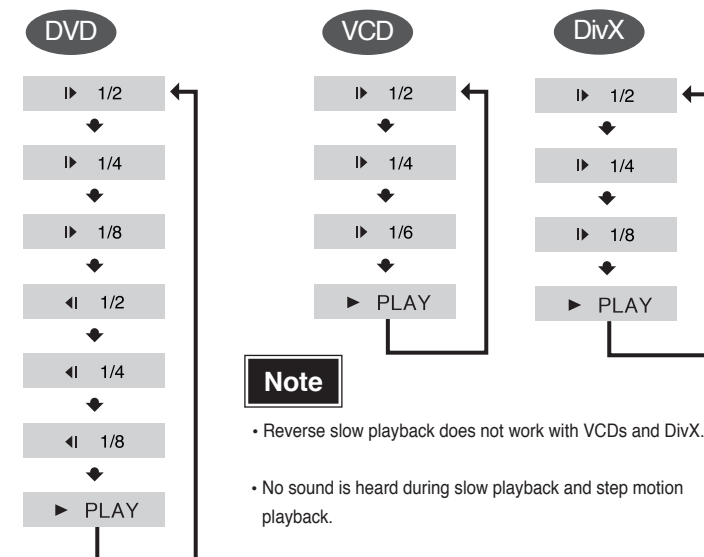

Note

- Reverse slow playback does not work with VCDs and DivX.
- No sound is heard during slow playback and step motion playback.



Skipping Scenes/Songs

DVD VCD MP3

Briefly press **⏮** **⏭**.

- Each time the button is pressed briefly during playback, the previous or next chapter, track, or directory (file) will be played.
- But, you cannot skip chapters consecutively.

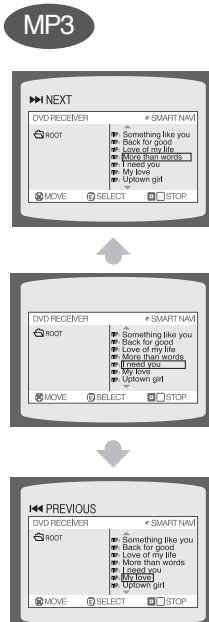

- When watching a VCD with a track longer than 15 minutes, each time **⏮** **⏭** is pressed, playback will skip back or forward 5 minutes.

Step Function

DVD VCD

Press **STEP** button.

- The picture moves forward one frame each time the button is pressed during playback.



Angle Function

This function allows you to view the same scene in different angles.

DVD

1 Press **INFO** button.

2 Press **Cursor** **▶** button to move to **ANGLE** display.

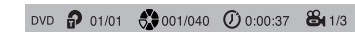

3 Press **Cursor** **▲**, **▼** buttons or numeric buttons to select the desired angle.

- Each time the button is pressed, the angle changes as follows:

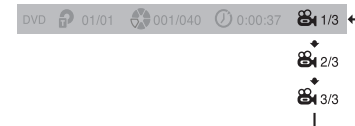

Note • The Angle function works only with discs on which multiple angles have been recorded.

OPERATION



Repeat Playback

Repeat playback allows you to repeatedly play a chapter, title, track (song), or directory (MP3 file).

DVD VCD CD MP3 JPEG

Press **CD REPEAT** button.

- Each time the button is pressed during playback, the repeat playback mode changes as follows:

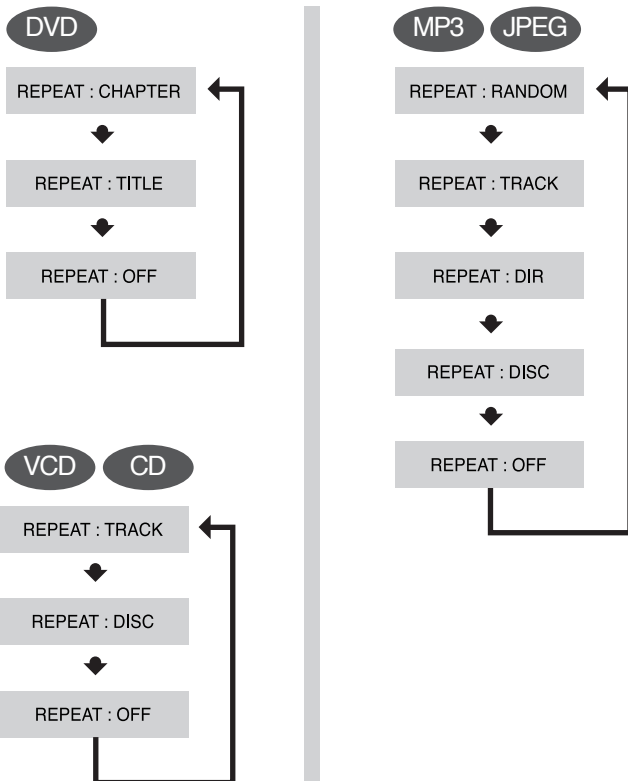

Repeat Playback Options

- CHAPTER**
Repeatedly plays the selected chapter.
- TITLE**
Repeatedly plays the selected title.
- RANDOM**
Plays tracks in random order. (A track that has already been played may be played again.)
- TRACK**
Repeatedly plays the selected track.
- DIR**
Repeatedly plays all tracks in the selected folder.
- DISC**
Repeatedly plays the entire disc.
- OFF**
Cancels Repeat Playback.

Note

- Repeat playback operation is not possible with version 2.0 VCD discs if PBC is turned on. To use Repeat Playback on a VCD with PBC, you should set the PBC to OFF in the disc menu. (See page 35.)

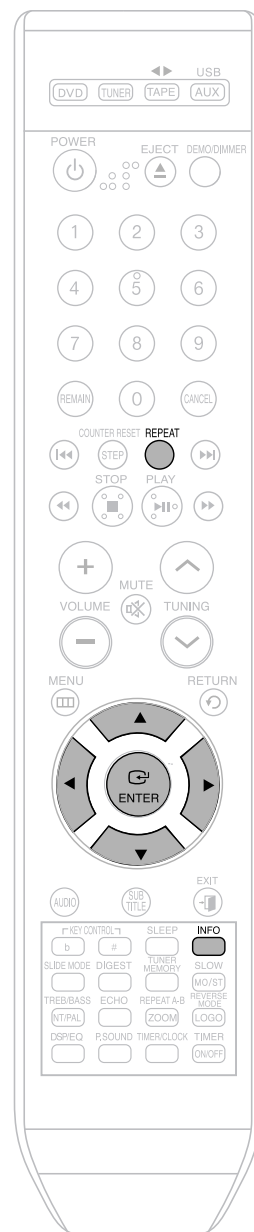

DVD VCD CD

To Select a Repeat Playback Mode in the Disc Information Screen

1 Press **INFO** button twice .

- For a VCD or CD, Press INFO button once.

2 Press Cursor **▶** button to move to REPEAT PLAYBACK display.

3 Press Cursor **▼** button to select the desired Repeat Playback mode.

4 Press **ENTER** button.

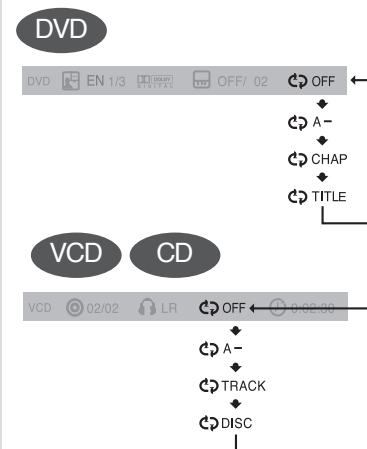

Note

- For MP3 and JPEG discs, you cannot select Repeat Play from the information display screen.
- For VCD Version 2.0 discs, you can select Repeat Play in PBC off mode.



A↔B Repeat Playback

DVD VCD CD

- 1 Press the **INFO** button twice.
- 2 Press the Cursor **▶** button to move to the REPEAT PLAYBACK (↻) display.
- 3 Press the Cursor **▲, ▼** button to select <A-> and then press the **ENTER** button at the beginning of the desired segment.
 - When the **ENTER** button is pressed, the selected position will be stored in memory.
- 4 Press the **ENTER** button at the end of the desired segment.
 - The specified segment will be played repeatedly.

DVD ◀ EN 1/3 ▶ OFF/ 02 ↻ A-B

REPEAT: A-B

- To return to normal playback, press the Cursor **▲, ▼** button to select **↻ OFF**.



• The A-B Repeat function does not operate with DivX, MP3 or JPEG discs.

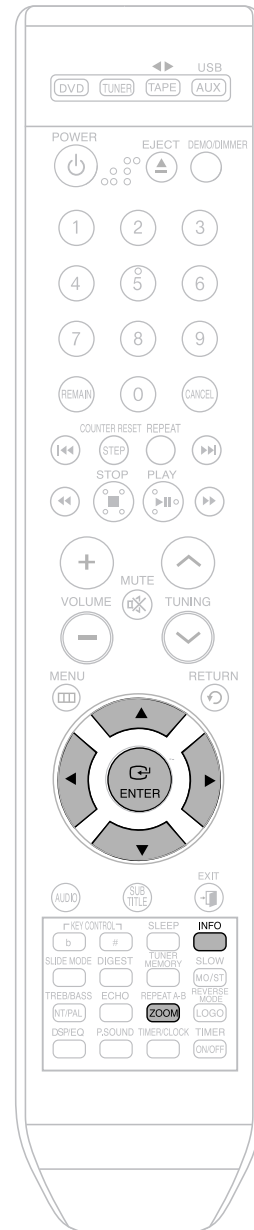

Zoom Function

This function allows you to enlarge a particular area of the displayed image.

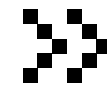

Zoom (Screen Enlarge) Function

DVD VCD

1 Press **ZOOM** button.



2 Press Cursor **▲, ▼, ◀, ▶** buttons to move to the area you want to enlarge.



3 Press **ENTER** button.

- Each time the button is pressed, the zoom level changes as follows:

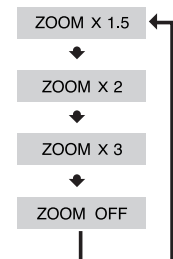

Before Reading the User's Manual

Make sure to check the following terms before reading the user manual.

Icons that will be used in manual

Icon	Term	Definition
	DVD	This involves a function available with DVD or DVD-R/DVD-RW discs that have been recorded and finalized in Video Mode.
	CD	This involves a function available with a data CD (CD-R or CD-RW).
	MP3	This involves a function available with CD-R/-RW discs.
	JPEG	This involves a function available with CD-R/-RW discs.
	DivX	This involves a function available with MPEG4 discs. (DVD±R/RW, CD-R or CD-RW)
	CAUTION	This involves a case where a function does not operate or settings may be cancelled.
	NOTE	This involves tips or instructions on the page that help each function operate.



• In this manual, the instructions marked with "DVD ()" are applicable to DVD-VIDEO, DVD-AUDIO and DVD-R/-RW discs that have been recorded in Video Mode and then finalized.

Where a particular DVD type is mentioned, it is indicated separately.

• If a DVD-R/-RW disc has not been recorded properly in DVD Video format, it will not be playable.

OPERATION

Selecting Audio Subtitle Language

Moving Directly to a Scene/Song

Audio Language Selection Function DVD

1 Press **INFO** button twice.



2 Press Cursor **▲**, **▼** buttons or numeric buttons to select the desired audio language.

- Depending on the number of languages on a DVD disc, a different audio language (ENGLISH, SPAIN, JAPANESE, etc.) is selected each time the button is pressed.

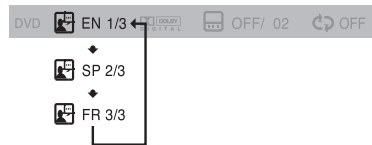

Subtitle Language Selection Function DVD

1 Press **INFO** button twice.



2 Press Cursor **▶** button to move to **SUBTITLE** display.



3 Press Cursor **▼** button or numeric buttons to select the desired subtitle.

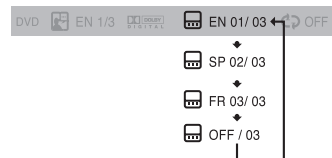

Note

- You can use the **SUBTITLE** button on the remote control to select a subtitle language.
- Depending on the disc, the Subtitle and Audio Language functions may not work.

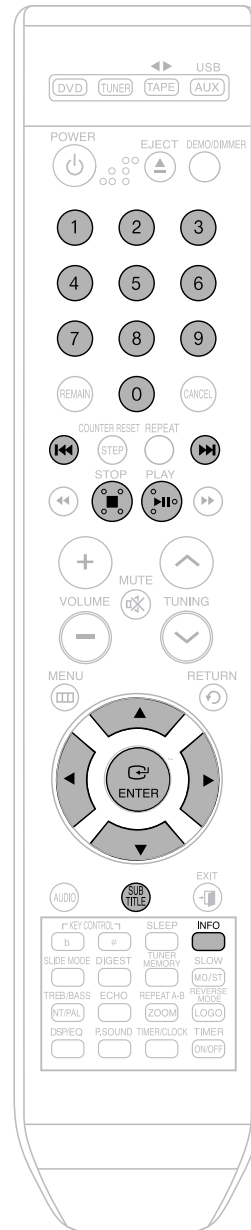

DVD VCD CD

1 Press **INFO** button.



Moving to a Chapter

4 Press Cursor **▲**, **▼** buttons or numeric buttons to select the desired chapter and then press **ENTER** button.

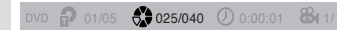

MP3 JPEG

Press the **numeric** buttons.

- The selected file will be played.
- A MP3 or JPEG disc cannot be moved from the disc information screen.
- When playing a MP3 or JPEG disc, you cannot use **▲**, **▼** to move a folder. To move a folder, press **■** (Stop) and then press **▲**, **▼**.

Moving to a Title/Track

2 Press Cursor **▲**, **▼** buttons or numeric buttons to select the desired title/track and then press **ENTER** button.



Moving to a Specific Time

5 Press Cursor **◀**, **▶** buttons to move to time display.



Moving to a Chapter

3 Press Cursor **◀**, **▶** buttons to move to Chapter display.

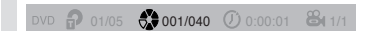

Moving to a Specific Time

6 Press the numeric buttons to select the desired time and then press **ENTER** button.

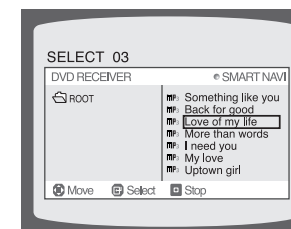

Note

- You can press **◀◀▶▶** on the remote control to move directly to the desired title, chapter, or track.
- Depending on the disc, you may not be able to move to the selected title or time.

JPEG File Playback JPEG

Images captured with a digital camera or camcorder, or JPEG files on a PC can be stored on a CD and then played back with this DVD player.

Slide Mode

1 Load the JPEG disc..

- Playback starts automatically. Each image is displayed for 5 seconds and then the next image is displayed.

2 Press **SLIDE MODE** button.

- Each time the button is pressed, the image makes the transition as follows :

SLIDE SHOW MODE : 1~5 → SLIDE SHOW MODE : RANDOM →
SLIDE SHOW MODE : NONE

Press **◀◀▶▶** to skip to the next slide.

- Each time the button is pressed, the slide moves backward or forward.

Digest Function

You can view 9 JPEG images on the TV screen at once.

1 Press the **DIGEST** button during playback.

- JPEG files will be shown in 9 windows.

2 Press the Cursor **▲, ▼, ◀, ▶** button to select the desired image and then press the **ENTER** button.

- The selected image is played for 5 seconds before moving to the next image.

➤ To view the previous or next 9 images, press the **◀◀▶▶** button.



Rotate/Flip Function

Press Cursor **▲, ▼, ◀, ▶** buttons during playback.

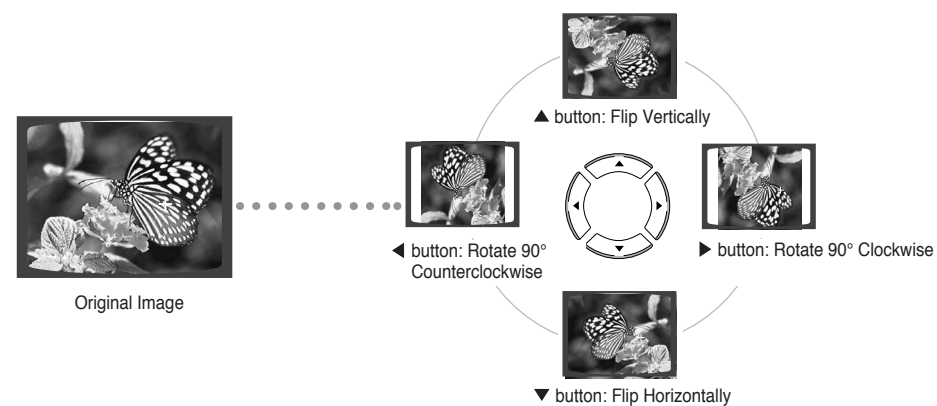

Using Disc Menu

You can use the menus for the audio language, subtitle language, profile, etc. DVD menu contents differ from disc to disc.

Using the Title Menu

For DVDs containing multiple titles, you can view the title of each movie. Depending on the disc, this function may either not work at all or may work differently.

DVD

1 In stop mode, Press **MENU** button.

- When playing a VCD (version 2.0), this toggles between PBC ON and OFF.



2 Press Cursor **▲**, **▼** buttons to move to 'DISC MENU' and then press **ENTER** button.

- When you select the disc menu that is not supported by the disc, the "**This menu is not supported**" message appears on the screen.



3 Press Cursor **▲**, **▼**, **◀**, **▶** buttons to select the desired item.



4 Press **ENTER** button.



Note

PBC (Playback Control) Function

When playing a VCD (version 2.0), you can select and view various scenes according to the menu screen.

PBC ON: This VCD disc is version 2.0. The disc is played back according to the menu screen. Some functions may be disabled. When some functions are disabled, select "PBC OFF" to enable them.

PBC OFF: This VCD disc is version 1.1. The disc is played back in the same way as with a music CD.

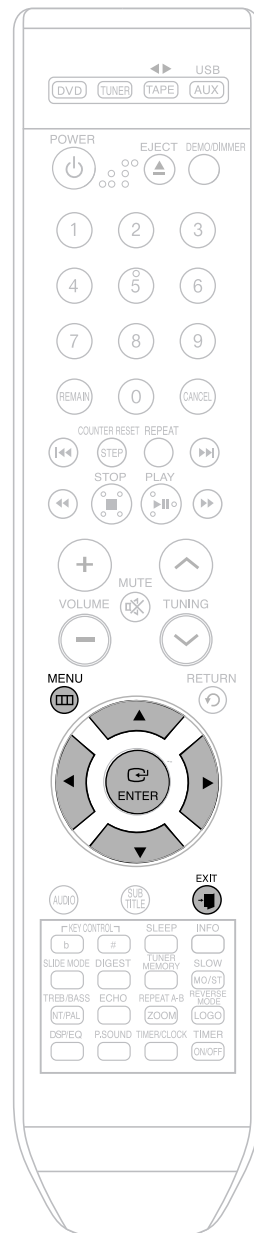

DVD

1 In stop mode Press **MENU** button.



2 Press Cursor **▲**, **▼** button to move to 'Title Menu'.



3 Press **ENTER** button.

- The title menu appears.



Press **EXIT** button to exit the setup screen.

OPERATION

Setting the Language

OSD language is set to English by default.

Language Code List

Enter the appropriate code number for the initial settings "Disc Audio", "Disc Subtitle" and/or "Disc Menu" (See page 39).

1 In stop mode, Press **MENU** button.



2 Press Cursor **▼** button to move to 'Setup' and then press **ENTER** button.



3 Press **ENTER** button.

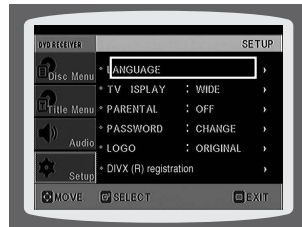

4 Press Cursor **▲, ▼** button to select the desired item and then press **ENTER** button.



Selecting the OSD Language

5 Press Cursor **▲, ▼** button to select the desired language and then press **ENTER** button.

- Once the setup is complete, if the language was set to English, OSD will be displayed in English.



Selecting the Audio Language (recorded on the disc)

Note

- To select other language, select OTHER and enter the language code of your country. (See 40 page for language code of countries) AUDIO, SUB TITLE and DISC MENU language can be selected.



Selecting the Disc Menu Language (recorded on the disc)



Selecting the Subtitle Language (recorded on the disc)



* If the language you selected is not recorded on the disc, menu language will not change even if you set it to your desired language.

Code	Language	Code	Language	Code	Language	Code	Language
1027	Afar	1181	Frisian	1334	Latvian, Lettish	1506	Slovenian
1028	Abkhazian	1183	Irish	1345	Malagasy	1507	Samoan
1032	Afrikaans	1186	Scots Gaelic	1347	Maori	1508	Shona
1039	Amharic	1194	Galician	1349	Macedonian	1509	Somali
1044	Arabic	1196	Guarani	1350	Malayalam	1511	Albanian
1045	Assamese	1203	Gujarati	1352	Mongolian	1512	Serbian
1051	Aymara	1209	Hausa	1353	Moldavian	1513	Siswati
1052	Azerbaijani	1217	Hindi	1356	Marathi	1514	Sesotho
1053	Bashkir	1226	Croatian	1357	Malay	1515	Sundanese
1057	Byelorussian	1229	Hungarian	1358	Maltese	1516	Swedish
1059	Bulgarian	1233	Armenian	1363	Burmese	1517	Swahili
1060	Bihari	1235	Interlingua	1365	Nauru	1521	Tamil
1069	Bislama	1239	Interlingue	1369	Nepali	1525	Tegulu
1066	Bengali; Bangla	1245	Inupiak	1376	Dutch	1527	Tajik
1067	Tibetan	1248	Indonesian	1379	Norwegian	1528	Thai
1070	Breton	1253	Icelandic	1393	Occitan	1529	Tigrinya
1079	Catalan	1254	Italian	1403	(Afan) Oromo	1531	Turkmen
1093	Corsican	1257	Hebrew	1408	Oriya	1532	Tagalog
1097	Czech	1261	Japanese	1417	Punjabi	1534	Setswana
1103	Welsh	1269	Yiddish	1428	Polish	1535	Tonga
1105	Danish	1283	Javanese	1435	Pashto, Pushto	1538	Turkish
1109	German	1287	Georgian	1436	Portuguese	1539	Tsonga
1130	Bhutani	1297	Kazakh	1463	Quechua	1540	Tatar
1142	Greek	1298	Greenlandic	1481	Rhaeto-Romance	1543	Twi
1144	English	1299	Cambodian	1482	Kirundi	1557	Ukrainian
1145	Esperanto	1300	Kannada	1483	Romanian	1564	Urdu
1149	Spanish	1301	Korean	1489	Russian	1572	Uzbek
1150	Estonian	1305	Kashmiri	1491	Kinyarwanda	1581	Vietnamese
1151	Basque	1307	Kurdish	1495	Sanskrit	1587	Volapuk
1157	Persian	1311	Kirghiz	1498	Sindhi	1613	Wolof
1165	Finnish	1313	Latin	1501	Sangro	1632	Xhosa
1166	Fiji	1326	Lingala	1502	Serbo-Croatian	1665	Yoruba
1171	Faeroese	1327	Laothian	1503	Singhalese	1684	Chinese
1174	French	1332	Lithuanian	1505	Slovak	1697	Zulu

SETUP

Press **EXIT** button to exit the setup screen.

Press **RETURN** button to return to the previous level.

Setting TV Screen type



1 In stop mode, Press **MENU** button.



2 Press Cursor **▼** button to move to 'Setup' and then press **ENTER** button.

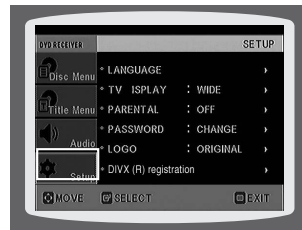

3 Press Cursor **▼** button to move to 'TV DISPLAY' and then press **ENTER** button.



4 Press Cursor **▲,▼** button to select the desired item and then press **ENTER** button.

- Once the setup is complete, you will be taken to the previous screen.

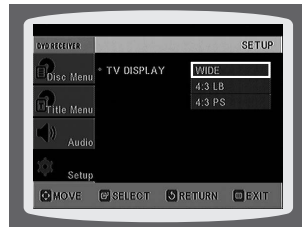

Adjusting the TV Aspect Ratio (Screen Size)

The horizontal to vertical screen size ratio of conventional TVs is 4:3, while that of widescreen and high definition TVs is 16:9. This ratio is called the aspect ratio. When playing DVDs recorded in different screen sizes, you should adjust the aspect ratio to fit your TV or monitor.

For a standard TV, select either <4:3PS> or <4:3LB> option according to personal preference. Select <WIDE/HDTV> if you have a widescreen TV.

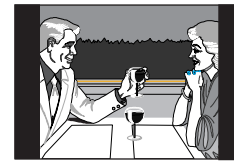

4:3PS (4:3 Pan&Scan)

Select this to play a 16:9 picture in the pan & scan mode on a conventional TV.

- You can see the central portion of the screen only (with the sides of the 16:9 picture cut off).



4:3LB (4:3 Letterbox)

Select this to play a 16:9 picture in the letter box mode on a conventional TV.

- Black bars will appear at the top and bottom of the screen.



WIDE/HDTV

Select this to view a 16:9 picture in the full-screen mode on your widescreen TV.

- You can enjoy the widescreen aspect.



- If a DVD is in the 4:3 ratio, you cannot view it in widescreen.
- Since DVD discs are recorded in various image formats, they will look different depending on the software, the type of TV, and the TV aspect ratio setting.
- When using HDMI, the screen is automatically converted to Wide mode.

Press **RETURN** button to return to the previous level.

Press **EXIT** button to exit the setup screen.

Setting Parental Controls (Rating Level)

Use this to restrict playback of adult or violent DVDs you do not want children to view.

1 in stop mode, Press **MENU** button.



2 Press Cursor **▼** button to move to 'Setup' and then press **ENTER** button.

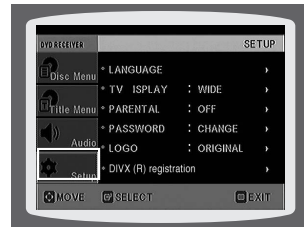

3 Press Cursor **▼** button to move to 'PARENTAL' and then press **ENTER** button.



4 Press Cursor **▲, ▼** button to select the desired rating level and then press **ENTER** button.

- If you have selected Level 6, you cannot view DVDs with Level 7 or higher.
- The higher the level, the closer the content is to violent or adult material.

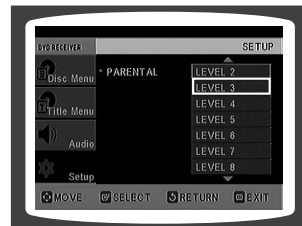

5 Enter the password and then press **ENTER** button.

- The password is set to "7890" by default.
- Once the setup is complete, you will be taken to the previous screen.

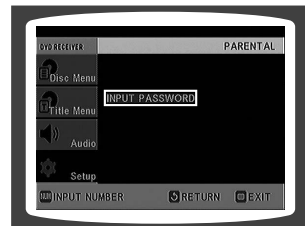

Note

- This function works only if a DVD disc contains the rating level information.

Press **RETURN** button to return to the previous level.

Press **EXIT** button to exit the setup screen.

Setting the Password

You can set the password for the Parental (rating level) setting.

1 Press **MENU** button.



2 Press Cursor **▼** button to move to 'Setup' and then press **ENTER** button.



3 Press Cursor **▼** button to move to 'PASSWORD' and then press **ENTER** button.



4 Press **ENTER** button.

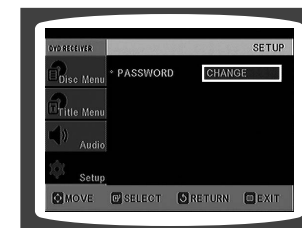

5 Enter the password and then press **ENTER** button.

- Enter the old password, a new password, and confirm new password.
- The setting is complete.

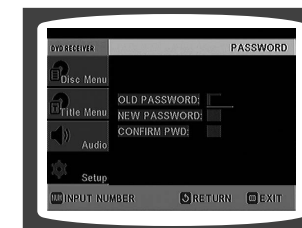

- The password is set to "7890" by default.

Press **RETURN** button to return to the previous level.

Press **CANCEL** button to cancel the error numeric when you inputting password.

Press **EXIT** button to exit the setup screen.



Setting the Wallpaper

JPEG DVD VCD

While watching a DVD, VCD or JPEG CD, you can set the image you like as a wallpaper.

Setting the Wallpaper

1 During playback, press **PLAY/PAUSE** button when the image you like comes up.

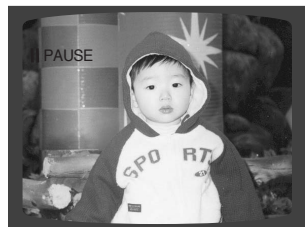

2 Press **LOGO** button.

• **"COPY LOGO DATA"** will be displayed on the TV screen.

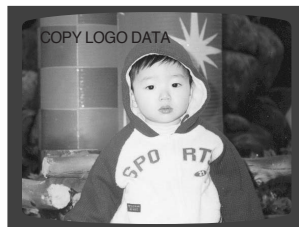

Note

- The selected wallpaper will be displayed.
- You can repeat Steps 1 and 2 to set up to 3 wallpapers.
- The power will turn off and turn on automatically and back on the display mode.

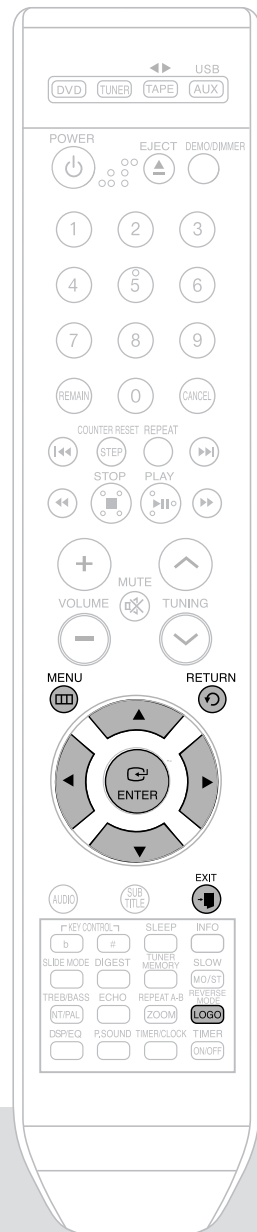

To Change the Wallpaper

1 Press **MENU** button.



2 Press **Cursor** ▼ button to move to 'Setup' and then press **ENTER** button.



3 Press **Cursor** ▼ button to move to 'LOGO' and then press **ENTER** button.



4 Press ▼ to select the desired 'USER', and then press **ENTER**.

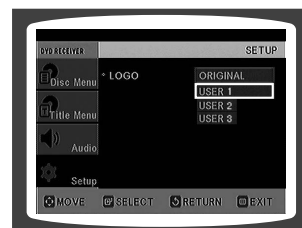

5 Press **EXIT** button to exit the setup screen.



Select this to set the Samsung Logo image as your wallpaper.



Select this to set the desired image as your wallpaper.

Press **RETURN** button to return to the previous level.

Press **EXIT** button to exit the setup screen.

SETUP



Setting the DRC (Dynamic Range Compression)

You can use this function to enjoy Dolby Digital sound when watching movies at low volume at night.



1 Press **MENU** button.



2 Press Cursor **▼** button to move to 'Audio' and then press **ENTER** button.



3 If "DRC" is selected, press **ENTER**.

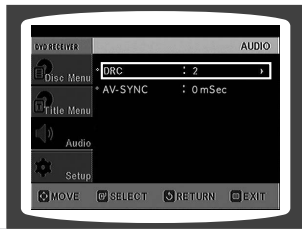

4 Press Cursor **▲, ▼** to adjust the 'DRC'.

• The more times the Cursor **▲** button is pressed, the greater the effect, and the more times Cursor **▼** button is pressed, the smaller the effect.



Press **RETURN** button to return to the previous level.

Press **EXIT** button to exit the setup screen.



AV SYNC Setup

Video may look slower than the audio if it is connected with digital TV. In this case, adjust the delay time of audio to optimal status to fit the video.

1 Press the **MENU** button.

• Setup menu appears.



2 Press Cursor **▲, ▼** buttons to move to 'Audio' and then press **ENTER** button.

• 'Audio' menu appears.



3 Press Cursor **▲, ▼** buttons to move to 'AV-SYNC' and then press **ENTER** button.

• AV-SYNC screen appears.



4 Press Cursor **▲, ▼** buttons to select the Delay Time of AV-SYNC and then press the **ENTER** button.

• You can set the audio delay time between 0 ms and 300 ms. Set it to the optimal status.

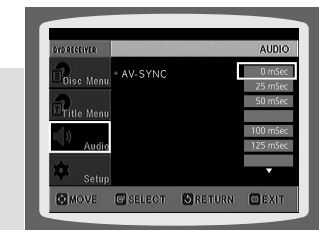

Press **RETURN** button to return to the previous level.

Press **EXIT** button to exit the setup screen.

Listening to Radio

Presetting Stations

You can store up to:

◆ 15 FM stations

Remote Control

- 1 Press the **TUNER** button to select the FM band.
- 2 Tune in to the desired station.
 - Automatic Tuning 1 : When the **◀▶** button is pressed, a preset broadcast station is selected.
 - Automatic Tuning 2 : Press and hold the **↕** button to automatically search for active broadcasting stations.
 - Manual Tuning : Briefly press the **↕** button to increase or decrease the frequency incrementally.

Main Unit

- 1 Press the **FUNCTION** button to select the FM band.
 - 2 Select a broadcast station.
 - Automatic Tuning 1 : Press the **STOP** (■) button to select **<PRESET>** and then press the **◀▶** button to select the preset station.
 - Automatic Tuning 2 : Press the **STOP** (■) button to select **<MANUAL>** and then press and hold the **◀▶** button to automatically search the band.
 - Manual Tuning : Press the **STOP** (■) button to select **<MANUAL>** and then briefly press the **◀▶** button to tune in to a lower or higher frequency.
- Press the **MO/ST** button to listen in Mono/Stereo.
- Each time the button is pressed, the sound switches between **<STEREO>** and **<MONO>**.
 - In a poor reception area, select **MONO** for a clear, interference-free broadcast.

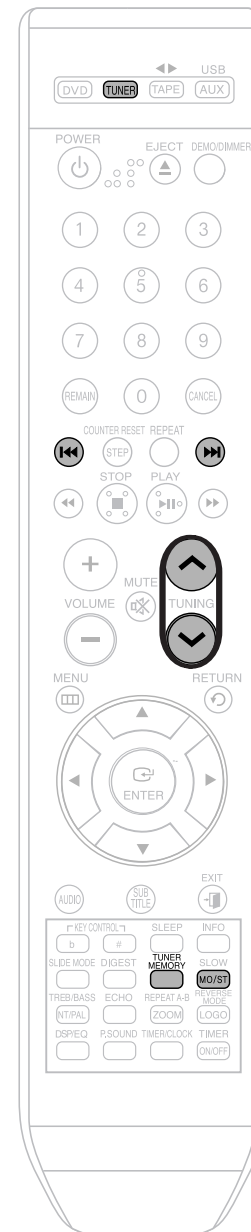
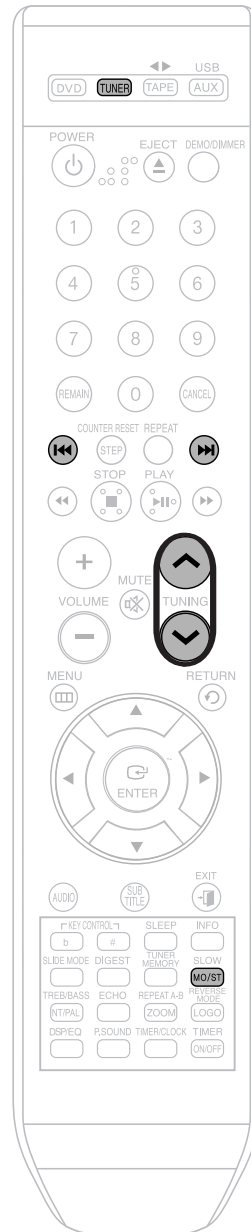

Example : Presetting FM 89.10 in the memory

- 1 Press the **TUNER** button to select the FM band.
- 2 Press the **↕** button to select **<89.10>**.



- 3 Press the **TUNER MEMORY** button.
 - **<PROGRAM>** flashes in the display.



- 4 Press the **◀▶** button to select preset number.
 - You can select between 1 and 15 presets.



- 5 Press the **TUNER MEMORY** button again.
 - Press the **TUNER MEMORY** button before **<PROGRAM>** disappears from the display.
 - **<PROGRAM>** disappears from the display and the station is stored in memory.

- 6 To preset another station, repeat steps 2 to 5.

➤ To tune in to a preset station, press the **◀▶** button on the remote control to select a channel.

✎ • This unit does not receive AM broadcasts.



Listening to a Cassette

Always treat your cassettes with care; refer, if necessary, to the section entitled "Precautions When Using Audio Cassettes" on page 64.

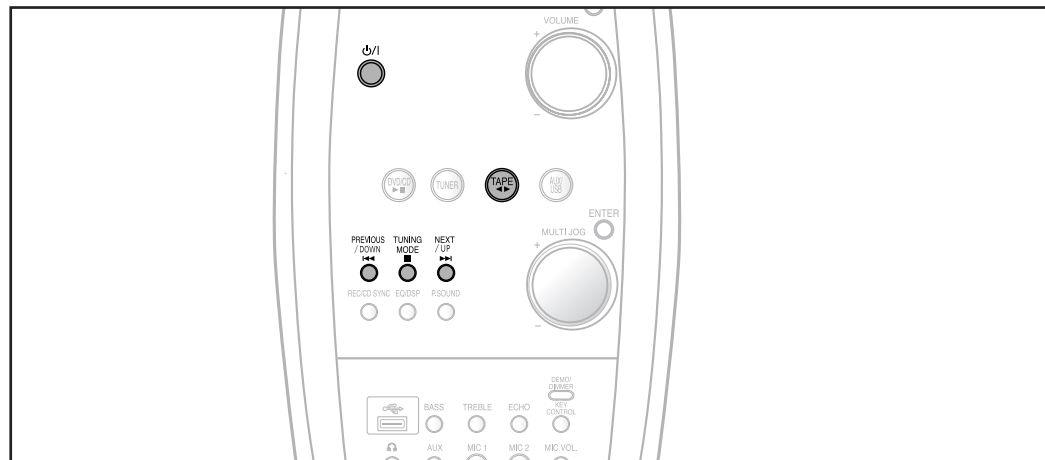

1 Switch the system on by pressing **STANDBY ON**.

2 Press **TAPE** on the player to select the Tape function.

3 Press the **PUSH OPEN** (▲) of the cassette deck to open the cassette door and insert a cassette.

- Insert a cassette with the recording/playback side facing the cassette holder, and then push the cassette door shut.

4 Press the ◀▶ button. The cassette starts playing.

- Side A : Tape (◀▶) button once.
- Side B : Tape (◀▶) button twice

5 Press the ◀◀, ▶▶ button if necessary.

- Rewind the cassette ◀◀ / DOWN button.
- Fast-forward the cassette UP / ▶▶ button.

6 When you have finished playback, press **STOP** button.

Selecting the Cassette Playback Mode

Your mini component system has three cassette playback modes which enable you to listen to both sides of a cassette automatically. .

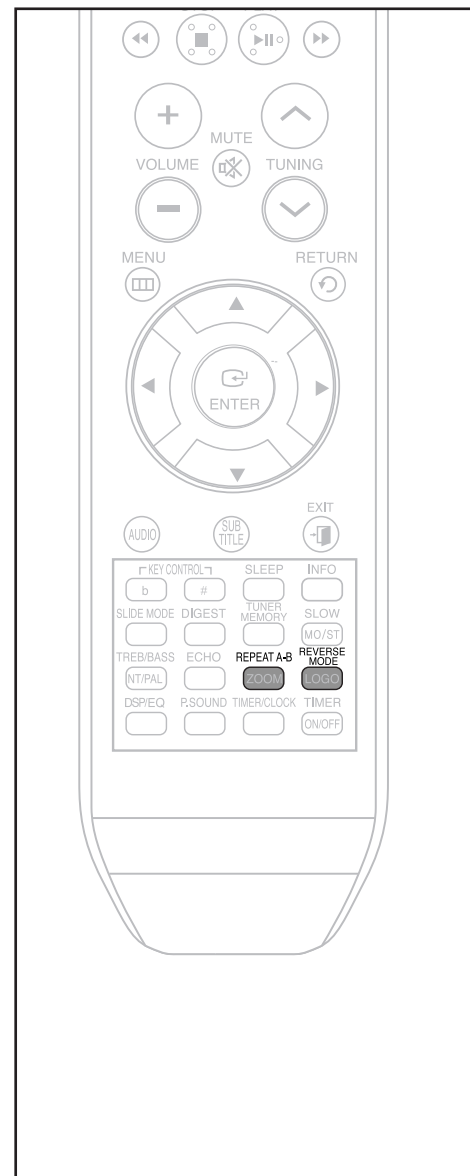

Press **REVERSE MODE** until the appropriate symbol is displayed.

- : One side of the selected cassette and then stops.
- : One side of the cassette. The other side of the cassette and then stops.
- : Both sides of the cassette indefinitely until you press stop.

REPEAT A↔B Function

- Use this to a specific section again during playback.
- Set the start and end points of the section you want to repeat 3 times.
- This is a useful when learning a foreign language.
- The TAPE REPEAT function can be used only on sections that are longer than 7 seconds.

- You cannot set the end point(B) within 7 seconds after setting the start point(A).
- Repeat A-B Function is available for TAPE only.

TAPE DECK



Tape Counter

When playing a cassette in the cassette deck, a counter is displayed to enable you to take note of the counter value at the start of each track to start playback at the beginning of the track to which you wish to listen.

- Before starting to record a cassette for which you wish to take note of the counter values at the beginning of each track, reset the counter by pressing **COUNTER RESET**.

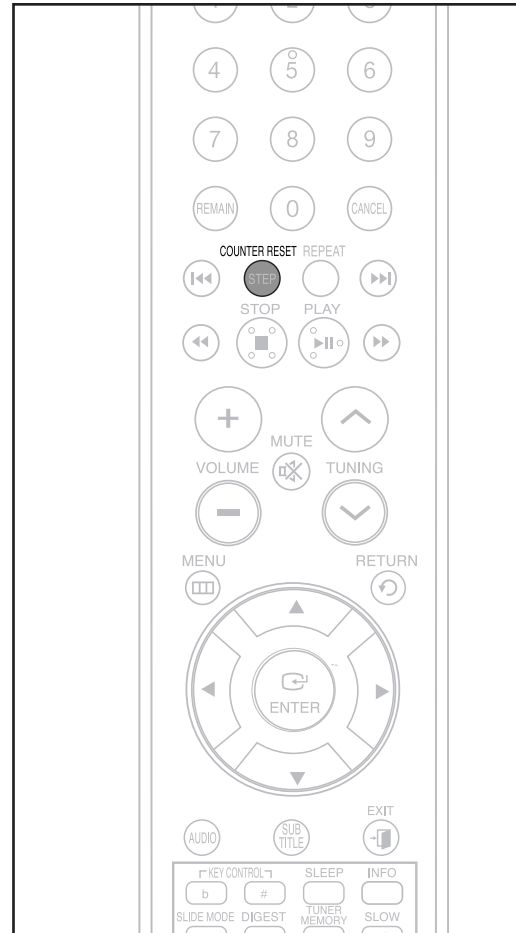

Recording a Compact Disc

You can record a compact disc on a cassette in two different ways:

Synchronised recording

This feature enables you to synchronize the start of the recording with the start of the disc or track of your choice only on Audio CD.

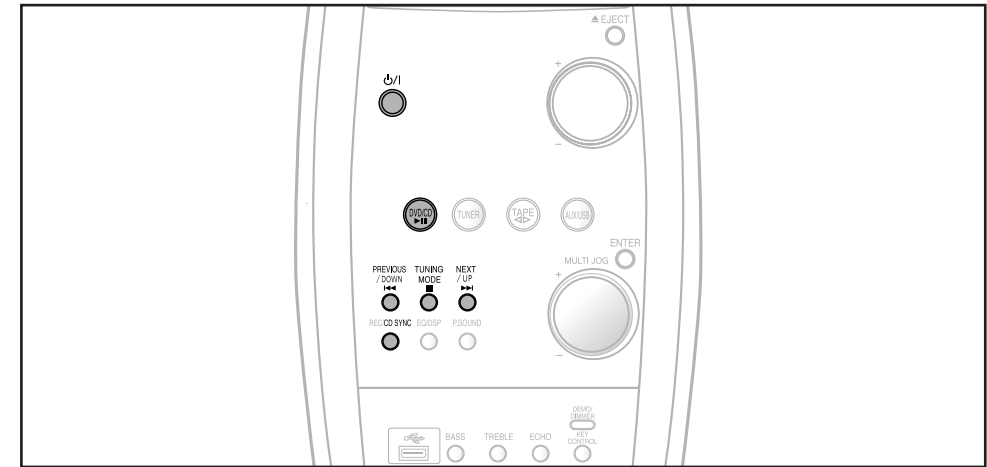

1 Switch the system on by pressing **STANDBY/ON**.

2 Insert a blank cassette in Tape.

3 Load a disc.

- Press the **PUSH OPEN** button () to open the cassette door, insert a cassette, and then close the cassette door.
- Insert the cassette with the safety tabs.

4 Press the **DVD/CD** () button.

- Use the CD selection (,) buttons to select the desired song.

5 Press **CD SYNCHRO** button.

- When stopped, press and hold the button to start the recording from the first piece of music.
- Press and hold **CD SYNCHRO** button during the playback of CD to start the recording from the first part of the music being played.

6 To stop recording, press button.

Note

- You can use **CD/SYNCHRO** button only in CD Playback Mode.

TAPE DECK

Direct recording

The direct recording mode enables you to start recording with any track on the compact disc.

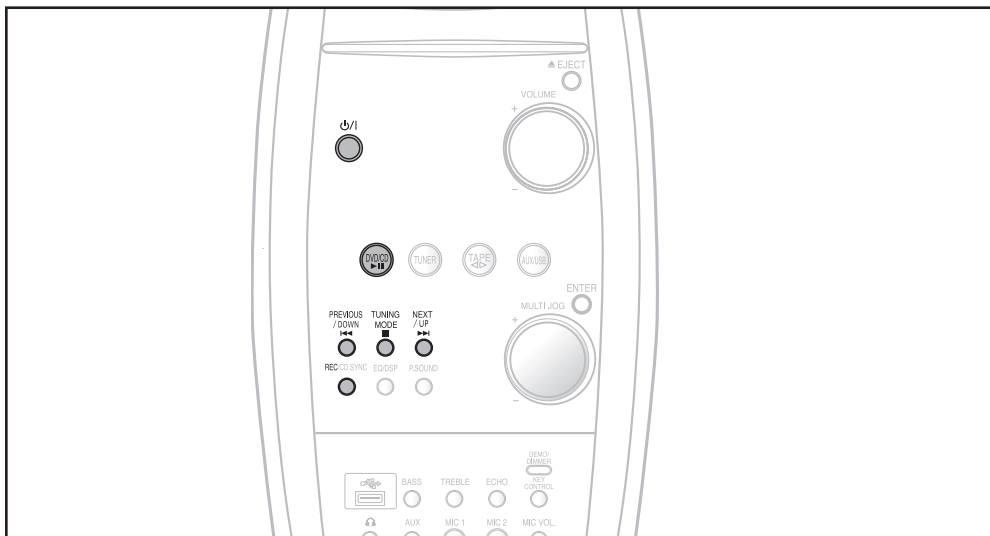

1 Switch the system on by pressing **STANDBY/ON**.

2 Insert a blank cassette in Tape .

- Press the **PUSH OPEN** button (▲) to open the cassette door, insert a cassette, and then close the cassette door.
- Insert the cassette with the safety tabs.

3 Load a disc.

4 Press the **DVD/CD** (▶||) button.

- Use the CD selection (◀◀ ▶▶) buttons to select the desired song.

5 Press **REC** button.

- Recording will begin.
- To stop recording, press ■ button.

Note

- The cassette tape you want to record on must have the safety tabs intact.
- EQ/DSP function is not available when recording.

Recording a Radio Program

You can record a radio program of your choice.
You do not need to adjust the volume, as it has no effect on the recording.

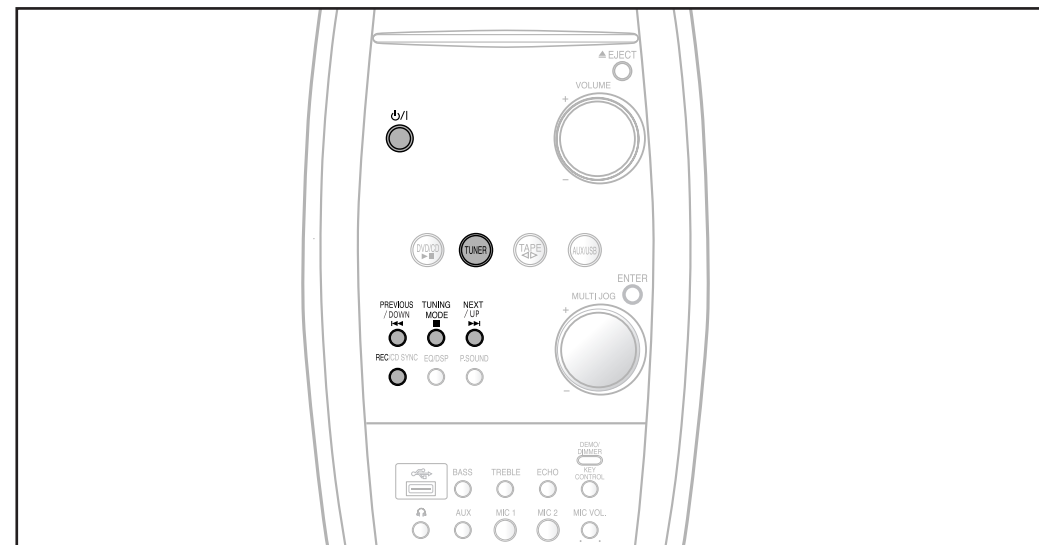

1 Switch the system on by pressing **STANDBY/ON**.

2 Insert a blank cassette in Deck .

3 Select the **TUNER** function by pressing **TUNER**.

4 Select the radio station that you wish to record by pressing ◀◀/DOWN or UP/▶▶ button .

5 Press **(REC/PAUSE)** button.

- **REC** is displayed in red and recording starts.

6 To stop recording, press ■ button.

POWER SOUND and sound field(DSP/EQ) Function

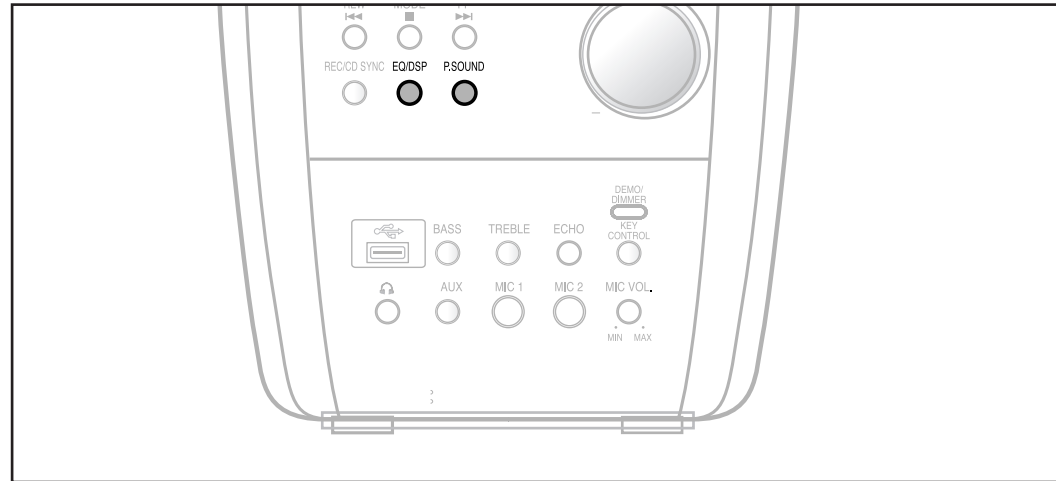

Sleep Timer Function / Mute Function

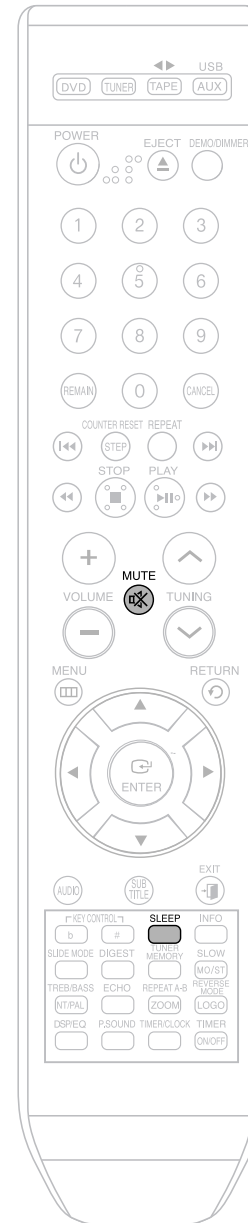

P.SOUND Function

Your mini-compact system is equipped with the function of Power Sound. The function of Power Sound amplifies bass and improves high key or bass twice as much for you to appreciate powerful real sound.

Press the **P.SOUND** button on the front panel.

Result: Press **P.SOUND** button on the front panel. To cancel this function, press **P.SOUND** button again .

Selecting DSP/EQ

Your mini-compact system is equipped with a preset equalizer that allows you to choose the most appropriate balance between treble and bass frequencies, according to the type of music you are listening to.

Turn **DSP/EQ** on the front panel or Press **DSP/EQ** on the remote control until the required option is selected.

To obtain a...	Select...
Normal balance (linear)	PASS
Balance suitable for pop music	POPS
Balance suitable for jazz music	JAZZ
Balance suitable for rock music	ROCK
Balance suitable for studio	STUDIO
Balance suitable for club	CLUB
Balance suitable for hall	HALL
Balance suitable for movie	MOVIE
Balance suitable for church	CHUR CH

Sleep Timer Function

You can set the time that the DVD player will shut itself off.

Press **SLEEP** button.

- Each time the button is pressed, the selection changes as follows: 90 MIN → 60 MIN → 45 MIN → 30 MIN → 15 MIN → OFF.



To confirm the sleep timer setting, press **SLEEP** button.

- The remaining time before the DVD player will shut itself off is displayed.
- Pressing the button again changes the sleep time from what you have set earlier.

To cancel the sleep timer, press **SLEEP** button until OFF appears on the display.

Mute Function

This is useful when answering a doorbell or telephone call.

Press **MUTE** button.

- 'MUTE' appears in the display.
- To turn off mute, press the button again.



DEMO Function / DIMMER Function/ ECO Function



DEMO Function

You can view the various functions available on your system.

Press **DEMO/DIMMER** button.

- The various functions available are listed in turn on the display.
- All these functions are described in detail in this booklet. For instructions on how to use them, refer to the appropriate sections.

ECO Mode Function

You can save the power consumption while the unit is turned off (on standby).

- To activate the ECO mode, Press **POWER** while the unit is turned off (on standby), The display illumination (including the display demonstration) disappears.
- While ECO mode is activated, the display demonstration is canceled temporarily.

DIMMER Function

You can adjust the brightness of the display on the main unit so it won't interfere with your movie viewing.

Press **DEMO/DIMMER** button.

- Each time the button is press, the brightness changes as follows: **DIMMER ON(Dim) → DIMMER OFF(Bright)**.

To cancel this function, press **DEMO/DIMMER** again.

Bass/Treble Level Function

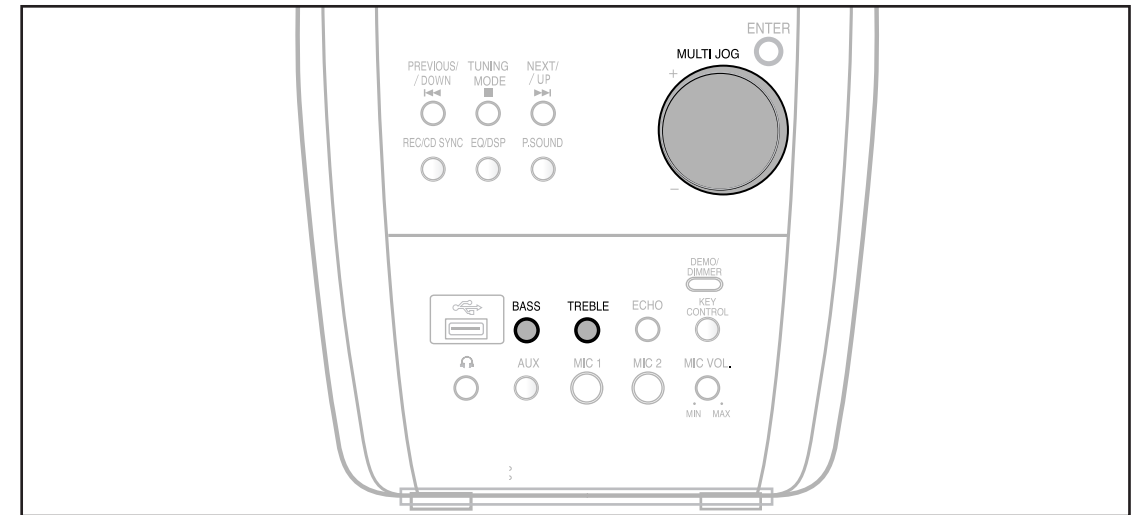

BASS Level Function

BASS function stresses low tones providing thudding sound effects.

1 Press **BASS** button and Turn **MULTI JOG** knob on the front panel to select from **BASS -08** to **BASS +08**, total 9 steps.

2 You can select the level of low tones you desire.

TREBLE Level Function

Treble function stresses high tones providing thudding sound effects.

1 Press **TREBLE** button and Turn **MULTI JOG** knob on the front panel to select from **TRE -08** to **TRE +08**, total 9 steps.

2 You can select the level of high tones you desire.

Connecting Headphones/Microphone(option)

You can connect a set of headphones to your micro component system so that you can listen to music or radio programmers without disturbing other people in the room. The earphones must have a 3.5ø jack or an appropriate adapter.

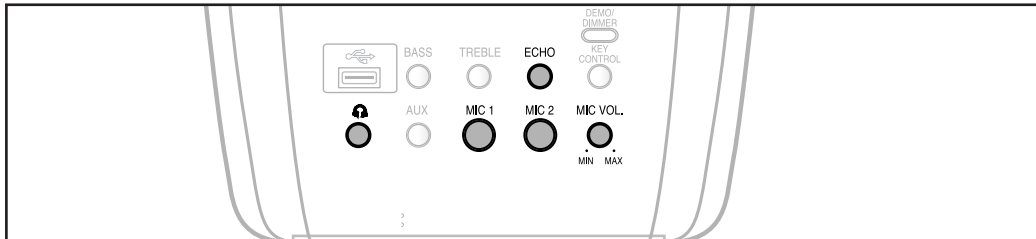

Connect the headphones to the **PHONES** jack on the front panel.

- The loudspeakers are no longer used to output the sound.

Note

- Prolonged use of headphones at a high volume may damage your hearing.
- HDMI AUDIO ON is converted to OFF when connected the headphones.

Plug the microphone with a 6.3ø MIC jack into microphone terminal.

- Connect the Microphone.
- Turn the **MIC LEVEL** knob to adjust the **MIC** level.
- Press the **ECHO** button to select ECHO1, ECHO2, and ECHO OFF.
- During using the microphone, you can press the **REC/PAUSE** button to record your favorite.
- When connected a MIC, HDMI output is not available.

Key Control

You can easily do song search on screen without viewing the song list book.

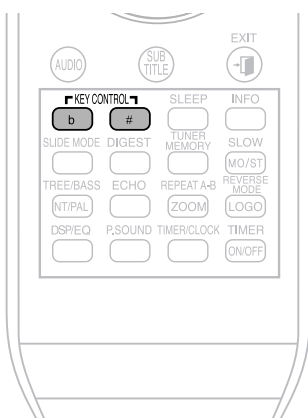

Press the **KEY CONTROL** button to adjust the key to your voice. The (-3~+3)7 steps key control you can select .

Result: Each time the **KEY CONTROL #, b** button is pressed, the following appears on the TV screen:

b : Low-Pitched
: High-Pitched

- Each time **#** button is pressed, the key is increased, and each time **b** button is pressed, the key is decreased .
- The function only can available for CD/VCD in stop mode when microphone is connect, it can not available for DVD and MP3 .
- The function for "key control" can not disappear immediately if you unplugged MIC.
- You can press this button "KEY CONTROL" on the main panel, then use "MULTI JOG CONTROL" or **◀▶** button to complete this operation.
- CD SYNCHRO function is not available when Key Control function is on.

Cautions on Handling and Storing Discs

Small scratches on the disc may reduce sound and picture quality or cause breaks in playback. Be especially careful not to scratch discs when handling them.

Handling discs

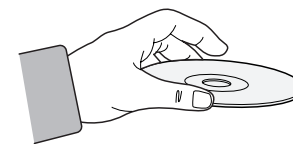

Do not touch the playback side of the disc. Hold the disc by the edges so that fingerprints will not get on the surface. Do not stick paper or tape on the disc.

Handling and Storing Discs

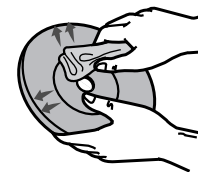

When you get fingerprints or dirt on the disc, clean it with a mild detergent diluted in water and wipe with a soft cloth.

- When cleaning, wipe gently from the inside to the outside of the disc.

Note

- Condensation may form if warm air comes into contact with cold parts inside the player. When condensation forms inside the player, the player may not operate correctly. If this occurs, remove the disc and let the player stand for 1 or 2 hours with the power on.

Precautions When Using Audio Cassettes

- Check that the tape in the cassette is sufficiently taut.
- To prevent erasing a cassette that you wish to keep, remove the safety tab on the upper edge of the cassette. To record a cassette, where the tab has been broken, simply cover the opening with adhesive tape.
- When you have finished playing a cassette, always put it back in its case.
- Store your cassettes in a clean place, out of direct sunlight, where they will not be exposed to high temperatures.
- Avoid using 120-minute cassettes as they place unnecessary strain on the tape mechanism.

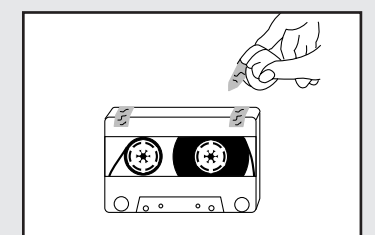
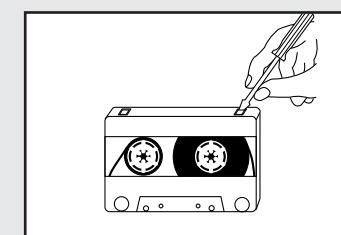
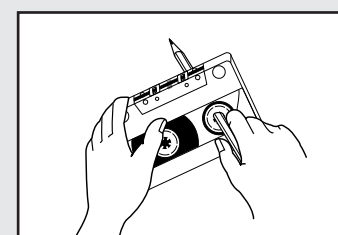



Before Calling for Service

Refer to the chart below when this unit does not function properly. If the problem you are experiencing is not listed below or if the instruction below does not help, turn off the unit, disconnect the power cord, and contact the nearest authorized dealer or Samsung Electronics Service Center.

Symptom	Check/Remedy
i can't eject the disc.	<ul style="list-style-type: none"> • Is the power cord plugged securely into the outlet? • Turn off the power and then turn it back on.
Playback does not start.	<ul style="list-style-type: none"> • Check the region number of the DVD. DVD discs purchased from abroad may not be playable. • CD-ROMs and DVD-ROMs cannot be played on this DVD player. • Make sure that the rating level is correct.
The remote control does not work.	<ul style="list-style-type: none"> • Is the remote control being operated within its operation range of angle and distance? • Are the batteries exhausted?
Playback does not start immediately when the Play/Pause button is pressed.	<ul style="list-style-type: none"> • Are you using a deformed disc or a disc with scratches on the surface? • Wipe the disc clean.
Sound is not produced.	<ul style="list-style-type: none"> • No sound is heard during fast playback, slow playback, and step motion playback. • Are the speakers connected properly? Is the speaker setup correctly customized? • Is the disc severely damaged?
Picture does not appear, sound is not produced, or the disc tray opens 2 to 5 seconds later.	<ul style="list-style-type: none"> • Was the DVD player suddenly moved from a cold place to a warm one? When condensation forms inside the player, remove the disc and let the player stand for 1 or 2 hours with the power on. (You can use the player again after condensation disappears.)
<ul style="list-style-type: none"> • Disc is rotating but no picture is produced. • Picture quality is poor and picture is shaking. 	<ul style="list-style-type: none"> • Is the TV power on? • Are the video cables connected properly? • Is the disc dirty or damaged? • A poorly manufactured disc may not be playable.

Symptom	Check/Remedy
Audio language and subtitles do not work.	<ul style="list-style-type: none"> • Audio language and subtitles will not work for DVDs not containing them. And depending on the disc, they may work differently.
Menu screen does not appear even when the menu function is selected.	<ul style="list-style-type: none"> • Are you using a disc that does not contain menus?
Aspect ratio cannot be changed.	<ul style="list-style-type: none"> • You can play 16:9 DVDs in 16:9 WIDE mode, 4:3 LETTER BOX mode, or 4:3 PAN SCAN mode, but 4:3 DVDs can be seen in 4:3 ratio only. Refer to the DVD disc jacket and then select the appropriate function.
The tape does not start playing	<ul style="list-style-type: none"> • The TAPE function has not been selected. • The cassette has not been inserted correctly. • The cassette player has not been closed. • The tape is either slack or broken.
The volume falls off The cassette is not erased correctly There is excessive wow and flutter	<ul style="list-style-type: none"> • The audio heads are dirty. • The rollers or drive capstans are dirty. • The tape is worn.
Can't receive radio broadcast.	<ul style="list-style-type: none"> • Is the antenna connected properly? • If the antenna's input signal is weak, install an external FM antenna in an area with good reception.
<ul style="list-style-type: none"> • The main unit is not working. (Example: The power goes out or strange noise is heard.) • The DVD player is not working normally. 	<ul style="list-style-type: none"> • Turn off the power and hold the STOP button on the main unit for longer than 5 seconds. <p>Using the RESET function will erase all stored settings. Do not use this unless necessary.</p>
The password for rating level has been forgotten.	<ul style="list-style-type: none"> • While the player is in "NO DISC" mode, hold the main unit's TUNING MODE/■ button for longer than 5 seconds. "INITIAL" appears on the display and all settings will return to the default values. • Press the POWER button. <p>Using the RESET function will erase all stored settings. Do not use this unless necessary.</p>



Specifications

RADIO

FM

Signal/noise ratio	55 dB
Usable sensitivity	10 dB
Total harmonic distortion	0.6 %

COMPACT DISC PLAYER

Capacity	1 disc
Frequency range	20 Hz - 20 KHz (± 1 dB)
Signal/noise ratio	85 dB (at 1 KHz) with filter
Distortion	0.05 % (at 1 KHz)
Channel separation	75 dB
Disc sizes	Diameter: 120 or 80 mm. Thickness: 1.2 mm

TAPE

Frequency range	125 Hz ~ 10 KHz
Signal/noise ratio	40 dB
Channel separation	30 dB
Erasing effect	50 dB(with filter)

AMPLIFIER

Output power	
Front Speaker(4 Ω)	100W/CH RMS,IEC (total harmonic distortion: 10 %)(MAX-DX75/DX76/DX79)
Rear Speaker(4 Ω)	100W/CH RMS,IEC (total harmonic distortion: 10 %)(MAX-DX79 ONLY)
Subwoofer Speaker(3 Ω)	150W/CH RMS,IEC (total harmonic distortion: 10 %)(MAX-DX76/DX79)
Channel separation	40 dB
Signal/noise ratio	75 dB

GENERAL

Power consumption	80W
Dimensions	346(D) x 387 (H) x 192 (W) mm
Weights	5.1Kg

USB Feature Supported Player

Digital Camera

Product	Company	Type
Finepix-A340	Fuji	Digital Camera
Finepix-F810	Fuji	Digital Camera
Finepix-F610	Fuji	Digital Camera
Finepix-f450	Fuji	Digital Camera
Finepix S7000	Fuji	Digital Camera
Finepix A310	Fuji	Digital Camera
KD-310Z	Konica	Digital Camera
Finecam SL300R	Kyocera	Digital Camera
Finecam SL400R	Kyocera	Digital Camera
Finecam S5R	Kyocera	Digital Camera
Finecam Xt	Kyocera	Digital Camera
Dimage-Z1	Minolta	Digital Camera
Dimage Z1	Minolta	Digital Camera
Dimage X21	Minolta	Digital Camera
Coolpix4200	Nikon	Digital Camera
Coolpix4300	Nikon	Digital Camera
Coolpix 2200	Nikon	Digital Camera
Coolpix 3500	Nikon	Digital Camera
Coolpix 3700	Nikon	Digital Camera
Coolpix 4100	Nikon	Digital Camera
Coolpix 5200	Nikon	Digital Camera
Stylus 410 digital	Olympus	Digital Camera
300-digital	Olympus	Digital Camera
U300	Olympus	Digital Camera
X-350	Olympus	Digital Camera
C-760	Olympus	Digital Camera
C-5060	Olympus	Digital Camera
X1	Olympus	Digital Camera
U-mini	Olympus	Digital Camera
Lumix-FZ20	Panasonic	Digital Camera
DMC-FX7GD	Panasonic	Digital Camera
Lumix LC33	Panasonic	Digital Camera
LUMIX DMC-F1	Panasonic	Digital Camera
Optio-S40	Pentax	Digital Camera
Optio-S50	Pentax	Digital Camera
Optio 33LF	Pentax	Digital Camera
Optio MX	Pentax	Digital Camera
Digimax-420	Samsung	Digital Camera
Digimax-400	Samsung	Digital Camera
Sora PDR-T30	Toshiba	Digital Camera
Coolpix 5900	Nikon	Digital Camera
Coolpix S1	Nikon	Digital Camera
Coolpix 7600	Nikon	Digital Camera
DMC-FX7	Panasonic	Digital Camera
Dimage Xt	Minolta	Digital Camera
AZ-1	Olympus	Digital Camera

USB Flash Disc

Product	Company	Type
Cruzer Micro	Sandisk	USB 2.0 USB Flash Drive 128M
Cruzer Mini	Sandisk	USB 2.0 128M
Cruzer Mini	Sandisk	USB 2.0 256M
SONY Micro Vault	Sony	USB 2.0 64MB
FLEX DRIVE	Serotech	USB 2.0 32MB
AnyDrive	A.L tech	USB 2.0 128MB
XTICK	LG	USB 2.0 128M
Micro Mini	lomega	USB 2.0 128M
iFlash	Imation	USB 2.0 64M
LG	XTICK(M)	USB 2.0 64M
RiDATA	EZDrive	USB 2.0 64M

MP3 Player



Product	Company	Type
Creative MuVo NX128M	Creative	128 MB MP3 Player
Iriver H320	Iriver	20G HDD MP3 Player
YH-920	Samsung	20G HDD MP3 Player
YP-T7	Samsung	MP3 Player
YP-MT6	Samsung	MP3 Player
YP-T6	Samsung	MP3 Player
YP-53	Samsung	MP3 Player
YP-ST5	Samsung	MP3 Player
YP-T5	Samsung	MP3 Player
YP-60	Samsung	MP3 Player
YP-780	Samsung	MP3 Player
YP-35	Samsung	MP3 Player
YP-55	Samsung	MP3 Player
iAUDIO U2	Cowon	MP3 Player
iAUDIO G3	Cowon	MP3 Player
iAudio M3	Cowon	HDD MP3 Player
SI-M500L	Sharp	256MB MP3 Player
H10	Iriver	MP3 Player
YP-T5 VB	Samsung	MP3 Player
YP-53	Samsung	256MB MP3 Player

USB External HDD

Product	Company	Type
MOMOBAY UX-2	Dvico	USB 2.0



Notes on Terminology

ANGLE	Recorded onto some DVD discs are scenes which have been simultaneously shot from a number of different angles (the same scene is shot from the front, from the left, from the right, etc.). With such discs, the Angle button can be used to change the angle of view for specific scenes.
CHAPTER NUMBER	These numbers are recorded on DVD discs. A Title is subdivided into many sections, each of which is numbered, and specific parts of the video can be searched quickly using these numbers.
DVD	A high-density optical disc on which high-quality pictures and sound have been recorded by means of digital signals. Incorporating a new video compression technology (MPEG-2) and high-density recording technology, a DVD disc comprises two 0.6 mm thick discs bonded together.
PCM	An acronym for Pulse Code Modulation - another name for digital audio.
PBC (PLAYBACK CONTROL)	This is recorded on a video CD (version 2.0). Selected scenes or information can be chosen from the menu displayed on the TV monitor.
REGION NUMBER	Both the DVD player and DVD discs are encoded with a region number. If the region number on the DVD disc does not correspond to the region number of the DVD player, the player cannot play the disc.
SUBTITLES	Translated appearing at the bottom of the screen. A DVD disc can contain up to 32 subtitle languages.
TITLE NUMBER	These numbers are recorded on DVD discs. When a disc contains two or more movies, these movies are numbered as Title 1, Title 2, etc.
TRACK NUMBER	These numbers are assigned to the tracks which are recorded on video and audio CDs. They enable specific tracks to be located quickly.
VIDEO CD	Contains recordings of pictures and sound whose quality is roughly comparable to that of video tape. This player also supports video CDs with playback control (version 2.0).
	5.1 (or 6) Channel Digital Surround sound reproduced from DVDs and LDs recorded as a digital signals (with  disc marking). With better sound quality, dynamic range, and directionality than traditional Dolby surround technology, you can enjoy dynamic, realistic sound.

Contact SAMSUNG WORLD WIDE

If you have any questions or comments relating to Samsung products, please contact the SAMSUNG customer care centre.

Si tiene preguntas o comentarios sobre productos Samsung, contacte con el centro de atención al cliente de SAMSUNG.

Region	Country	Customer Care Center	Web Site
North America	CANADA	1-800-SAMSUNG (7267864)	www.samsung.com/ca
	MEXICO	01-800-SAMSUNG (7267864)	www.samsung.com/mx
	U.S.A	1-800-SAMSUNG (7267864)	www.samsung.com
Latin America	ARGENTINE	0800-333-3733	www.samsung.com/ar
	BRAZIL	0800-124-421 4004-0000	www.samsung.com/br
	CHILE	800-726-7864 (SAMSUNG)	www.samsung.com/cl
	COSTA RICA	0-800-507-7267	www.samsung.com/latin
	ECUADOR	1-800-10-7267	www.samsung.com/latin
	EL SALVADOR	800-6225	www.samsung.com/latin
	GUATEMALA	1-800-299-0013	www.samsung.com/latin
	JAMAICA	1-800-234-7267	www.samsung.com/latin
	PANAMA	800-7267	www.samsung.com/latin
	PUERTO RICO	1-800-682-3180	www.samsung.com/latin
	REP. DOMINICA	1-800-751-2676	www.samsung.com/latin
	TRINIDAD & TOBAGO	1-800-7267-864	www.samsung.com/latin
VENEZUELA	0-800-100-5303	www.samsung.com/latin	
COLOMBIA	01-8000112112	www.samsung.com.co	
Europe	BELGIUM	02 201 2418	www.samsung.com/be
	CZECH REPUBLIC	844 000 844 Distributor pro Českou republiku : Samsung Zrt., česká organizační složka Vyskočilova 4, 14000 Praha 4	www.samsung.com/cz
	DENMARK	70 70 19 70	www.samsung.com/dk
	FINLAND	030-6227 515	www.samsung.com/fi
	FRANCE	3260 SAMSUNG or 08 25 08 65 65 (€ 0,15/Min)	www.samsung.com/fr
	GERMANY	01805 - 121213 (€ 0,14/Min)	www.samsung.de
	HUNGARY	06-80-SAMSUNG (7267864)	www.samsung.com/hu
	ITALIA	800-SAMSUNG (7267864)	www.samsung.com/it
	LUXEMBURG	0032 (0)2 201 24 18	www.samsung.lu
	NETHERLANDS	0900 20 200 88 (€ 0,10/Min)	www.samsung.com/nl
	NORWAY	815-56 480	www.samsung.com/no
	POLAND	0 801 801 881	www.samsung.com/pl
	PORTUGAL	80 8 200 128	www.samsung.com/pt
	SLOVAKIA	0800-SAMSUNG (726786)	www.samsung.com/sk
	SPAIN	902 10 11 30	www.samsung.com/es
	SWEDEN	0771-400 200	www.samsung.com/se
	U.K	0870 SAMSUNG (7267864)	www.samsung.com/uk
	Republic of Ireland	0818 717 100	www.samsung.com/uk
	Switzerland	0800-7267864	www.samsung.com/ch
	CIS	RUSSIA	8-800-200-0400
KAZAHSTAN		8-800-080-1188	www.samsung.kz
UZBEKISTAN		8-800-120-0400	www.samsung.uz
UKRAINE		8-800-502-0000	www.samsung.com/ur
LITHUANIA		8-800-77777	www.samsung.lt
LATVIA		800-7267	www.samsung.com/lv/index.htm
ESTONIA		800-7267	www.samsung.ee
Asia Pacific		AUSTRALIA	1300 362 603
	CHINA	800-810-5858, 010-6475 1880	www.samsung.com.cn
	HONG KONG	3698 - 4698	www.samsung.com/hk
	INDIA	3030 8282 1800 110011	www.samsung.com/in
	INDONESIA	0800-112-8888	www.samsung.com/id
	JAPAN	0120-327-527	www.samsung.com/jp
	MALAYSIA	1800-88-9999	www.samsung.com/my
	PHILIPPINES	1800-10-SAMSUNG (7267864)	www.samsung.com/ph
	SINGAPORE	1800-SAMSUNG (7267864)	www.samsung.com/sg
	THAILAND	1800-29-3232 02-689-3232	www.samsung.com/th
	TAIWAN	0800-329-999	www.samsung.com/tw
	VIETNAM	1 800 588 889	www.samsung.com/vn
Middle East & Africa	SOUTH AFRICA	0860 7267864 (SAMSUNG)	www.samsung.com/za
	U.A.E	800SAMSUNG (7267864) 8000-4726	www.samsung.com/mea

Free Manuals Download Website

<http://myh66.com>

<http://usermanuals.us>

<http://www.somanuals.com>

<http://www.4manuals.cc>

<http://www.manual-lib.com>

<http://www.404manual.com>

<http://www.luxmanual.com>

<http://aubethermostatmanual.com>

Golf course search by state

<http://golfingnear.com>

Email search by domain

<http://emailbydomain.com>

Auto manuals search

<http://auto.somanuals.com>

TV manuals search

<http://tv.somanuals.com>