

*Sunbeam*

# Express Kettle

## Instruction Booklet

This book covers the use and care of the following Sunbeam Kettles:

KE2100 Express – Corded Automatic Kettle

KE4400 Express Filter – Cordless Automatic Kettle

Please read these instructions carefully  
and retain for future reference.



# Contents

<b>Sunbeam's Safety Precautions</b>	<b>2</b>
<b>Features of your Express Kettle</b>	<b>4</b>
<b>Using your Express Kettle</b>	<b>8</b>
<b>Sunbeam's 3-Way Safety System</b>	<b>9</b>
<b>Care and Cleaning of your Express Kettle</b>	<b>10</b>

تأكد من تفهيم احتياطات السلامة المذكورة اعلاه

請務必理解上述的安全預防措施。

Assurez-vous que les précautions ci-dessus relatives à la sécurité sont bien comprises

Versichern Sie sich daß die obenstehenden Sicherheitsmaßnahmen Verstanden werden

Βεβαιώνετε πως οι παραπάνω προφυλάξεις ασφαλείας γίνονται κατανοητές

Pastikan bahwa tindakan-tindakan keselamatan seperti di atas dimengerti anda

Accertatevi che le suddette norme di sicurezza siano comprese a dovere

上記の注意事項をよくお読みになり、安全を御確認ください

Уверете се дека погоре споменатите мерки на претпазливост се добро разбрани

Asegúrese de que las precauciones de seguridad precedentes sean bien comprendidas

کاری بکنید کہ احتیاطهای بالا حتماً درک بشوند

ต้องแน่ใจว่า ข้อควรระวังเรื่องความปลอดภัยข้างต้น เป็นที่เข้าใจกันดี

Yukarda belirtilen güvenliik önlemlerinin anlaşılığından emin olunuz

Xin kiểm chắc rằng những biện pháp làm an toàn kể trên được hiểu rõ

# Sunbeam's Safety Precautions

## SAFETY PRECAUTIONS FOR YOUR KETTLE.

- Boiling water will scald. Do not leave a boiling or hot kettle near or where children may touch it.
- Boiling water maybe ejected, if overfilled.
- Do not leave the power cord near the edge of a bench top where children may touch or pull it.
- Do not move kettle while switched on.
- Always switch the power off and unplug the cord while the kettle is NOT in use.
- Do not operate the kettle without water.
- Do not operate the kettle unless the element is fully immersed in water or filled to the minimum level indicated.
- NOTE: If the kettle is overfilled and tilted backwards, water may leak from the control area. This is normal for this kettle design, and will not damage the kettle in any way.
- Your Express kettle must only be used with the Power Base supplied.
- Always operate the kettle on a flat, level surface.

Important instructions – retain for future use.

If you have any concerns regarding the performance and use of your appliance, please visit [www.sunbeam.com.au](http://www.sunbeam.com.au) or contact the Sunbeam Consumer Service Line. Ensure the above safety precautions are understood.

# Sunbeam's Safety Precautions

**Sunbeam are very safety conscious when designing and manufacturing consumer products, but it is essential that the product user also exercise care when using an electrical appliance. Listed below are precautions which are essential for the safe use of an electrical appliance:**

- Read carefully and save all the instructions provided with an appliance.
- Always turn the power off at the power outlet before you insert or remove a plug. Remove by grasping the plug - do not pull on the cord.
- Turn the power off and remove the plug when the appliance is not in use and before cleaning.
- Do not use your appliance with an extension cord unless this cord has been checked and tested by a qualified technician or service person.
- Always use your appliance from a power outlet of the voltage (A.C. only) marked on the appliance.
- Close supervision is necessary when your appliance is being used near children or infirm persons.
- Never leave an appliance unattended while in use.
- Young children should be supervised to ensure that they do not play with the appliance.
- Do not use an appliance for any purpose other than its intended use.
- Do not place an appliance on or near a hot gas flame, electric element or on a heated oven. Do not place on top of any other appliance.
- Do not let the power cord of an appliance hang over the edge of a table or bench top or touch any hot surface.
- For safety reasons and to avoid maintenance by unskilled persons, some appliances are 'sealed' using tamperproof screws. Such appliances should always be returned to the nearest Sunbeam Appointed Service Centre for adjustment or repair if required.
- Do not operate any electrical appliance with a damaged cord or after the appliance has been dropped or damaged in any manner. If damage is suspected, return the appliance to the nearest Sunbeam Appointed Service Centre for examination, repair or adjustment.
- For additional protection, Sunbeam recommend the use of a residual current device (RCD) with a tripping current not exceeding 30mA in the electrical circuit supplying power to your appliances.
- Do not immerse the appliance in water or any other liquid unless recommended.

# Features of your Express Kettle – KE2100

---

## 1.8 litre capacity.

For up to 10 cups of water.

---

## Robust one-piece design.

Safe, fully enclosed one-piece design. Minimises spillage if the kettle is dropped as there is no lid to pop open.

---

## Full length water gauge.

Indicates the amount of water in the kettle.

---

## 2400 watt element.

The fast boil 2400 watt element boils 2 cups of water in approximately one minute.

---

## 3-Way Safety System.

- 1 - Automatically switches the kettle off after boiling.
- 2 - Cuts out for boil-dry protection.
- 3 - Shuts down in case of overheating.

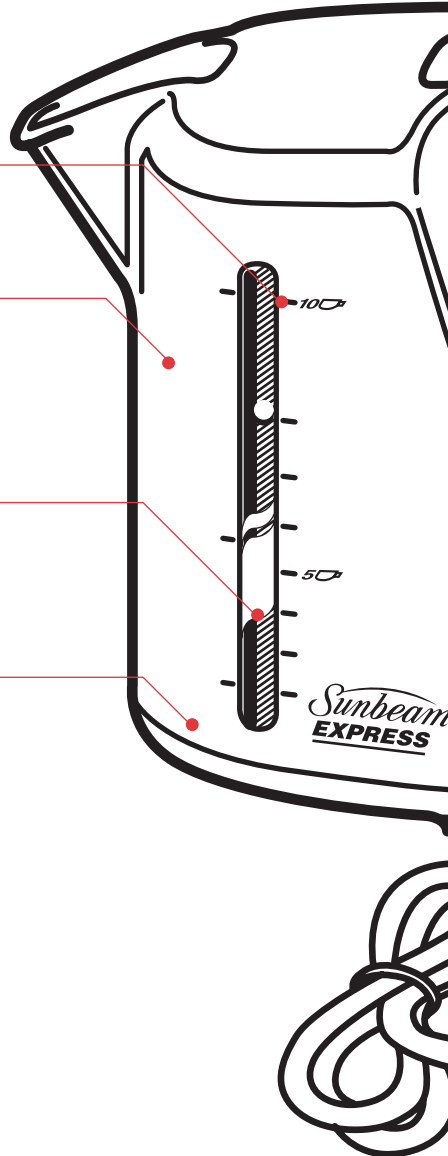

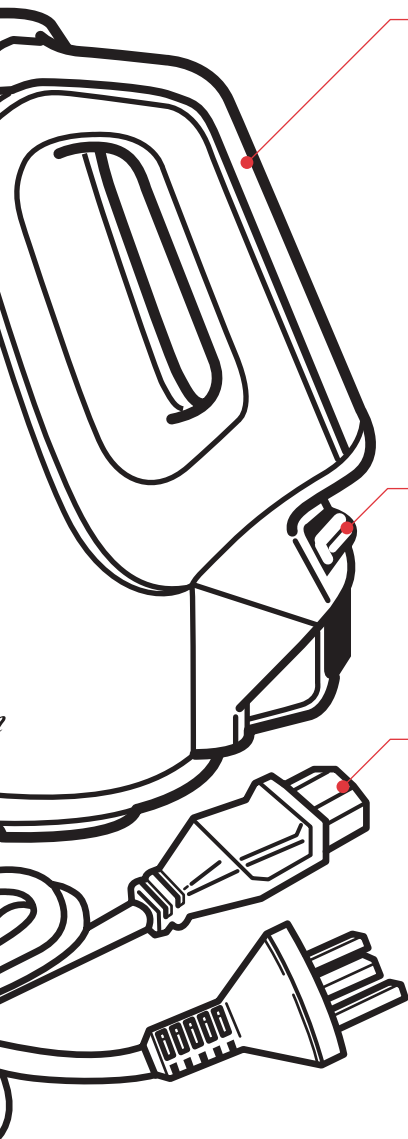

**Ergonomic.**

The handle provides greater pouring balance and prevents steam burns when pouring.

**On/Off switch with auto cut-out.**

Automatically switches the kettle off after boiling.

**Removable cord.**

Makes the kettle easy to fill at the sink and easy to pour.

# Features of your Express Filter Kettle – KE4400

## **Robust one-piece design.**

Safe, fully enclosed one-piece design. Minimises spillage if the kettle is dropped as there is no lid to pop open.

## **Removable mesh filter.**

Eliminates water scale deposits for cleaner water.

## **1.8 litre capacity.**

For up to 10 cups of water.

## **Full length water gauge.**

Indicates the amount of water in the kettle.

## **2400 watt element.**

The fast boil 2400 watt element boils 2 cups of water in approximately one minute.

## **3-Way Safety System.**

- 1 - Automatically switches the kettle off after boiling.
- 2 - Cuts out for boil-dry protection.
- 3 - Shuts down in case of overheating.

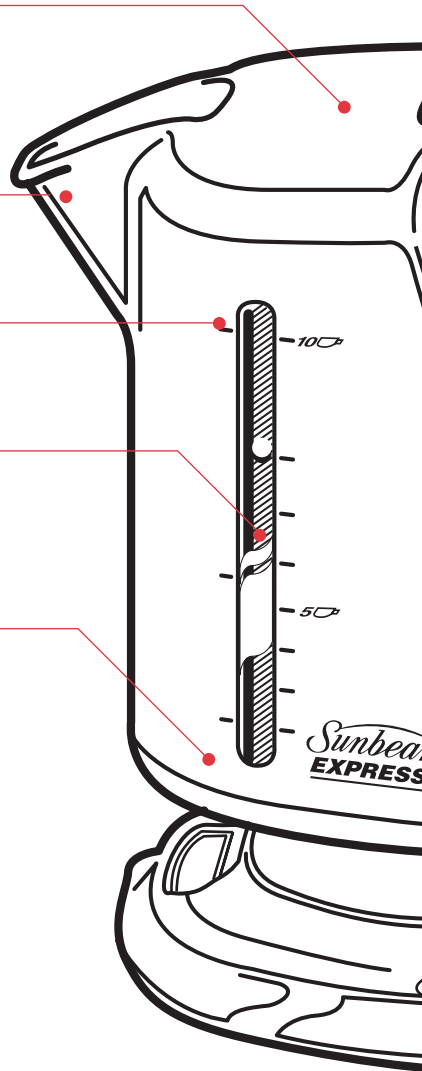

**3 cord exits**

**Cord storage cavity**

Cord winds neatly under the base for safe, convenient storage.

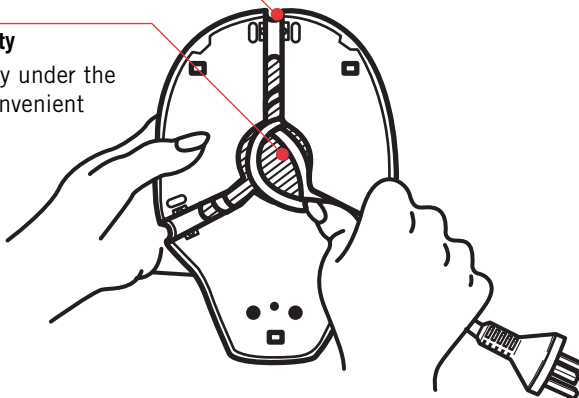

**Ergonomic.**

The handle provides greater pouring balance and prevents steam burns when pouring.

**On/Off boil switch with auto cut-out.**

Automatically switches the kettle off after boiling.

**Power base.**

Cordless for greater convenience. The power base also features a cord storage cavity underneath and 3 cord exits.

**Rubber feet.**

Non-slip rubber feet.

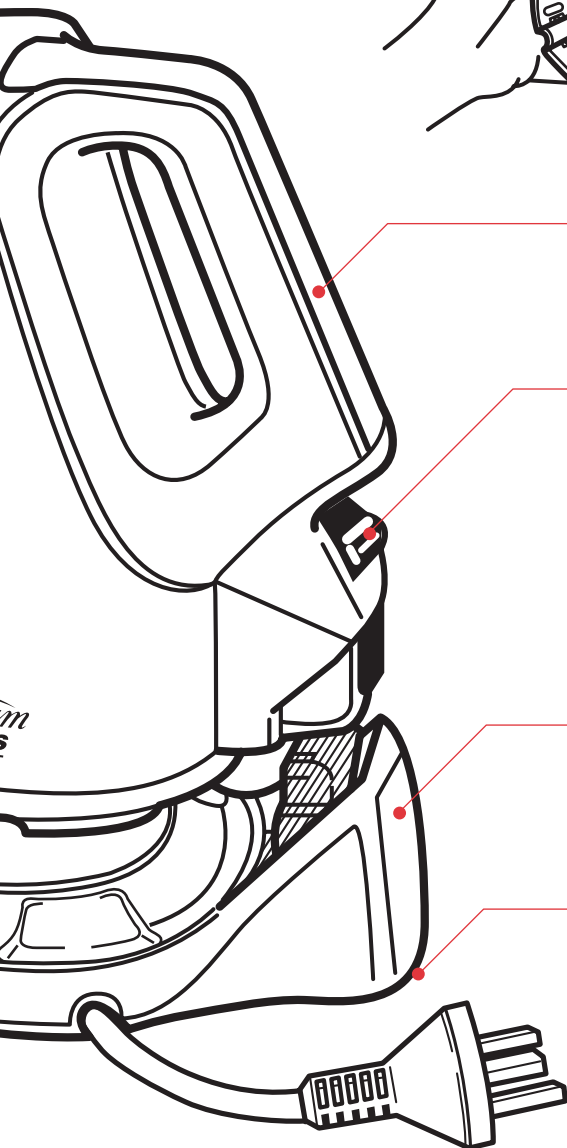



# Using your Express Kettle

## **Before using your kettle.**

It is recommended that you clean your kettle before use by boiling a full kettle of water then discarding the water.

## **Using your kettle**

1. To fill the kettle, remove it from the power base and fill with the desired amount of water.  
Always fill the kettle between the minimum and maximum marks. Too little water will result in the kettle switching off before the water has boiled. Too much water may cause it to spill out of the spout when boiling.
2. Connect the plug into a 230-240 Volt AC power outlet. Turn the power ON.
3. Position the kettle on the power base. Press the ON/OFF button. The kettle will switch off automatically once the water has boiled.  
**NOTE:** Ensure that the ON/OFF switch is clear of obstructions. The kettle will not turn off if the switch is constrained. Do not remove the (KE4400) from the power base while in use.

4. Lift the kettle from the power base and pour the water.

**NOTE:** Use caution when pouring the water from your kettle, as boiling water will scald.

5. The kettle may be stored on the power base when not in use. The kettle will not re-boil until the ON/OFF switch is pressed downward.

**NOTE:** Ensure the power is turned OFF at the power outlet while the kettle is not in use.

Should you accidentally allow the kettle to operate without water, the boil-dry protection will automatically switch it off. If this should occur, allow the kettle to cool before filling with cold water and re-boiling.

## **Cord Storage Facility**

Excess cord can be stored by feeding the cord into the storage cavity underneath the power base.

# Sunbeam's 3 Way Safety System



Safety is a major consideration in the design of a Sunbeam kettle. This is why we have developed our 3-Way Safety System, which ensures that your kettle will:

## **1. Automatically switch off after boiling.**

For convenience, safety and energy efficiency, your Sunbeam kettle features an auto cut-out device.

## **2. Cut-out for boil-dry protection.**

If the kettle is operated without water, it will automatically cut-out, preventing any damage to the element.

## **3. Shut-down in case of overheating.**

In the event of overheating, the kettle will automatically shut down to prevent further damage. Should this occur, take your kettle to a Sunbeam Service Centre or Appointed Service Agent.

# Care and Cleaning

Always remove the plug from the power outlet before cleaning.

Never immerse the kettle switch area or cord in water, or allow moisture to come into contact with these parts.

## **Removal of mineral deposits.**

Mineral deposits in tap water may cause the kettle interior to discolour. To remove this build-up, use Sunbeam Liquid Descaler, a simple to use, non-toxic cleaner available from Sunbeam Appointed Service Centres.

## **Alternatively:**

1. Fill the kettle with 3 cups of white vinegar and the remainder with water and allow to stand overnight. DO NOT BOIL.

2. Empty the solution from the kettle. Any stains remaining inside the spout can be removed by rubbing with a damp cloth. Fill the kettle with clean water, bring to boil and then discard the water. Repeat and the kettle will then be ready to use.

The outside of the kettle can be wiped over with a damp cloth.

**CAUTION: Do not use chemical, steel wool, or abrasive cleaners to clean the outside of the kettle.**



## Consumer Hotline

Australia

1800 025 059

New Zealand

(09) 912 0747

Consumer information:

1800 025 059 or [www.sunbeam.com.au](http://www.sunbeam.com.au)

 is a registered Trademark of Sunbeam Corporation Limited. ACN 000 006 771.

© Sunbeam Corporation Limited 2003.

## Free Manuals Download Website

<http://myh66.com>

<http://usermanuals.us>

<http://www.somanuals.com>

<http://www.4manuals.cc>

<http://www.manual-lib.com>

<http://www.404manual.com>

<http://www.luxmanual.com>

<http://aubethermostatmanual.com>

Golf course search by state

<http://golfingnear.com>

Email search by domain

<http://emailbydomain.com>

Auto manuals search

<http://auto.somanuals.com>

TV manuals search

<http://tv.somanuals.com>