



STVG-700

**SEMI-PRO COMPACT DISC + GRAPHICS
WITH BUILT-IN TV KARAOKE CENTER**



OWNER'S MANUAL

Please read before using this unit.

The Singing Machine™ is a registered trademark of The Singing Machine Co., Inc.

WARNINGS

WARNING: TO REDUCE THE RISK OF FIRE OR SHOCK HAZARD, DO NOT EXPOSE THIS PRODUCT TO RAIN OR MOISTURE.

	CAUTION RISK OF ELECTRIC SHOCK DO NOT OPEN	
CAUTION: TO PREVENT THE RISK OF ELECTRIC SHOCK, DO NOT REMOVE COVER OR BACK. NO USER-SERVICEABLE PARTS INSIDE. REFER SERVICING TO QUALIFIED PERSONNEL.		

 This symbol is intended to alert you to the presence of uninsulated dangerous voltage within the product's enclosure that might be of sufficient magnitude to constitute a risk of electric shock. Do not open the product's case.

 This symbol is intended to inform you that important operating and maintenance instructions are included in the literature accompanying this product.

This CD player is made and tested to meet exacting safety standards. It meets FCC requirements and complies with safety performance standards of the U.S. Department of Health and Human Services.

Warnings:

- This CD player employs a laser light beam. Only a qualified service person should remove the cover or attempt to service this device, due to possible eye injury.
- The use of controls, adjustments, or procedures other than those specified herein might result in hazardous radiation exposure.

CAUTION

This compact disc player is classified as a CLASS 1 LASER product. The CLASS 1 LASER PRODUCT label is located on the rear panel.



CAUTION!

Invisible laser radiation when open and interlocks defeated. Avoid exposure to beam.

IMPORTANT SAFETY INSTRUCTIONS

Careful attention is devoted to quality standards in the manufacture of your recorder, and safety is a major factor in its design. However, safety is also your responsibility. This section lists important information that will help you properly use and enjoy your recorder and accessories. **Read all the included safety and operating instructions before using your recorder.** Follow them closely, and retain them for future reference.

Heed Warnings - Follow all warnings on the product and in the operating instructions.

Cleaning - Unplug this product from the wall outlet before cleaning. Use only a damp cloth for cleaning. Do not use liquid or aerosol cleaners.

Attachments - Do not use attachments/accessories not recommended by the product manufacturer, as they might create a hazard.

Water and Moisture - Do not use this product near water (for example, near a bathtub, washbowl, kitchen sink, or laundry tub; in a wet basement; or near a swimming pool).

Accessories - Do not place this product on an unstable cart, stand, tripod, bracket, or table. The product may fall, causing serious injury to a child or adult, and serious damage to the product. Use only with a cart, stand, tripod, bracket, or table recommended by the manufacturer or sold with the product. Follow the manufacturer's instructions for mounting, and use a recommended mounting accessory.



Carts - Move the product on a cart carefully. Quick stops, excessive force, and uneven surfaces may cause the product/cart to overturn.

Ventilation - Slots and openings in the cabinet provide ventilation, ensure reliable operation, and protect from overheating. Do not block or cover these openings, and do not place the product on a bed, sofa, rug, or other similar surface. Do not place the product in a built-in installation such as a bookcase or rack unless it provides proper ventilation as specified by the manufacturer.

Power Sources - Operate this product using only the power source indicated on its marking label. If you are not sure of your home's power type, consult your product dealer or local power company.

Polarization - This product is equipped with a polarized AC line plug (a plug having one blade wider than the other). This plug will fit in the power outlet only one way. This is a safety feature. If you cannot insert the plug fully into the outlet, try reversing the plug. If the plug still doesn't fit, contact your electrician to replace your obsolete outlet. Do not defeat the safety purpose of the polarized plug. If you need an extension, use a polarized cord.

Power-Cord Protection - Route power-supply cords so they are not likely to be walked on or pinched by items placed on or against them, paying particular attention to cords at plugs, convenience receptacles, and the point where they exit from the product.

Lightning - For added protection for this product during a lightning storm, or when it is left unattended and unused for long periods of time, unplug it from the wall outlet and disconnect the antenna or cable system. This will prevent damage to the product due to lightning and power-line surges.

Overloading - Do not overload wall outlets, extension cords, or integral convenience receptacles, as this can result in a risk of fire or electric shock.

Objects and Liquids - Never push objects of any kind into this product through openings, as they may touch dangerous voltage points or short out parts that could result in a fire or electric shock. Never spill liquid of any kind on the product.

Servicing - Do not attempt to service this product yourself, as opening or removing covers may expose you to dangerous voltage or other hazards. Refer all servicing to qualified service personnel.

Damage Requiring Service - Unplug this product from the wall outlet and refer servicing to qualified service personnel under the following conditions:

- When the power-supply cord or plug is damaged.
- If liquid has been spilled or objects have fallen into the product.
- If the product has been exposed to rain or water.
- If the product does not operate normally by following the operating instructions. Adjust only those controls that are covered by the operating instructions, as an improper adjustment of other controls may result in damage and will often require extensive work by a qualified technician to restore the product to normal operation.
- If the product has been dropped or damaged in any way.
- When the product exhibits a distinct change in performance.

Replacement Parts - When replacement parts are required, be sure the service technician uses replacement parts specified by the manufacturer or having the same characteristics as the original part. Unauthorized substitutions may result in fire, electric shock, or other hazards.

Safety Check - Upon completion of service or repairs to this product, ask the service technician to perform safety checks to determine that the product is in proper operating condition.

Wall or Ceiling Mount - The product should be mounted to a wall or ceiling only as recommended by the manufacturer.

Heat - The product should be situated away from heat sources such as radiators, heat registers, stoves, or other products (including amplifiers) that produce heat.

Power Lines - Locate an outdoor antenna away from power lines.

Nonuse Periods - Unplug the product's power cord when you will not use it for extended periods.

Outdoor Antenna Grounding - If an outside antenna or cable system is connected to the product, ground the antenna or cable system so as to provide some protection against voltage surges and built-up static charges. Article 810 of the National Electrical Code, ANSI/NFPA 70, provides information about proper grounding of the mast and supporting structure, grounding of the lead-in wire to an antenna discharge unit, size of grounding conductors, location of antenna-discharge unit, connection to grounding electrodes, and requirements for the grounding electrode. See the example below.

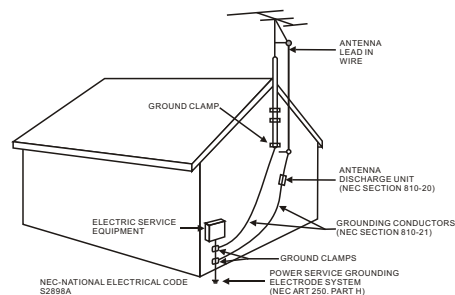

The Singing Machine Karaoke Glossary of Terms

In addition to all of the terminology associated with consumer electronics products, a few additional terms are used almost exclusively in karaoke. These terms are meant to familiarize you with the world of Karaoke. The features listed below may not necessarily pertain to the particular model Singing Machine that you have. Following are some brief explanations:

Echo:

Echo adds depth and resonance to a singer's voice, without affecting the music. This echo is produced by creating minor controlled feedback in the singer's voice.

Multiplex:

A multiplex tape is really three recordings on one tape. Side A, has a stereo recording of songs without the lead singer. Side B has two mono recordings. The right channel has a mono recording, which allows you to sing a duet with the lead singer. The left channel has a mono recording of the same music, without the lead singer. Multiplex control allows the singer to gradually go from left channel to right channel, thereby gradually fading out the vocal.

Auto Voice Control (AVC):

When the AVC function is activated, the vocals on a multiplex recording are eliminated as soon as the singer begins singing into the microphone. When the singer stops singing, the vocals on the multiplex recording are automatically re-activated. This useful function is used primarily during practice sessions while a singer is learning a song. Please note that the AVC function only works with multiplex recordings and not with standard audio recordings.

Pitch Control:

This function controls pitch of music by controlling the speed at which a cassette tape plays back. By increasing the speed of the tape, the music sounds higher (sharp). By slowing the tape speed, the music sounds lower (flat).

Key Controller:

Key Controller changes the key of the music (+ or - steps) to adjust to the singer's voice.

CDG:

This is an acronym for Compact Disc plus Graphics. You will also see variations CD+G and CD+Graphics. This is regular CD with information stored on a data track simultaneous to music. In laymen's terms, CDG has a video output for simple graphics (not full motion video). In the case of karaoke, the graphics function is used to store song lyrics, and display the lyrics in synch with music. In most cases, CDG software displays lyrics which change color as they are to be sung. A regular television is all that is required to display CDG lyrics.

INTRODUCTION

Your STVG-700 AM/FM Radio, TV Receiver, Semi-Pro Compact Disc + Graphics Karaoke System will provide you with many years of fun and entertainment. It can let you be the "star" as you sing along with your favorite recordings and hear your voice with the music through the system's speakers.

This Karaoke System is made up of compact designs and full of features, yet it is easy to use. Just a few simple instructions and you will become an expert.

Before you use your unit, please glance through this Manual to familiarize yourself with all the features available and the sections of the manual that describe their operation. Next go to the section for the specific operation you wish to perform.

For your easy reference, listed here are some of the main features of this Karaoke Center:

Lyrics on TV screen - displays the lyrics with the tempo of music when playing CD+G discs.

Automatic Voice Control - lets you replace the original singer's voice with your own voice when any prerecorded multiplex karaoke disc or tape is played. To activate, just rotate Mic Volume to a comfortable listening level, and Auto Voice Control for the best balance between playback and microphone levels.

Balance Control - lets you adjust the balance between the prerecorded original singer's voice and the music if you use a multiplex karaoke tape or disc.

Echo Control - lets you add an echo to enrich your voice for a concert hall effect.

Multiple Karaoke music center - it plays audio Compact Discs, CD+Graphics discs and Cassette tapes in its cassette deck.

Built-In Speaker - lets you share the music with your family or friends.

Auxiliary Output Jacks - let you connect another audio output component, such as an equalizer / booster or a PA system.

CONTROL LOCATIONS

- | | |
|---------------------------------------|--------------------------------|
| 1. Rod Antenna Holder | 24. STOP/EJECT Button |
| 2. LO VHF/HI VHF/UHF TV Band Selector | 25. PAUSE Button |
| 3. TV/OFF/RADIO Selector | 26. Rod Antenna |
| 4. STOP Button | 27. MASTER Volume Control |
| 5. SKIP▶▶▶ Button | 28. TV/RADIO Tuning Knob |
| 6. PLAY/PAUSE Button | 29. FUNCTION Selector |
| 7. SKIP◀◀◀ Button | 30. OPEN/CLOSE Button |
| 8. Handle | 31. PROGRAM LED Indicator |
| 9. POWER ON/OFF Switch LED Indicator | 32. BALANCE Volume Control |
| 10. POWER ON/OFF Switch | 33. TONE Control |
| 11. INTRO Button | 34. PITCH Control |
| 12. PROGRAM Button | 35. A.V.C. Control |
| 13. REPEAT Button | 36. REPEAT LED Indicator |
| 14. MIC Volume Control | 37. TRACK Indicator |
| 15. ECHO Volume Control | 38. VIDEO INPUT/OUTPUT Jacks |
| 16. MIC Holder | 39. AUX OUTPUT Socket (L & R) |
| 17. MIC Jacks | 40. AUX INPUT Socket (L & R) |
| 18. PLAY/PAUSE LED Indicator | 41. BRIGHTNESS Control |
| 19. CDG LED Indicator | 42. CONTRAST Control |
| 20. RECORD Button | 43. VERTICAL HOLD Control |
| 21. PLAY Button | 44. AV/TV Function Push Switch |
| 22. REWIND Button | 45. External Antenna Socket |
| 23. FAST FORWARD Button | 46. AC POWER Cord |

CONTROL LOCATIONS

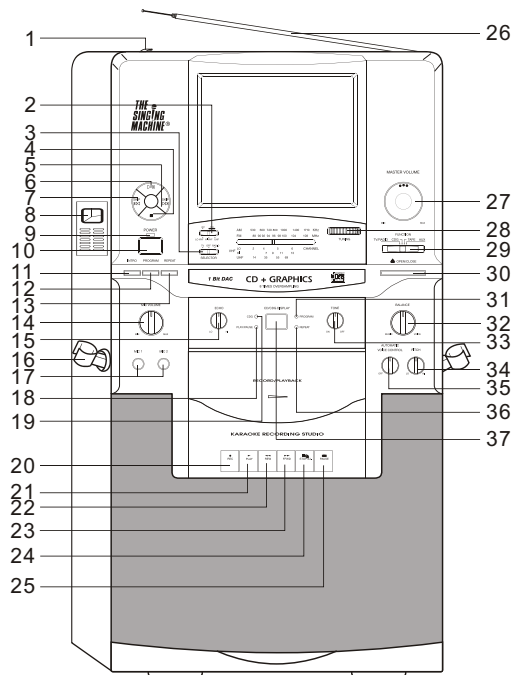

(Fig.1)

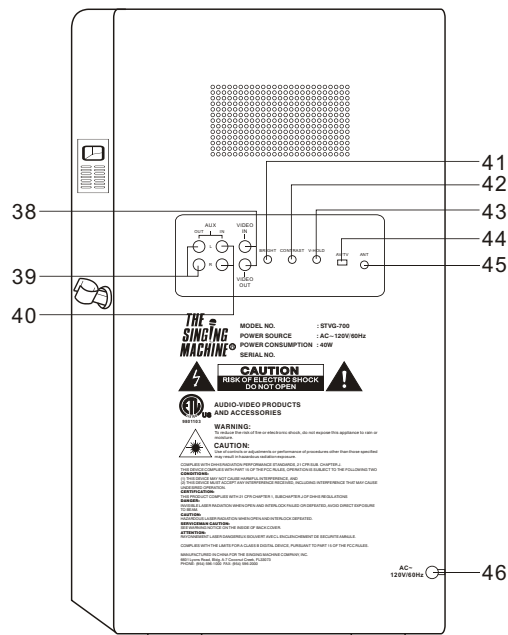

(Fig.2)

MAKING THE CONNECTIONS

CONNECTING POWER

You can power the system from a standard AC outlet by using supplied powercord.

Caution: The supplied AC powercord, has a polarized plug that fits into the wall outlet only one way. If the plug does not fit properly, turn it over and try again. Do not force it.

CONNECTION TO TV SET

For song lyrics from CDG to appear on the TV screen you must connect the included video cable (yellow colored RCA single-plug) to the Video Output jack on the back of your STVG-700 unit. Then connect the other end of the video plug (yellow) to the Video Input jack of the television. If your television does not have the required Video Input, you will need an RF Modulator (Radio Frequency Modulator), which connects through your TV antenna or cableline and serves as Video Input. You must change your VCR or TV's source selection to Aux In or Video(x) when connecting your karaoke machine to a Aux In or Video(x) input. Your VCR or TV documentation will explain how to change the input source selection.

CONNECTING AN AUDIO SOURCE FOR INPUT

To connect another audio source (such as a Tuner, an A/V Receiver or a VCR) so you can sing along with its music, simply connect the Audio Output jacks (Red & White TSA jacks) to the system's AUX IN R & L jacks.

ANTENNA CONNECTION

1. ROD ANTENNA (75 OHM)

In a normal reception area, the built-in ROD antenna will deliver a sharp clear picture.

When operation, extend it's length and adjust it's direct & angle for the clearest picture.

2. External antenna adaptor (PAD)

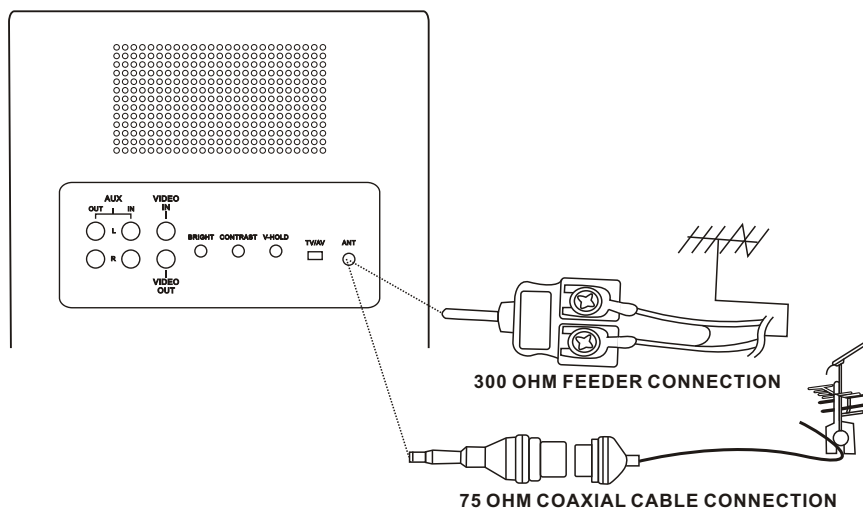

CD OR CD+G OPERATION

PREPARATION

- This unit is designed to play CD's bearing the identification logo. If CD's do not conform to the CD standard, they may not play properly.
- Fingerprints and dust should be carefully wiped off with a soft cloth. Wipe in a straight motion from the center to the outside of the disc.
- Never use chemicals, such as record cleaning sprays, anti-static sprays or fluids, benzene or thinner to clean compact disc. These chemicals will permanently damage the plastic surface of the disc.
- Always place the compact disc on the disc tray with the label facing upward. Compact discs can be played on only one side.
- To remove a disc from its storage case, press down the center of the case and lift the disc out, holding it carefully by the edges.
- Disc should be returned to their cases after use, protect them from dust and scratches.
- To prevent warping the disc, do not expose it to direct sunlight, high humidity or high temperatures for extended periods of time.
- Do not apply paper or write anything on either side of the disc. The inks used in some felt-tips pens, may damage the surfaces of the disc.

PLAYING CD OR CD+G DISC

Reminders:

- Do not press the disc tray of the CD compartment while it's moving.
- Never place anything except a compact disc on the disc tray. Foreign objects can damage the unit.
- Do not apply excessive force to disc cover.
- Always place one disc to the disc tray at a time.

TURNING POWER ON/OFF

To turn on the Karaoke system, press the POWER switch button. The red LED POWER indicator will light up. To turn off the system, press POWER switch button again, the POWER indicator will turn off.

FUNCTION SELECT

Set the FUNCTION-SELECT switch to CDG position, and set the selection (TV /OFF/RADIO) switch to TV (or OFF) position. Don't set to the RADIO position.

LOADING A DISC

Press the ▲ OPEN/CLOSE button to open CD/CDG compartment tray. Close CD/CDG compartment tray by pressing this key again.

PLAY/PAUSE Mode

To start playing, press PLAY/PAUSE button, the first track [1] and the PLAY/PAUSE LED Indicator will be displayed. (If a CD+G disc is detected, the CDG Red LED indicator will also on).

To temporarily stop playing, press the PLAY/PAUSE button, the PLAY/PAUSE LED indicator will flash.

STOP Mode

If STOP button is pressed in the course of playing, the disc will cease to play. (The total track number will be shown on the LED window).

SKIP PLAY (For both CD and CDG discs)

During STOP mode, you can skip up or down to your desired track number by pressing a SKIP button (◀◀-SKIP-▶▶).

CD OR CD+G OPERATION

SEARCH (For CD disc only)

When playing any CD disc, you press and hold the SKIP button (◀◀-SKIP-▶▶), the system will search at high speed in the forward or reverse direction. By releasing the button, normal play will continue.

REPEAT PLAY

- To repeat the track currently playing, press the REPEAT button once, the REPEAT LED indicator will flash, then activate the PLAY/PAUSE button.
- To repeat all tracks, press the REPEAT button twice, the REPEAT LED indicator will light up. Press the PLAY/PAUSE button to begin.
- To clear the repeat function. Press the REPEAT button again, the REPEAT LED indicator will turn off.

PROGRAM PLAY

- Use this PROGRAM key to program and play back songs in a pre-selected order.
- Programming should be done in the STOP mode only. Press the PROGRAM key until its PROGRAM LED indicator flashes, number [0] will also display. Then press SKIP keys (◀◀-SKIP-▶▶) to select a desired track and press PROGRAM key to confirm entry. You can repeat the same steps up to a maximum of 19 tracks.
- To clear all the programmed memories, press STOP button.

INTRO PLAY

- If you wish to play the first 10 seconds of each track, depress INTRO key to activate.
- Press INTRO key again during INTRO-play mode can resume normal play of the remaining track in the disc.

TV OPERATIONS

TURNING POWER ON/OFF

To turn on the Karaoke TV/RADIO system by pressing the POWER switch button. To turn off the system, press POWER switch button again, the POWER indicator will turn off.

1. Press the POWER switch to ON.
2. Select the FUNCTION switch (29) to TV/RADIO position. (Fig.1)
3. Select the TV/OFF/RADIO switch to TV position.
4. Select the TV/AV switch (44) to TV position at the back of system. (Fig.2)
5. Pull out the directional antenna or plug the external antenna socket by connecting with aerial cable for best signal.
6. Select your desired channel by using TV channel selector (LOVHF/Hi VHF/UHF switch)(2) and tune up the Tuning knob (28). (Fig.1)
7. Adjust music volume (27) to your pleasure. (Fig.1)

CASSETTE OPERATION

Loading and Unloading Cassettes

Follow these steps to load and unload

1. Press STOP/EJECT button.
2. Insert cassette with desired side facing you, tape surface down. Avoid touching tape.
3. Close cassette holder/tape deck cover.

To ensure firm locking of cassette holder/tape covers, please press the cassette door(s) at the centre point (or the rightmost positions) until a 'click' sound is heard.

Note: To unload, press STOP/EJECT button, remove cassette and close cover.

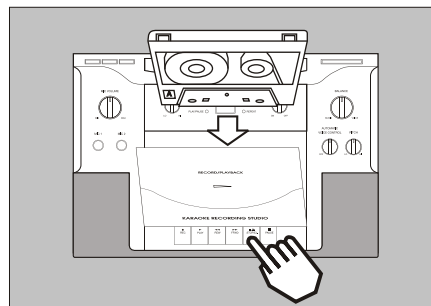

PLAYBACK

1. Turn on POWER (1).
2. Load cassette into the cassette compartment.
3. Depress PLAY button (2).
4. Adjust MASTER VOLUME (4), and BALANCE (6) controls to your pleasure.
5. To stop tape, press STOP/EJECT button (3) on that Deck once. (Press a second time to eject the tape.) Or, when the tape reaches its end, that deck will automatically stop and its PLAY button will be released.

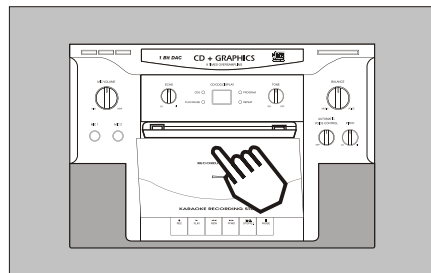

AM/FM RADIO

1. Turn on POWER (1).
2. Switch function selector (11) to TV/RADIO position.
3. Switch TV/RADIO function selector (12) to radio position.
4. Switch BAND selector (13) to either AM or FM radio position.
5. For FM reception, use directional antenna on back of unit (14) for best signal. (AM antenna is built-in).
6. Turn Tuning knob (15) to select desired station as indicated on dial.
7. Adjust MASTER VOLUME (4) to your pleasure.
8. To turn the radio off, set Function selector (11) to CDG/TAPE/AUX position.

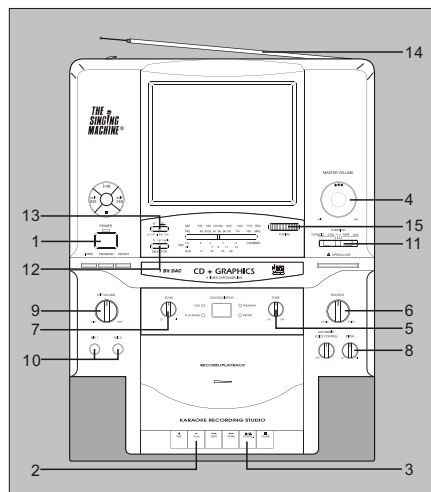

TV BROADCASTING RECEPTION

1. Turn on POWER (1).
2. Switch Function selector (11) to TV/RADIO position.
3. Switch TV/RADIO Function selector (12) to TV position.
4. Switch TV/AV Function selector (44) to TV position. (Fig.2)

CASSETTE OPERATION

5. Turn Tuning knob (15) to select desired TV channel with HI-VHF/LOW-VHF/UHF channel selector (13).
6. For the best signal, connect the unit to an aerial antenna using the external antenna jack or use the directional antenna on the back of the unit (14).
7. Adjust BRIGHTNESS (41), CONTRAST (42) and Vertical HOLD (43) volume to have the best picture quality. (Fig.2)
8. Adjust MASTER VOLUME (4) to your pleasure.
9. To turn the TV off, set Function selector (11) to TAPE/AUX position.

MICROPHONES/ECHO/TONE

1. When either or both Microphone are plugged into the Microphone jacks (10), their output is mixed with the playback from Radio/TV/Cassette tapes/CD/CDG discs.
2. Adjust MIC VOLUME (9) for best balance between playback and microphone levels.
3. Adjust ECHO (7) to add depth and richness to vocals, and TONE (5) as desired.

SING ALONG - TAPE

1. Follow instructions for PLAYBACK.
2. Follow instructions for MICROPHONES/ECHO/TONE.
3. Adjust MASTER VOLUME, ECHO and TONE controls. Your voice will be combined with the playback output and will be heard through the loudspeakers.

SING ALONG - RADIO

1. Follow operating instructions for AM/FM radio.
2. Follow operating instructions for Microphones/ECHO/TONE.
3. Adjust MASTER VOLUME, MIC VOLUME, ECHO and TONE controls. Your voice will be combined with the radio station output and will be heard through the loudspeakers.

SING ALONG WITH A VIDEO CASSETTE

Follow these steps to sing along with a video cassette.

1. Connect a stereo VCR's Left and Right audio output (AUX OUT) to the system's AUX IN jacks (40). (Fig.2)
2. Connect a VCR's Video Out to the system's VIDEO IN jack (38). (Fig.2)
3. Switch the TV/AV selector (44) to AV position. (Fig.2)
4. Switch the function selector (11) to AUX position.
5. Turn the POWER switch (1) ON.
6. Plug in the microphone(s) into either of the MIC jacks.
7. Load the Video Cassette and then start playback.
8. Follow instructions for MICROPHONES/ECHO/TONE.
9. Adjust MASTER VOLUME, ECHO and TONE controls. Your voice will be combined with the playback output and will be heard through the loudspeaker.
10. With Singing Machine or similar multiplex cassettes, you can sing duets along with the recorded artist and background music. Or by turning the Balance control, you can eliminate the vocal track and do a solo performance with the background music.

SING ALONG - TV BROADCASTING

1. Follow operating instructions for TV broadcasting.
2. Follow operating instructions for Microphone/ECHO/TONE.
3. Adjust MASTER VOLUME, MIC VOLUME, ECHO and TONE controls. Your voice will be combined with the TV broadcasting channel output and will be heard through the loudspeakers.

RECORDING SING ALONG - RADIO

1. Load a blank cassette.
2. Follow instructions for Sing Along-Radio, including adjusting volume, ECHO, TONE and Tape controls.
3. Press both RECORD and PLAY buttons of Cassette Deck at the same time. The combined output of your voice and radio station output will be recorded on the blank tape in Cassette Deck.

CASSETTE OPERATION

Note: If you want to record a radio broadcast without Sing Along, load a blank tape into Cassette Deck. Unplug the microphone.

RECORDING SING ALONG - TV BROADCASTING

1. Follow operating instructions for TV broadcasting.
2. Follow instructions for Sing Along-TV Broadcasting, including adjusting Volume, ECHO, TONE TV controls.
3. Load a blank cassette.
4. Press both RECORD and PLAY buttons of Cassette Deck at the same time. The combined output of your voice and the playback of TV broadcasting will be recorded on the blank tape in Cassette Deck.

Note: If you want to record a TV broadcast without Sing Along, load a blank tape in Cassette Deck. Unplug the microphone.

PUBLIC ADDRESS - Using a Microphone

The STVG-700 can be used as a PA (Public Address System), you can sing along with PRE-RECORDED TAPE, CD or auxiliary input from a music component.

Public Address (PA) Operation Procedures

1. Connect the supplied Microphone to either one of the MIC input sockets.
2. Press the POWER switch to turn the unit On.
3. Press the FUNCTION select to TAPE. Move the MIC VOLUME control to central position.
4. Move the ON/OFF switch located on the Microphone to ON position and speak or Sing to the Microphone. The Microphone sensitivity and loudness could be adjusted as required by turning the MIC VOLUME control and/or MASTER VOLUME control.
5. To add depth or ambiance to your voice, adjust the ECHO control until the desired effect is obtained.

NOTE: To prevent feedback or whistling from occurring, please be sure that the microphone is not too close to the STVG-700 unit.

CARE AND MAINTENANCE

POWER SWITCH

After using the STVG-700, turn off the power by pressing the power switch.

CLEANING THE UNIT

To clean the unit, simply wipe with a soft clean cloth moistened with plain lukewarm water.

CLEANING TAPE HEAD

When the tape is running, magnetic tape residue, powder and dust naturally accumulate on the tape deck heads, capstan and pinch roller, when they become too dirty, you will find:

- * Sound quality deteriorates.
 - * The output sound level drops.
 - * The previous recording is not completely erased.
 - * Recording is not performed satisfactorily.
- Therefore, for continued high performance from the cassette section, periodically clean the heads, pinch rollers and capstans whenever an accumulation of dust and red-brown oxide particles is noticed. To do this, open the cassette holder. Remove any cassettes still in the cassette compartments. Carefully rub each head (4,5,8), pinch roller (3,7) and capstan (2,6) with a cotton swab (1) moistened with isopropyl alcohol or special head-cleaning fluid.

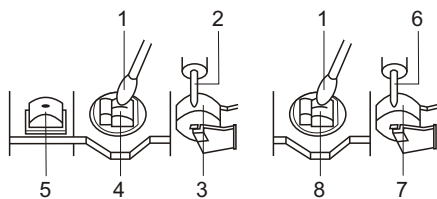

Proprietary tape head cleaners are available from most HI-FI retail outlets.

CASSETTE DECK CARE

Use a clean soft cloth moistened with plain lukewarm water and wrung dry. Never use benzol, benzene or other strong chemical cleaners since these could damage the finish or your unit. It is important that no liquid reaches the inside of the unit.

NOTE

- * Screwdriver and other metal objects should never be allowed to come in contact with tape heads. These will scratch the sensitive surface causing damage to your tapes.
- * Magnets or magnetized objects should not be placed near tape heads.



To prevent fire or shock hazard, disconnect your stereo system from the AC power plug when cleaning.

COMPACT DISC

Handling Disc

Although the music tracks in the disc are covered with a protective layer, it is still advisable to treat the disc carefully. Ensure that you always pick up discs by the edge, and put them back in their holders immediately after use.

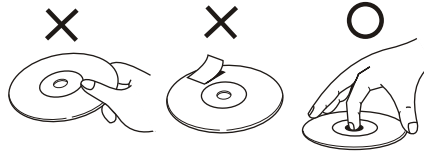

CLEANING DISC

Cleaning will not normally be necessary. However, should fingerprints, dust or dirt appear, you can wipe them off with a soft, lint-free cloth. Wipe the disc in a straight line from centre to edge. You can moisten the disc first if necessary.



NOTE: Do not use the detergent or abrasive cleaning agents, for they can damage the disc.

CD PLAYER

The player mechanism is fitted with self-lubricating bearing and must not be oiled or greased.

TROUBLE SHOOTING GUIDE

If you have followed the instructions and are having difficulty operating the unit, locate the PROBLEM in the left column below. Check the corresponding POSSIBLE CAUSE column to locate and remedy the problem.

PROBLEM	POSSIBLE CAUSE	SOLUTION
No power when POWER is on.	No power plug connection at the AC outlet.	Insert the power plug into the AC outlet.
No sound.	Volume control is set to minimum.	Turn up the volume.
	The wrong function is selected.	Select the correct function.
CASSETTE unsteady tape sound	Dirty capstan.	Clean capstan.
	Irregular cassette tape winding.	Replace tape.
	Pitch knob may be in wrong position.	Adjust pitch knob.
Cannot record	The erasure prevention tabs are broken out.	Replace tape or cover tab openings with adhesive tape.
	Play button and Record button were not pressed down simultaneously.	When recording, make sure that both the Record and Play buttons are pressed down at the same time.
Record tape sound is distorted.	Dirty head.	Clean capstan.
	Faulty cassette tape.	Replace tape.
CD PLAYER cannot work normally.	Disc is inserted upside down.	Insert disc correctly.
	Disc is dirty.	Wipe clean with soft cloth.
	Disc is scratched.	Use a new disc.
	Disc seriously warped.	Use a new disc.
	A nonstandard disc is inserted.	Use only brand name disc.
	Moisture has formed inside the CD deck.	Wait about 20 to 30 minutes to let it dry.
No song lyrics appear on screen	Wrong function is selected.	Select CD on Function Selector (29).
	Video cable is not connected properly to the TV.	Connect the video cable to the system's VIDEO OUT and to the TV VIDEO IN.
	Source selector on TV is not set to VIDEO.	Using your TV Remote to select VIDEO Input.
	TV does not have video line input.	Connect from VIDEO OUT of the system to the AUX IN of your VCR or Connect to an RF Modulator and then to the TV cable input.
No TV reception	Directional antenna is out of direction.	Turn the directional antenna with best reception or use an external antenna.
Picture is jumping up	Vertical hold is not set correctly.	Adjust the V. hold knob.

SPECIFICATIONS

AUDIO SECTION: OUTPUT POWER (MAXIMUM) OUTPUT IMPEDANCE	5 WATTS 4 ohms
CD PLAYER SECTION: FREQUENCY RESPONSE SIGNAL-TO-NOISE RATIO WOW AND FLUTTER D-A CONVERSION NUMBER OF PROGRAMS SAMPLING SYSTEM	20Hz-20KHz(+/-3dB) 65 dB IMMEASURABLE 1-BIT DAC 19 STEPS RANDOM ACCESS PROGRAMMING 8 TIMES OVER SAMPLING
TV SECTION: SYSTEM LO VHF CHANNEL HI VHF CHANNEL UHF CHANNEL	NTSC 2 - 6 7 - 13 14 - 69
CASSETTE DECK SECTION: WOW AND FLUTTER FREQUENCY RESPONSE TAPE SPEED	0.35%(WRMS) 125Hz-6.3KHz(+/-5dB) 4.75cm/Sec.
RADIO SECTION: AM FREQUENCY RANGE FM FREQUENCY RANGE	520 - 1740KHz 88 - 108MHz
POWER SOURCE: AC INPUT POWER	AC~120V/60Hz
DIMENSIONS(HxWxD)	22.5 x 11.8 x 10.5 Inches
WEIGHT	22Lbs
ACCESSORIES	1. Pre-recorded Karaoke CD+G disc 2. AV Cable 3. Dynamic Microphone

Specifications are typical, individual units might vary. They are subject to continuous improvement without notice and without incurring any obligation.

NOTES

NOTES

NOTES

The Singing Machine Company, Inc.

610-0700-00

6601 Lyons Road, Bldg. 7A, Coconut Creek, FL33073-9902, USA.
TEL: (954) 596-1000 FAX: (954) 596-2000

PRINTED IN CHINA

VISIT OUR WEBSITE www.singingmachine.com

Free Manuals Download Website

<http://myh66.com>

<http://usermanuals.us>

<http://www.somanuals.com>

<http://www.4manuals.cc>

<http://www.manual-lib.com>

<http://www.404manual.com>

<http://www.luxmanual.com>

<http://aubethermostatmanual.com>

Golf course search by state

<http://golfingnear.com>

Email search by domain

<http://emailbydomain.com>

Auto manuals search

<http://auto.somanuals.com>

TV manuals search

<http://tv.somanuals.com>