

## RANGE COMPOSITION

The range consists of 7 sinks on legs with two bowls varying in length from 1000 to 1800 mm.



# 1000/1800 mm

## ECO DOUBLE BOWL SINKS ON LEGS

**ZANUSSI**  
PROFESSIONAL

## FUNCTIONAL AND CONSTRUCTION FEATURES

already assembled.

- ◆ 40 mm high worktop in 304 AISI stainless steel, 700 mm in depth.
- ◆ 40 mm high shelf in stainless steel with riveted corners and trasversal reinforcements (accessory available upon request).
- ◆ 40x40 mm square section feet in 304 AISI stainless steel.
- ◆ Front and side paneling in stainless steel and back paneling in stainless steel.
- ◆ 100 mm upstand.
- ◆ The sink units are delivered

TECHNICAL DATA							
CHARACTERISTICS	MODELS						
	SL210 132516	SL212 132460	SL214 132461	SL216D 132517	SL216S 132518	SL218D 132462	SL218S 132463
External dimensions - mm							
width	1000	1200	1400	1600	1600	1800	1800
depth	700	700	700	700	700	700	700
height	850	850	850	850	850	850	850
Upstand dimensions - mm							
height	100	100	100	100	100	100	100
depth	13	13	13	13	13	13	13
radius	90°	90°	90°	90°	90°	90°	90°
Bowls - n.	2	2	2	2	2	2	2
Bowl dimensions (wxdxh) - mm	400x500xH250	500x500xH250	500x500xH250	400x500xH250	400x500xH250	500x500xH250	500x500xH250
Net weight - kg.	40	42	45	48	48	51	51

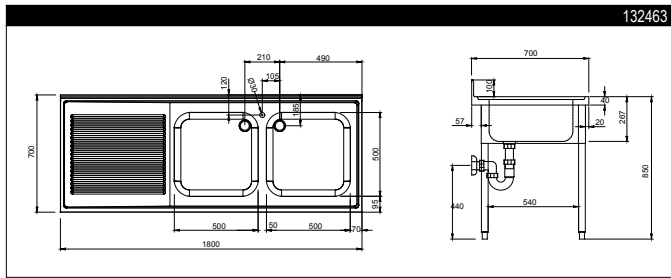
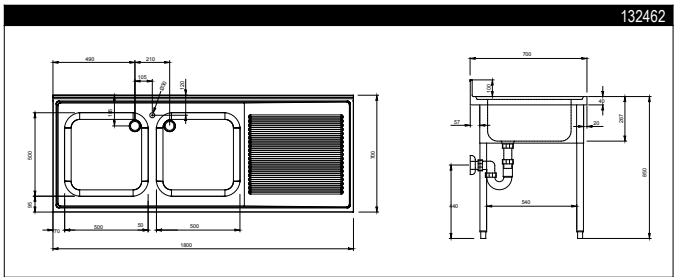
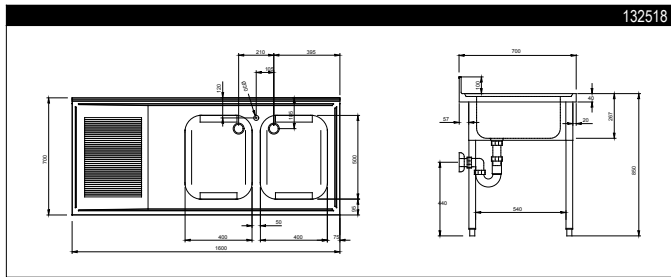
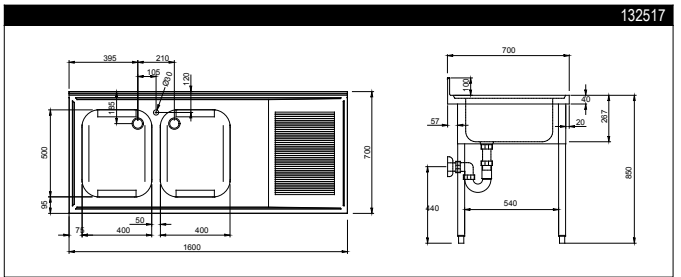
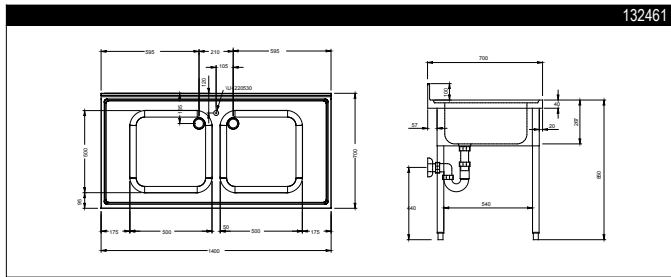
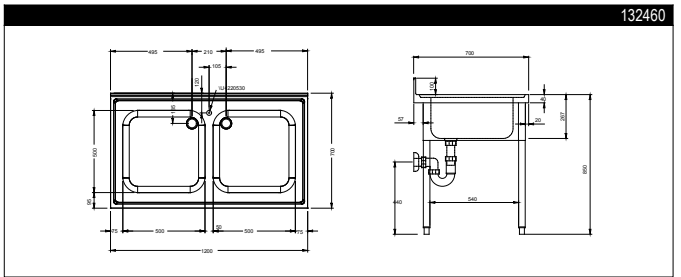
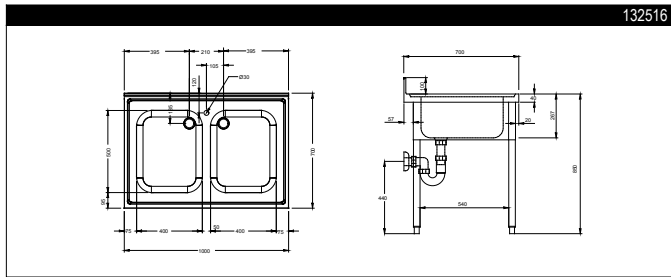

LEGEND	SL210 132516	SL212 132460	SL214 132461	SL216D 132517	SL216S 132518	SL218D 132462	SL218S 132463
A - Hot water inlet	3/4"	3/4"	3/4"	3/4"	3/4"	3/4"	3/4"
B - Cold water inlet	3/4"	3/4"	3/4"	3/4"	3/4"	3/4"	3/4"
C - Water drain	1 1/2"	1 1/2"	1 1/2"	1 1/2"	1 1/2"	1 1/2"	1 1/2"

OPTIONAL ACCESSORIES	MODELS						
	SL210 132516	SL212 132460	SL214 132461	SL216D 132517	SL216S 132518	SL218D 132462	SL218S 132463
DOUBLE PLASTIC DRAIN SYPHON 1.5"	850021	850021	850021	850021	850021	850021	850021
ELBOW OP.MIX.TAP+SHORT SPOUT-3/4" HOLE	855323						
ELBOW OP.MIXER TAP+SPOUT-3/4" SINGLE HOLE		855322	855322	855322	855322	855322	855322
ELBOW OP.TAP+SPRAY ARM+SPOUT-3/4" HOLE	855324	855324	855324	855324	855324	855324	855324
FOOT OP.MIXER TAP(HOT+COLD)+SPOUT-3/4"	855328	855328	855328	855328	855328	855328	855328
LOWER SHELF 1000MM	855167						
LOWER SHELF 1200MM		855168					
LOWER SHELF 1400MM			855169				
LOWER SHELF 1600MM				855170	855170		
LOWER SHELF 1800MM						855171	855171
MAXIREEL-RETRACTABLE HOSE SPRAY UNIT 6M	855327	855327	855327	855327	855327	855327	855327
MIXER TAP W/FOOT PEDAL FOR SINKS ON LEGS	855317	855317	855317	855317	855317	855317	855317
MIXER TAP WITH SPOUT 3/4" SINGLE HOLE	855319	855319	855319	855319	855319	855319	855319
MIXER TAP+SPRAY ARM+SPOUT-3/4" SING.HOLE	855329	855329	855329	855329	855329	855329	855329
PRE-WASH SPRAY UNIT,SINGLE HOLE	855315	855315	855315	855315	855315	855315	855315
SINGLE BRASS DRAIN SYPHON 1.5"	855308	855308	855308	855308	855308	855308	855308
SINGLE PLASTIC DRAIN SYPHON 1.5"	855306	855306	855306	855306	855306	855306	855306
WALL MIX.TAP+SPRAY+SPOUT+SH.LEVER+THERM	855307	855307	855307	855307	855307	855307	855307
WALL MIXER TAP WITH SWIVEL SPOUT 3/4"	855310	855310	855310	855310	855310	855310	855310



www.zanussiprofessional.com

## Free Manuals Download Website

<http://myh66.com>

<http://usermanuals.us>

<http://www.somanuals.com>

<http://www.4manuals.cc>

<http://www.manual-lib.com>

<http://www.404manual.com>

<http://www.luxmanual.com>

<http://aubethermostatmanual.com>

Golf course search by state

<http://golfingnear.com>

Email search by domain

<http://emailbydomain.com>

Auto manuals search

<http://auto.somanuals.com>

TV manuals search

<http://tv.somanuals.com>