

## RANGE COMPOSITION

A complete and flexible range of cold rooms ideal for storing and conserving perishable food (meat, fish, cold cuts, cheese, fruit, vegetables), in addition to chilled and frozen food. Constructed in top quality, reliable materials, they are manufactured with the utmost attention paid to eliminating possible ecological damage. All models can be connected to a refrigeration unit installed directly inset on the wall of the cold room or to a remote refrigeration unit. The availability of a remote condenser unit is particularly useful when using cold rooms in environments with critical ambient temperatures, ventilation or space problems. The models detailed on this sheet are 4 cold rooms (-2°+8°C) with built-in refrigerating unit and with usable volume of 8,4 to 10 m<sup>3</sup> with panel insulation 60 mm in thickness. All models come with panels, gas precharged cooling unit and piping.



Shelving as accessory

# 8.4/ 10 m<sup>3</sup>

## SPLIT UNIT COLD ROOMS -2°+8°C ZANUSSI PROFESSIONAL

### FUNCTIONAL AND CONSTRUCTION FEATURES

- ◆ Assembly system that guarantees minimal temperature loss through twin hook fasteners which allow perfect alignment of the panels. This fastener is made of high resistant composite material and guarantees perfect grip of all components that can be easily disassembled and reassembled.
- ◆ Wall panels and inside ceiling panels are clad with anti-scratch prepainted galvanized steel
- ◆ All panels are insulated with injected polyurethane.CFC and HCFC free.
- ◆ All panels have PVC gaskets foamed in place to assure airtight and secure fitting. Any other sealing between panels on site is eliminated.
- ◆ Galvanized steel floor covered with a non-abrasive, non-slip, ribbed plastic coat
- ◆ Rounded internal and external corners.
- ◆ The right-hinged door is available as standard (left-hinged door on request) and constructed with smooth rounded profiles, cam-lift action hinges, airtight magnetic door, gaskets and high insulation for saving energy and operating costs. As an option a microswitch switches on automatically the internal light and turns off the fans
- ◆ Newly designed handle, complete with lock has an internal safety release to prevent

entrapment when the door is accidentally locked from outside.

- ◆ Powerful tropicalized refrigeration system designed to operate more efficiently and without failure in the most extreme temperatures (up to 43°C).
- ◆ Prefitted and insulated pipes for connection between evaporator and condensing unit with fast connectors.
- ◆ Defrosting through heated gas permits to reduce the total power installed shorten defrosting time and limited warming of the cold room.
- ◆ The control panel includes: luminous ON/OFF switch, internal lighting switch, cold room functioning indicator, defrosting cycle

indicator, temperature and thermostat control with digital display.

- ◆ All models comply with the standards required by the main international approval bodies and are H marked.

CHARACTERISTICS	MODELS			
	MN08420RCL 102274	MN09416RCL 102282	MN09428RCL 102258	MN10024RCL 102275
External dimensions - mm				
width	2150	2950	1750	2150
depth	2150	1750	2950	2550
height	2150	2150	2150	2150
Internal dimensions - mm				
width	2030	2830	1630	2030
depth	2030	1630	2830	2430
height	2030	2030	2030	2030
Power - kW				
installed-electric	0,85	0,85	0,85	0,85
Noise level - dBA	60	60	60	60
Net weight - kg.	381	426	426	437
Power supply - V, phases, Hz	230 V, 1N, 50	230 V, 1N, 50	230 V, 1N, 50	230 V, 1N, 50
Usable surface area - m <sup>2</sup>	4,12	4,61	4,61	4,93
Usable volume - m <sup>3</sup> .	8,4	9,4	9,4	10,0
Refrigeration unit				
Compressor power - HP	0,75	0,75	0,75	0,75

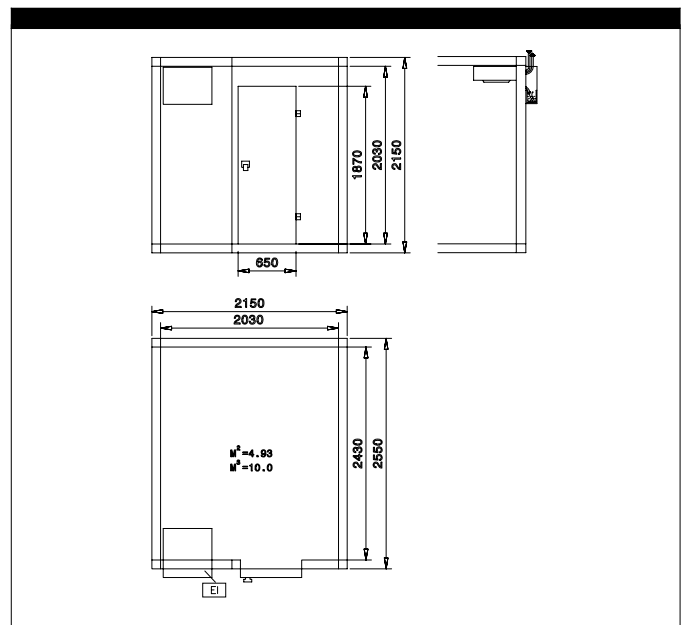
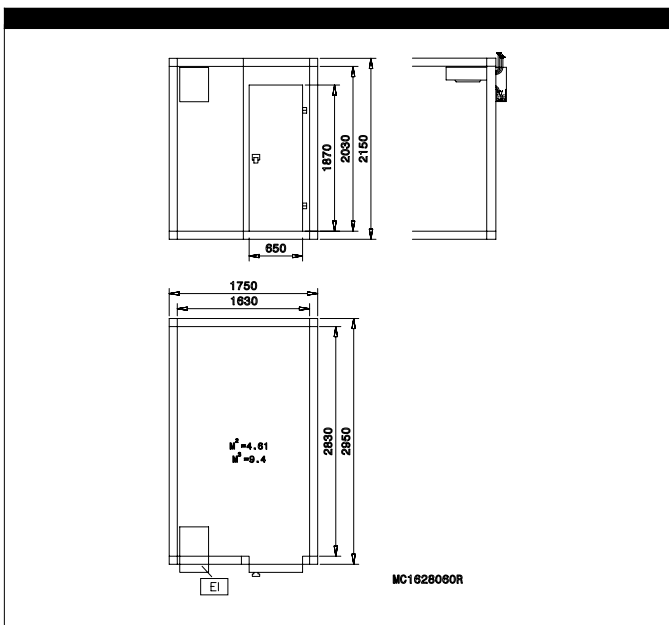
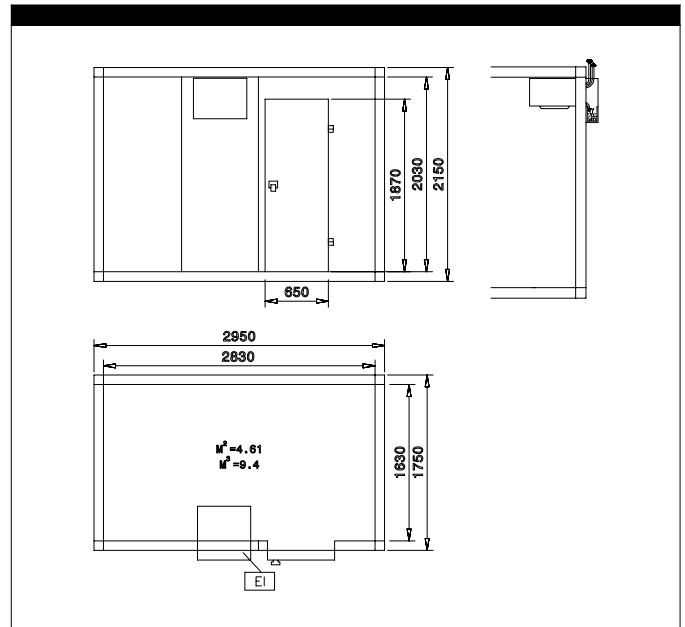
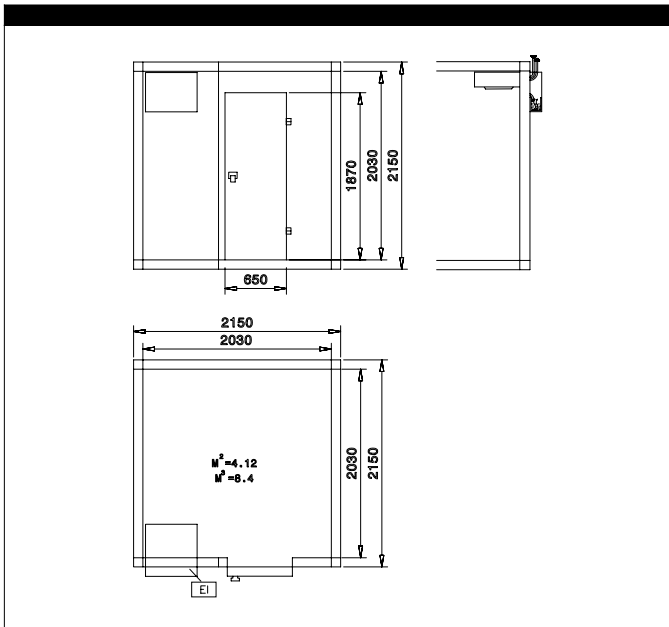

	MN08420RCL 102274	MN09416RCL 102282	MN09428RCL 102258	MN10024RCL 102275
EI - Electrical connection	230 V, 1N, 50	230 V, 1N, 50	230 V, 1N, 50	230 V, 1N, 50
RI - Remote refrigeration connection	●	●	●	●



ACCESSORIES	MODELS			
	MN08420RCL 102274	MN09416RCL 102282	MN09428RCL 102258	MN10024RCL 102275
ALUM.SHELV.,POLY.TIERS-COLDROOM 163X283			137094	
ALUM.SHELV.,POLY.TIERS-COLDROOM 203X203	137097			
ALUM.SHELV.,POLY.TIERS-COLDROOM 203X243				137098
ALUM.SHELV.,POLY.TIERS-COLDROOM 283X163		137105		
DOOR MICROSWITCH	102441	102441	102441	102441
GRAPHIC TEMPERATURE RECORDER	102025	102025	102025	102025
KIT HACCP ADV.CONNECTION FOR COLD ROOMS	102021	102021	102021	102021
PLASTIC CURTAIN FOR 65CM DOOR CLEARANCE	102027	102027	102027	102027
PRINTER FOR HACCP BASIC VERSION REFRIG.	881457	881457	881457	881457
PRINTER FOR TEMPERATURE RECORDER	102026	102026	102026	102026



www.zanussiprofessional.com

## Free Manuals Download Website

<http://myh66.com>

<http://usermanuals.us>

<http://www.somanuals.com>

<http://www.4manuals.cc>

<http://www.manual-lib.com>

<http://www.404manual.com>

<http://www.luxmanual.com>

<http://aubethermostatmanual.com>

Golf course search by state

<http://golfingnear.com>

Email search by domain

<http://emailbydomain.com>

Auto manuals search

<http://auto.somanuals.com>

TV manuals search

<http://tv.somanuals.com>