

EN User manual

2

# USER MANUAL

Fridge-Freezer

ZRB228FXO  
ZRB228FWO

*la vita è bella*  
**ZANUSSI**

ITALIAN SINCE 1916

Safety information	2	Care and cleaning	6
First use	3	What to do if...	6
Control panel	4	Technical data	8
Daily use	4	Electrical connection	9
Helpful hints and tips	5	Environmental concerns	11

Subject to change without notice

## Safety information

In the interest of your safety and to ensure the correct use, before installing and first using the appliance, read this user manual carefully, including its hints and warnings. To avoid unnecessary mistakes and accidents, it is important to ensure that all people using the appliance are thoroughly familiar with its operation and safety features. Save these instructions and make sure that they remain with the appliance if it is moved or sold, so that everyone using it through its life will be properly informed on appliance use and safety.

For the safety of life and property keep the precautions of these user's instructions as the manufacturer is not responsible for damages caused by omission.

### Children and vulnerable people safety

- This appliance is not intended for use by persons (including children) with reduced physical, sensory or mental capabilities, or lack of experience and knowledge, unless they have been given supervision or instruction concerning use of the appliance by a person responsible for their safety. Children should be supervised to ensure that they do not play with the appliance.
- Keep all packaging well away from children. There is risk of suffocation.
- If you are discarding the appliance pull the plug out of the socket, cut the connection cable (as close to the appliance as you can) and remove the door to prevent playing children to suffer electric shock or to close themselves into it.
- If this appliance featuring magnetic door seals is to replace an older appliance having a spring lock (latch) on the door or lid, be sure to make that spring lock unusable before you discard the old appliance. This will prevent it from becoming a death trap for a child.

### General safety

 **Caution!** Keep ventilation openings clear of obstruction.

- The appliance is intended for keeping foodstuff and/or beverages in a normal household as explained in this instruction booklet.
- Do not use other electrical appliances (such as ice cream makers) inside of refrigeration appliances, unless they are approved for this purpose by the manufacturer.
- Do not damage the refrigerant circuit.
- The refrigerant isobutene (R600a) is contained within the refrigerant circuit of the appliance, a natural gas with a high level of environmental compatibility, which is nevertheless flammable.

During transportation and installation of the appliance, be certain that none of the components of the refrigerant circuit become damaged.

If the refrigerant circuit should become damaged:

- avoid open flames and sources of ignition
- thoroughly ventilate the room in which the appliance is situated

It is dangerous to alter the specifications or modify this product in any way. Any damage to the cord may cause a short-circuit, fire and/or electric shock.

 **Warning!** Any electrical component (power cord, plug, compressor) must be replaced by a certified service agent or qualified service personnel.

1. Power cord must not be lengthened.
2. Make sure that the power plug is not squashed or damaged by the back of the appliance. A squashed or damaged power plug may overheat and caused a fire.
3. Make sure that you can come to the mains plug of the appliance.
4. Do not pull the mains cable.
5. If the power plug socket is loose, do not insert the power plug. There is a risk of electric shock or fire.

6. You must not operate the appliance without the lamp cover of interior lighting.
- This appliance is heavy. Care should be taken when moving it.
  - Do not remove or touch items from the freezer compartments if your hands are damp/wet, as this could cause skin abrasions or frost/freezer burns.
  - Avoid prolonged exposure of the appliance to direct sunlight.

### Daily Use

- Do not put hot pot on the plastic parts in the appliance.
- Do not store flammable gas and liquid in the appliance, because they may explode.
- Appliance's manufacturers storage recommendations should be strictly adhered to. Refer to relevant instructions.
- Do not place carbonated or fizzy drinks in the freezer compartment as it creates pressure on the container, which may cause it to explode, resulting in damage to the appliance.
- Ice lollies can cause frost burns if consumed straight from the appliance.

### Care and cleaning

Before maintenance, switch off the appliance and disconnect the mains plug from the mains socket.

- Do not clean the appliance with metal objects.
- Do not use sharp objects to remove frost from the appliance. Use a plastic scraper.
- Regularly examine the drain in the refrigerator for defrosted water. If necessary, clean the drain. If the drain is blocked, water will collect in the bottom of the appliance.

### Installation

**Important!** For electrical connection carefully follow the instructions given in specific paragraphs.

## First Use

### Cleaning the interior

Before using the appliance for the first time, wash the interior and internal accessories with lukewarm water and some neutral soap so as to remove the typical smell of a brand-new product, then dry thoroughly.

- Unpack the appliance and check if there are damages on it. Do not connect the appliance if it is damaged. Report possible damages immediately to the place you bought it. In that case retain packing.
- It is advisable to wait at least four hours before connecting the appliance to allow the oil to flow back in the compressor.
- Adequate air circulation should be around the appliance, lacking this leads to overheating. To achieve sufficient ventilation follow the instructions relevant to installation.
- Wherever possible the back of the product should be against a wall to avoid touching or catching warm parts (compressor, condenser) to prevent possible burn.
- The appliance must not be located close to radiators or cookers. Make sure that the mains plug is accessible after the installation of the appliance.
- Connect to potable water supply only.

### Service

- Any electrical work required to do the servicing of the appliance should be carried out by a qualified electrician or competent person.
- This product must be serviced by an authorized Service Centre, and only genuine spare parts must be used.

### Environment Protection

 This appliance does not contain gasses which could damage the ozone layer, in either its refrigerant circuit or insulation materials. The appliance shall not be discarded together with the urban refuse and rubbish. The insulation foam contains flammable gases: the appliance shall be disposed according to the applicable regulations to obtain from your local authorities. Avoid damaging the cooling unit, especially at the rear near the heat exchanger. The materials used on this appliance marked by the symbol ♻️ are recyclable.

**Important!** Do not use detergents or abrasive powders, as these will damage the finish.

## Temperature Control

- The refrigerator is designed to maintain an internal storage temperature in the refrigerator compartment

### Temperature regulation

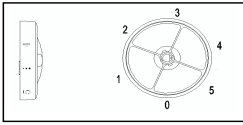

The temperature in the refrigerator and freezer compartment is controlled by the temperature controller installed on the roof of the refrigerator compartment. We strongly recommend you use a freezer thermometer to check that the temperature is below -18 centigrade before loading any food. This can take 2 - 3 hours. The marks on the knob are setting guides, NOT the exact degrees of temperature.

'0' is 'OFF' and '5' represents the lowest temperature. Please start with the knob set to position '3'. Use a suitable thermometer to check the temperature after two hours. The refrigerator temperature should be set between +2 C and +5 and the freezer will vary between -18 and -25 degrees centigrade over a typical cycle. To reduce the refrigerator temperature turns the knob towards '4' and check after one hour.

### Quick Freezing

Quick freezing allows moisture inside foodstuffs to form fine ice-crystals which prevent the cell membrane from being damaged and the cytoplasm being lost when unfreezing, thus the original freshness and nutrition constituent of foodstuffs can be retained.

Fresh meal and fish to be stored for long time must be done by quick freezing.

To quick freeze turn the temperature knob to setting "5" before adding food.

After quick freezing, turn the knob back to the original position.

### Replacing the light bulb

Disconnect the appliance from the mains supply. Remove the lamp guard, unscrew the lamp in an anti-clockwise direction until the lamp comes out of the lamp holder.

Screw a new lamp (15 Watt & E14

Base) bulb into the lamp holder in a clockwise direction until tight.

Repalce the lamp guard back into place.

Reconnect the appliance to the mains supply.

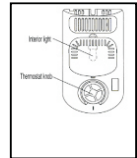

## Daily Use

### Movable shelves

- The walls of the refrigerator are equipped with a series of runners so that the shelves can be positioned as desired.

### Vegetable Drawer

The drawer is suitable for storing fruit and vegetables.

### Positioning the door shelves

- To permit storage of food packages of various sizes, the door shelves can be placed at different heights.

### Ice-cube production

- This appliance is equipped with one tray for the production of ice-cubes.
- These are insert on the sides of the upper freezer drawer
- Pull out the upper freezer drawer. Extract the ice-tray. Pull out the tap. Fill with water to the limit indicated "MAX".
- Refit the tap and insert the tray in the appropriate place.
- To remove the ice cubes rotate the tray with the ice needles towards the top and hit on a rigid surface.
- To simplify the release of the ice needles it is recommended to keep the closed tray under if possible luke warm water for a few seconds.

**Warning!** Do not use metallic instruments to remove

the trays from the freezer.

### Freezing fresh food

- The freezer compartment is suitable for freezing fresh food and storing frozen and deep-frozen food for a long time.
- To freeze fresh food activate the Fast Freeze function at least 24 hours before placing the food to be frozen in the freezer compartment.
- Place the fresh food to be frozen in the bottom compartment.
- The maximum amount of food that can be frozen in 24 hours is specified on the rating plate, a label located on the inside of the appliance.
- The freezing process lasts 24 hours: during this period do not add other food to be frozen.

### Storage of frozen food

- When first starting-up or after a period out of use, before putting the products in the compartment let the appliance run at least 2 hours on the higher settings.

**Important!** In the event of accidental defrosting, for example due to a power failure, if the power has been off for longer than the value shown in the technical characteristics chart under "rising time", the defrosted food must be consumed quickly or cooked immediately and then re-frozen (after cooling).



## Thawing

- Deep-frozen or frozen food, prior to being used, can be thawed in the refrigerator compartment or at room

## Helpful hints and tips

### Hints for energy saving

- Do not open the door frequently or leave it open longer than absolutely necessary.
- If the ambient temperature is high and the Temperature Regulator is set to low temperature and the appliance is fully loaded, the compressor may run continuously, causing frost or ice on the evaporator. If this happens, set the Temperature Regulator toward warmer settings to allow automatic defrosting and so a saving in electricity consumption.

### Hints for fresh food refrigeration

To obtain the best performance:

- Do not store warm food or evaporating liquids in the refrigerator.
- Do cover or wrap the food, particularly if it has a strong flavour.
- Position food so that air can circulate freely around it.

### Hints for refrigeration

Useful hints:

- Meat (all types): wrap in polythene bags and place on the glass shelf above the vegetable drawer.
- For safety, store in this way only one or two days at the most.
- Cooked foods, cold dishes, etc...: these should be covered and may be placed on any shelf.
- Fruit and vegetables: these should be thoroughly cleaned and placed in the special drawer(s) provided.
- Butter and cheese: these should be placed in special airtight containers or wrapped in 4 electroflux aluminium foil or polythene bags to exclude as much air as possible.
- Milk bottles: these should have a cap and should be stored in the bottle rack on the door.
- Bananas, potatoes, onions and garlic, if not packed, must not be kept in the refrigerator.

temperature, depending on the time available for this operation.

- Small pieces may even be cooked still frozen, directly from the freezer: in this case, cooking will take longer.

### Hints for freezing

To help you make the most of the freezing process, here are some important hints:

- the maximum quantity of food which can be frozen in 24 hrs. is shown on the rating plate;
- the freezing process takes 24 hours. No further food to be frozen should be added during this period;
- only freeze top quality, fresh and thoroughly cleaned, foodstuffs;
- prepare food in small portions to enable it to be rapidly and completely frozen and to make it possible subsequently to thaw only the quantity required;
- wrap up the food in aluminium foil or polythene and make sure that the packages are airtight;
- do not allow fresh, unfrozen food to touch food which is already frozen, thus avoiding a rise in temperature of the latter;
- lean foods store better and longer than fatty ones; salt reduces the storage life of food;
- water ices, if consumed immediately after removal from the freezer compartment, can possibly cause the skin to be freeze burnt;
- it is advisable to show the freezing in date on each individual pack to enable you to keep tab of the storage time.

### Hints for storage of frozen food

To obtain the best performance from this appliance, you should:

- make sure that the commercially frozen foodstuffs were adequately stored by the retailer;
- be sure that frozen foodstuffs are transferred from the food store to the freezer in the shortest possible time;
- not open the door frequently or leave it open longer than absolutely necessary.
- Once defrosted, food deteriorates rapidly and cannot be refrozen.
- Do not exceed the storage period indicated by the food manufact

## Care and cleaning

 **Caution!** Unplug the appliance before carrying out any maintenance operation.

 This appliance contains hydrocarbons in its cooling unit; maintenance and recharging must therefore only be carried out by authorized technicians.

### Periodic cleaning

The equipment has to be cleaned regularly:

- clean the inside and accessories with lukewarm water and some neutral soap.
- regularly check the door seals and wipe clean to ensure they are clean and free from debris.
- rinse and dry thoroughly.

**Important!** Do not pull, move or damage any pipes and/or cables inside the cabinet.

Never use detergents, abrasive powders, highly perfumed cleaning products or wax polishes to clean the interior as this will damage the surface and leave a strong odour.

Clean the condenser (black grill) and the compressor at the back of the appliance with a brush or a vacuum cleaner.

This operation will improve the performance of the appliance and save electricity consumption.

**Important!** Take care of not to damage the cooling system.

Many proprietary kitchen surface cleaners contain chemicals that can attack/damage the plastics used in this appliance.

For this reason it is recommended that the outer casing of this appliance is only cleaned with warm water with a little washing-up liquid added.

After cleaning, reconnect the equipment to the mains supply.

## What to do if...

 **Warning!** Before troubleshooting, disconnect the mains plug from the mains socket.

Only a qualified electrician or competent person must do the troubleshooting that is not in this manual.

### Defrosting of the refrigerator

Frost is automatically eliminated from the evaporator of the refrigerator compartment every time the motor compressor stops, during normal use. The defrost water drains out through a trough into a special container at the back of the appliance, over the motor compressor, where it evaporates.

It is important to periodically clean the defrost water drain hole in the middle of the refrigerator compartment channel to prevent the water overflowing and dripping onto the food inside. Use the special cleaner provided, which you will find already inserted into the drain hole.

### Defrosting of the freezer

The freezer compartment of this model is a "no frost" type. This means that there is no build up of frost when it is in operation, neither on the internal walls nor on the foods.

The absence of frost is due to the continuous circulation of cold air inside the compartment, driven by an automatically controlled fan.

### Periods of non-operation

When the appliance is not in use for long periods, take the following precautions:

- disconnect the appliance from electricity supply
- remove all food
- defrost and clean the appliance and all accessories
- leave the door/doors ajar to prevent unpleasant smells.

If the cabinet will be kept on, ask somebody to check it once in a while to prevent the food inside from spoiling in case of a power failure.

**Important!** There are some sounds during normal use (compressor, refrigerant circulation)

Problem	Possible cause	Solution
The appliance does not operate.	The mains plug is not connected to the mains socket correctly. Temperature control is in the Off position. Refrigerator may not be plugged in, or plug may be loose. House fuse blown or tripped circuit breaker. Power outage.	Connect the mains plug to the mains socket correctly. See Control Panel. Ensure plug is tightly pushed into outlet. Check the fuse and reset circuit breaker. Check house light & call loack Electric Company.
The lamp does not work.	The lamp is in stand-by. The lamp is defective.	Close and open the door. Refer to "Replacing the lamp".
The compressor operates continually.	The temperature is not set correctly. The door is not closed correctly. The door has been opened too frequently. The product temperature is too high. The room temperature is too high.	See Control Panel. Close the door. Do not keep the door open longer than necessary. Let the product temperature decrease to room temperature before storage. Decrease the room temperature.
Water flows on the rear plate of the refrigerator.	During the automatic defrosting process, frost defrosts on the rear plate.	This is correct.
Water flows into the refrigerator.	The water outlet is clogged. Products prevent that water flows into the water collector.	Clean the water outlet. Make sure that products do not touch the rear plate.
Water flows on the ground.	The melting water outlet does not flow in the evaporative tray above the compressor.	Attach the melting water outlet to the evaporative tray.
The temperature in the appliance is too low.	The temperature regulator is not set correctly. The temperature regulator is not set correctly.	Set a higher temperature. Set a lower temperature.
The temperature in the appliance is too high.	The door is not closed correctly. The product temperature is too high.	Close the door. Let the product temperature decrease to room temperature before storage.
There is too much frost.	Many products are stored at the same time. Food is not wrapped correctly. The door is not closed correctly	Store less products at the same time. Wrap the food correctly. The door is not closed correctly.
Noisy running	The appliance has not been properly leveled. The appliance is in contact with the wall. Refrigerant is circulating throughout the system.	See "Installation" See "Installation" This is normal.

## Technical Data

Dimensions		
	Height	1750 mm
	Width	595 mm
	Depth	620 mm

The technical information are situated in the rating plate on the back side of the appliance and in the energy label.

**⚠ Caution!** Read the "Safety Information" carefully for your safety and correct operation of the appliance before installing the appliance.

### Positioning

Install this appliance at a location where the ambient temperature corresponds to the climate class indicated on the rating plate of the appliance:

Climate Class	Ambient Temperature
SN	+10 °C to 32 °C
N	+16 °C to 32 °C
ST	+16 °C to 38 °C
T	+16 °C to 43 °C

### Location

The appliance should be installed well away from sources of heat such as radiators, boilers, direct sunlight etc. Ensure that air can circulate freely around the back of the cabinet. To ensure best performance, if the appliance is positioned below an overhanging wall unit, the minimum distance between the top of the cabinet and the wall unit must be at least 100 mm. Ideally, however, the appliance should not be positioned below overhanging wall units.

Accurate levelling is ensured by one or more adjustable feet at the base of the cabinet.

If the cabinet is placed in a corner and the side with the hinges facing the wall, the distance between the wall and the cabinet must be at least 10 mm to allow the door to open enough so that the shelves can be removed.

**⚠ Warning!** It must be possible to disconnect the appliance from the mains power supply; the plug must therefore be easily accessible after installation.

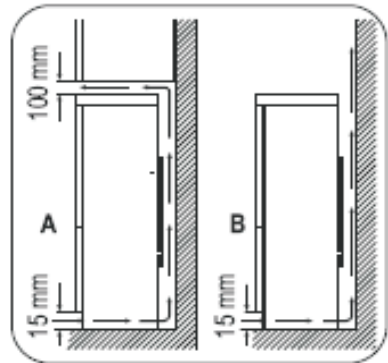

## Electrical connection

**⚠ Caution!** Any electrical work required to install this appliance should be carried out by a qualified electrician or competent person.

**⚠ Warning!** This appliance must be earthed.

The manufacturer declines any liability should these safety measures not be observed.

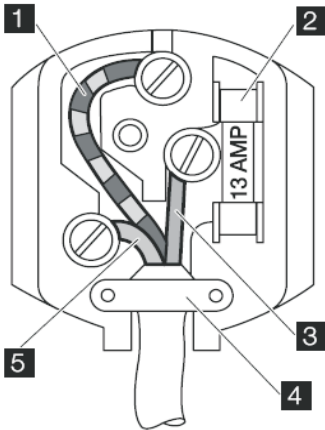

coloured in accordance with the following code:

- |                            |         |
|----------------------------|---------|
| <b>1</b> Green and Yellow: | Earth   |
| <b>3</b> Brown:            | Live    |
| <b>5</b> Blue:             | Neutral |

As the colours of the wires in the mains lead of this appliance may not correspond with the coloured markings identifying the terminals in your plug, proceed as follows:

1. Connect the wire coloured green and yellow to the terminal marked either with the letter "E" or by the earth symbol  or coloured green and yellow.
2. Connect the wire coloured blue to the terminal either marked with the letter "N" or coloured black.
3. Connect the wire coloured brown to the terminal either marked with the letter "L" or coloured red.
4. Check that no cut, or stray strands of wire is present and the cord clamp **4** is secure over the outer sheath.
5. Make sure the electricity supply voltage is the same as that indicated on the appliance rating plate.
6. Switch on the appliance.

The appliance is supplied with a 13 amp plug fitted **2**. In the event of having to change the fuse in the plug supplied, a 13 amp ASTA approved (BS 1362) fuse must be used.

**⚠ Warning!** A cut off plug inserted into a 13 amp socket is a serious safety (shock) hazard. Ensure that it is disposed of safely.

## Electrical connection

Before plugging in, ensure that the voltage and frequency shown on the rating plate correspond to your domestic power supply.

The appliance must be earthed. The power supply cable plug is provided with a contact for this purpose. If the domestic power supply socket is not earthed, connect the appliance to a

separate earth in compliance with current regulations, consulting a qualified electrician.

The manufacturer declines all responsibility if the above safety precautions are not observed. This appliance complies with the E.E.C. Directives.

## Rear spacers

In the bag with the documentation, there is one stopper block to protect the condenser if the space is too close to the wall.

### Door reversibility

**Warning!** Before carrying out any operations, remove the plug from the power socket.

**Important!** To carry out the following operations, we suggest that this be made with another person that will keep a firm hold on the doors of the appliance during the operations.

To change the opening direction of the door, do these steps:

1. Tilt the refrigerator back to set at an angle.
2. Rotate the left and right adjustable front feet at the bottom by hand, turning them anti-clockwise.

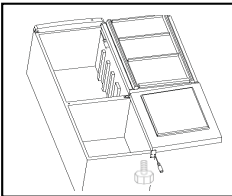

3. Unscrew the bolts which are used to fix the bottom hinge with the wide head of a spanner, and unscrew bottom hinge with screwdriver, then remove the freezer door carefully; After that use the narrow-head of the spanner to unscrew the hinge pin and stopper, and place them in the symmetrical holes.

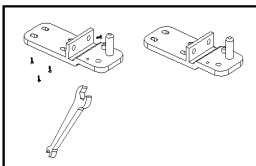

4. Unscrew with the left-bottom bolts with wide-head of the spanner, then unscrew the bottom hinge with a screwdriver.

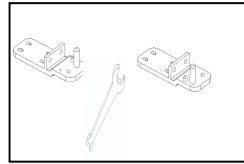

5. Remove the stopper which is under the bottom door trim with a screwdriver, then install it to the left symmetrical position.

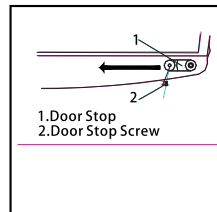

6. Rotate the bolt which is used to fix the middle hinge with screwdriver, remove the middle hinge, then carefully remove fridge door.

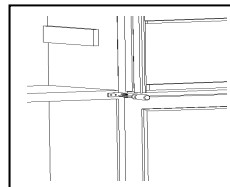

7. Rotate the pin by using the wide-head of the spanner and remove the left hole cover with a screwdriver, exchange the assembly location and fix it as the previous method.

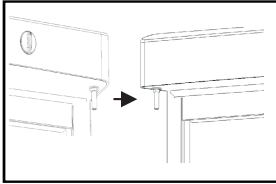

8. Change the handle. (which is the same method for both fridge door and freezer door )

Remove the two side of plastic hole cover and handle with a screwdriver, fix them on the opposite side. Put the plastic hole covers over were the handle was originally situated.

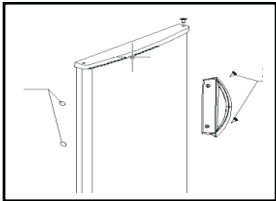

9. Install the door carefully, adjust assembly position, move the hinge to left symmetrical position, then fix it with the bolt. Then use the bolt to fix the adjustable foot in an appropriate location.

**Warning!** Reposition, level the appliance, wait for at least four hours and then connect it to the power socket.

If the ambient temperature is cold (i.e. in Winter), the gasket may not fit perfectly to the cabinet. In that case, wait for the natural fitting of the gasket.

In case you do not want to carry out the above mentioned operations, contact the nearest After Sales Service Force.

## Environmental Concerns

The symbol  on the product or on its packaging indicates that this product may not be treated as household waste. Instead it should be taken to the appropriate collection point for the recycling of electrical and electronic equipment. By ensuring this product is disposed of correctly, you will help prevent potential negative

consequences for the environment and human health. Which could otherwise be caused by inappropriate waste handling of this product. For more detailed information about recycling of this product, please contact your local council, your household waste disposal service or the shop where you purchased the product.

To buy accessories, consumables and spare parts at our online shop please visit:  
[www.zanussi.co.uk](http://www.zanussi.co.uk)

C0924.5.1(083B)-00-032010





## Free Manuals Download Website

<http://myh66.com>

<http://usermanuals.us>

<http://www.somanuals.com>

<http://www.4manuals.cc>

<http://www.manual-lib.com>

<http://www.404manual.com>

<http://www.luxmanual.com>

<http://aubethermostatmanual.com>

Golf course search by state

<http://golfingnear.com>

Email search by domain

<http://emailbydomain.com>

Auto manuals search

<http://auto.somanuals.com>

TV manuals search

<http://tv.somanuals.com>