



ADC780

VANDAL RESISTANT CAMERA PRE-PACKS



FEATURES

- Vandal resistant
- Surface dome, flush dome and corner mount housings
- Indoor and outdoor versions
- Tamper resistant fasteners
- Cast aluminum with polycarbonate window
- 480-line color camera, installed
- 2.6-6 mm variable focal lens
- Auto iris
- Weather resistant (outdoor version)
- Backlight compensation
- Heater options
- Easy to install

The ADC780 Series of pre-packaged vandal resistant cameras is designed for tough environments where a typical camera would not survive. The housing is made of heavy-duty cast aluminum with a polycarbonate viewing window. The camera inside is protected by the housing's unique tamper resistant hardware.

For the surface dome and corner mount versions, an overlapping cover with a gasket is designed to protect against water intrusion.

With the optional thermostatically controlled heater, the camera will operate in temperatures from -40° to 50° C (-40° to 122° F). The heater is not available with the flush mount version.

The installed camera is a high-resolution color camera with 480 lines of resolution and a 2.6-6 mm variable focal, auto iris lens. This one camera will meet or exceed most viewing requirements, providing a sharp picture with true colors.

These packages are ideal for schools, parking garages and correctional facilities where cameras are subject to abuse.



AMERICAN DYNAMICS ADC780 VANDAL RESISTANT HOUSINGS

SPECIFICATIONS

Model Numbers*

ADC780SD-24	Surface Dome - NTSC
ADC780FD-24	Flush Dome - NTSC
ADC780CM-24	Corner Mount - NTSC
ADC780SD-24HI	Surface Dome with Heater Installed
ADC780CM-24HI	Corner Mount with Heater Installed
ADC780SD-24X	Surface Dome - PAL
ADC780FD-24X	Flush Dome - PAL
ADC780CM-24X	Corner Mount - PAL
ADC780SD-24H	Heater Kit for Surface Dome
ADC780CM-24H	Heater Kit for Corner Mount

* Housing is shipped with mounting screws with gaskets.
 * Recommended installation materials (not supplied): Teflon® plumbers tape and UL® listed electrical tape.

Operational

Imager	1/4-inch Interline transfer CCD
Video Output	1.0 Vp-p/ 75 Ω, composite
Active Pixel Count	
NTSC	768 (H) x 494 (V)
PAL	752 (H) x 582 (V)
Lens	2.6-6.0 mm variable focal, auto iris lens
Minimum Scene	
Illumination	3.0 lux (f1.4 lens) at 50 IRE 0.4 lux (f1.4 lens) at 20 IRE
Horizontal Resolution	480 TV lines
Light Compensation Modes	Automatic electronic shutter, On/Off (NTSC 1/60 -1/100,000 sec) (PAL 1/50 -1/100,000 sec)
Auto Iris Drive	DC
Backlight Compensation	On/Off selectable
Synchronization Modes	Internal/line-lock with phase adjustment
White Balance	Automatic
Geometric Distortion	None
S/N Ratio	-50 dB
Manual Pan	335°
Manual Tilt	75°

Controls

AES	On/Off
AGC	On/Off
Synchronization	Internal/line-lock with phase adjustment
DC Iris	Level control

Connectors

Input Power	Screw terminal block
Composite Video	BNC on cord

Electrical

AC Voltage	24 VAC (+20%, -15%) 60 Hz NTSC 50 Hz PAL
Power Consumption	3.0 watts

Mechanical

Dimensions (W x H x D)	
Surface Dome	120 x 120 x 91.5 mm (4.72 x 4.72 x 3.64 in)
Flush Dome	
Total	120 x 120 x 91.5 mm (4.72 x 4.72 x 3.64 in)
Above Ceiling	39 mm (1.54 in)
Below Ceiling	52.5 mm (2.07 in)
Corner Mount	105 x 120 x 127 mm (4.13 x 4.72 x 5.00 in)

Weight

Surface Dome	590 g (1.30 lbs)
Flush Dome	450 g (1.00 lbs)
Corner Mount	590 g (1.30 lbs)

Color	Light beige
Construction	Cast aluminum housing with polycarbonate bubble or window

Environmental

Operating Environment	
Surface Dome	Indoor/Outdoor
Flush Dome	Indoor
Corner Mount	Indoor/Outdoor
Operating Temperature	-10° to 50° C (14° to 122° F) with Optional Heater -40° to 50° C (-40° to 122° F)
Humidity	90% RH (non-condensing)
Storage Temperature	-20° to 60° C (-4° to 140° F)

Regulatory

Emissions	FCC Part 15, Class A CE: EN55022 ICES-003
Immunity	CE: EN55082-1 CE: EN50130-4
Safety	UL1950 CSA C22.2 No. 950 EN60950

Weather Resistance

Surface Mount	NEMA 4, IP43
Flush Mount	NEMA 1, IP40
Corner Mount	NEMA 3R, IP43
Impact Resistance	ASTM D5420-98A

ADC780FD Flush Mount
Side View

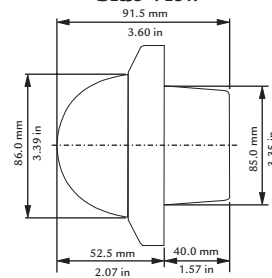

ADC780SD Surface Mount
Side View

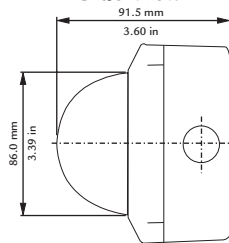

ADC780CM Corner Mount
Side View

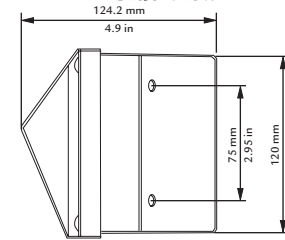

Product specifications and availability subject to change without notice. Certain product names mentioned herein may be trade names and/or registered trademarks of other companies.



VS214-02 01/03 L
©2003 Sensormatic Electronics Corporation

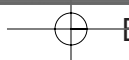

Free Manuals Download Website

<http://myh66.com>

<http://usermanuals.us>

<http://www.somanuals.com>

<http://www.4manuals.cc>

<http://www.manual-lib.com>

<http://www.404manual.com>

<http://www.luxmanual.com>

<http://aubethermostatmanual.com>

Golf course search by state

<http://golfingnear.com>

Email search by domain

<http://emailbydomain.com>

Auto manuals search

<http://auto.somanuals.com>

TV manuals search

<http://tv.somanuals.com>