

Installation Instructions / Warranty

Wallbar Sets

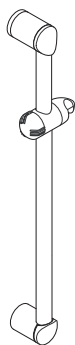

Unica'E
06890XX0

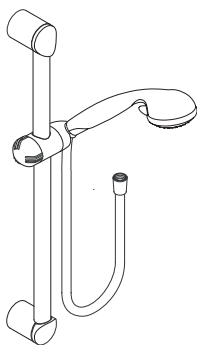

Cromo E 75 3-Jet
06494XX0
Cromo E 75 2-Jet
06496XX0

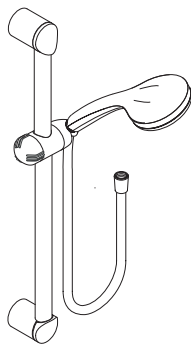

Monsoon II
04043XX0

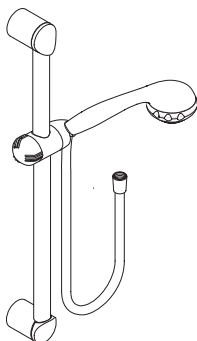

Clubmaster
04044XX0

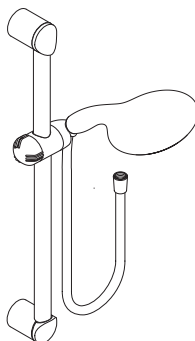

Rairdance E 120 3-Jet
04098XX0

hangrohe

Unica'E Wallbar

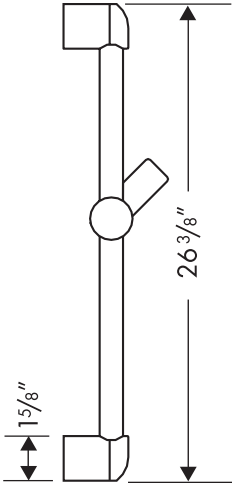

Follow the installation instructions (see page 4) when drilling the mounting holes.

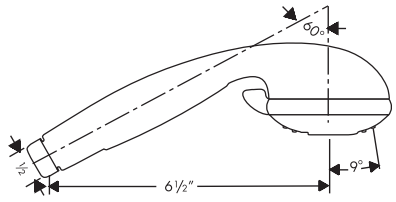

Cromo E 75 3-Jet
Cromo E 75 2-Jet

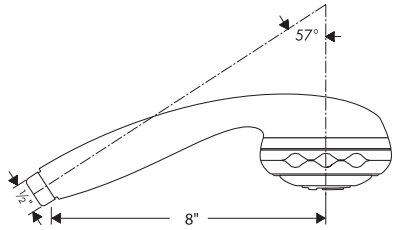

Clubmaster

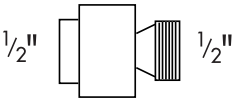

06510XX1 vacuum breaker - included with 04043XX1, 04044XX1, 04098XX1 only

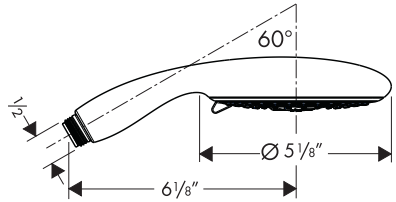

Raindance E 120 AIR 3-Jet

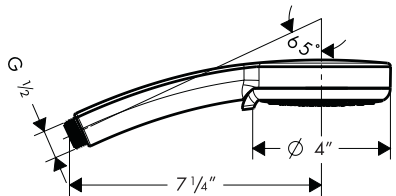

Monsoon II

Technical Information

Croma E 75 3-Jet handshower	2.5 gpm Full, massage, turbo massage
Croma E 75 2-Jet handshower	2.5 gpm Full, turbo massage
Clubmaster handshower	2.5 gpm Full, massage, soft aerated
Raindance E 120 AIR handshower	2.5 gpm AIR, Whirl AIR, Balance AIR
Monsoon II handshower	2.5 gpm Full, massage, turbo massage

Installation Considerations

- For best results, Hansgrohe recommends that this unit be installed by a licensed, professional plumber.
- Please read over these instructions thoroughly before beginning installation. Make sure that you have all tools and supplies needed to complete the installation.
- The screws and anchors included with this set are suitable for use in a tile or other solid surface wall. They are not suitable for use in an acrylic or fiberglass shower enclosure. Please contact the manufacturer of the enclosure regarding recommended mounting locations, reinforcement requirements, and mounting hardware.
- *This unit does not include a wall supply. Use Hansgrohe model 27458XX3 or another supply that complies with ASME A112.18.1/CSA B125.1 including ASME A112.18.3.*
- In Massachusetts, the maximum output temperature of the shower valve can be no higher than 112°F.

Wallbar installation

Remove the screw covers from the wallbar.

Position the wallbar in the desired location. Mark the positions of the screw holes (1).

Place the wallbar in a safe location.

Drill the holes with a 6 mm bit (2).



Do not drill into existing water lines!

(3) Install the anchors.



Seal the wall around the anchors with waterproof sealant.



Failure to seal the wall can lead to possible water damage.

Install the wallbar using the screws and washers.

Install the screw covers.

Install the soap dish (optional).

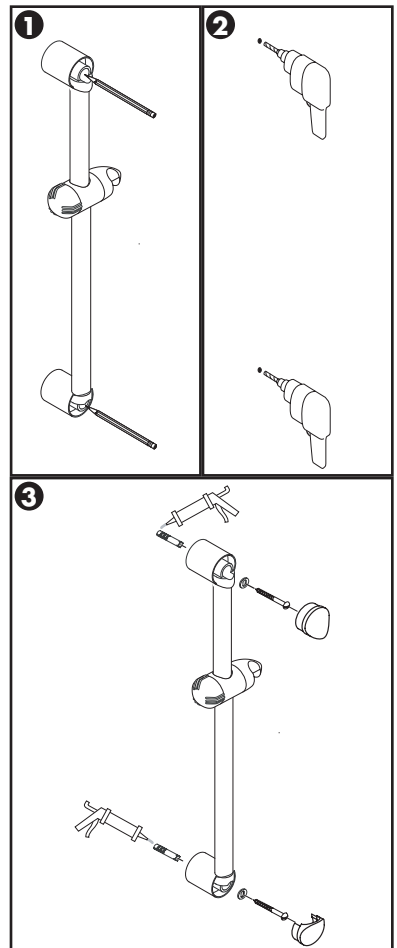

06494XX0/06496XX0 only:

Place a black rubber washer in one end of the handshower hose. Connect this end to the wall supply (not included).

Place a second washer in the other end of the hose. Connect this end to the handshower.

Rest the handshower in the holder.

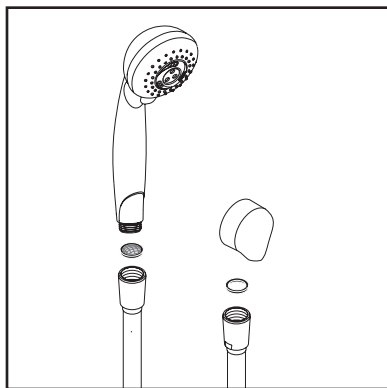

Install the vacuum breaker (Models 04043XX1/04044XX1/04098XX1 only)

Install the vacuum breaker and washer on the water supply.

Place a hose washer in one end of the hose. Connect this end of the hose to the vacuum breaker.

Place a second hose washer in the other end of the hose. Connect this end of the hose to the handshower.

Rest the handshower in the holder.

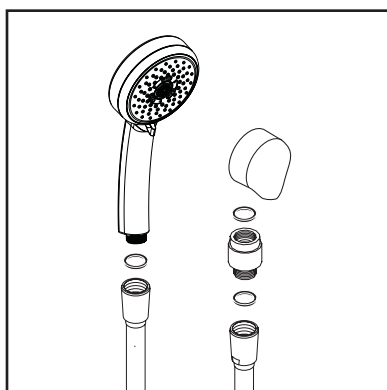

User Instructions

Do not remove the handshower by pulling "out" on it. This will damage the handshower holder.

To remove the handshower from the holder, pull "up" on it until the nut at the end of the handshower hose clears the holder, before pulling "out".

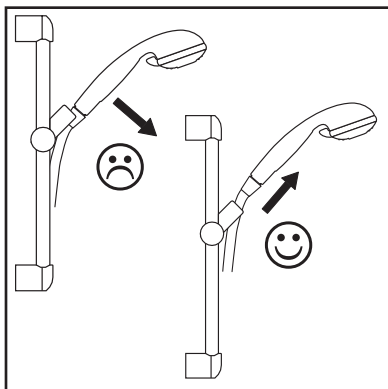

To move the slider up and down the bar, loosen the slider knob. Move the slider to the desired position. Tighten the knob.

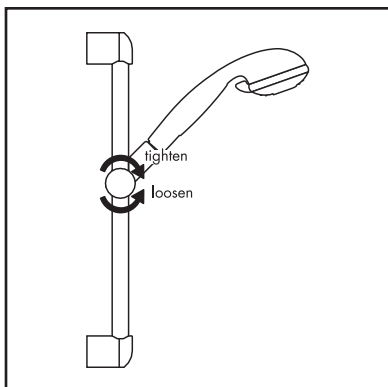

To change the angle of the handshower, use the handshower as a lever. Pull or push the handshower to the desired position.

The handshower holder will ratchet to six different positions.

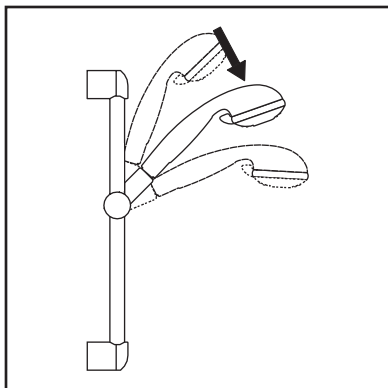

Handshower user instructions

Clubmaster only: Turn the function ring until the desired function is achieved.

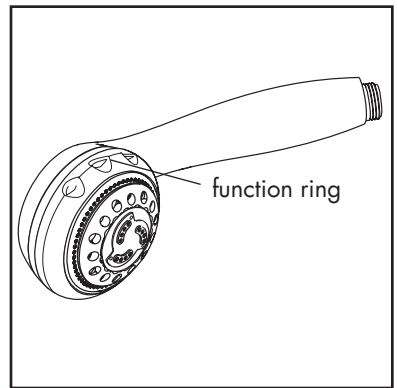

All other models: Push the function lever until the desired function is achieved

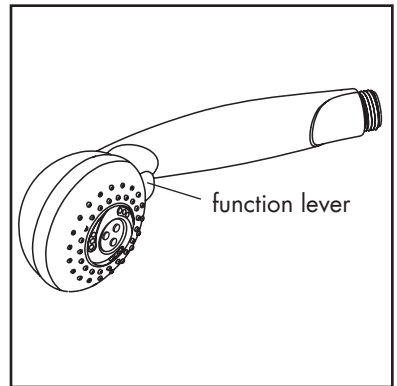

Scale Removal

This handshower incorporates the Quick Clean cleaning system. If scale deposits are noticed in the spray channels, turn the water on lightly and rub the spray channels with a finger or a sponge.

Clubmaster only: When the spray modes are changed, pins push deposits from the normal spray channels.

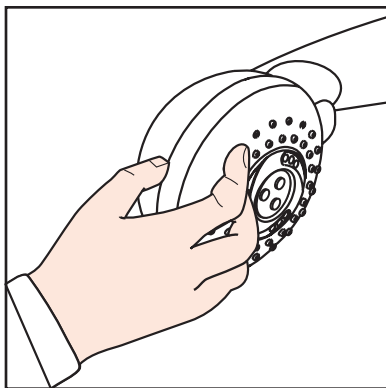

If scale deposits are noticed on the spray face, pour about 3/4" of a commercial scale remover, such as Lime-Away™ or CLR™, into a shallow dish. Dilute the remover according to the label instructions.

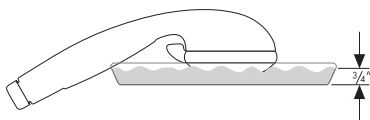

Soak only the spray face in the solution for the amount of time specified on the label.

Rinse the handshower with clear water.

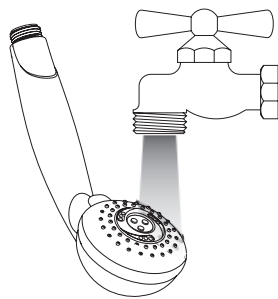

Reinstall the handshower. Turn on the water and allow the handshower to flush for at least one minute.

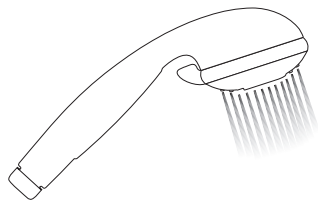

Replacement Parts

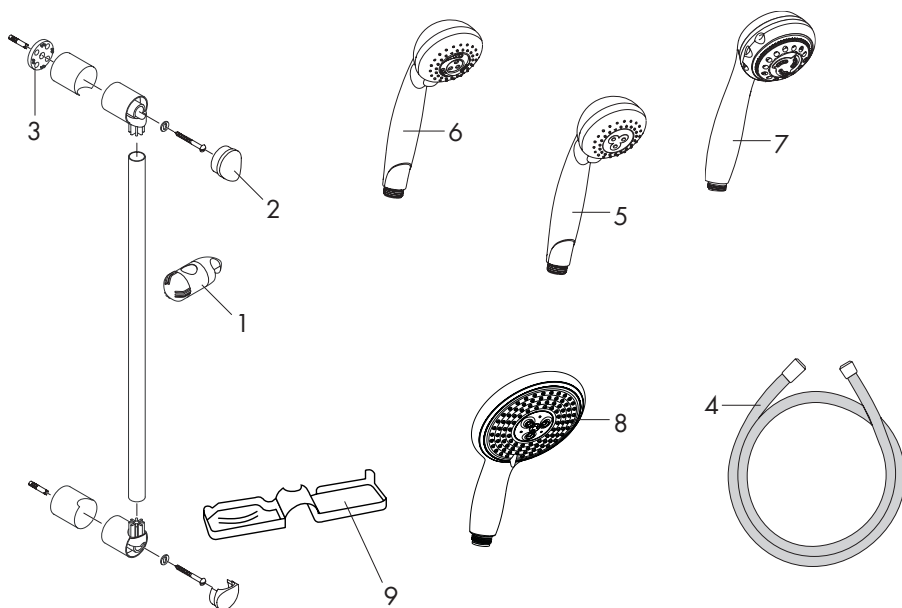

1	slider	88590XX0
2	screw cover	88534XX0
3	tile spacer (optional)	96184000
4	handshower hose, 63"	28276XX0
	handshower hose, 72"	88625XX0
5	Croma E 75 2-jet handshower	28570XX1
6	Croma E 75 3-jet handshower	28573XX1
7	Clubmaster handshower	28525XX1
8	Raindance E 120 3-jet handshower	28507XX1
9	soap dish	69007000
	hose washer	98058000

XX = color

00 = chrome

62 = oil rubbed bronze

82 = brushed nickel

83 = polished nickel

93 = polished brass

Cleaning Recommendation for Hansgrohe Products

Modern lavatory faucets, kitchen faucets, and showers consist of very different materials to comply with the needs of the market with regard to design and functionality. To avoid damage and returns, it is necessary to consider certain criteria when cleaning.

Cleaning Materials for Faucets and Showers

Acids are a necessary ingredient of cleaning materials for removing lime, however please pay attention to the following points when cleaning faucets and showers:

- Only use cleaning materials which are explicitly intended for this type of application.
- Never use cleaning materials which contain hydrochloric, formic, phosphoric, or acetic acid, as they cause considerable damage.
- Never mix one cleaning material with another.
- Never use cleaning materials or appliances with an abrasive effect, such as unsuitable cleaning powders, sponge pads, or micro fiber cloths.

Cleaning Instructions for Faucets and Showers

Please follow the cleaning material manufacturer's instructions. In addition, pay attention to the following points:

- Clean the faucets and showers as and when required
- Use the amount of cleaning product and the amount of time recommended by the manufacturer. Do not leave the cleaner on the fixture longer than necessary.
- Regular cleaning can prevent calcification.
- When using spray cleaners, spray first onto a soft cloth or sponge. Never spray directly onto the faucet as droplets can enter openings and gaps and cause damage.
- After cleaning, rinse thoroughly with clean water to remove any cleaner residue.

Important

Residues of liquid soaps, shampoos, and shower foams can also cause damage, so rinse with clean water after using.

Please note: if the surface is already damaged, the effect of cleaning materials will cause further damage.

Components with damaged surfaces must be replaced or injury could result.

Damage caused by improper treatment is not covered under the warranty.

Limited Lifetime Consumer Warranty

This product has been manufactured and tested to the highest quality standards by Hansgrohe, Inc. ("Hansgrohe"). This warranty is limited to Hansgrohe products which are purchased by a consumer in the United States after March 1, 1996, and installed in either the United States or Canada.

WHO IS COVERED BY THE WARRANTY

This warranty extends to the original consumer purchaser only. This warranty is non-transferable.

WHAT IS COVERED BY THE WARRANTY

This warranty covers only your Hansgrohe manufactured product. Hansgrohe warrants this product against defects in material or workmanship as follows: Hansgrohe will repair at no charge for parts only or, at its option, replace any product or part of the product that proves defective because of improper workmanship and/or material, under normal installation, use, service and maintenance. If Hansgrohe is unable to provide a replacement and repair is not practical or cannot be timely made, Hansgrohe may elect to refund the purchase price in exchange for the return of the product.

LENGTH OF WARRANTY

Replacement or repaired parts of products will be covered for the term of this warranty as stated in the following two sentences. If you are a consumer who purchased the product for use primarily for personal, family, or household purposes, this warranty extends for as long as you own the product and the home in which the product is originally installed. If you purchased the product for use primarily for any other purpose, including, without limitation, a commercial purpose, this warranty extends only (i) for 1 year, with respect to Hansgrohe and Commercial products, and (ii) for

5 years, with respect to AXOR products.

THIS WARRANTY DOES NOT COVER, AND HANSGROHE WILL NOT PAY FOR:

- A. Conditions, malfunctions or damage not resulting from defects in material or workmanship.
- B. Conditions, malfunctions or damage resulting from (1) normal wear and tear, improper installation, improper maintenance, misuse, abuse, negligence, accident or alteration, or (2) the use of abrasive or caustic cleaning agents or "no-rinse" cleaning products, or the use of the product in any manner contrary to the product instructions. (3) Conditions in the home such as excessive water pressure or corrosion.
- C. Labor or other expenses for the disconnection, deinstallation, or return of the product for warranty service, or for installation or reinstallation of the product (including but not limited to proper packaging and shipping costs), or for installation or reinstallation of the product.
- D. Accessories, connected materials and products, or related products not manufactured by Hansgrohe.

TO OBTAIN WARRANTY PARTS OR INFORMATION

Contact your Hansgrohe retailer, or contact Technical Service at:

Hansgrohe Inc.
1492 Bluegrass Lakes Parkway
Alpharetta GA 30004
Toll-free (800) 334-0455.

In requesting warranty service, you will need to provide

- 1. The sales receipt or other evidence of the date and place of purchase.
- 2. A description of the problem.
- 3. Delivery of the product or the defective part, postage prepaid and carefully packed and insured, to Hansgrohe Inc. 1492 Bluegrass Lakes Parkway, Alpharetta, Georgia 30004, Attention: Technical Service, if required by Hansgrohe.

When warranty service is completed, any repaired or replacement product or part will be returned to you postage prepaid.

EXCLUSIONS AND LIMITATIONS

REPAIR OR REPLACEMENT (OR, IN LIMITED CIRCUMSTANCES, REFUND OF THE PURCHASE PRICE) AS PROVIDED UNDER THIS WARRANTY IS THE EXCLUSIVE REMEDY OF THE PURCHASER. HANSGROHE NEITHER ASSUMES NOR AUTHORIZES ANY PERSON TO CREATE FOR IT ANY OBLIGATION OR LIABILITY IN CONNECTION WITH THIS PRODUCT.

HANSGROHE SHALL NOT BE LIABLE TO PURCHASER OR ANY PERSON FOR ANY INCIDENTAL, SPECIAL, OR CONSEQUENTIAL DAMAGES, ARISING OUT OF BREACH OF THIS WARRANTY OR ANY IMPLIED WARRANTY (INCLUDING MERCHANTABILITY).

Some States do not allow the exclusion or limitation of incidental or consequential damages, so the above limitation or exclusion may not apply to you. This warranty gives you specific legal rights, and you may have other rights which vary from State to State. You may be required by law to give us a reasonable opportunity to correct or cure any failure to comply before you can bring any action in court against us under the Magnuson-Moss Warranty Act.

PRODUCT INSTRUCTIONS AND QUESTIONS

Upon purchase or prior to installation, please carefully inspect your Hansgrohe product for any damage or visible defect. Prior to installing, always carefully study the enclosed instructions on the proper installation and the care and maintenance of the product. If you have questions at any time about the use, installation, or performance of your Hansgrohe product, or this warranty, please call or write to us or call us toll-free at 800 334 0455.

hansgrohe

Hansgrohe, Inc. • 1490 Bluegrass Lakes Parkway • Alpharetta, GA 30004
Tel. 770-360-9880 • Fax 770-360-9887

www.hansgrohe-usa.com

Free Manuals Download Website

<http://myh66.com>

<http://usermanuals.us>

<http://www.somanuals.com>

<http://www.4manuals.cc>

<http://www.manual-lib.com>

<http://www.404manual.com>

<http://www.luxmanual.com>

<http://aubethermostatmanual.com>

Golf course search by state

<http://golfingnear.com>

Email search by domain

<http://emailbydomain.com>

Auto manuals search

<http://auto.somanuals.com>

TV manuals search

<http://tv.somanuals.com>