



Features

- 150 mm LED ring light for low-angle illumination. See Banner's website at www.bannerengineering.com for a complete lighting tutorial.
- Uses 3 tiers of LEDs mounted at 75° to the optical axis.
- Low-angle light enhances contrast of surface defects, etching, and embossed marks.
- Well suited for dot-peened or pin-stamped data matrix marks.
- Solid-state LED light source.
- Continuous or strobed operation is selectable via sensor software.
- Black anodized aluminum housing with ¼ - 20 threaded mounting holes.
- The suggested field of view is 80 mm in diameter and the suggested stand off is 12.5 mm.

Models

Models*	Illumination	Color	Cable/Connector	Supply Voltage and Current
LEDRI150-3W	High-intensity, low-angle light	Visible Red 640 nm	3-conductor, 2 m (6.5') attached cable with flying leads (see wiring table)	24V dc ±10% @ 500 mA max.
LEDII150-3W		Infrared 880 nm		24V dc ±10% @ 350 mA max.
LEDRI150-3M		Visible Red 640 nm	2 m (6.5') pigtail with 3-pin, 8 mm male Pico-style connector (direct connection to PresencePLUS P4)	24V dc ±10% @ 500 mA max. Voltage supplied by PresencePLUS sensor, if operating at 24V dc (see sensor manual).
LEDII150-3M		Infrared 880 nm		24V dc ±10% @ 350 mA max. Voltage supplied by PresencePLUS sensor, if operating at 24V dc (see sensor manual).

*For 9 m (30') cable, add suffix "W30" to the model number (e.g., LEDRI150-3W W30).

Specifications

Useful Life	When operated within specification, output will decrease less than 20% after 20,000 hours and less than 30% after 30,000 hours. NOTE: Actual useful life of strobed lights depends on duty cycle.
Environmental Rating	IEC IP0; NEMA 0
Operating Conditions	Temperature: 0° to +50° C (+32° to 122° F) Maximum relative humidity: 90% at 50° C (non-condensing) max.
Cleaning Instructions	Regularly remove any dust and dirt from the light source. Blow off dust using anti-static compressed air.
Certifications	

LED..I150-3.. 3-Tier Low-Angle Ring Light (150 mm)

Dimensions

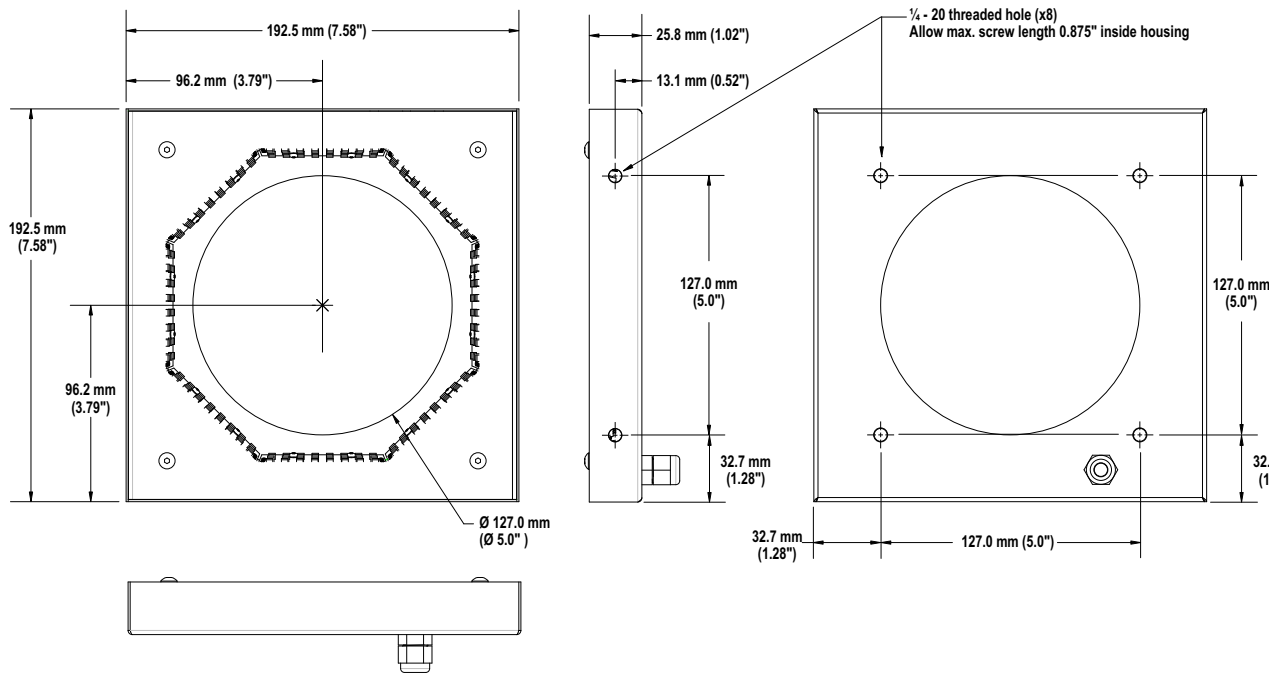

Wiring Table

LED..I150-3W Wire	PresencePLUS Pro Controller Terminal Block	External Power Supply (Strobed)	External Power Supply (Continuous)
Brown	Pin 1, +V (24V dc $\pm 10\%$)	+V	+V
Blue	Pin 2, -V (dc common)	-V	-V
Black	Pin 4 (strobe)	+5V dc OFF -V ON	-V



more sensors, more solutions

WARRANTY: Banner Engineering Corp. warrants its products to be free from defects for one year. Banner Engineering Corp. will repair or replace, free of charge, any product of its manufacture found to be defective at the time it is returned to the factory during the warranty period. This warranty does not cover damage or liability for the improper application of Banner products. This warranty is in lieu of any other warranty either expressed or implied.

Free Manuals Download Website

<http://myh66.com>

<http://usermanuals.us>

<http://www.somanuals.com>

<http://www.4manuals.cc>

<http://www.manual-lib.com>

<http://www.404manual.com>

<http://www.luxmanual.com>

<http://aubethermostatmanual.com>

Golf course search by state

<http://golfingnear.com>

Email search by domain

<http://emailbydomain.com>

Auto manuals search

<http://auto.somanuals.com>

TV manuals search

<http://tv.somanuals.com>