

# incognito **BK10**

---

A-BUS table-top keypad

Installation Guide



 *Cambridge Audio*



# BK10 Table-top keypad

## CONTENTS

Introduction.....	4
Configurations.....	5
A-BUS Ready / Incognito Ready.....	6
Full Incognito system.....	8
Installation notes.....	10
Rear panel connections.....	11
Keypad controls.....	12
Remote control.....	13
Operating instructions.....	14
Local source selection.....	16
Technical specifications.....	18
Limited warranty.....	19

## INTRODUCTION

**Thank you for purchasing this Cambridge Audio Incognito product. Incognito is a cost-effective, modular based multi-room system using standard Cat-5/5e or Cat-6 cable to distribute hi-fi quality sound and video around a home.**

The BK10 is an A-BUS™ compatible amplified keypad unit with buttons for control of speaker volume levels, Standby/On and source select (with compatible Cambridge Audio equipment), as well as having an IR window for both receiving remote control signals and passing them to connected source equipment (IR pass-through). The BK10 can connect to the Incognito Ready outputs of Cambridge Audio receivers and amplifiers, or A-BUS hubs and A-BUS Ready receivers from other manufacturers, using Cat-5 wiring. The BK10 then connects to speakers using conventional speaker cable.

Thanks for taking the time to read this manual, we do recommend you keep it for future reference.



Matthew Bramble  
Technical Director



The crossed-out wheeled bin is the European Union symbol for indicating separate collection for electrical and electronic equipment. This product contains electrical and electronic equipment which should be reused, recycled or recovered and should not be disposed of with unsorted regular waste. Please return the unit or contact the authorised dealer from whom you purchased this product for more information.

# BK10 Table-top keypad

## CONFIGURATIONS

The BK10 can be used in two types of configurations:

1. As an A-BUS Ready / Incognito Ready keypad attached directly to the back of an amplifier / receiver.
2. In a full A-BUS or Incognito Multi-Room system attached to a hub.

A-BUS Ready / Incognito Ready allows one or two keypads (and a PSU) to be simply connected to a hi-fi unit to allow a simple 2/3 zone multi-room system to be constructed.

Alternatively when a dedicated A-BUS hub is used the system has many more options available such as sub-zones, local inputs and video switching.

Please see [www.cambridge-audio.com](http://www.cambridge-audio.com) for more details.

For both possibilities, as the BK10 is compatible with the A-BUS™ standard, the unit works with any manufacturers A-BUS compatible products, however source selection from the keypad is only possible with Cambridge Audio's own Incognito A-BUS system or Incognito Ready outputs on Cambridge Audio hi-fi units.

## A-BUS READY / INCOGNITO READY

In this configuration the keypad is connected directly to the amplifier/receiver. A power supply unit (Incognito PS5) is also required to power the one or two keypads. Refer to the diagrams for system connection details:

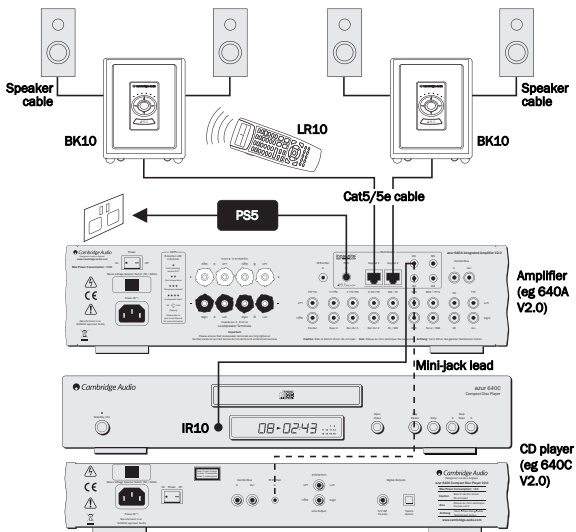

## BK10 Table-top keypad

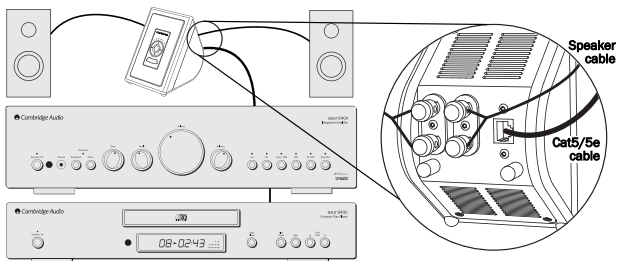

The BK10 comes with 10 metres of Cat5 connection cable, but an Incognito CP20 cable pack (with 20 metres of cable, 2 x 3.5-3.5 connection cables and a punch-down/wire stripper tool) can be purchased separately.

To allow control of your source equipment from the remote rooms an IR emitter (IR10) is plugged into one of the IR outputs on the rear of the unit and then attached over the IR window of the source unit. Alternatively, on our own products that feature IR emitter Inputs, a mini-jack to mini-jack lead can be used.

Commands received by the keypads can now be sent back to the source equipment via the amplifier. It is then possible to control the source equipment from the remote rooms by using the source equipment's own remote controls or through a learning remote. The Incognito LR10 Learning Remote can fully control the keypads, "learn" the source's remote controls and change source input on the amplifier etc.

## FULL INCOGNITO SYSTEM

The BK10 keypad can also be used as part of a full Incognito system, where it is plugged into an Incognito hub (AH10), perhaps with other Incognito accessories such as a video switching unit (VH10) or local input module (LM10) fitted. See the diagram below for an example of an Incognito system.

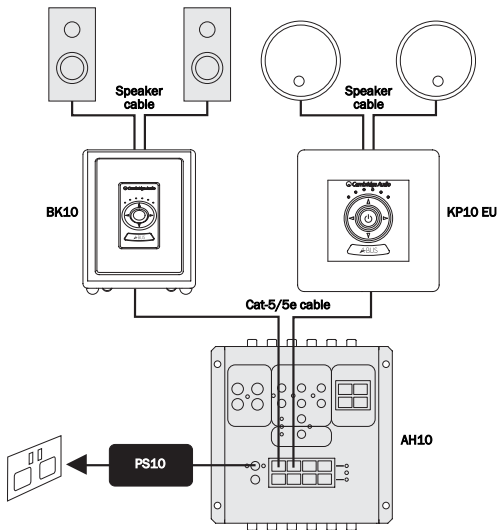



# BK10 Table-top keypad

**Note:** When using a BK10 keypad with an AH10 hub, an Incognito PS10 power supply unit **MUST** be used.

**Please consult the AH10 Incognito Multi-Room Installation Guide for full details of the various options available for the full Incognito system.**

**IMPORTANT! The BK10 is default set to the A-BUS Ready/Incognito Ready configuration. For use in a full Incognito system, the mode switch (located inside the keypad block) must be set to the alternative "AH10" mode.**

Use a screw driver to carefully remove the backplate and set the mode switch to the "AH10" position as shown below:

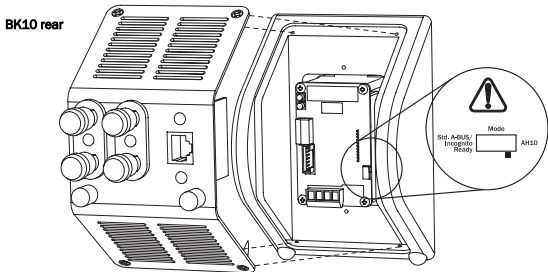

**Note:** Setting the mode switch to the wrong setting can cause erroneous operation!

## INSTALLATION NOTES

Avoid placing the keypad where there is line of sight to another keypad. In such situations both keypads may pick up the same commands from a remote control and it will be difficult to control each zone independently.

Avoid placing the BK10 where there is line of sight to the source equipment for the system. In such situations the source equipment may pick up the same IR commands directly as are picked up by the keypad and sent to the source equipment. This can interfere with the remote operation of the source equipment.

Do not place the keypad in areas directly lit by strong sunlight or where it will be strongly lit by fluorescent tubes. These can be sources of infra-red energy which can interfere with the remote control operation of the system. Some plasma televisions can radiate a lot of infra-red energy and care should be taken if fitting a BK10 near a plasma screen television. Avoid placing the BK10 near to dimmer switches or other items, which generate a lot of electrical noise.

## Safety precautions

The BK10 runs on 24V DC supplied through the connecting cable. As such there is no mains voltage present in the BK10 and the unit is often safe to place in areas where only extra low voltage (ELV) equipment is permitted. However, it is imperative that you always check the wiring regulations in force for your application and area.

# BK10 Table-top keypad

## REAR PANEL CONNECTIONS

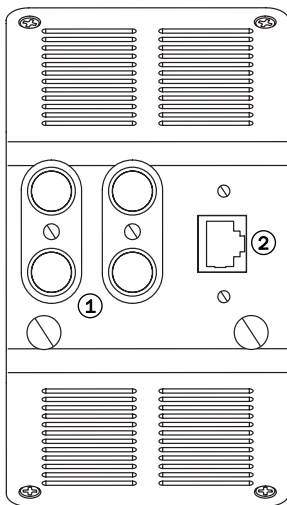

### ① Speaker output

Connect to a pair of speakers with two runs of standard high-quality speaker cable. Speakers of at least 88 dB SPL for 1W @ 1 metre efficiency should be used with the BK10. Speakers from 4-8 ohms can be used.

### ② Cat5 to BK10

A Cat-5 cable (terminated with an RJ45 jack plug) is used to connect the BK10 to an AH10 hub or A-BUS Ready receiver.

## KEYPAD CONTROLS

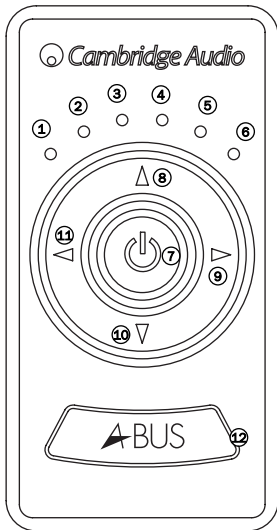

① - ⑥ The six LEDs indicate the volume level of the BK10. The LEDs also also display the source selected when the source is changed and can also show the status of some other functions. For full instructions on volume adjustment, source selection, sound adjustment and local source selection modes, refer to the 'Operating instructions' section of this guide.

### ⑦ Standby/On

Press to switch the keypad between On and Standby mode. By pressing and holding the Standby button for about 2 seconds, all BK10s connected to the AH10 hub will be turned off. If the BK10 is connected to a Cambridge Audio Incognito Ready Amplifier rather than an AH10 hub, the amplifier will be turned off.

### ⑧ Volume up

Press to increase the volume or other sound adjustment.

### ⑨ Source select (right)

Use this key to select the current active source.

# BK10 Table-top keypad

## ⑩ Volume down

Press to decrease the volume or other sound adjustment.

## ⑪ Source select (left)

Use this key to select the current active source.

## ⑫ IR window

Point the Incognito LR10 Learning Remote towards this window. A small flashing LED behind this window indicates operation.

## REMOTE CONTROL

The BK10 can be used with the Incognito LR10 remote control, a sophisticated learning remote which is able to learn the codes of all the source equipment remotes. Once programmed the user can thus use the LR10 to perform all operations from one remote.

The LR10 is also suitable where the BK10 is to be connected to the A-BUS Ready outputs of AV receivers and amplifiers instead of one of our hubs as it can learn the relevant source change commands etc of the receiver or amplifier as well as the source equipment.

***Please refer to the Incognito LR10 manual for further information.***

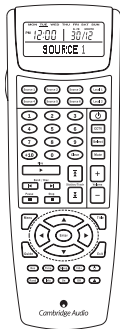

## OPERATING INSTRUCTIONS

### Volume adjustment

Volume is adjusted using the volume up and volume down buttons on the keypad or remote; this is indicated on the keypad by the intensity of the blue LED lights, there are four levels of intensity per LED.

### Source selection

The Source left and right buttons allow you to choose from multiple connected sources. The LED display will indicate which source is selected.

### Sound adjustment modes

Pressing the Power/Standby button while holding the Volume down key activates the sound adjustment modes, the four central LEDs on the keypad will then light in sequence to indicate each of the four sound adjustment modes in turn; Bass, Treble, Balance and Fader. These modes can also be activated using the 'Select' button on the remote control.

After holding both buttons down for a short period, the second LED on the keypad will light indicating that **Bass adjust mode** has been activated. In this mode pressing the Volume up/down keys will adjust the Bass (low frequencies) level.

Continuing to hold both keys down will light the third LED indicating that **Treble adjust mode** has been activated. In this mode pressing the Volume up/down keys will adjust the Treble (high frequencies) level.

# BK10 Table-top keypad

Continuing to hold both buttons will light the fourth LED indicating that **Balance adjust mode** has been activated. In this mode pressing the Volume up/down keys will adjust the sound level between the left and right speakers.

Continuing to hold both buttons will light the fifth LED indicating that **Fader adjust mode** has been activated. In this mode pressing the Volume up/down keys will adjust the balance between the main speakers and the pre-amp output. The pre-amp output is on the rear of the KP10 and not accessible from the back of the BK10.

The volume up and down buttons on the remote control can also be used to adjust the sound in each mode.

**Note:** If no adjustment is made the system will automatically go back to volume adjustment after two seconds.

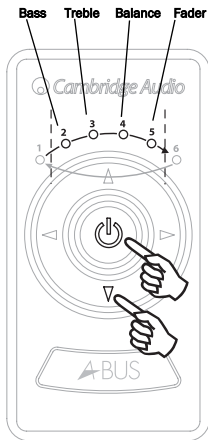

## LOCAL SOURCE SELECTION

**Note:** This feature is only available if the BK10 is part of a full Incognito multi-room system with one or two Local Input Modules (LM10) fitted.

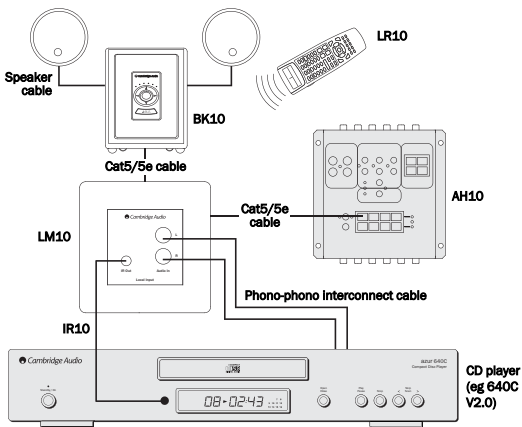

The local source selection mode will need to be activated to configure the BK10 correctly. This mode is only available when the Mode Switch is set to "AH10" mode. LM10s can only be used with an AH10 hub.

**Please refer to your LM10 Installation Guide for more information.**



## BK10 Table-top keypad

Pressing the Select left or right buttons on the keypad allows you to rotate through all six sources as default. However, it is possible to allow the addition of one or two local sources by accessing **Local source selection mode**. To enter this mode press the Volume up button simultaneously with the Power button for four seconds; the LED display will then scroll through the sequence shown in the illustration and described as follows:

After holding both buttons down for a short period, LED 2 will light indicating that **Sources 1-6** (default) are available for selection.

Continuing to hold both keys down will light LED 3 indicating that **Sources 1-6 + Local source 1 mode** is available for selection.

Continuing to hold both buttons will light LED 4 - indicating that **Sources 1-6 + Local source 1 + Local source 2 mode** is available for selection.

Continuing to hold Volume up and Power buttons will light LED 5, to indicate that **Off mode** is available for selection, and no source will be selected.

To select these modes, wait till the corresponding LED is lit and then release Power and Volume up buttons.

**Note:** If no adjustment is made the system will automatically go back to volume adjustment after two seconds. If "Standard A-BUS/Incognito Ready" mode is selected on the Mode switch, the BK10 will only rotate round the main 6 sources.

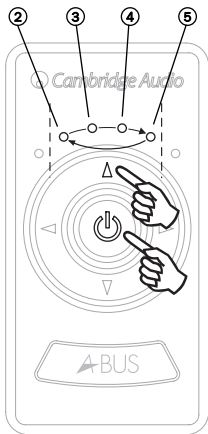

## TECHNICAL SPECIFICATIONS

<b>Input impedance</b>	45 k ohms
<b>Frequency response</b>	20Hz – 20kHz +/- 1dB
<b>THD</b>	<0.2% @ 1W, 20Hz – 20 kHz
<b>S/N ratio</b>	> 80 dB 'A' weighted
<b>Volume control range</b>	-80 dB, 36 steps
<b>Bass control range</b>	+/- 16 dB, 2 dB steps
<b>Treble control range</b>	+/- 16 dB, 2 dB steps
<b>Balance control range</b>	+/- 40 dB, 9 steps either way
<b>Preamp output</b>	Variable level, follows volume setting
<b>IR pass through</b>	34 – 40 kHz and 54 – 58 kHz modulation frequencies supported
<b>Speaker impedance</b>	4–8 ohms
<b>Power requirement</b>	24 V DC @ 1A max (supplied by hub)

This guide is designed to make installing and using this product as easy as possible. Information in this document has been carefully checked for accuracy at the time of printing; however, Cambridge Audio's policy is one of continuous improvement, therefore design and specifications are subject to change without prior notice. If you notice any errors please feel free to email us at: [support@cambridgeaudio.com](mailto:support@cambridgeaudio.com)

This document contains proprietary information protected by copyright. All rights are reserved. No part of this manual may be reproduced by any mechanical, electronic or other means, in any form, without prior written permission of the manufacturer. All trademarks and registered trademarks are the property of their respective owners.

Incognito and Incognito Ready are trademarks of Cambridge Audio Ltd. All rights reserved.

© Copyright Cambridge Audio Ltd 2006

A-BUS and A-BUS Ready are registered trademarks of LeisureTech Electronics Pty Ltd Australia.

# BK10 Table-top keypad

## LIMITED WARRANTY

Cambridge Audio warrants this product to be free from defects in materials and workmanship (subject to the terms set forth below). Cambridge Audio will repair or replace (at Cambridge Audio's option) this product or any defective parts in this product. Warranty periods may vary from country to country. If in doubt consult your dealer and ensure that you retain proof of purchase.

To obtain warranty service, please contact the Cambridge Audio authorised dealer from which you purchased this product. If your dealer is not equipped to perform the repair of your Cambridge Audio product, it can be returned by your dealer to Cambridge Audio or an authorised Cambridge Audio service agent. You will need to ship this product in either its original packaging or packaging affording an equal degree of protection.

Proof of purchase in the form of a bill of sale or receipted invoice, which is evidence that this product is within the warranty period, must be presented to obtain warranty service.

This warranty is invalid if (a) the factory-applied serial number has been altered or removed from this product or (b) this product was not purchased from a Cambridge Audio authorised dealer. You may call Cambridge Audio or your local country Cambridge Audio distributor to confirm that you have an unaltered serial number and/or you purchased from a Cambridge Audio authorised dealer.

This warranty does not cover cosmetic damage or damage due to acts of God, accident, misuse, abuse, negligence, commercial use, or modification of, or to any part of, the product. This warranty does not cover damage due to improper operation, maintenance or installation, or attempted repair by anyone other than Cambridge Audio or a Cambridge Audio dealer, or authorised service agent which is authorised to do Cambridge Audio warranty work. Any unauthorised repairs will void this warranty. This warranty does not cover products sold AS IS or WITH ALL FAULTS.

REPAIRS OR REPLACEMENTS AS PROVIDED UNDER THIS WARRANTY ARE THE EXCLUSIVE REMEDY OF THE CONSUMER. CAMBRIDGE AUDIO SHALL NOT BE LIABLE FOR ANY INCIDENTAL OR CONSEQUENTIAL DAMAGES FOR BREACH OF ANY EXPRESS OR IMPLIED WARRANTY IN THIS PRODUCT. EXCEPT TO THE EXTENT PROHIBITED BY LAW, THIS WARRANTY IS EXCLUSIVE AND IN LIEU OF ALL OTHER EXPRESS AND IMPLIED WARRANTIES WHATSOEVER INCLUDING, BUT NOT LIMITED TO, THE WARRANTY OF MERCHANTABILITY AND FITNESS FOR A PRACTICAL PURPOSE.

Some countries and US states do not allow the exclusion or limitation of incidental or consequential damages or implied warranties so the above exclusions may not apply to you. This warranty gives you specific legal rights, and you may have other statutory rights, which vary from state to state or country to country.

 *Cambridge Audio*

**Incognito BK10**



[www.cambridge-audio.com](http://www.cambridge-audio.com)

Part No. AP19601/1

Download from [Www.Somanuals.com](http://Www.Somanuals.com). All Manuals Search And Download.

## Free Manuals Download Website

<http://myh66.com>

<http://usermanuals.us>

<http://www.somanuals.com>

<http://www.4manuals.cc>

<http://www.manual-lib.com>

<http://www.404manual.com>

<http://www.luxmanual.com>

<http://aubethermostatmanual.com>

Golf course search by state

<http://golfingnear.com>

Email search by domain

<http://emailbydomain.com>

Auto manuals search

<http://auto.somanuals.com>

TV manuals search

<http://tv.somanuals.com>