

SMT Power Inductor

SISN63 Type

Features

- RoHS compliant.
- Low profile (4.0mm max. height), SMD type.
- Unshielded, suitable for high density mounting.
- High energy storage and low DCR.
- Provided with embossed carrier tape packing.
- Ideal for power source circuits, DC-DC converter, DC-AC inverters inductor application.
- In addition to the standard versions shown here, customized inductors are available to meet your exact requirements.

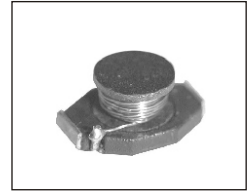

Mechanical Dimension:

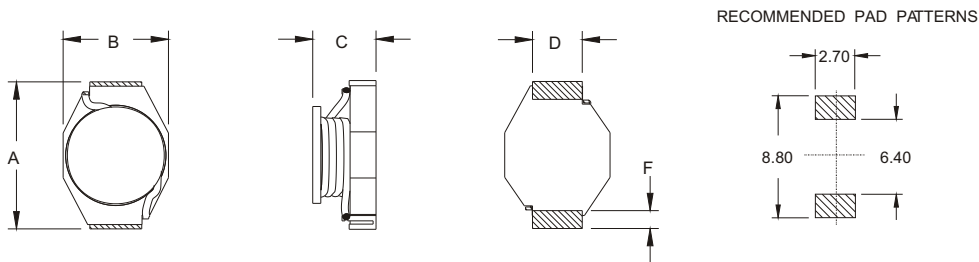

UNIT:mm/inch
 A = 8.60 ± 0.254 / 0.339 ± 0.010
 B = 5.84 ± 0.254 / 0.230 ± 0.010
 C = 4.00 / 0.157 Max.
 D = 2.50 ± 0.254 / 0.098 ± 0.010
 E = 1.50 ± 0.30 / 0.059 ± 0.012
 F = 0.80 / 0.032 (REF)

Electrical Characteristics: 25°C: 100KHz, 0.1V

PART NO.	L ¹ (uH)	DCR (Ω)MAX	Isat ² (Adc)
SISN63-0R5	0.6	0.010	7.50
SISN63-1R0	1.0	0.017	5.00
SISN63-2R2	2.2	0.035	3.20
SISN63-3R3	3.3	0.038	3.20
SISN63-4R0	4.0	0.040	3.00
SISN63-4R7	4.7	0.054	2.30
SISN63-100	10.0	0.111	1.60
SISN63-150	15.0	0.170	1.30
SISN63-220	22.0	0.250	1.00
SISN63-330	33.0	0.350	0.90
SISN63-470	47.0	0.470	0.75

1. Tolerance of inductance : ±20%.
2. Isat is the DC current which cause the inductance drop less than 10% of its nominal inductance without current.
3. Operating temperature: -20°C to 105°C (including self-temperature rise).



DELTA ELECTRONICS, INC.

(TAOYUAN PLANT CPBG) 252, SAN YING ROAD, KUEISAN INDUSTRIAL ZONE, TAOYUAN SHIEN, 333, TAIWAN, R.O.C.

TEL: 886-3-3591968; FAX: 886-3-3591991

<http://www.deltaww.com>

Free Manuals Download Website

<http://myh66.com>

<http://usermanuals.us>

<http://www.somanuals.com>

<http://www.4manuals.cc>

<http://www.manual-lib.com>

<http://www.404manual.com>

<http://www.luxmanual.com>

<http://aubethermostatmanual.com>

Golf course search by state

<http://golfingnear.com>

Email search by domain

<http://emailbydomain.com>

Auto manuals search

<http://auto.somanuals.com>

TV manuals search

<http://tv.somanuals.com>