

# Through Hole Couple Inductor

## TDHCB Type

### Features

- RoHS compliant.
- Low profile, SMD type.
- High current.
- Magnetic shielded.
- High energy storage and low DCR.
- Provided with embossed carrier tape packing.
- Ideal for power source circuits, DC-DC converter, DC-AC inverters inductor applications.
- In addition to the standard versions shown here, customized inductors are available to meet your exact requirements.

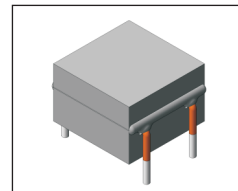

### Mechanical Dimension :

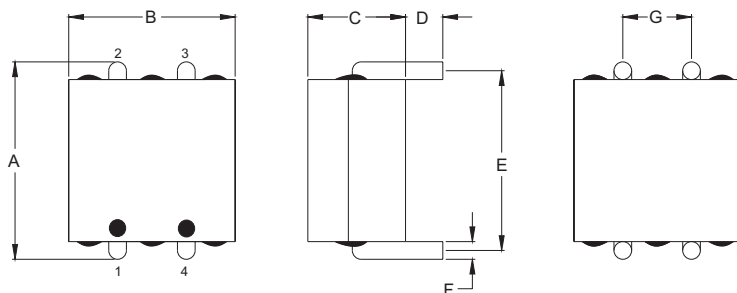

UNIT : mm

SERIES	A	B	C	D	E	R	G
TDHCB1385B	14.5 Max.	13.5 Max.	8.5 Max.	3.5 ± 0.5	13.0 ± 0.5	1.0	4.80
TDHCB1590B	17.5 Max.	14.0 Max.	9.0 Max.	2.5 ± 0.5	15.5 ± 0.5	1.0	5.05

### Electrical Characteristics : At 25°C: 100KHz, 1V

PART NO.	L <sup>1</sup> (nH)	L @ Isat1 (nH)	2 * Lk <sup>2</sup> (nH)	DCR (mΩ) MAX	Isat <sup>3</sup> (A dc)
TDHCB1385B-0R3	300±20%	240±20%	200±20%	0.47±20%	60
TDHCB1590B-R45	450±20%	360±20%	300±20%	0.54±20%	55

1. L is the inductance of each phase (1-2 @ 4,3 open or 4-3 @ 1,2 open) @100KHz, 1V, 25°C.
2. 2\*Lk is two times of leakage inductance (1-4 @ 2,3 short)
3. Isat1 is the DC current which cause the L drop to L @ Isat1.
4. Operating temperature : -40°C to 125°C ( including self-temperature rise ).



DELTA ELECTRONICS, INC.

(TAOYUAN PLANT CPBG) 252, SAN YING ROAD, KUEISAN INDUSTRIAL ZONE, TAOYUAN SHIEN, 333, TAIWAN, R.O.C.

TEL: 886-3-3591968; FAX: 886-3-3591991

<http://www.deltawww.com>

## Free Manuals Download Website

<http://myh66.com>

<http://usermanuals.us>

<http://www.somanuals.com>

<http://www.4manuals.cc>

<http://www.manual-lib.com>

<http://www.404manual.com>

<http://www.luxmanual.com>

<http://aubethermostatmanual.com>

Golf course search by state

<http://golfingnear.com>

Email search by domain

<http://emailbydomain.com>

Auto manuals search

<http://auto.somanuals.com>

TV manuals search

<http://tv.somanuals.com>