

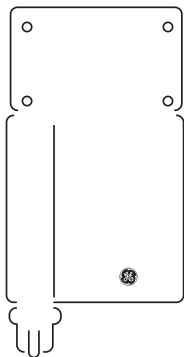

Wireless Alarm System

Garage Door Sensor

User's Manual



Control all Sensors

& accessories from
one location

Table of Contents

Important Safeguards	4
Introduction	5
Installation	6
Assigning a Sensor to a Zone	7-8
Erasing a Sensor from a Zone	8-9
Testing a Sensor or your system	9-10
Low battery indicator	10
Battery warnings	11
F.A.Q.'S	12-13
FCC Warning	14

Before connecting or operating the Garage Door Sensor, please read these instructions carefully and save this manual for future reference.

Congratulations

The GE Choice Alert™ Wireless Alarm System is one of the most affordable and expandable wireless alarm systems available. You'll discover that the system offers many features typically found in custom installed Alarm systems.

The Choice Alert system is reliable and easy-to-use. With Choice Alert you can select from a line of Sensors and Accessories; start small and expand as you need, or create a system that meets all your needs. The Choice Alert System is protected by Priority Code Selection technology which provides increased security and trouble-free wireless connections. It also guarantees the Control Center will only respond to signals from your Sensors in and around your home, and prevents anyone from tampering with your system.

The user manual explains in simple steps how to install, use and care for your new Choice Alert Garage Door Sensor.

If you have any questions or would like additional information please visit our web site www.jascopeproducts.com, or contact our Customer Service Group at 1-800-654-8483.

Important safeguards

PreCautions

- 1.** Do not attempt to disassemble the Garage Door Sensor, unless described in the user's manual. There are no user serviceable parts.
- 2.** Handle with Care – Avoid striking or shaking. Improper use or storage could damage the Garage Door Sensor. Modifying or tampering the device or its internal components can cause a malfunction and void the Garage Door Sensor's warranty.
- 3.** If you feel the Garage Door Sensor or any part of the Choice Alert system is not operating correctly or as described, please contact Customer Service for assistance **(1-800-654-8483)**.

Introduction

The Garage Door Sensor is designed to be used specifically with vertical opening garage or shed doors. When mounted properly it monitors when the door is open or closed. If the door is opened, the Garage Door Sensor will transmit a signal to the Control Center. The settings on the Control Center determine if an alarm, alert or chime sounds.

Parts Check List

Identify all the parts before proceeding.

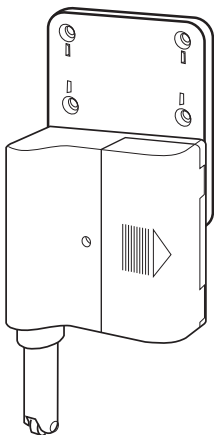

Garage Door Sensor
with mounting bracket

4 Screws



Double sided tape

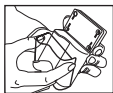
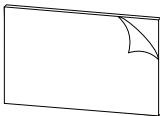

Make sure you take the
cover off before installing

Preparing the Garage Door Sensor for Installation

The Garage Door Sensor is a self-contained Sensor. Before installing open the battery door and, remove the yellow battery isolation tape from the Garage Door Sensor. This activates the Lithium battery inside the Garage Door Sensor. The approximate battery life is up to two years. When replacing the battery it is recommended to replace all Sensor batteries at the same time in order ensure proper operation of the entire system.

Note: When using doublesided tape apply to clean dry surface.

The Garage Door Sensor is intended to be positioned on the interior side of the garage door at the bottom. The Garage Door Sensor must be mounted vertically so the detection cylinder is able to move freely up and

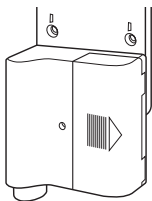

Closed

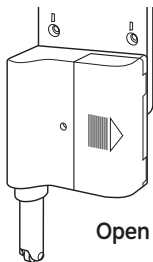

Open

down. Select a position on the garage door frame near bottom edge. To not damage the Garage Door Sensor when the door closes, position the Garage Door Sensor with the detection rod retracted and the
load from www.Somanuals.com. All Manuals Search And Down

bottom edge of the Garage Door Sensor even with the door edge. In most applications you can use double sided tape (included). It is strongly suggested to mount Garage Door Sensor lightly to ensure operation. Once you are confident with the mounting position apply pressure to secure to surface. For a more secure installation you can use the included screws.

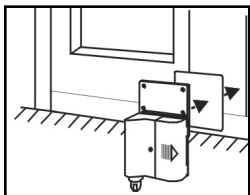

with tape

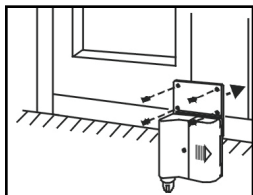

with screws

Once the Garage Door Sensor is mounted, you'll need to assign the Garage Door Sensor to a Zone on the Control Center.

Assigning the Sensor to a Zone

Assigning the Sensor into a Zone is an easy four step process, however there are a few points to remember

- Only one Sensor can be assigned at a time.
- A Sensor cannot be assigned to two different Zones.
- Up to four Sensors can be added per Zone (if a fifth Sensor is added then the first Sensor will be replaced.)
- Batteries must be active in the Sensor before it can be assigned to a Zone.
- Sensors can be assigned to a Zone and then mounted, or can be mounted and then assign to a Zone.

Follow these steps to assign a Sensor to a Zone.

Step 1 – Press and hold the Learn button on the Control Center for three seconds. When the Control Center sounds a long beep, release the Learn button.

Step 2 – Press the Zone button (1, 2, 3 or 4) for the Zone you want to assign to the Garage Door Sensor. The LED indicator for that Zone will begin to flash.

Step 3 – Release the Zone button.

Note: Zone 4 is for dedicated alerts only. Sensors in this Zone will not trigger an alarm or chime.

Step 4 – Activate the Garage Door Sensor

- To activate The Garage Door Sensor, lower the detection rod to its full extension; if mounted, raise the garage door.

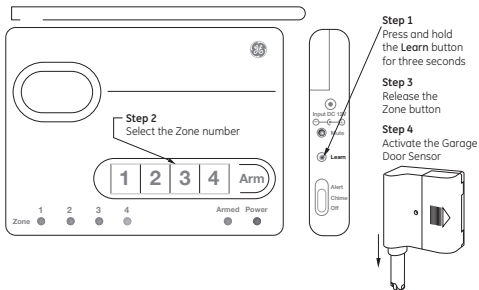

Erasing the Sensor from a Zone

Note: If you need to remove the Sensor from a Zone, the system will erase the entire Zone, so any other Sensors will need to be put back into that particular Zone.

Step 1 - To erase a Zone, press and hold the

Learn button on the Control Center. The unit will beep once.

Step 2 - While holding the Learn button, press and hold the Zone button to be erased. After five seconds the Control Center will sound two beeps and the Zone LED indicator will flash twice.

Step 3 - Release all buttons. The Zone has been erased.

Note: The Zone/Garage Door Sensor cannot be erased if:

- The Zone has been triggered for an Alert or alarm. The Sensor/Zone must be reset.
- There is loss of signal from the Sensor to the Control Center (such as low battery, or Sensor is out of range).
- The system is armed.

The Control Center will sound three beeps to indicate it could not erase the Zone.

Testing a Sensor or your system

Once all the Sensors have been assigned to Zones in the Control Center you can now test your system. Ensure the Control Center can receive the signal from the intended location of the Sensor before permanently mounting a Sensor.

Step 1 - To place Control Center in Test mode unplug AC adapter and remove batteries.

Step 2 - Press and hold the 'Mute' button and plug the AC adapter back into the Control Center. When all the LED indicators turn on, release the Mute button. The Control Center is now in Test Mode and any Sensor can now be tested in any Zone.

Step 3 - Set the Notification Mode to switch 'Alert' position and begin activating Sensors one at a time.

Note: The sensor has a LED that flashes to show when the sensor has triggered and transmitted to the main unit.

Step 4 - When testing is complete, unplug the AC adapter, then plug the AC adapter back in and reinstall batteries. This returns the Control Center to standard operation mode.

Note: The Control Center will automatically return to standard operation mode after 5 hours.

Low Battery Indicator

The Control Center continuously monitors all the Sensors. If the Control Center does not receive a signal from any Sensor it will begin rapidly flashing the Zone LED indicator . This indicates one or more Sensors in the Zone may have low battery power and are unable to transmit a signal the necessary distance. **If all batteries and/or Sensors are installed at the same time into a Zone, it is recommended to replace the batteries in all Sensors in the Zone.**

However, you can check the Garage Door Sensor status independently by placing the Control Center in Test mode (see Testing a Sensor on page 9) and trigger the Sensor separately (i.e. open garage door). If the Sensor does not trigger an alert then replace the battery with a new one. Additionally, the red LED on the Sensor will flash when the Sensor is triggered.

Note: The Sensor detection system is 'range dependant', which means Sensors located closer to the Control Center may seem to have batteries that last longer than those Sensors at a greater distance. The Lithium cell battery in the Garage Door Sensor can last up to two years.

Model #	Description	Battery Type	Battery Life*
45129	Control Center	(4) "AAA"	24 months
45130	Garage Sensor	(1) "2032"	24 months

*maximum potential life based upon usage and location

WARNING!

Risk of personal injury

- Prolonged exposure to alarm siren may cause permanent hearing loss

Battery Warning!

- Remove batteries before storing the Alarm or Sensor for extended periods
- Batteries may leak harmful liquids or ignitable materials or explode causing injury and product damage
- Do not mix old and new or other battery types
- Replace all batteries at the same time
- Replace fully discharged batteries immediately

Garage Door Sensor F.A.Q.'S

Q. I bought a new Sensor and the Control Center will not recognize it. Why?

A. First, make sure that the yellow battery isolation tape has been removed and that the battery is new. Second, ensure the battery is inserted into the Sensor according to polarity(+/-) markings. Third, confirm that the Sensor has been correctly assigned to a Zone.

Q. I put the Sensor on Zone 4 and it will not set off the alarm. Why?

A. Zone 4 is a Dedicated Alert Zone and is designed to monitor Sensors in this Zone. It will only issue an alert (LED will flash, continuous beeping will be heard). Sensors in Zone 4 will not set off the alarm. Use Zone 4 for water Sensors, garage doors, gates, sheds or other areas that you want to monitor (i.e. areas that you want to be alerted if there is a problem, but do not want the alarm to sound).

Q. I erased a Sensor from a Zone and now all of my other Sensors in that Zone will not work. Why?

A. The system can only erase entire Zones. You will need to add the other Sensors back in that Zone to the Control Center again.

Q. Why does one of my Zones continually flash?

A. This can be caused by 1 of 2 conditions. First condition, if it is a rapid flash it means a Sensor in the Zone has a low battery. If more than one Sensor is in a Zone, you will need to test each Sensor by putting the unit into test mode (see pg. 9 of this manual). It may also be that a Sensor is out of range and cannot make contact with the Control Center. If this is the case, you may need to move the Control Center closer or use a Signal Repeater. The second condition, if it is a slow flash, one of the Sensors is triggered. Check to ensure the Sensors in the Zone are closed/reset (i.e. close door, window, etc).

Q. If one Sensor has a low battery, should I replace all of the batteries?

A. If Sensors were added at the same time, chances are good all the batteries will need to be replaced.

Q. How do I know if any Sensors have low batteries?

A. The Control Center will indicate if any Sensor does not have sufficient power to transmit a status signal (battery is low). You can also check each Sensor independently by using the Test Mode (see pg.9 in manual).

Q. If one Sensor has a low battery, will the other Sensors in the Zone (or other Zones) continue to operate?

A. Yes, as long as the other Sensors have sufficient battery power, they will continue to transmit information to the Control Center and the system will operate normally.

FCC Warning

Any unauthorized changes or modifications to the equipment would void the user's warranty and may conflict with both state and federal laws. The Choice Alert system complies with part 15 of the FCC rules. Operation is subject to the following conditions:

- 1) The Choice Alert system may not cause harmful interference.
- 2) The Choice Alert system may accept any interference received including interference that may cause undesired operation.

NOTE: This equipment has been tested and found to comply with the limits for a Class B digital device, pursuant to Part 15 of the FCC Rules. These limits are designed to provide reasonable protection against harmful interference in a residential installation. This equipment generates, uses and can radiate radio frequency energy and, if not installed and used in accordance with the instructions, may cause harmful interference to radio communications. However, there is no guarantee that interference will not occur in a particular installation. If this equipment does cause harmful interference to radio or television reception, which can be determined by turning the equipment off and on, the user is encouraged to try to correct the interference by one or more of the following measures:

- Reorient or relocate the receiving antenna.
- Increase the separation between the equipment and receiver.
- Connect the equipment into an outlet on a circuit different from that to which the receiver is connected.
- Consult the dealer or an experienced radio/TV technician for help

WARNING

Limitations of Alarm Products

This product should be tested periodically to make sure it is working properly. The product, if used properly, may reduce the risk of burglary, robbery, or other adverse events. However, JASCO is not an insurer, this product is neither insurance nor a guarantee that such an event will be prevented, and users should protect themselves with proper insurance. JASCO makes no representation that this product cannot be compromised or circumvented, that it will provide an adequate warning, or that it will prevent any personal injuries, property damage, or other losses. Like any alarm product, including expensive commercial systems, it may be bypassed, it is subject to compromise, and it may fail to warn for a variety of reasons, including, but not limited to: improper installation or positioning; improper maintenance; tampering; dead or improperly installed batteries; sensing limitations; component failures; receivers; intrusions may be outside of a product's designed range and certain environmental conditions may impact performance and audible alarm signals may be outside of hearing range, muted by doors, walls, and floors, unheard by deep sleepers or the hearing-impaired, or overwhelmed by other sounds.



is a trademark of the General Electric Company and is used under license to Jasco Products Company LLC, 10 E. Memorial Road, Oklahoma City, OK 73114.

This Jasco product comes with a 1 year limited warranty. Visit

www.jascoproducts.com for details.

45130-1

01/09/08

Free Manuals Download Website

<http://myh66.com>

<http://usermanuals.us>

<http://www.somanuals.com>

<http://www.4manuals.cc>

<http://www.manual-lib.com>

<http://www.404manual.com>

<http://www.luxmanual.com>

<http://aubethermostatmanual.com>

Golf course search by state

<http://golfingnear.com>

Email search by domain

<http://emailbydomain.com>

Auto manuals search

<http://auto.somanuals.com>

TV manuals search

<http://tv.somanuals.com>