

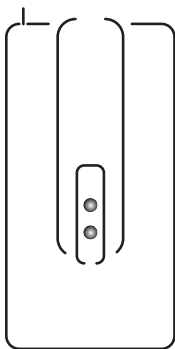

Wireless Alarm System

Silent Alert™

User's Manual



Control all Sensors

& accessories from

one location

Table of Contents

Important Safeguards	4
Introduction	4
Adding a Silent Alert to the system	5-6
Testing the Silent Alert or your system	6
Installation	7
Low battery indicator	9
Battery warnings	9
FCC Warning	8

Before connecting or operating the Silent Alert, please read these instructions carefully and save this manual for future reference.

Congratulations

The GE Choice Alert™ Wireless Alarm System is one of the most affordable and expandable wireless alarm systems available. You'll discover the system offers many features typically found in custom installed Alarm systems.

The Choice Alert system is reliable and easy-to-use. With Choice Alert you can select from a line of Sensors and Accessories; start small and expand as you need, or create a system that meets all your needs. The Choice Alert System is protected by Priority Code Selection technology which provides increased security and trouble-free wireless connections. It also guarantees the Control Center will only respond to signals from your Sensors in and around your home, and prevents anyone from tampering with your system.

The user manual explains in simple steps how to install, use and care for your new Choice Alert Silent Alert.

If you have any questions or would like additional information please visit our web site www.jascopeproducts.com, or contact our Customer Service Group at 1-800-654-8483.

Important safeguards

PreCautions

1. Do not attempt to disassemble the Silent Alert, unless described in the user's manual. There are no user serviceable parts.
2. Handle with Care – Avoid striking or shaking. Improper use or storage could damage the Silent Alert. Modifying or tampering the device or its internal components can cause a malfunction and void the Silent Alert's warranty.
3. If you feel the Silent Alert or any part of the Choice Alert system is not operating correctly or as described, please contact Customer Service for assistance **(1-800-654-8483)**.

Introduction

The Silent Alert is an excellent addition the Choice Alert Alarm system. It can provide an extra level of awareness for alarm activity as well as keep you and your family informed about the status of the wireless alarm. There is no limit to the number of Silent Alerts that can be added to the system. Suggested discrete places to position the Silent Alert may be above the Garage door, above the interior garage door leading into the house, over or along side a window, under the eave of a roof line... generally any area that is easy to notice but secluded enough so only you and your family know where to look.

The Silent Alert will only activate once an alarm is actually sounded. It will not activate during the entry and exit delay times. It cannot be turned-off unless it receives a disarm code from the Control Center it is linked with, or the batteries have been removed. Once activated it will continue to blink for several days. It cannot be disarmed even if the Control Center is unplugged or destroyed.

Parts Check List

Identify all the parts before proceeding.
The Silent Alert is designed to provide a visual warning BEFORE entering the home if an alarm has

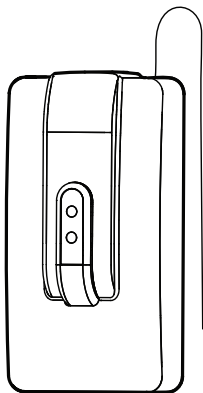

Silent Alert

2 - Screws



2 - Plastic anchors



2 - Rubber gromets



Double sided tape

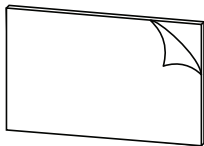

been triggered.

You can add any number of Silent Alert LED indicators to the Choice Alert System. To add a Silent Alert to the system, you will need to link it with the Control Center.

Adding a Silent Alert™

In order to link the Silent Alert to the Crontrol Center, you will need to have the Silent Alert and Control Center near each other.

Step 1 - Open the Silent Alert by gently inserting a small blade screwdriver into the tab slot on one end and gently pry upwards. This action releases the cover from the base. This procedure can be easily completed once the Silent Alert is mounted as well. Install two (2) new "AA" batteries according to the polarity markings in the battery compartment.

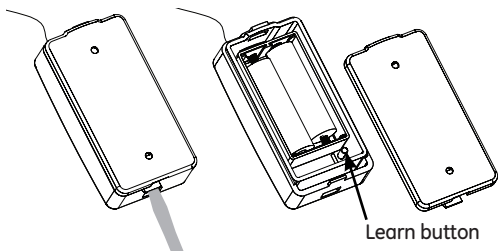

Step 2 - Press and hold the Learn button inside the Silent Alert. One of the LED indicators on the front of the Silent Alert will begin to flash.

Step 3 - While continuing to press the Learn button in the Silent Alert, **press and hold the Mute button on the side of the Control Center** for

three seconds.

Step 4 - Release all buttons.

The Control Center will sound two beeps and flash the green power indicator, this indicates a test signal was sent to the Silent Alert. When the Silent Alert receives the test signal, the LED indicator will stop flashing, indicating it has been linked with your Control Center. Reattach the Silent Alert to the base.

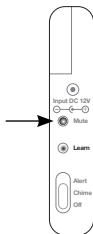

Anytime the alarm is triggered (in Armed HOME or AWAY), and the siren sounds, the Control Center will send a signal to the Silent Alert to begin alternately flashing its LED indicators. The Silent Alert will continue to flash the LED indicators until the Control Center sends a disarm signal.

Note: Even if the Control Center is disconnected from power or destroyed, the Silent Alert will continue to flash LED indicators.

Installation

You will need to determine if the surface to mount the Silent Alert is smooth or rough/porous. If smooth you can use the included double sided tape. **When using doublesided tape apply to clean dry surface.** Remove one side of the tape and attach it to the back side of the Silent Alert. Once the mounting surface is ready, remove the other side of the double side tape and press into position.

If the mounting surface is rough or porous, you will need to use the rubber grommets and screws (included). Secure the plate to the desired location with the screws.

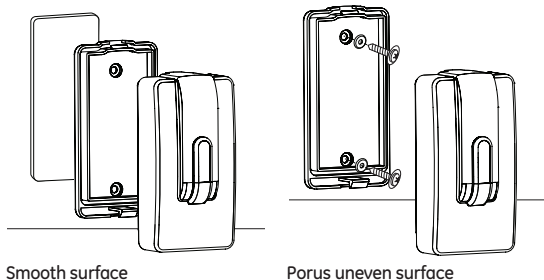

Smooth surface

Porus uneven surface

Test the Silent Alert

Step 1 - After the Silent Alert has been successfully linked with the Control Center, press and hold the Mute button on the Control Center for three seconds. This action sends a test signal.

Step 2 - When the Silent Alert receives the test signal from the Control Center, one LED indicator on the Silent Alert will begin to flash once a second. It will continue to flash for 30 seconds.

Erasing the Silent Alert from the system

Step 1 - Remove the batteries from the Silent Alert.

Step 2 - With the batteries removed, press and hold the Learn button.

Step 3 - While pressing the Learn button, re-install the batteries. The LEDs will flash rapidly and then stop. This indicates the Silent Alert has been removed from the system.

Step 4 - Release all buttons

Low Battery Indicator

When the voltage level of batteries reach low levels, one LED will begin to flash once every 5 seconds. This indicates that the batteries need to be replaced.

Model #	Description	Battery Type	Battery Life*
45129	Control Center	(4) "AAA"	24 months
45137	Silent Alert	(2) "AA"	18 months

*maximum potential life based upon usage and location

WARNING!

Risk of personal injury

- Prolonged exposure to alarm siren may cause permanent hearing loss

Battery Warning!

- Remove batteries before storing the Alarm or Sensor for extended periods
- Batteries may leak harmful liquids or ignitable materials or explode causing injury and product damage
- Do not mix old and new or other battery types
- Replace all batteries at the same time
- Replace fully discharged batteries immediately

FCC Warning

Any unauthorized changes or modifications to the equipment would void the user's warranty and may conflict with both state and federal laws. The Choice Alert system complies with part 15 of the FCC rules. Operation is subject to the following conditions:

- 1) The Choice Alert system may not cause harmful interference.
- 2) The Choice Alert system may accept any interference received including interference that may cause undesired operation.

NOTE: This equipment has been tested and found to comply with the limits for a Class B digital device, pursuant to Part 15 of the FCC Rules. These limits are designed to provide reasonable protection against harmful interference in a residential installation. This equipment generates, uses and can radiate radio frequency energy and, if not installed and used in accordance with the instructions, may cause harmful interference to radio communications. However, there is no guarantee that interference will not occur in a particular installation. If this equipment does cause harmful interference to radio or television reception, which can be determined by turning the equipment off and on, the user is encouraged to try to correct the interference by one or more of the following measures:

- Reorient or relocate the receiving antenna.
- Increase the separation between the equipment and receiver.
- Connect the equipment into an outlet on a circuit different from that to which the receiver is connected.
- Consult the dealer or an experienced radio/TV technician for help

WARNING

Limitations of Alarm Products

This product should be tested periodically to make sure it is working properly. The product, if used properly, may reduce the risk of burglary, robbery, or other adverse events. However, JASCO is not an insurer, this product is neither insurance nor a guarantee that such an event will be prevented, and users should protect themselves with proper insurance. JASCO makes no representation that this product cannot be compromised or circumvented, that it will provide an adequate warning, or that it will prevent any personal injuries, property damage, or other losses. Like any alarm product, including expensive commercial systems, it may be bypassed, it is subject to compromise, and it may fail to warn for a variety of reasons, including, but not limited to: improper installation or positioning; improper maintenance; tampering; dead or improperly installed batteries; sensing limitations; component failures; receivers; intrusions may be outside of a product's designed range and certain environmental conditions may impact performance and audible alarm signals may be outside of hearing range, muted by doors, walls, and floors, unheard by deep sleepers or the hearing-impaired, or overwhelmed by other sounds.



is a trademark of the General Electric Company and is used under license to Jasco Products Company LLC, 10 E. Memorial Road, Oklahoma City, OK 73114.

This Jasco product comes with a 1 year limited warranty. Visit

www.jascoproducts.com for details. Search And Down

45137-1

01/09/08

Free Manuals Download Website

<http://myh66.com>

<http://usermanuals.us>

<http://www.somanuals.com>

<http://www.4manuals.cc>

<http://www.manual-lib.com>

<http://www.404manual.com>

<http://www.luxmanual.com>

<http://aubethermostatmanual.com>

Golf course search by state

<http://golfingnear.com>

Email search by domain

<http://emailbydomain.com>

Auto manuals search

<http://auto.somanuals.com>

TV manuals search

<http://tv.somanuals.com>