

TrueDRY™ DR120

Ventilating Dehumidification System

SPECIFICATION DATA

DR120 Capacities and Performance

Part Number:	DR120A2000
Blower:	350 CFM @ 0.0 in. WG 210 CFM @ 0.4 in. WG
Supply Voltage:	120 VAC; 60 Hz.
Amps:	8.1 A
Power transformer to R/C terminals:	24 VAC, 0.85A
Energy performance:	2.69 liters (5.7 pints) per kilowatt hour (KWH)
Refrigerant:	R-410A
Operating Temp Range (outside cabinet):	34 – 135 °F (1.1 – 57.2 °C)
Capacity:	65 pints/day (60 °F [15.6 °C], 60 %RH) 91 pints/day (70 °F [21.1 °C], 60 %RH) 120 pints/day (80 °F [26.7 °C], 60 %RH)
Coverage:	Up to 3500 sq. ft.
Duct Connections:	6 in. Supply Inlet 10 in. Round Inlet 10 in. Round Outlet (ABS Plastic)
Filter Efficiency:	Standard MERV-11
Drain Connection:	3/4 in. threaded female NPT, with attached 3/4 in. threaded male NPT

Dimensions (See Fig. 1):

Width:	14-3/8 in.
Height:	21-3/16 in.
Length:	25-13/16 in. (without collars) 32-3/16 in. (with collars)
Weight:	90 lbs (40.8 Kg)

Shipping Specs

Width:	18-1/2 in.
Height:	26-1/4 in.
Length:	35-1/2 in.
Weight:	101 lbs (45.8 Kg)

Optional Parts

Replacement Filter	50070171-002
Motorized Ventilation Damper	EARD6
10" Backdraft Damper	SPRD10
Compressor Relay, 24 VAC, 30 A	50035445-014
Compressor Run Capacitor	50070205-001
10" Duct Collar	50049536-005
Fan Assembly	50070205-002
Capacitor - Fan	50070205-003
Fan Relay, SPDT, 24 VAC, 15A	50035445-011
Transformer 120/24 VAC, 40 VA	50035445-013
Defrost Thermostat	50070204-002
Leveling Foot	50035445-019

ETL Listed. Energy Star Rated. Conforms to UL Std. 474.

For more information call 1-800-468-1502 or visit our website at customer.honeywell.com.

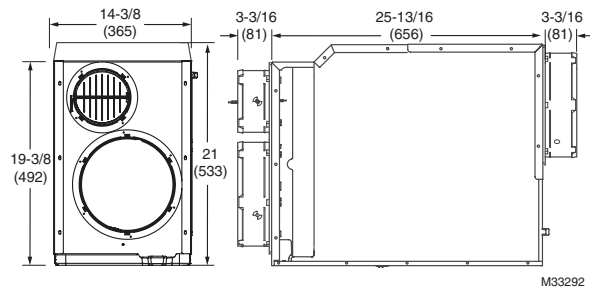

Fig. 1. Dimensions in in. (mm).

Honeywell TrueDRY Whole-House Dehumidifiers are designed to help maintain proper humidity levels in the home. Lower humidity levels feel more comfortable, and helps safeguard against problems from excess moisture in the home such as mold, mildew, warped wood, peeling of paint, or musty odors. Honeywell TrueDRY Whole Home Dehumidification Systems are Energy Star rated providing efficient and economical operation.

Dehumidification

The Honeywell TrueDRY DR120 dehumidifier utilizes refrigeration and internal air circulation to cool the incoming air stream below its dew point. Water condenses and drains off the coil, sending drier air back into the house.

- Can remove up to 120 pints/day of moisture.
- Energy Star rated
- Electrocoating reduces coil corrosion and helps prevent refrigerant leaks
- Top or side ducted exhaust
- Reduced noise during operation
- MERV 11 air filtration

Ventilation

The Honeywell TrueDRY DR120 has a separate control for ventilation, so the powerful onboard blower can be used to efficiently bring fresh air into the house even when dehumidification is not needed. The TrueDRY DR120 has a 6" supply side damper that can be used to duct in air from the outside, or closed if not needed.

Simplified Wiring

The Honeywell TrueDRY DR120 dehumidifiers can be controlled by a variety of 24-volt remote wired and wireless controls.

The TrueDRY DR120 allows the use of a 24V normally closed float switch or water sensor to simplify installation in a drain pan. This will allow the external float switch to kill power to the compressor in the event of water blockage.



68-3088-01

Installation Recommendations and Options

A

Dedicated Return to Main Supply

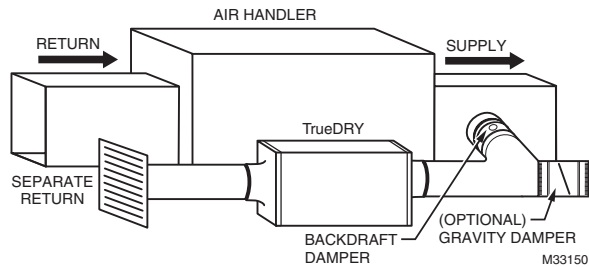

Ideal when...

- Access to a dedicated central return for TrueDRY DR65 is available.
- Combined with A/C operation; requires backdraft damper on the exhaust port to minimize backdraft when TrueDRY DR65 is not on but A/C is.
- Providing dry air to a specific area with an optional 20% open gravity damper on TrueDRY DR65 supply.

B

Main Return to Main Supply

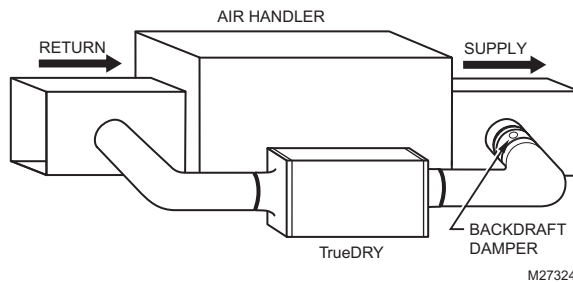

Ideal when...

- Running TrueDRY DR65 when not running A/C. Requires damper on the exhaust port to minimize backdraft when TrueDRY DR65 is not on but A/C is.
- Access to a dedicated central return for TrueDRY DR65 is not available.
- System fan should run with dehumidifier for best results.

C

Main Return to Main Return

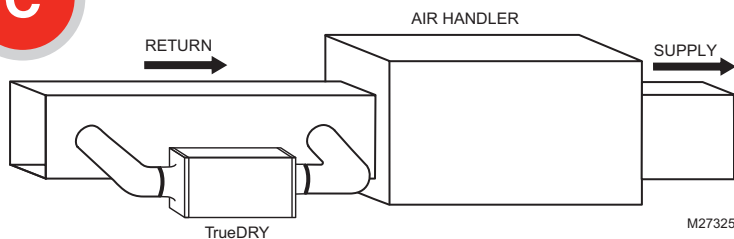

Ideal when...

- Running TrueDRY DR65 with A/C operation.
- System fan must run with dehumidifier.
- Minimizing discharge air temperature (DAT) increase is preferred.
- Access to a dedicated central return for TrueDRY DR65 is not available.

D

Dedicated Return to Main Return

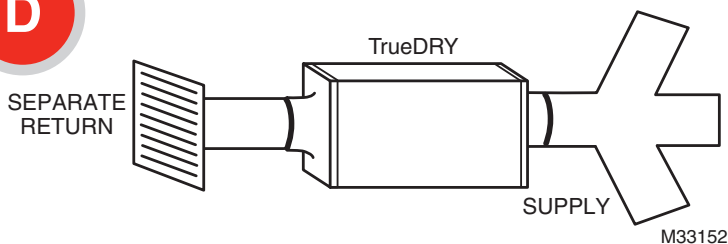

Ideal when...

- TrueDRY DR65 will not be ducted to a forced air HVAC system.

Automation and Control Solutions

Honeywell International Inc.
1985 Douglas Drive North
Golden Valley, MN 55422

<http://customer.honeywell.com>

© U.S. Registered Trademark.
© 2012 Honeywell International Inc.
68-3088-01 M.S. 03-12
Printed in U.S.A.

Honeywell

Free Manuals Download Website

<http://myh66.com>

<http://usermanuals.us>

<http://www.somanuals.com>

<http://www.4manuals.cc>

<http://www.manual-lib.com>

<http://www.404manual.com>

<http://www.luxmanual.com>

<http://aubethermostatmanual.com>

Golf course search by state

<http://golfingnear.com>

Email search by domain

<http://emailbydomain.com>

Auto manuals search

<http://auto.somanuals.com>

TV manuals search

<http://tv.somanuals.com>